

Sharkoon

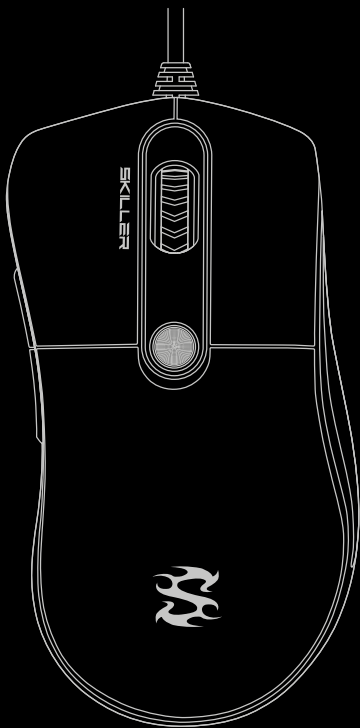

SKILLER
SGM2

Manual

Specifications

General:

■ Max. DPI/CPI Min. DPI/CPI	6,400 400
■ Sensor	Optical
■ Chip	SPCP6651
■ Illumination	✓
■ Max. Polling Rate	1,000
■ Lift-Off Distance	2 mm
■ Frames Per Second	6,000
■ Inches Per Second	66
■ Max. Acceleration	22.5 g
■ Mouse Feet	4, PTFE
■ Weight Without Cable	106 g
■ Dimensions (L x W x H)	131.6 x 69.2 x 42.4 mm
■ Supported Operating Systems	Windows XP/7/8/10

Button Properties:

■ Number of Buttons	6
■ Operating Life Cycles of Buttons	Min. 5 Million Clicks

DPI Properties:

■ DPI Steps	400/1,200/3,200/6,400
■ DPI Switch	✓
■ DPI Indicator	✓

Cable and Connectors:

■ Connector	USB
■ Gold-Plated USB Plug	✓
■ Textile Braided Cable	✓
■ Cable Length	180 cm

Package Contents:

■ SKILLER SGM2, Additional Set of Mouse Feet, Manual
--

Overview

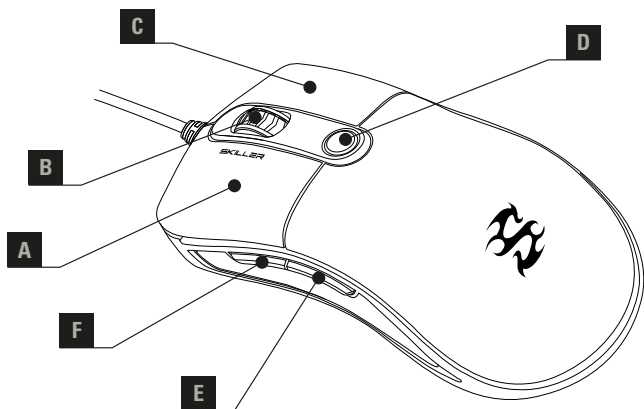

- A Left mouse button
- B Scroll wheel
- C Right mouse button
- D DPI switch
- E Thumb button 2
- F Thumb button 1
- G LED Mode Selector

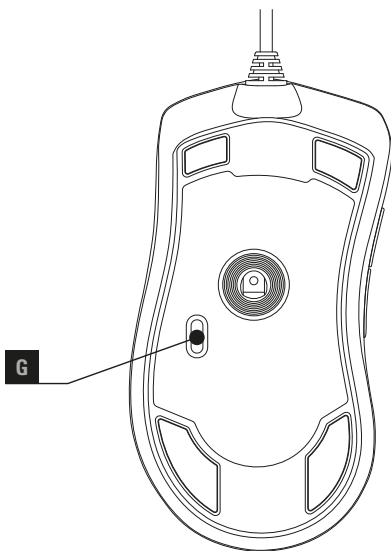

Connecting to the PC

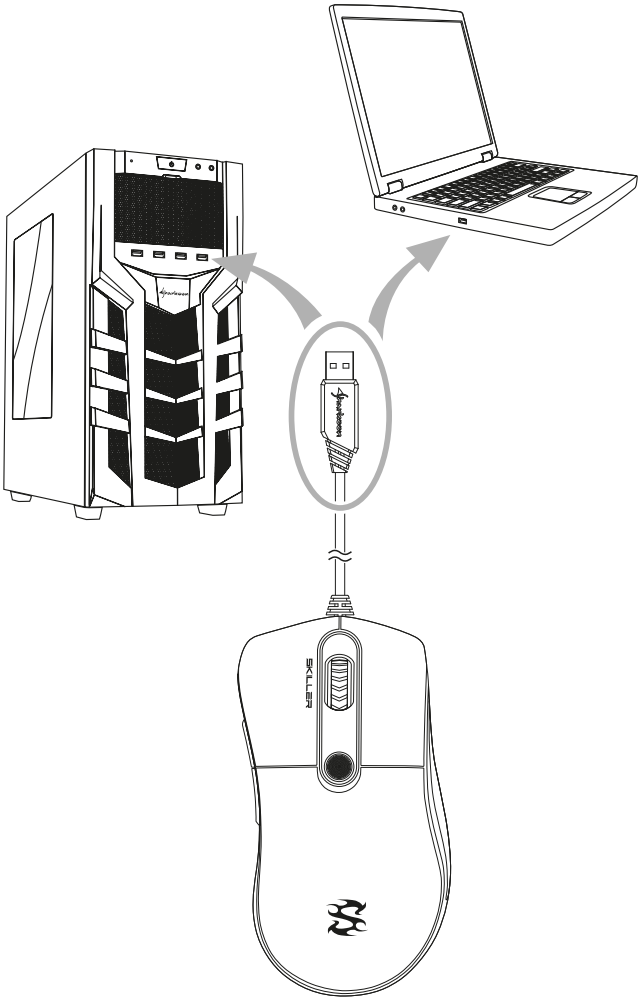

DPI Indicator

If a new DPI step is selected, all the illumination blinks three times in the color of the selected step. An active illumination mode will be briefly paused. A small delay can occur until the illumination is refreshed. The DPI steps are ordered in the following colors:

■ Red SKILLER logo:	400 DPI
■ Green SKILLER logo:	1,200 DPI
■ Blue SKILLER logo:	3,200 DPI
■ Yellow SKILLER logo:	6,400 DPI



Illumination Modes

To select the desired illumination mode, press the LED mode selector on the underside of the mouse up to six times. The seventh press will deactivate the illumination. The illumination modes are as follows:

■ Press x 1:	Pulsating (Color depends on the selected DPI step)
■ Press x 2:	Rainbow
■ Press x 3:	Color Change
■ Press x 4:	Color Flow
■ Press x 5:	Color Marquee
■ Press x 6:	Segmented Color Flow

Legal Disclaimer

For potential loss of data, especially due to inappropriate handling, SHARKOON assumes no liability.

All named products and descriptions are trademarks and/or registered trademarks of the respective manufacturers and are accepted as protected. As a continuing policy of product improvement at SHARKOON, the design and specifications are subject to change without prior notice. National product specifications may vary.

All rights reserved especially (also in extracts) for translation, reprinting, reproduction by copying or other technical means. Infringements will lead to compensation. All rights reserved especially in case of assignation of patent or utility patent. Means of delivery and technical modifications reserved.

Disposal of your old products

Your product is designed and manufactured with high quality materials and components, which can be recycled and reused.



When this crossed-out wheeled bin symbol is attached to a product, it means the product is covered by the European Directive 2012/19/EU.

Please be informed about the local separate collection system for electrical and electronic products. Please act according to your local rules and do not dispose of your old products with your normal household waste. The correct disposal of your old product will help prevent potential negative consequences to the environment and human health.

SHARKOON Technologies GmbH
Siemensstraße 38
35440 Linden
Germany

© **SHARKOON Technologies 2018**

info@sharkoon.com
www.sharkoon.com