



# INSTALLATIEHANDLEIDING

Stadium 22S

Stadium 32S

Stadium 52F

Stadium 52CF

Stadium 62F

Stadium 62CF

Stadium 192T

Stadium 862F

Stadium 862CF

Stadium 962C

Stadium 962M

# Stadium 22S

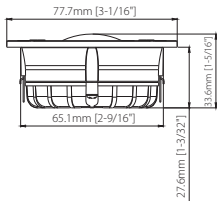
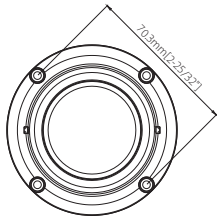
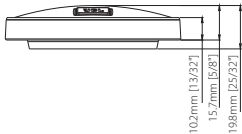
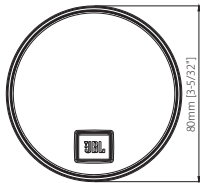

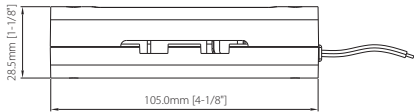
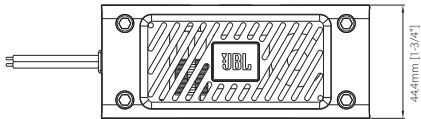
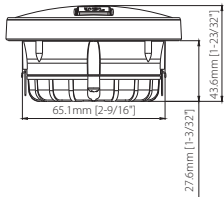
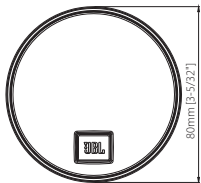

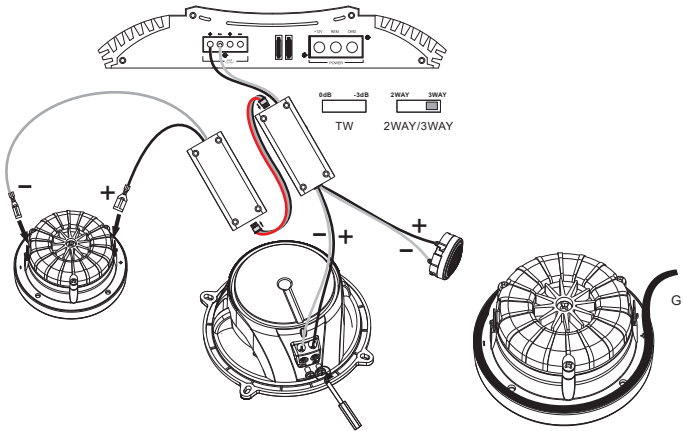

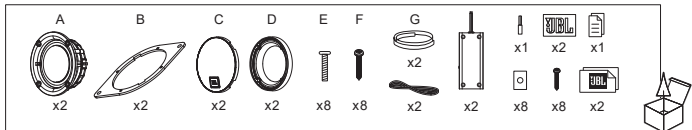
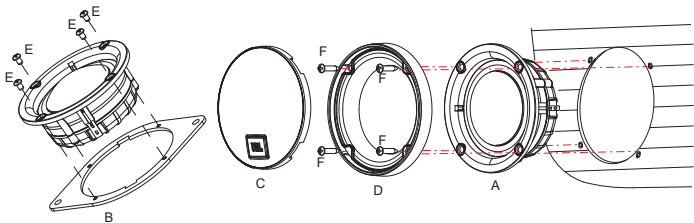

## Specificaties

- Type: 2" (50 mm) PEI dome midrange met bandpass crossover-behuizing
- Vermogen: 50Wrms, 150W piek
- Gevoeligheid (@ 2,83 V): 94dB
- Frequentierespons: 500Hz – 7kHz
- Impedantie: 3,0 ohms

## Thiele-Small Parameters

- Crossover Point: 600 Hz

# Stadium 32S

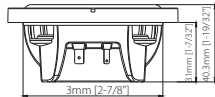
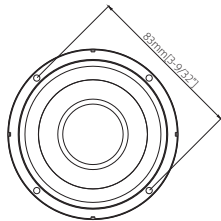
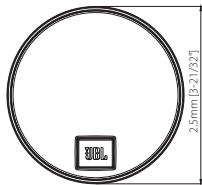

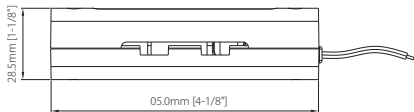
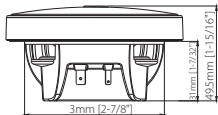
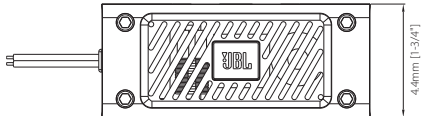
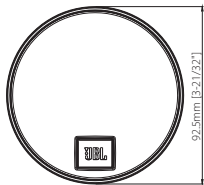



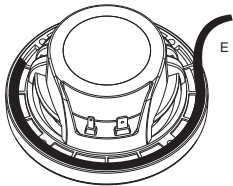
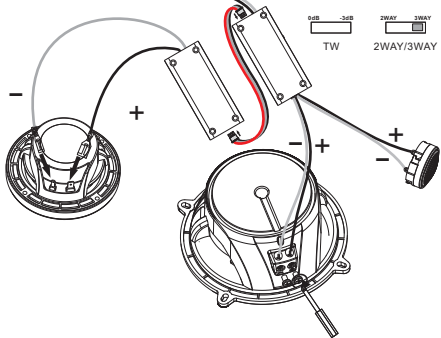
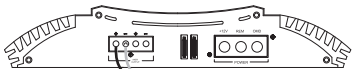

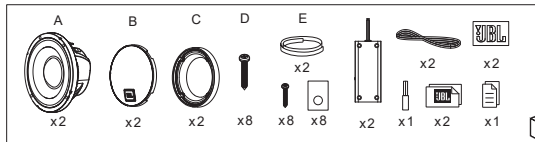
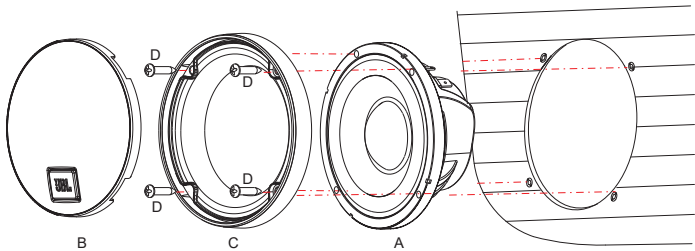

## Specificaties

- Type: 3" (89 mm) midrange met bandpass crossover-behuizing
- Vermogen: 55Wrms, 165W piek
- Gevoeligheid (@ 2,83 V): 93dB
- Frequentierespons: 200Hz – 15kHz
- Impedantie: 3,0 ohms

## Thiele-Small Parameters

- BL (Tm): 5,64
- DCR (ohms): 2,7
- Mms (g): 4,964
- Sd (cm<sup>2</sup>): 35,26
- Cms (mm/N): 0,113
- Vas (l): 0,198
- Fs (Hz): 212,9
- Qes: 0,58
- Qms: 12,282
- Qts: 0,554
- Crossover Point: 300 Hz

# Stadium 52F

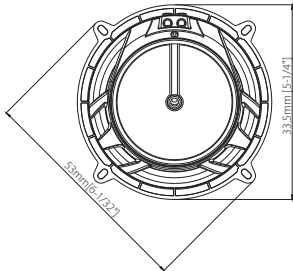
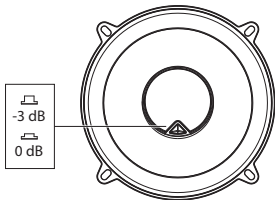
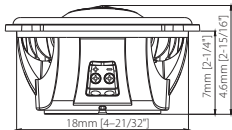

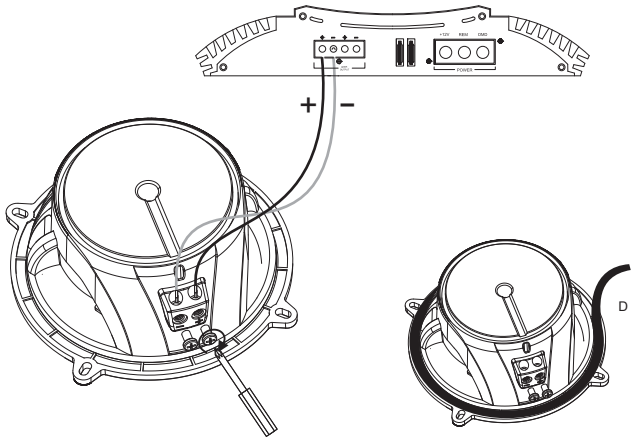

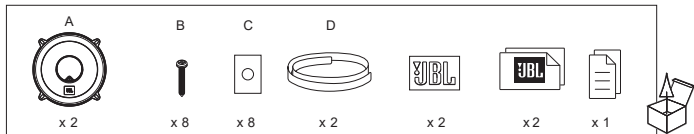
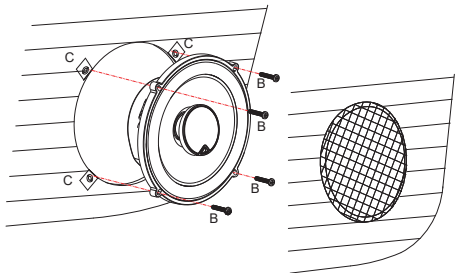

## Specificaties

- Type: 5-1/4" (133 mm) tweeweg autospeaker
- Vermogen: 60Wrms, 180W piek
- Gevoeligheid (@ 2,83 V): 93dB
- Frequentierespons: 55Hz – 40kHz
- Impedantie: 3,0 ohms

## Thiele-Small Parameters

- BL (Tm): 3,88
- DCR (ohms): 2,70
- Mms (g): 9,82
- Sd (cm<sup>2</sup>): 102,07
- Cms (mm/N): 0,40
- Vas (l): 5,95
- Fs (Hz): 79,90
- Qes: 0,92
- Qms: 6,85
- Qts: 0,81
- Crossover Point: 4,6 kHz

# Stadium 52CF

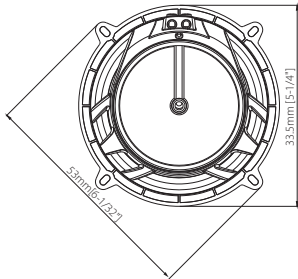
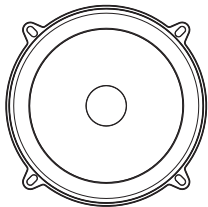
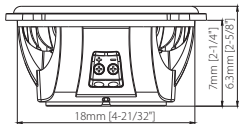



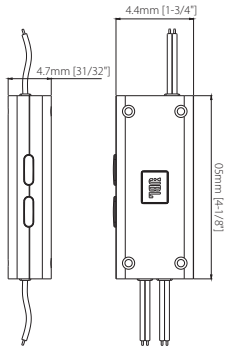
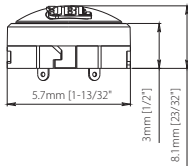
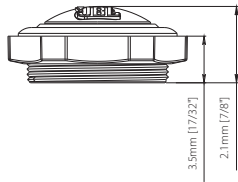
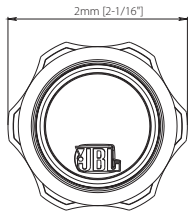

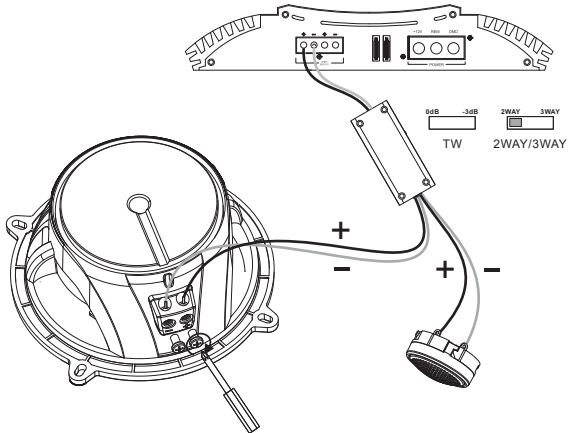

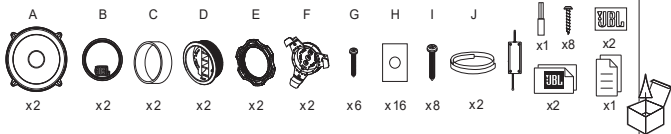
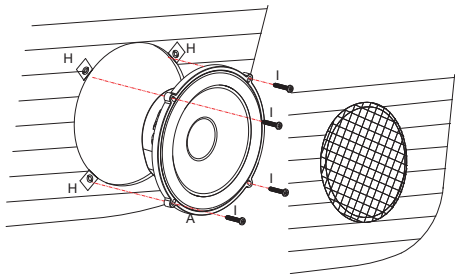

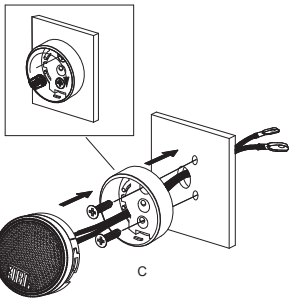
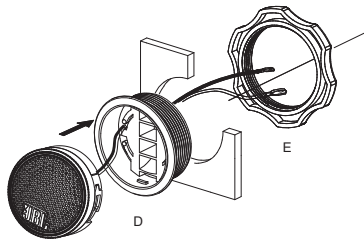
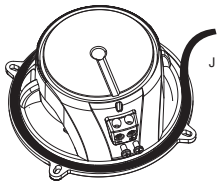

## Specificaties

- Type: 5-1/4" (133 mm) tweeweg component speakersysteem
- Vermogen: 80Wrms, 240W piek
- Gevoeligheid (@ 2,83 V): 93dB
- Frequentierespons: 55Hz – 40kHz
- Impedantie: 3,0 ohms

## Thiele-Small Parameters

- BL (Tm): 3,96
- DCR (ohms): 2,70
- Mms (g): 11,42
- Sd (cm<sup>2</sup>): 102,07
- Cms (mm/N): 0,40
- Vas (l): 5,89
- Fs (Hz): 74,50
- Qes: 0,92
- Qms: 6,98
- Qts: 0,81
- Crossover Point: 4,0 kHz

# Stadium 62F

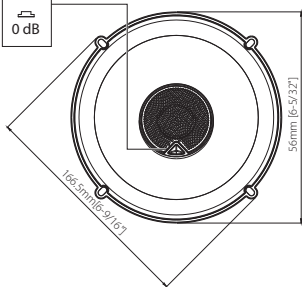
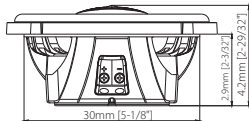
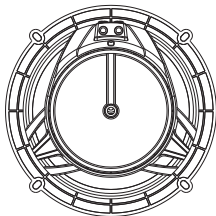



+ -

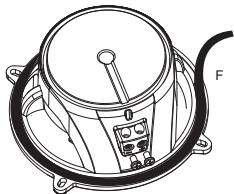
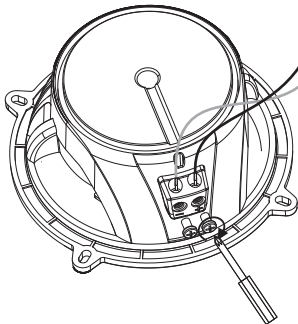

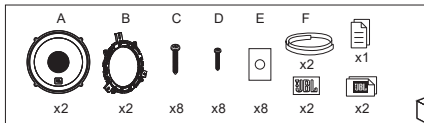
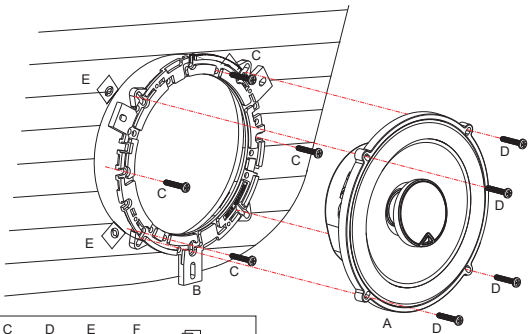



## Specificaties

- Type: 6-1/2" (165 mm) tweeweg autospeaker
- Vermogen: 85Wrms, 255W piek
- Gevoeligheid (@ 2,83 V): 93dB
- Frequentierespons: 45Hz – 40kHz
- Impedantie: 3,0 ohms

## Thiele-Small Parameters

- BL (Tm): 4,23
- DCR (ohms): 2,70
- Mms (g): 14,23
- Sd (cm<sup>2</sup>): 143,14
- Cms (mm/N): 0,24
- Vas (l): 6,99
- Fs (Hz): 86,00
- Qes: 1,19
- Qms: 11,31
- Qts: 1,08
- Crossover Point: 4,6 kHz

# Stadium 62CF

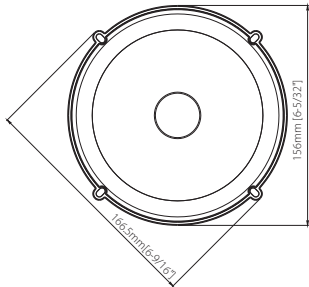
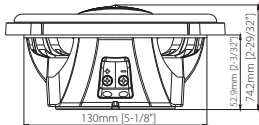
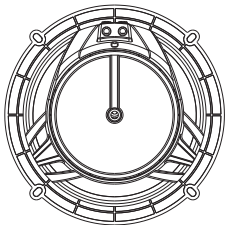

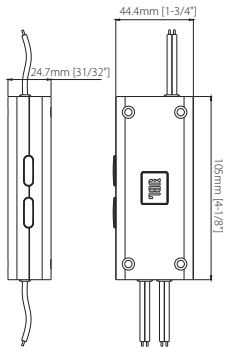
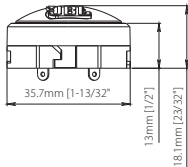
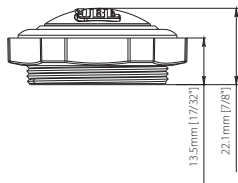
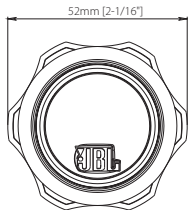

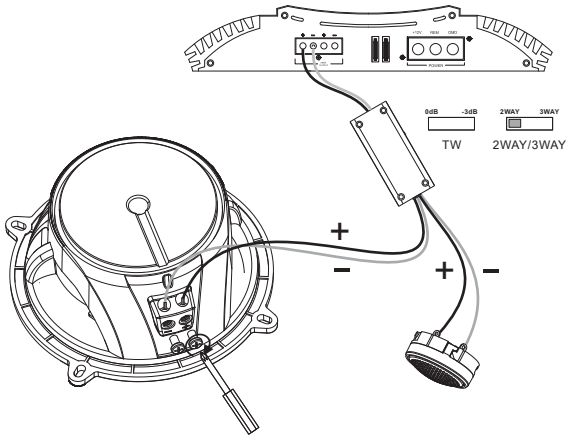

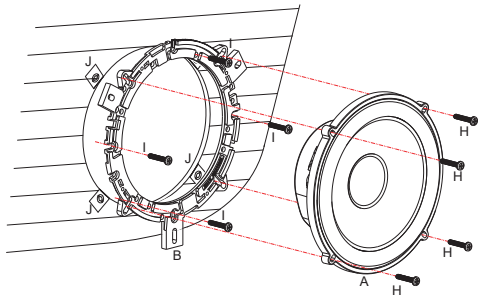

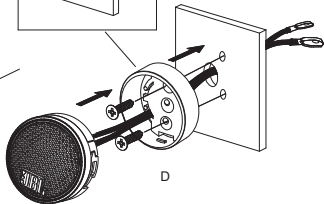
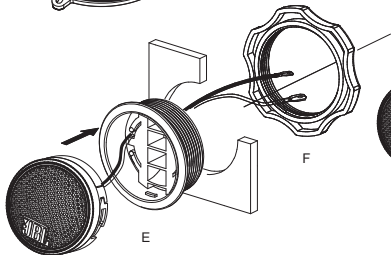
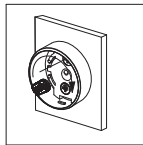
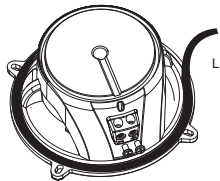

## Specificaties

- Type: 6-1/2" (165 mm) tweeweg component speakersysteem
- Vermogen: 110Wrms, 330W piek
- Gevoeligheid (@ 2,83 V): 93dB
- Frequentierespons: 45Hz – 40kHz
- Impedantie: 3,0 ohms

## Thiele-Small Parameters

- BL (Tm): 4,45
- DCR (ohms): 2,70
- Mms (g): 14,62
- Sd (cm<sup>2</sup>): 143,14
- Cms (mm/N): 0,25
- Vas (l): 7,34
- Fs (Hz): 82,70
- Qes: 1,02
- Qms: 8,47
- Qts: 0,91
- Crossover Point: 4,6 kHz

# Stadium 192T

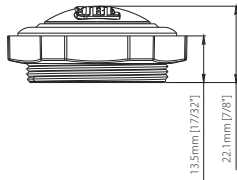
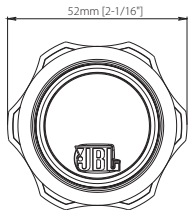
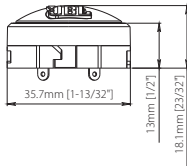



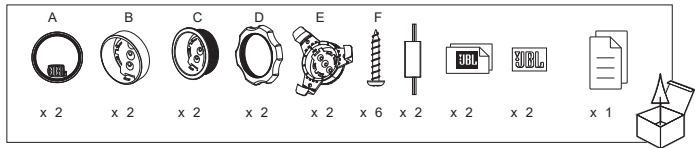
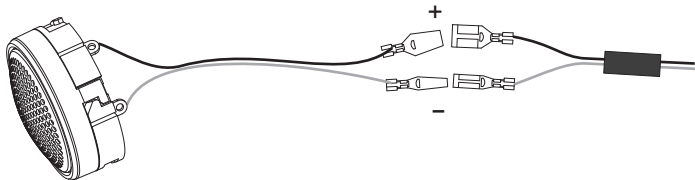

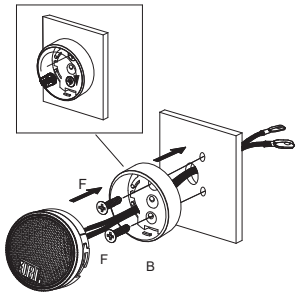
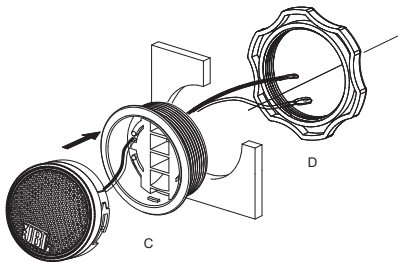

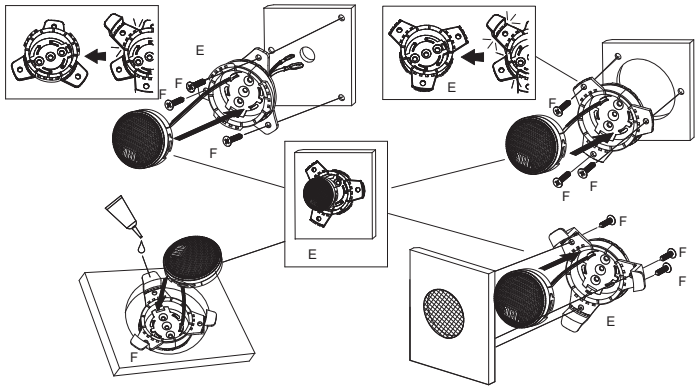

## Specificaties

- Type: 3/4" (19 mm) Edge-Driven aluminium dome tweeter
- Vermogen: 50Wrms, 150W piek
- Gevoeligheid (@ 2,83 V): 93dB
- Frequentierespons: 2kHz – 40kHz
- Impedantie: 3,0 ohms

## Thiele-Small Parameters

- Crossover Point: 4,6 kHz

# Stadium 862F

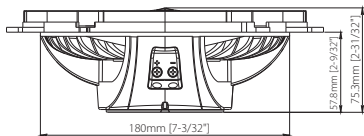
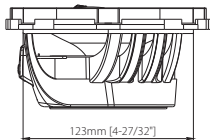
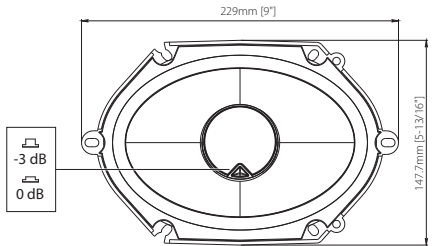

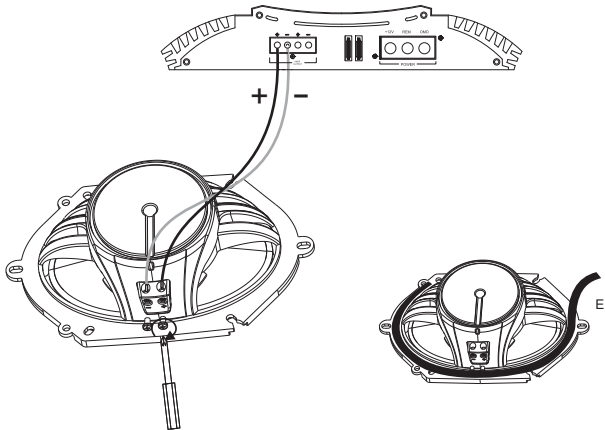

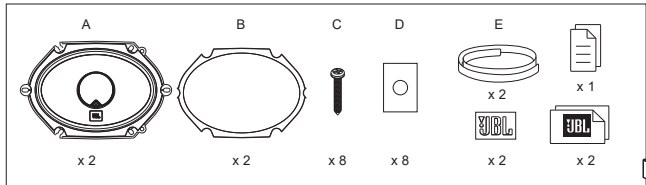
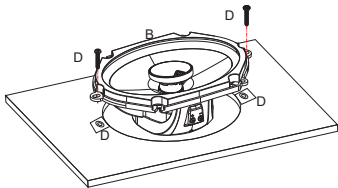
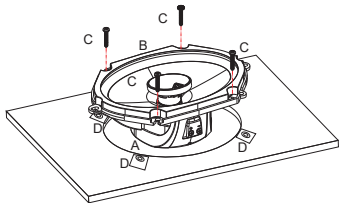

## Specificaties

- Type: 6" x 8" (147 mm x 205 mm) tweeweg autoluidspreker
- Vermogen: 100Wrms, 300W piek
- Gevoeligheid (@ 2,83 V): 93dB
- Frequentierespons: 40Hz – 40kHz
- Impedantie: 3,0 ohms

## Thiele-Small Parameters

- BL (Tm): 4,66
- DCR (ohms): 2,70
- Mms (g): 17,58
- Sd (cm<sup>2</sup>): 167,42
- Cms (mm/N): 0,25
- Vas (l): 9,94
- Fs (Hz): 75,80
- Qes: 1,03
- Qms: 10,19
- Qts: 0,93
- Crossover Point: 4,1 kHz



# Stadium 862CF

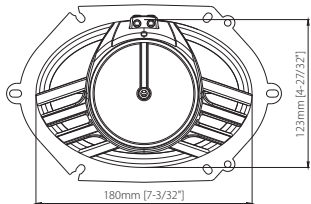
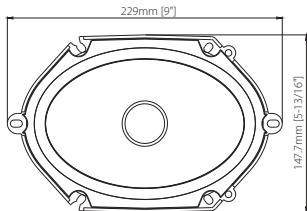
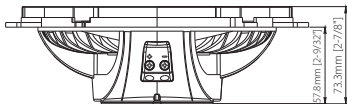

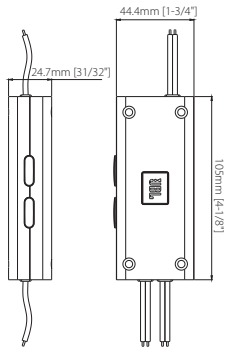
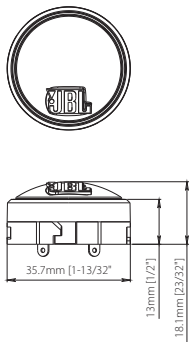
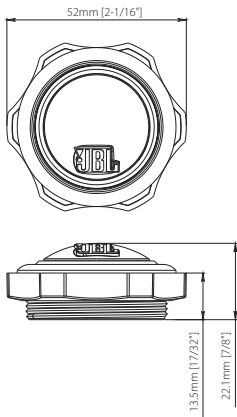

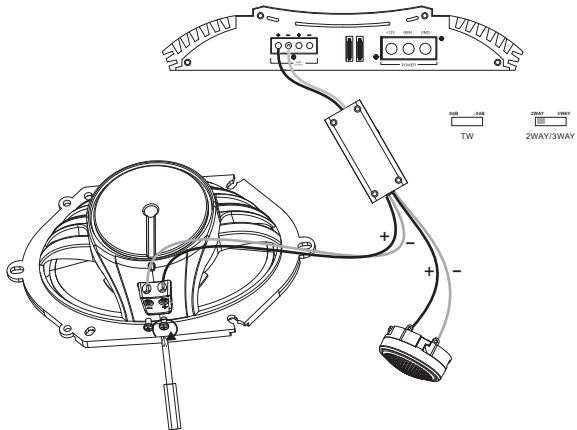

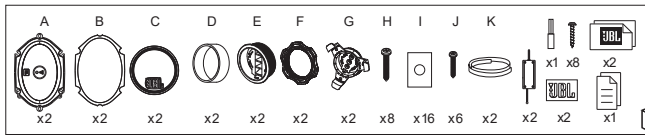
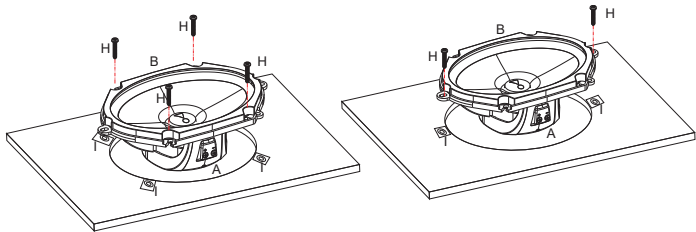

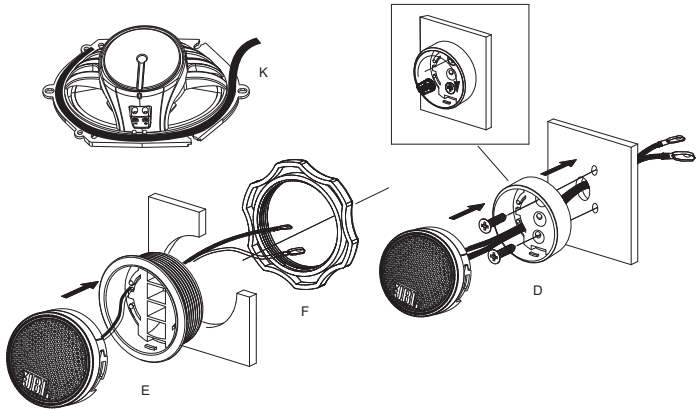

## Specificaties

- Type: 6" x 8" (147 mm x 205 mm) tweeweg component speakersysteem
- Vermogen: 120Wrms, 360W piek
- Gevoeligheid (@ 2,83 V): 93dB
- Frequentierespons: 40Hz – 40kHz
- Impedantie: 3,0 ohms

## Thiele-Small Parameters

- BL (Tm): 4,70
- DCR (ohms): 2,70
- Mms (g): 16,74
- Sd (cm<sup>2</sup>): 167,42
- Cms (mm/N): 0,28
- Vas (l): 11,06
- Fs (Hz): 73,70
- Qes: 0,97
- Qms: 6,16
- Qts: 0,84
- Crossover Point: 4,0 kHz

# Stadium 962C

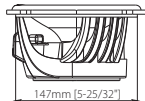
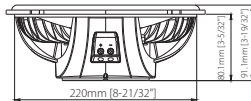
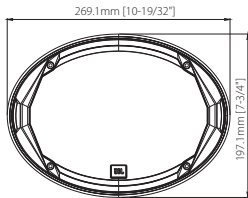
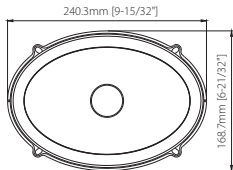

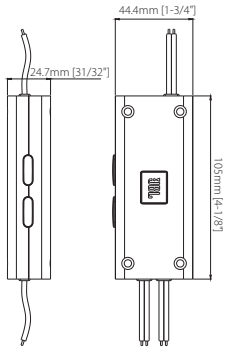
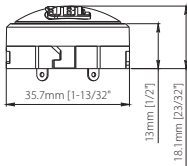
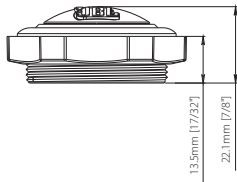
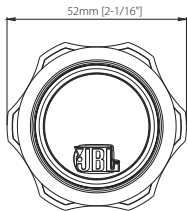



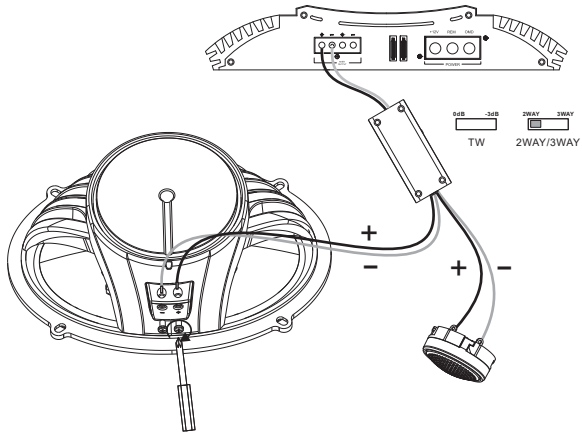

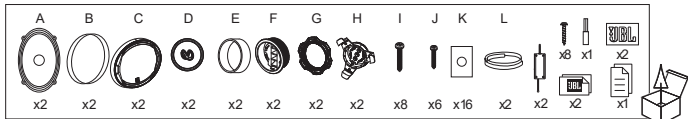
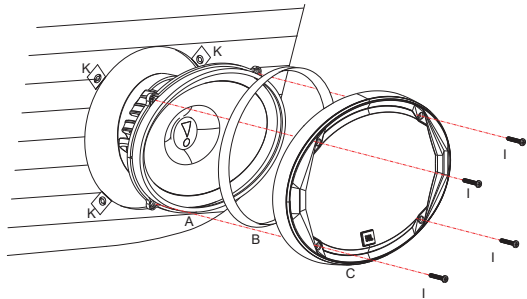

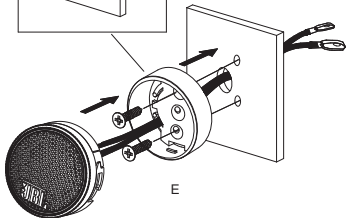
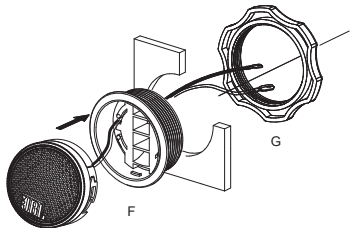
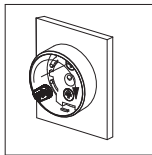
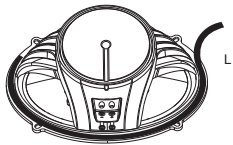

## Specificaties

- Type: 6" x 9" (168 mm x 240 mm) tweeweg component speakersysteem
- Vermogen: 145Wrms, 435W piek
- Gevoeligheid (@ 2,83 V): 94dB
- Frequentierespons: 35Hz – 40kHz
- Impedantie: 3,0 ohms

## Thiele-Small Parameters

- BL (Tm): 6,162
- DCR (ohms): 2,70
- Mms (g): 28,033
- Sd (cm<sup>2</sup>): 248,85
- Cms (mm/N): 0,34
- Vas (l): 29,7588
- Fs (Hz): 51,6
- Qes: 0,671
- Qms: 7,374
- Qts: 0,615
- Crossover Point: 3,9 kHz

# Stadium 962M

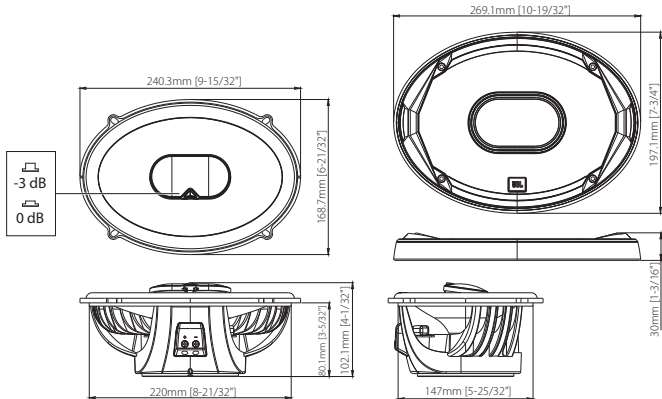

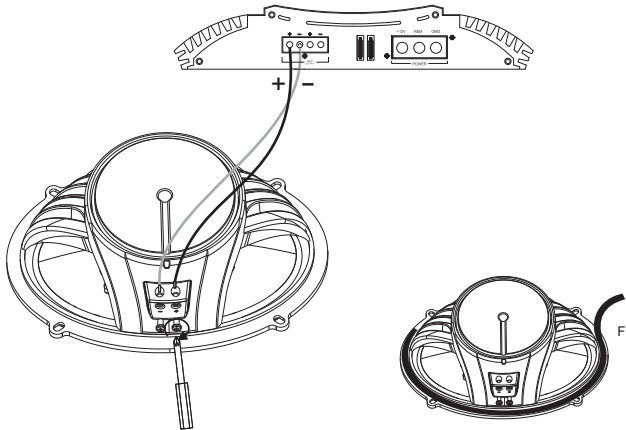

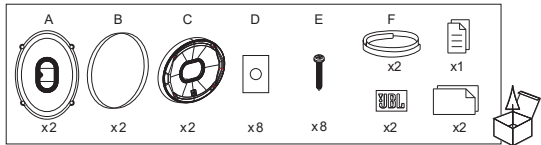
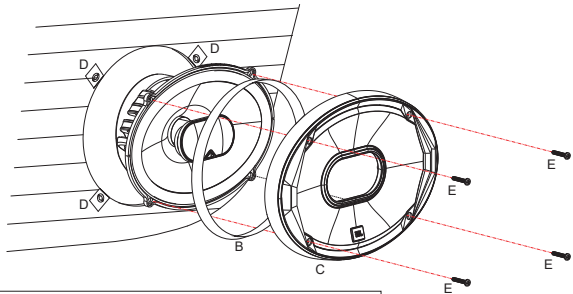

## Specificaties

- Type: 6" x 9" (168 mm x 240 mm) drieweg autospeaker
- Vermogen: 120Wrms, 360W piek
- Gevoeligheid (@ 2,83 V): 94dB
- Frequentierespons: 35Hz – 40kHz
- Impedantie: 3,0 ohms

## Thiele-Small Parameters

- BL (Tm): 6,578
- DCR (ohms): 2,70
- Mms (g): 27,904
- Sd (cm<sup>2</sup>): 248,85
- Cms (mm/N): 0,24
- Vas (l): 21,0071
- Fs (Hz): 61,5
- Qes: 0,741
- Qms: 8,637
- Qts: 0,682
- Crossover Point: 3,9 kHz





HARMAN International  
Industries, Incorporated  
8500 Balboa Boulevard,  
Northridge, CA 91329 VS  
© 2021 HARMAN International  
Industries, Incorporated. Alle  
rechten voorbehouden.

JBL is een handelsmerk van HARMAN International Industries, Incorporated, geregistreerd in de Verenigde Staten en / of andere landen.

Functies, specificaties en ontwerp kunnen zonder voorafgaande kennisgeving worden gewijzigd.