

Quick Start Guide

1

Charge your Tractive GPS tracker

Press the buttons on the top and bottom of the tracker to detach the battery. Plug the battery into charger provided.

The LED on the charger will turn red while the battery is charging. Once the battery is fully charged, the red light will disappear.

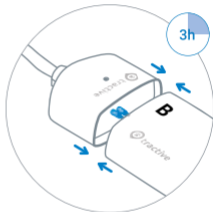
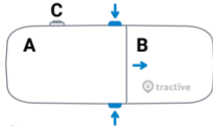

2

Turn on the Tractive GPS tracker

Putting the battery back together with the device will automatically turn on the tracker.

ON/OFF: Press button **C** for 3 seconds.
LED Status: Press button **C** for 1 second.
 LED blinks twice.*



- * ● ● network available - GPS available
- ● no network - GPS available
- ● network available - no GPS
- ● no network - no GPS

3

Download the Tractive GPS app

Download the Tractive GPS app from the Apple App Store or the Google Play Store. You can also visit my.tractive.com to track your pet.



4

Activate your Tractive GPS tracker

Follow the instructions in the Tractive GPS app or at my.tractive.com to activate your tracker. The 8-character Tracker ID can be found on the back of your tracker.

ABCDEFGH



5

Attach your Tractive GPS tracker to your pet's collar

- a) Remove your pet's collar and continue according to the collar width.
- b1) **Collar width: 1.5 cm or less** - put the collar through the two rectangular holes on the sides of the rubber clip.
- b2) **Collar width: 1.6 cm or more** - place the collar in between the rubber clip and the collar mount.
- c) Fasten the rubber clip onto the mount. Attach the Tractive GPS tracker to the mount and ensure the tracker is fully secured.

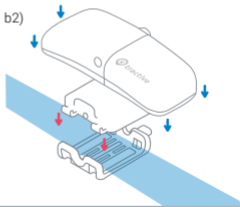
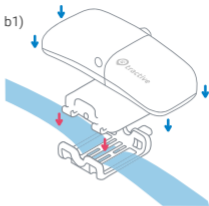

You are ready to go!
Happy Tracking!

?

Need more information?
Visit [tractive.com/help](https://www.tractive.com/help)



Quick Start Guide



1 **Laden** Sie Ihren Tractive GPS Tracker auf

Drücken Sie die Knöpfe an der oberen und unteren Seite des Trackers, um den Akku abzunehmen. Schließen Sie den Akku an das beiliegende Ladegerät an. Die LED am Ladegerät leuchtet rot, während der Akku aufgeladen wird. Sobald dieser vollständig geladen ist, erlischt das rote Licht.

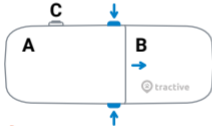

2

Schalten Sie den Tractive GPS Tracker ein

Der Tracker wird automatisch eingeschaltet, wenn der Akku wieder mit dem Gerät verbunden ist.

EIN/AUS: Drücken Sie Knopf **C** für 3 Sek.

LED-Status: Drücken Sie Knopf **C** für 1 Sek.
Die LED blinkt zweimal.*



- * ●● Netzwerk Ja - GPS Ja
- Netzwerk Nein - GPS Ja
- Netzwerk Ja - GPS Nein
- Netzwerk Nein - GPS Nein

3

Laden Sie die Tractive GPS App herunter

Laden Sie die Tractive GPS App vom Apple App Store oder Google Play Store herunter. Sie können Ihr Haustier auch auf my.tractive.com orten.



4

Aktivieren Sie Ihren Tractive GPS Tracker

Folgen Sie den Anweisungen in der Tractive GPS App oder auf my.tractive.com, um Ihren Tracker zu aktivieren.

Sie finden die 8-stellige Tracker-ID auf der Rückseite Ihres Trackers.

ABCDEFGH



5

Befestigen Sie Ihren Tractive GPS Tracker am Halsband Ihres Haustieres

- a) Nehmen Sie Ihrem Haustier das Halsband ab und fahren Sie entsprechend der Halsbandbreite fort.
- b1) **Halsbandbreite: 1,5 cm oder weniger**
Führen Sie das Halsband durch die zwei äußeren, rechteckigen Löcher an den Seiten der Gummiklammer.
- b2) **Halsbandbreite: 1,6 cm oder mehr**
Legen Sie das Halsband zwischen die Gummiklammer und den Halsbandaufsatz.
- c) Befestigen Sie die Gummiklammer am Aufsatz. Bringen Sie den Tracker am Aufsatz an und vergewissern Sie sich, dass er fest sitzt.

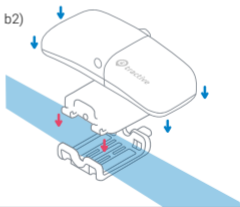
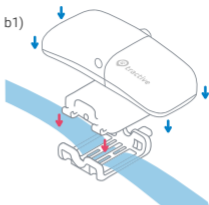

Los geht's!

Viel Spaß beim Tracken!

?

Benötigen Sie mehr Infos?

Besuchen Sie [tractive.com/help](https://www.tractive.com/help)



Quick Start Guide

1

Carica il tuo localizzatore Tractive GPS

Premi i pulsanti nella parte superiore e inferiore del localizzatore per disconnettere la batteria. Inserisci la batteria nel caricabatteria fornito. Il LED sul caricabatterie si illuminerà di rosso mentre la batteria sta caricando. Una volta che la batteria è completamente carica, il LED rosso si spegnerà.

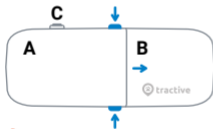

2

Accendi il localizzatore Tractive GPS

Riconnettendo la batteria al localizzatore, questo si accende automaticamente.

ON/OFF: Premi il pulsante **C** per 3 secondi.

Stato LED: Premi il pulsante **C** per 1 secondo. Il LED lampeggia due volte.*



- * ●● Rete OK - GPS OK
- NO rete - GPS OK
- Rete OK - NO GPS
- No rete - NO GPS

3

Scarica l'applicazione Tractive GPS

Scarica l'applicazione Tractive GPS dall'Apple App Store o dal Google Play Store. Puoi anche visitare my.tractive.com per localizzare il tuo animale domestico.



4

Attiva il tuo localizzatore Tractive GPS

Segui le istruzioni nell'applicazione Tractive GPS o su my.tractive.com per attivare il tuo localizzatore. Puoi trovare il codice seriale di 8 caratteri del dispositivo sul retro del tuo localizzatore.

ABCDEFGH



5

Aggancia il localizzatore Tractive GPS al collare del tuo animale domestico

- a) Rimuovi il collare del tuo animale domestico e prosegui in base alla larghezza del collare.
- b1) **Larghezza del collare: 1,5 cm o minore** - inserisci il collare nei fori rettangolari ai lati della clip di gomma.
- b2) **Larghezza del collare: 1,6 cm o maggiore** - posiziona il collare fra la clip di gomma e il supporto per il collare.
- c) Fissa la clip di gomma sul supporto. Aggancia il localizzatore Tractive GPS al supporto e assicurati che l'aggancio sia ben saldo.

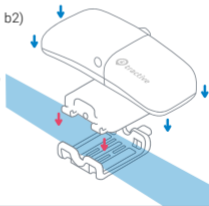
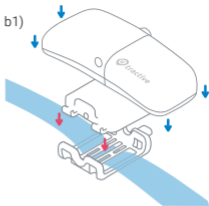

Sei pronto!

Divertiti a localizzare!

?

Hai bisogno di più informazioni?

Visita [tractive.com/help](https://www.tractive.com/help)



Quick Start Guide

1

Chargez votre traceur Tractive GPS

Appuyez sur les boutons situés en haut et en bas de l'appareil afin de détacher la batterie. Insérez la batterie dans le chargeur fourni. Le voyant LED du chargeur s'allume en rouge pendant le chargement de l'appareil. Une fois l'appareil complètement chargé, la lumière rouge disparaîtra.

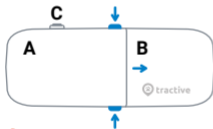

2

Allumez le traceur Tractive GPS

Reconnectez la batterie au traceur et l'appareil s'allumera automatiquement.

ALLUMER/ÉTEINDRE : Appuyez 3 secondes sur le bouton **C**.

État LED : Appuyez 1 seconde sur le bouton **C**. La LED clignote deux fois.*



- * ●● Réseau mobile OK - GPS OK
- Pas de réseau mobile - GPS OK
- Réseau mobile OK - Pas de GPS
- Pas de réseau mobile - Pas de GPS

3

Téléchargez l'application Tractive GPS

Téléchargez l'application Tractive GPS à partir de l'App Store ou du Google Play Store. Vous pouvez également suivre votre animal de compagnie sur my.tractive.com.



4

Activez votre traceur Tractive GPS

Suivez les instructions dans l'application Tractive GPS ou sur my.tractive.com afin d'activer votre appareil. L'identifiant du traceur (8 lettres) se trouve au dos de votre appareil.

ABCDEFGH



5

Attachez votre traceur Tractive GPS au collier de votre animal

- a) Ôtez le collier à votre animal puis continuez suivant la largeur du collier.
- b1) **Largeur collier : 1,5 cm ou moins** - passez le collier par les deux trous rectangulaires sur le côté du clip en silicone.
- b2) **Largeur collier : 1,6 cm et plus** - placez le collier entre le clip et la fixation du traceur.
- c) Attachez le clip en silicone à la fixation. Attachez le traceur Tractive GPS à la fixation et assurez-vous que l'appareil tient bien.

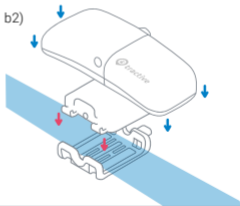
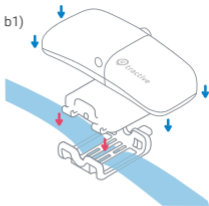

Tout est prêt !
Bon suivi !

?

Apprenez-en plus
sur [tractive.com/help](https://www.tractive.com/help)



Quick Start Guide

1

Cargue su localizador Tractive GPS

Pulse los botones en la parte superior e inferior del dispositivo para extraer la batería. Inserte la batería en el cargador proporcionado. El LED en el cargador se iluminará en rojo mientras se carga la batería. Una vez que el dispositivo esté cargado completamente, la luz roja desaparecerá.

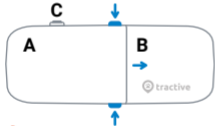

2

Encienda el localizador Tractive GPS

Al volver a unir la batería con el dispositivo, el localizador se encenderá automáticamente.



ENCENDER/APAGAR: presione el botón **C** por 3 segundos.

Estado del LED: presione el botón **C** por 1 segundo. El LED parpadeará dos veces.*

- * ●● Red móvil OK - GPS OK
- Sin red móvil - GPS OK
- Red móvil OK - Sin GPS
- Sin red móvil - Sin GPS

3

Descargue la aplicación Tractive GPS

Descargue la aplicación Tractive GPS desde la Apple App Store o Google Play Store. También puede visitar my.tractive.com para rastrear a su mascota.



4

Active su localizador Tractive GPS

Siga las instrucciones en la aplicación Tractive GPS o en my.tractive.com para activar su localizador. Encontrará el ID de 8 dígitos del localizador en la parte trasera de su dispositivo.

ABCDEFGH



5

Coloque su localizador Tractive GPS en el collar de su mascota

- a) Retire el collar de su mascota y proceda según el ancho del collar.
- b1) **Ancho del collar: 1,5 cm o menos** - pase el collar por los dos orificios rectangulares del clip de goma.
- b2) **Ancho del collar: 1,6 cm o más** - coloque el collar entre el clip de goma y el soporte.
- c) Una el clip de goma con el soporte. Ponga el localizador Tractive GPS en el soporte y asegúrese de que el dispositivo está totalmente fijo.

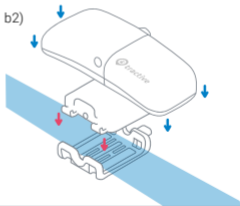
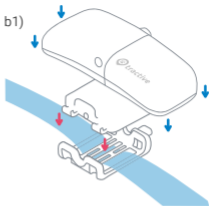

¡Y listo!

¡Feliz rastreo!

?

¿Necesita más información?

Visite [tractive.com/help](https://www.tractive.com/help)



Quick Start Guide

1 Recarregue seu rastreador Tractive GPS

Pressione os botões da parte superior e inferior do rastreador para remover a bateria. Insira a bateria no carregador incluso. O LED no carregador acenderá em vermelho enquanto a bateria estiver carregando. Quando a bateria estiver completamente carregada, a luz vermelha irá desaparecer.

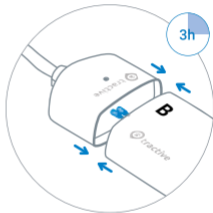
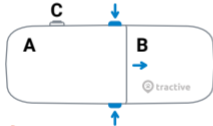

2

Ligue o rastreador Tractive GPS

Reconectar a bateria ao dispositivo ligará o rastreador automaticamente.

LIGAR/DESLIGAR: pressione o botão **C** por 3 segundos.

Estado do LED: pressione o botão **C** por 1 segundo. O LED piscará duas vezes.*



- * ●● Rede disponível - GPS disponível
- Rede indisponível - GPS disponível
- Rede disponível - Sem GPS
- Rede indisponível - Sem GPS

3

Baixe o aplicativo Tractive GPS

Baixe o aplicativo Tractive GPS pela Apple App Store ou pela Google Play Store. Você também pode visitar my.tractive.com para rastrear seu animal de estimação



4

Ative seu rastreador Tractive GPS

Siga as instruções no aplicativo Tractive GPS ou em my.tractive.com para ativar seu rastreador. O ID de 8 dígitos do rastreador está localizado na parte traseira do seu dispositivo.

ABCDEF GH



5

Coloque seu rastreador Tractive GPS na coleira do seu animal de estimação

- a) Retire a coleira do seu animal de estimação.
- b1) **Largura da coleira: 1.5cm ou menos** - Coloque a coleira por entre os dois buracos retangulares nas laterais do clipe de borracha.
- b2) **Largura da coleira: 1.6cm ou mais** - Posicione a coleira entre a presilha e o suporte para a coleira.
- c) Aperte a presilha contra o suporte para coleira. Prenda o rastreador Tractive GPS no suporte para coleira e verifique se o dispositivo está bem preso.

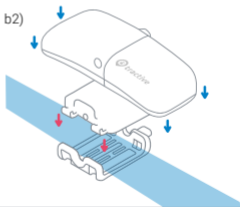
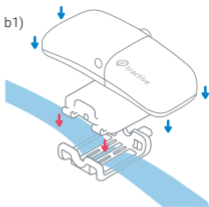

Tudo pronto para começar!
Bom rastreio!

?

Precisa de mais informações?
Visite [tractive.com/help](https://www.tractive.com/help)



Quick Start Guide

1

Oplad din Tractive GPS tracker

Tryk på knappen på toppen og i bunden af trackeren for at frigøre batteriet. Sæt batteriet i den medfølgende oplader. LED lampen lyser rødt når trackeren oplades. Når trackeren er fuldt opladet, slukker det røde lys.

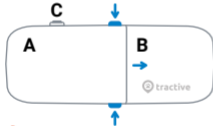

2

Tænd Tractive GPS trackeren

Når batteriet sættes fast på trackeren, tændes den automatisk.



TÆND/SLUK: Tryk på knap **C** i 3 sekunder.

LED status: Tryk på knap **C** i 1 sekund. LED blinker 2 gange.*

- * ●● Neværk tilgængeligt - GPS OK
- Intet netværk - GPS OK
- Neværk tilgængeligt - Ingen GPS
- Intet netværk - Ingen GPS

3

Download Tractive GPS appen

Download Tractive GPS appen fra Apple App Store eller fra Google Play Store. Du kan også besøge my.tractive.com for at tracke dit kæledyr.



4

Aktiver din Tractive GPS tracker

Følg instruktionerne i Tractive GPS appen eller på my.tractive.com for at aktivere din tracker. Det 8-cifrede Tracker-ID kan findes på bagsiden af trackeren.

ABCDEFGHIH



5

Sæt din GPS tracker på dit kæledyrs halsbånd

- Tag dit kæledyrs halsbånd af og følg vejledningen for bredden.
- Halsbåndsbredde: 1,5 cm eller mindre** - put halsbåndet igennem de to rektangulære huller på siden af gummi clipsen.
 - Halsbåndsbredde: 1,6 cm eller mere** - placer halsbåndet mellem gummi clipsen og holderen på enheden.
- Sæt gummi clipsen fast på holderen. Sæt Tractive GPS trackeren fast på holderen og sørg for at trackeren er helt sikret.

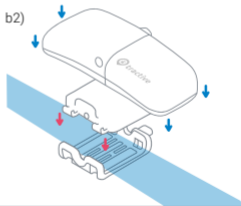
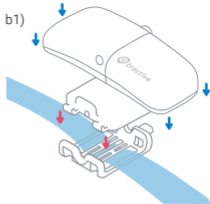

Du er nu klar!
Glædelig tracking!

?

Har du brug for hjælp?
 Besøg [tractive.com/help](https://www.tractive.com/help)



Quick Start Guide

1 Ladda din Tractive GPS-tracker

Tryck in knapparna på enhetens övre och undre samtidigt för att lossa batteriet. Ladda batteriet med den medföljande laddaren. LED-lampan lyser rött under tiden som enheten laddas. Den röda lampan slocknar när enheten är helt uppladdad.

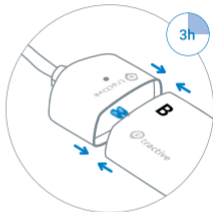
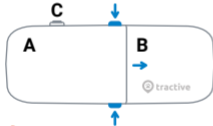

2

Slå på din Tractive GPS-tracker

När batteriet fästs på enheten så slås din tracker automatiskt på.



PÅ/AV: Tryck på knapp **C** i 3 sekunder.

LED-status: Tryck på knapp **C** i 1 sekund. LED blinkar två gånger.*

- * ●● Tillgängligt nätverk – GPS OK
- Inget nätverk – GPS OK
- Tillgängligt nätverk – Ingen GPS
- Inget nätverk – Ingen GPS

3

Ladda ner Tractive GPS-appen

Ladda ner Tractive GPS-appen från Apple App Store eller Google Play Store. Du kan också besöka my.tractive.com för att spåra ditt husdjur.



4

Aktivera din Tractive GPS-tracker

Följ anvisningarna i Tractive GPS-appen eller på my.tractive.com för att aktivera din tracker. Ditt 8-siffriga tracker-ID finns tryckt på baksidan av trackern.

ABCDEFGH



5

Fäst din GPS-tracker på ditt hundjurs halsband

- a) Ta av ditt hundjurs halsband och följ anvisningarna beroende på dess bredd.
- b1) **Halsband på 1,5 cm eller mindre** – för halsbandet genom de två rektangulära hålen på baksidan av gummihållaren.
- b2) **Halsband på 1,6 cm eller mer** – placera halsbandet mellan gummihållaren och infattningen på enheten.
- c) Fäst gummihållaren på enheten. Fäst din Tractive GPS-tracker på enheten och säkerställ att den sitter säkert.

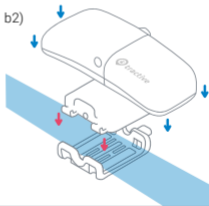
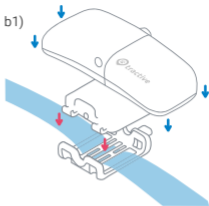

Du är nu redo!
Glad spårning!

?

Behöver du hjälp?

Besök [tractive.com/help](https://www.tractive.com/help)



Quick Start Guide

1

Lad opp din Tractive GPS enhet

Trykk på knappene på toppen og bunnen av trackeren for å ta bort batteriet. Sett batteriet i laderen. LED'en lyser rødt under lading. Lyset vil slukke når trackeren er fulladet.

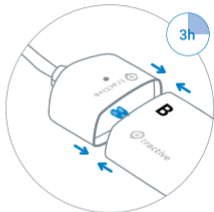
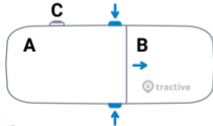

2

Slå på Tractive GPS trackeren

Trackeren slår på automatisk når batteriet er festet til enheten.



PÅ/AV: Trykk på knapp **C** i 3 sekunder.

LED-status: Trykk på knapp **C** i 1 sekund. LED blinker to ganger.*

- * ●● Nettverk tilgjengelig - GPS OK
- Ingen nettverk - GPS OK
- Nettverk tilgjengelig - Ingen GPS
- Ingen nettverk - Ingen GPS

3

Last ned Tractive GPS appen.

Last ned Tractive GPS appen fra Apple App Store eller fra Google PlayStore. Du kan også besøke my.tractive.com for å spore kjæledyret ditt.



4

Aktiver din Tractive GPS tracker

Følg instruksjonene i Tractive GPS appen eller på my.tractive.com for å aktivere din tracker. Det 8-sifret tracker-ID er trykt på baksiden av enheten.

ABCDEFGHIH



5

Fest GPS trackeren på kjæledyrets halsbånd

- a) Ta kjæledyrets halsbånd av og følg instruksjonene for bredde.
- b1) **Halsbåndsbredde: Med 1,5 cm eller mindre** skal halsbåndet gjennom de to rektangulære hull på siden av gummiholderen
- b2) **Halsbåndsbredde: Med 1,6 cm eller mere** skal halsbåndet plasseres mellom gummiholderen og holderen på enheten.
- c) Fest gummiholderen på enheten. Fest Tractive GPS trackeren på holderen og sørg for at den er sikret.

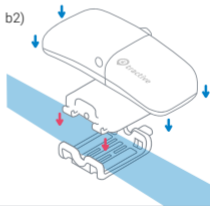
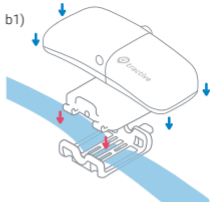

Nå er du klar!
God spring!

?

Trenger du hjelp?

Besøk [tractive.com/help](https://www.tractive.com/help)



Quick Start Guide



1

Lataa

Tractive GPS -laite

Irrota akku painamalla laitteen päällä ja alla olevia painikkeita. Liitä akku toimitukseen sisältyvään laturiin. Laturin merkkivalo muuttuu punaiseksi, kun akku latautuu. Kun akku on ladattu täyteen, punainen valo sammuu.

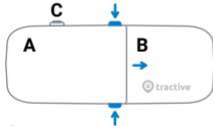

2

Käynnistä

Tractive GPS -laite

Laite käynnistyy automaattisesti, kun akku asetetaan takaisin paikalleen.

ON/OFF: paina painiketta **C** 3 sekuntia.

Merkkivalon tila: paina painiketta **C** 1 sekunti. Merkkivalo vilkkuu kahdesti.*



- * ●● Verkko ja GPS käytettävissä
- Ei verkkoa - GPS käytettävissä
- Verkko käytettävissä - ei GPS:ää
- Ei verkkoa eikä GPS:ää

3

Lataa

Tractive GPS -sovellus

Lataa Tractive GPS -sovellus Apple App Storesta tai Google Play -kaupasta. Voit seurata lemmikkiäsi myös osoitteessa my.tractive.com.



4

Aktivoi

Tractive GPS -laite

Aktivoi laite noudattamalla Tractive GPS -sovelluksen tai sivuston my.tractive.com ohjeita. 8-numeroinen Tracker ID on laitteen taustapuolella.

ABCDEFGH



5

Kiinnitä GPS-laite lemmikin pantaan

- a) Irrota lemmikin panta ja jatka pannan leveyden mukaan.
- b1) **Pannan leveys enintään 1,5 cm:** työnnä panta kumisoljen sivuissa olevista nelikulmaisista aukoista.
- b2) **Pannan leveys 1,6 cm tai enemmän:** Aseta panta kumisoljen ja pantapidikkeen väliin.
- c) Kiinnitä kumisolki pantapidikkeeseen. Kiinnitä Tractive GPS -laite pidikkeeseen ja varmista, että se pysyy tukevasti paikallaan.

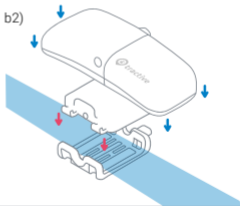
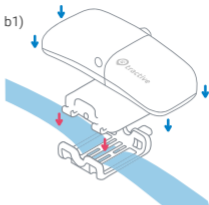

Valmis!

Mukavaa seuraamista!

?

Tarvitsetko apua?

Sivusto: [tractive.com/help](https://www.tractive.com/help)



Quick Start Guide

1

Laad uw Tractive GPS-apparaat op

Druk op de knoppen aan de boven- en onderkant van het apparaat om de batterij los te koppelen. Plaats de batterij in de bijgevoegde oplader. Het lampje op de oplader kleurt rood wanneer het apparaat wordt opgeladen. Wanneer het apparaat volledig is opgeladen verdwijnt het rode lampje.

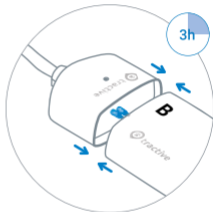
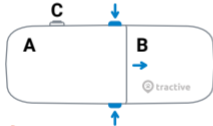

2

Schakel de Tractive GPS-tracker in

De tracker wordt automatisch ingeschakeld als de batterij in het apparaat wordt geplaatst.

AAN/UIT: Houd de knop **C** 3 sec. lang ingedrukt.

Lampstatus: houd de knop **C** 1 sec. lang ingedrukt. Het lampje knippert twee keer.*



- * ●● Netwerk beschikb. - gps beschikb.
- Geen netwerk - gps beschikb.
- Netwerk beschikb. - geen gps
- Geen netwerk - geen gps

3

Download de Tractive GPS-app

Download de Tractive GPS-app in de Apple App Store of de Google Play Store. U kunt uw huisdier ook volgen op my.tractive.com.



4

Activeer uw Tractive GPS-tracker

Volg de instructies in de Tractive GPS-app of op my.tractive.com om uw apparaat te activeren. De 8-cijferige tracker-ID vindt u op de achterzijde van de tracker.



ABCDEFGH



5

Bevestig de gps-tracker aan de halsband van uw huisdier

a) Verwijder de halsband van uw huisdier en volg de instructies op basis van de breedte van de halsband.

b1) **Halsbandbreedte 1,5 cm of minder:** haal de halsband door de twee rechthoekige openingen op de zijkanten van de rubberen klem.

b2) **Halsbandbreedte 1,6 cm of meer:** plaats de halsband tussen de rubberen klem en het opzetstuk.

c) Maak de rubberen klem vast aan het opzetstuk. Bevestig de Tractive GPS-tracker op het opzetstuk en zorg ervoor dat deze goed vast zit.

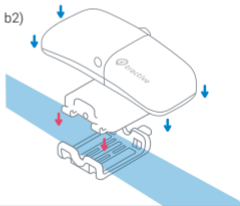
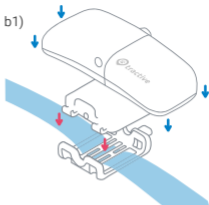

Klaar voor actie!
Happy Tracking!

?

Hulp nodig?

Ga naar [tractive.com/help](https://www.tractive.com/help)



Quick Start Guide

1

Dobijte

GPS tracker Tractive

Stisknutím tlačítek na horní a spodní straně trackeru odpojte baterii. Vložte baterii do příložené nabíječky. Když se baterie nabíjí, LED dioda na nabíječce svítí červeně. Když je baterie plně nabitá, LED dioda zhasne.

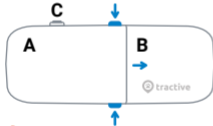

2

Zapněte

GPS tracker Tractive

Vložení baterie zpět do zařízení se tracker automaticky zapne.



ZAPNUTÍ/VYPNUTÍ: Stiskněte tlačítko **C** na 3 sekundy.

Stav pomocí LED diody: Stiskněte tlačítko **C** na 1 sekundu. LED dioda dvakrát blikne.*

- * ● ● Síť k dispozici – GPS k dispozici
- ● Žádná síť – GPS k dispozici
- ● Síť k dispozici – Žádná GPS
- ● Žádná síť – Žádná GPS

3

Stáhněte aplikaci

Tractive GPS

Stáhněte aplikaci Tractive GPS z obchodu App Store nebo Google Play. Svého mazlíčka můžete také sledovat na stránce my.tractive.com.



4

Aktivujte svůj

GPS tracker Tractive

Aktivujte svůj tracker podle pokynů v aplikaci Tractive GPS nebo na stránce my.tractive.com. Osmimístné ID trackeru najdete na zadní straně trackeru.



ABCDEFGH



5

Přípevněte GPS tracker k obojku svého mazlíčka

- Sundejte svému mazlíčkovi obojek a dále pokračujte podle šířky obojku.
- Šířka obojku: 1,5 cm nebo méně** – protáhněte obojek dvěma obdélníkovými otvory na stranách gumového klipu.
- Šířka obojku: 1,5 cm nebo více** – vložte obojek mezi gumový klip a úchytku na obojek.
- Přípevněte gumový klip k úchytce. Přípevněte GPS tracker Tractive k úchytce a ujistěte se, že je dobře přichycený.

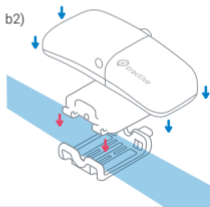
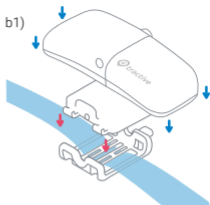

Jste připravení vyrazit!
**Příjemnou zábavu
 s vaším mazlíčkem!**

?

Potřebujete více informací?
 Navštivte [tractive.com/help](https://www.tractive.com/help)



Quick Start Guide

1

Nabite svoj Tractive GPS tracker

Ak chcete batériu odpojiť, stlačte tlačidlá na hornej a spodnej strane trackera. Batériu zapojte do dodanej nabíjačky. Počas nabíjania batérie sa kontrolka LED na nabíjačke rozsvieti načerveno. Akonáhle je batéria úplne nabitá, červené svetlo zmizne.

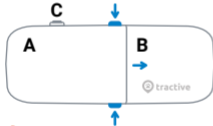

2

Zapnite Tractive GPS tracker

Vloženie batérie späť do zariadenia tracker automaticky zapne.



ON/OFF: Stlačte tlačidlo **C** na 3 sekundy.

Stav LED: Stlačte tlačidlo **C** na 1 sekundu. LED zabliká dvakrát.*

- * ● ● Sieť k dispozícii - GPS k dispozícii
- ● Žiadna sieť - GPS k dispozícii
- ● Sieť k dispozícii - Žiadna GPS
- ● Žiadna sieť - Žiadna GPS

3

Stiahnite si aplikáciu Tractive GPS

Stiahnite si aplikáciu Tractive GPS z obchodu Apple App Store alebo Google Play Store. Môžete tiež navštíviť my.tractive.com a sledovať svojho domáceho maznáčika.



4

Aktivujte si svoj Tractive GPS tracker

Sledujte pokyny pre aktiváciu v aplikácii Tractive GPS alebo na stránke my.tractive.com.

8-znakový identifikátor trackera nájdete na zadnej strane vášho trackera.



ABCDEFGH



5

Pripojte svoj GPS tracker k obojku vášho domáceho miláčika

- a) Zložte obojek svojho domáceho miláčika a pokračujte podľa šírky obojku.
- b1) **Šírka obojka: 1,5 cm alebo menej** - obojek položte cez dva obdĺžnikové otvory na stranách gumovej spony.
- b2) **Šírka obojka: 1,6 cm alebo viac** - obojek položte medzi gumovú sponu a držiak obojku.
- c) Gumovú sponu upevnite na držiak. Pripojte Tractive GPS tracker k držiaku a uistite sa, že tracker je plne zabezpečený.

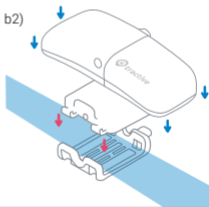
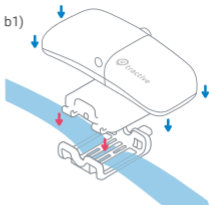

Ste pripravení ísť!
Šťastné sledovanie!

?

Potrebujete viac informácií?

Navštívte stránku [tractive.com/help](https://www.tractive.com/help)



Quick Start Guide

1

Töltse fel a Tractive GPS eszközt

Nyomja meg az eszköz tetején és alján található gombokat az akkumulátor cseréjéhez. Helyezze be az akkumulátort a mellékelt töltőbe. A LED pirosan fog égni töltés közben. A LED kialszik, ha az akkumulátor teljesen feltöltött.

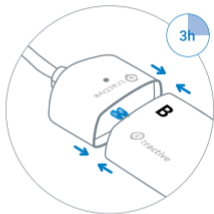
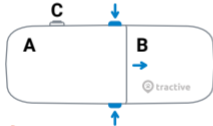

2

Kapcsolja be a Tractive GPS nyomkövetőt

Az akkumulátor csatlakoztatása az eszközhöz automatikusan bekapcsolja a nyomkövetőt.

BE/KI: Tartsa lenyomva az **C** gombot 3 másodpercig.

LED állapot: Tartsa lenyomva az **C** gombot 1 másodpercig. LED kétszer villan.*



- * ●● Hálózat elérhető - GPS elérhető
- Hálózat nincs - GPS elérhető
- Hálózat elérhető - GPS nincs
- Hálózat nincs - GPS nincs

3

Töltse le a Tractive GPS alkalmazást.

Töltse le a Tractive GPS alkalmazást az Apple App Store-ból vagy a Google Play aruházból. A my.tractive.com oldalon is követheti házi kedvencét.



4

Aktiválja a Tractive GPS eszközt

Kövesse a Tractive GPS alkalmazás vagy a my.tractive.com oldal utasításait az aktiváláshoz. A 8 jegyű számkód (Tracker ID) megtalálható az eszköz hátoldalán.

ABCDEFGH



5

Csatolja a GPS nyomkövetőt a házi kedvence nyakörvéhez

- a) Vegye le kedvence nyakörvét, majd folytassa a nyakörv szélessége szerint.
- b1) **Nyakörv szélessége: 1,5 cm vagy kevesebb** - vezesse át a nyakörvet a gumipánt szélén levő két négyzetletű lyukán.
- b2) **Nyakörv szélessége: 1,6 cm vagy több** - helyezze a nyakörvet a gumipánt és a nyakörvcsatlakoztató közé.
- c) Rögzítse a gumipántot a nyakörvcsatlakoztatóhoz. Csatolja a Tractive GPS nyomkövetőt a csatlakoztatóhoz, és bizonyosodjon meg, hogy a nyomkövető biztosan van rögzítve.

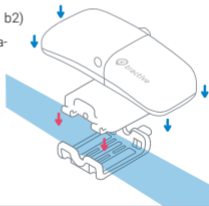
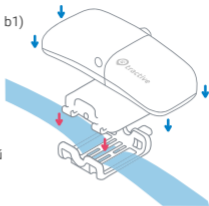

Indulásra készen áll!
Vidám nyomkövetést!

?

További információra van szüksége?

Látogasson el a [tractive.com/help](https://www.tractive.com/help) oldalra.



Quick Start Guide

1

Napunite Vaš Tractive GPS uređaj

Pritisnite tipke na vrhu i dnu uređaja kako biste odvojili bateriju. Spojite bateriju sa isporučеним punjačem. LED svjetlo na punjaču će svjetliti crveno dok se uređaj puni. Kada se uređaj potpuno napuni, crveno svjetlo će nestati.

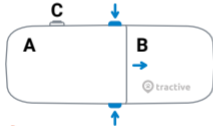

2

Upalite Tractive GPS uređaj

Tractive GPS uređaj će se automatski upaliti kada spojite bateriju sa uređajem.



UKLJ./ISKLJ.: Pritisnite dugme **C** za 3 sekunde.

Status LED svijetla: Pritisnite dugme **C** za 1 sekundu. LED svijetlo dvaput treperi.*

- * ● ● Mreža dostupna - GPS dostupan
- ● Nema mreže - GPS dostupan
- ● Mreža dostupna - Nema GPS
- ● Nema mreže - Nema GPS

3

Preuzmite aplikaciju Tractive GPS

Preuzmite aplikaciju Tractive GPS sa Apple App Store-a ili sa Google Play Store-a. Također možete posjetiti my.tractive.com kako bi pratili Vašeg ljubimca.



4

Aktivirajte Vaš Tractive GPS uređaj

Slijedite upute u aplikaciji Tractive GPS ili na my.tractive.com kako biste aktivirali uređaj. Osmoznakovni identifikator uređaja može se pronaći na stražnjoj strani uređaja.



ABCDEFGH



5

Pričvrstite Vaš GPS uređaj za ovratnicu Vašeg ljubimca

A) Skinite ovratnicu sa Vašeg ljubimca i nastavite u zavisnosti širine ovratnice.

B1) **Širina ovratnice: 1,5 cm ili manje** -
Provucite ovratnicu kroz dvije pravokutne rupice sa strane gumene spojnice.

B2) **Širina ovratnice: 1,6 cm ili više** -
Postavite ovratnicu između gumene spojnice i držača za ovratnicu.

C) Pričvrstite gumenu spojnicu sa držačem. Pričvrstite Tractive GPS uređaj za držač i osigurajte da je uređaj dobro pričvršćen.

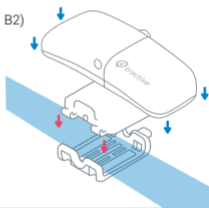
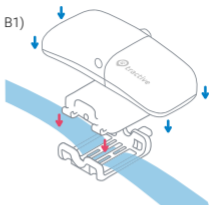

Spremni ste!
Sretno praćenje!

?

Trebate više informacija?

Posjetite [tractive.com/help](https://www.tractive.com/help)



Quick Start Guide

1

Naładuj lokalizator Tractive GPS

Naciśnij przyciski na górze i dole lokalizatora, aby odłączyć baterię. Podłącz baterię do dostarczonej ładowarki. Podczas ładowania dioda LED na ładowarce będzie świecić na czerwono. Po całkowitym naładowaniu baterii dioda przestanie świecić.

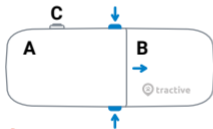

2

Włącz lokalizator Tractive GPS

Ponowne podłączenie baterii do urządzenia spowoduje automatyczne włączenie lokalizatora.

WŁ./WYL.: Naciśnij przycisk **C** na 3 sekundy.

Status LED: Naciśnij przycisk **C** na 1 sekundę. Dioda LED mignie dwukrotnie.*



- * ● ● Sieć dostępna – GPS dostępny
- ● Brak sieci – GPS dostępny
- ● Sieć dostępna – brak GPS
- ● Brak sieci – brak GPS

3

Pobierz aplikację Tractive GPS

Pobierz aplikację Tractive GPS ze sklepu Apple AppStore lub Google Play. Aby śledzić zwierzę, możesz również skorzystać z witryny my.tractive.com.



4

Aktywuj lokalizator Tractive GPS

Aby aktywować lokalizator, postępuj według instrukcji w aplikacji Tractive GPS lub w witrynie my.tractive.com. 8-cyfrowy identyfikator lokalizatora znajduje się z tyłu urządzenia.



ABCDEFGH



5

Umieść lokalizator GPS na obroży zwierzęcia

- a) Zdejmij zwierzęciu obrozę i kontynuuj czynności w zależności od jej szerokości.
- b1) **Obroża o szerokości do 1,5 cm** – przeciągnij obrozę przez dwa prostokątne otwory po bokach gumowej podkładki.
- b2) **Obroża o szerokości 1,6 cm lub więcej** – umieść obrozę między gumową podkładką a uchwytem.
- c) Przymocuj gumową podkładkę do uchwyty. Umieść lokalizator Tractive GPS w uchwycie i upewnij się, że jest solidnie przymocowany.

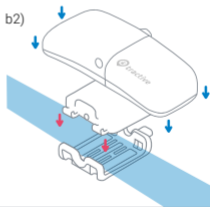
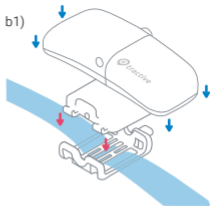

Wszystko gotowe!
Miłego lokalizowania!

?

Potrzebujesz więcej informacji?

Odwiedź witrynę [tractive.com/help](https://www.tractive.com/help)



Кратко ръководство за употреба

1 Заредете Вашия Tractive GPS тракер

Натиснете страничните бутони едновременно за да откачите батерията. Сложете батерия в предоставеното зарядно устройство. Светодиодът на зарядното устройство ще свети червено по време на зареждането. Когато батерията е напълно заредена червената светлина изгасва.

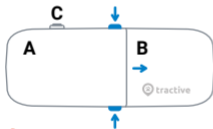

2

Включете

Tractive GPS тракера

Когато поставите батерията обратно на тракера, той се включва автоматично.

ВКЛ/ИЗКЛ: Натиснете бутон **C** за 3 секунди.

LED статус: Натиснете бутон **C** за 1 секунда. LED мига два пъти.*



- * ● ● Налична мрежа - наличен GPS
- ● Няма мрежа - наличен GPS
- ● Налична мрежа - няма GPS
- ● Няма мрежа - няма GPS

3

Изтеглете приложението
Tractive GPS

Изтеглете приложението Tractive GPS от Apple App Store или от Google Play Store. Също така може да посетите my.tractive.com за да следите домашния си любимец.



4

Активирайте Вашия
Tractive GPS тракер

Следвайте инструкциите в приложението Tractive GPS или на my.tractive.com за да активирате тракера.

8-цифрения идентификационен номер се намира на гърба на Вашия тракер.

ABCDEFGHIH



5

Прикрепете GPS тракера към нашийника на Вашия любимец

а) Свалете нашийника на Вашия любимец и следвайте инструкциите според ширината му.

б1) **Ширина до 1.5 см** - пхнете нашийника през двата правоъгълни отвора на гумената част от механизма за закрепване.

б2) **Ширина над 1.6 см** - поставете нашийника между пластмасовата и гумената част на закрепващия механизъм.

с) Закачете гумената част към пластмасовата част на закрепващия механизъм. Закрепете Tractive GPS тракера към закрепващия механизъм и се убедете, че тракера е закачен добре.

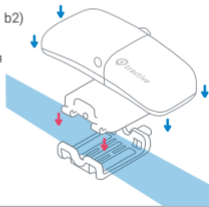
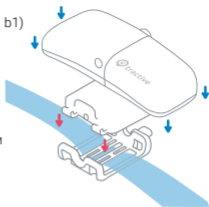

Хайде да тръгваме!
Приятно следене!

?

Нужна Ви е повече информация?

Посетете [tractive.com/help](https://www.tractive.com/help)



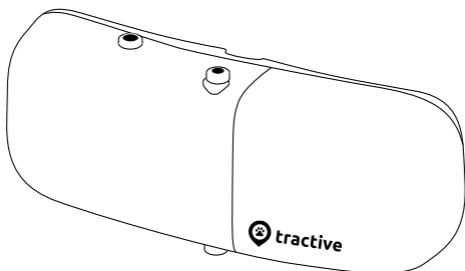

Tractive GPS

SAFETY INFORMATION

EN

TRACTIVE GPS SAFETY INFORMATION

ELECTROMAGNETIC COMPATIBILITY

Very strong magnetic fields (e.g. transformers) should always be avoided as they may result in variations in the transmission. Failure to follow these instructions may lead to malfunctions or damage to your Tractive GPS device.

RISKS FOR CHILDREN AND PEOPLE IN NEED OF CARE

The use of this device is not intended for people (including children) with limited physical, sensory or mental abilities or lack of experience and/or lack of knowledge, unless they are supervised by a person responsible for their safety or have been instructed on the use of the device.

Note: Some countries, states or regions have laws related to location based tracking of people, animals and objects. It's the sole responsibility of the owner and user to abide by the law and rules in the area the Tractive GPS device is used. Please switch off the Tractive GPS tracker before boarding a plane.

SAFETY ADVICE

Important: Although the Tractive GPS device is small in size, it might be too large or heavy for small or injured pets. If you are unsure whether you can use this device with your pet, we highly recommend consulting a pet doctor or veterinarian.

BATTERY OPERATION

Your Tractive GPS tracker is operated by a rechargeable lithium-ion polymer battery. Below you will find some advice on the use of rechargeable batteries:

- The battery of the Tractive GPS is replaceable and should only be replaced with other Tractive GPS batteries. However, the built-in battery cell must not be removed.
- Batteries may not be disassembled, thrown into fire or short-circuited.
- Do not carry or store the battery together with metal objects that may short-circuit the positive and negative terminals of the battery.
- Never expose the Tractive GPS device to excessive heat such as sunshine, fire or the like.
- Do not charge the battery near a heat source or in direct sunlight.
- Keep the battery away from water.
- Do not drive metal objects into the battery, hit it with a hammer, or damage and crush it otherwise.
- If a battery leaks, avoid direct contact with the liquid and safely dispose of the battery.
- Keep batteries away from children and pets to prevent them from being swallowed. Swallowing may lead to burns, perforation of soft tissue, and death. Severe burns can occur within 2h of ingestion. In case of ingestion of a cell or battery, seek medical or vet assistance promptly.
- If the battery overheats or deforms during charging or use with the device, immediately remove it from the device or charger and do not use it again.
- In case the battery shows any signs of wear (scratches, bitemarks, etc.), dispose the battery and do not use it again.
- Only use the USB cable that came with your Tractive GPS device. The use of other cables might overcharge the battery and can lead to fire or explosion.

Disregarding these instructions can cause damage and possibly even cause the battery to explode.

DISPOSAL

Batteries are hazardous waste. For the correct disposal of batteries, appropriate containers are provided at the premises of commercial battery dealers as well as local council waste disposal facilities. If you want to dispose of your Tractive GPS device, follow the current local provisions at the time. Information may be obtained from the local council waste disposal facility.

DECLARATION OF CONFORMITY

Directive 2014/53/EU:

Short text of the Declaration of conformity:
Tractive GmbH hereby declares that the Tractive GPS device conforms to the fundamental requirements and other relevant provisions of directive 2014/53/EU.

The full text of the Declaration of Conformity can be viewed on our website: tractive.com/doc

Technical Information

Function	Operation Frequency	Max. RF Output Power
GPRS 900	TX: 880MHz - 915MHz RX: 925MHz - 960MHz	33 dBm
GPRS 1800	TX: 1710MHz - 1785MHz RX: 1805MHz - 1880MHz	30 dBm
ISM	TX/RX: 2402MHz - 2480MHz	20 dBm
GPS	RX: 1575.42 MHz	

