

Trust



www.trust.com/23184/faq

QLIDE | Wireless
Qi Charger
RGB Mousepad

1.

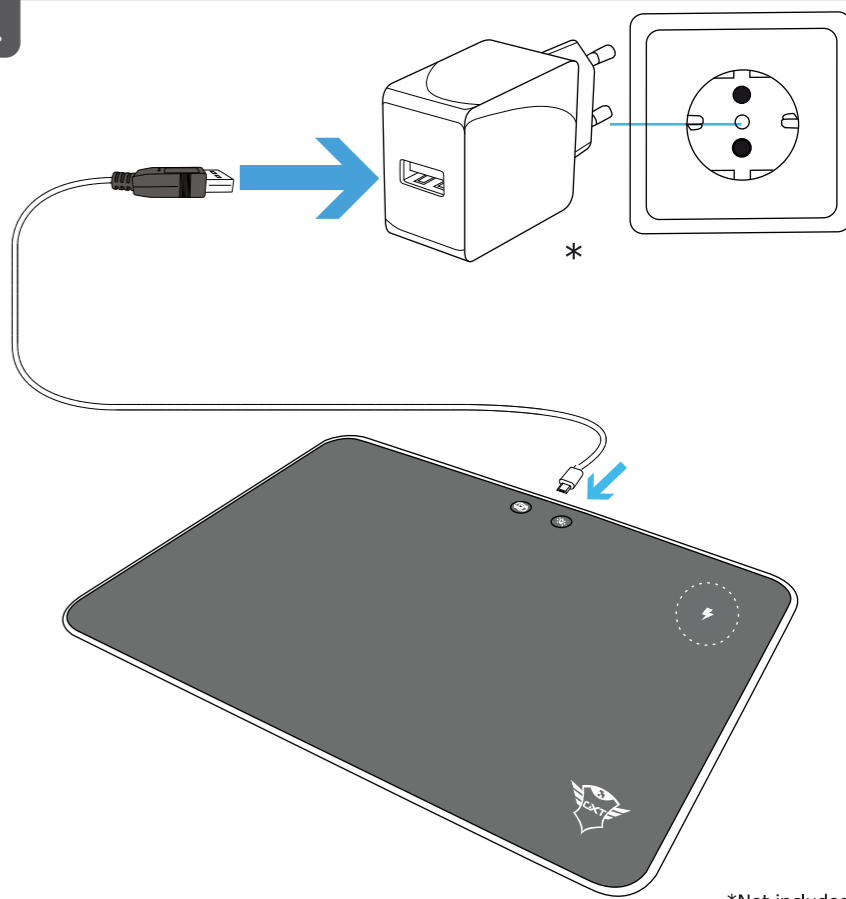

2.

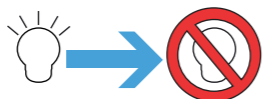
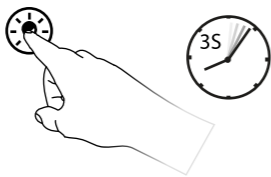
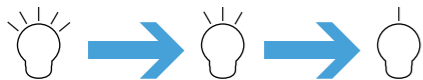
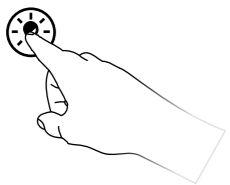
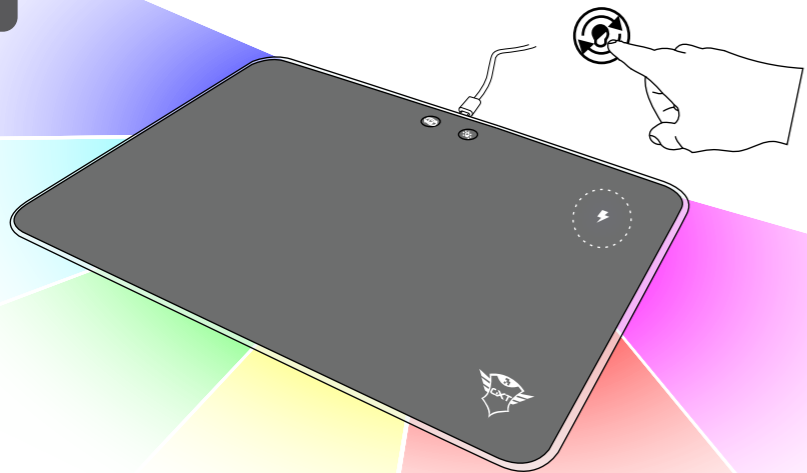

3.

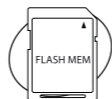
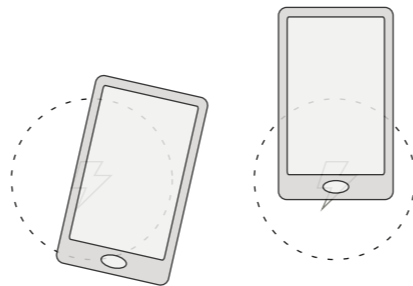
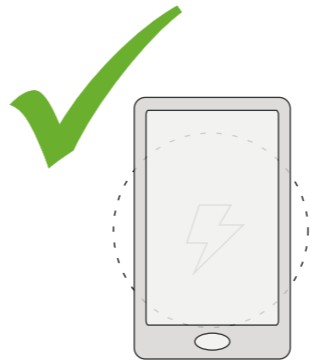

4.

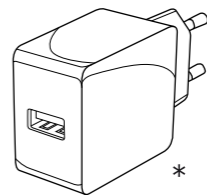
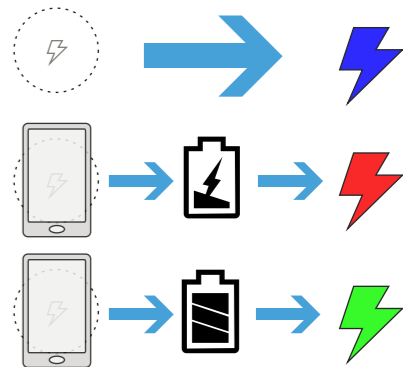
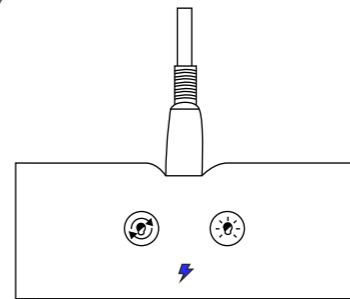

Qualcomm quick charge 3.0



10W / 7.5W

USB



5W

Qualcomm is a trademark of Qualcomm Incorporated, registered in the United States and other countries. Quick Charge is a trademark of Qualcomm Incorporated. All Qualcomm Incorporated trademarks are used with permission. Qualcomm Quick Charge is a product of Qualcomm Technologies, Inc. and/or its subsidiaries.

*Not included