

4

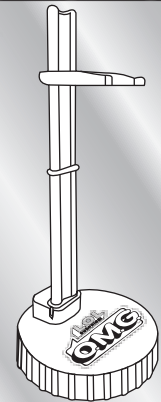

4A

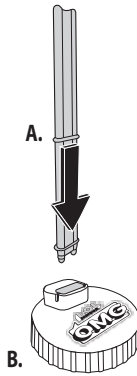

4B

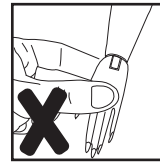
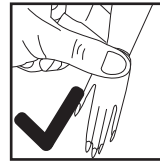
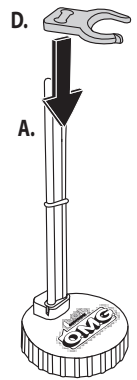

**TIP:** When removing the hands to dress doll, pinch the wrists' joints and gently pull. **DO NOT PULL FROM THE FINGERS.**

IMPORTANT INFORMATION

- Illustrations are for reference only. Styles may vary from actual contents.
- Please keep this manual as it contains important information.
- Doll stand can be both a stand and a chair.
- The seat (C) is stored under the base (B).
- For added support when doll is sitting, add the c-clip (D).

www.LOLsurprise.com  
©2020 MGA Entertainment, Inc.  
L.O.L. SURPRISE!™ and L.O.L. SURPRISE! O.M.G.™ are trademarks of MGA in the U.S. and other countries. All logos, names, characters, likenesses, images, slogans, and packaging appearance are the property of MGA.

**MGA Entertainment**  
9220 Winnetka Ave,  
Chatsworth, CA 91311,  
U.S.A.  
(800) 222-4685

**MGA Entertainment UK Ltd.**  
50 Presley Way Crownhill  
Milton Keynes, MK8 0ES  
Bucks, UK  
+ 0800 521 558

**MGA Entertainment (Netherlands) B.V.**  
Klipperaak 201, 2411 ND Bodegraven, NL  
Tel: +31 (0) 172-758 038  
E-mail: klantenservice@mgae.com

**Imported by MGA Entertainment Australia Pty Ltd**  
Suite 2.02, 32 Delhi Road  
Macquarie Park NSW 2113  
1300 059 676

The preferred method of contact for Customer Service is through our e-mail contact form at [www.mgae.com](http://www.mgae.com)



Printed in China  
0120-0-E/INT



570165 / 567202 / 567219 / 567196

AGES 3+  
ADULT SUPERVISION REQUIRED

**WARNING:**  
CHOKING HAZARD—Small parts.  
Not for children under 3 years.

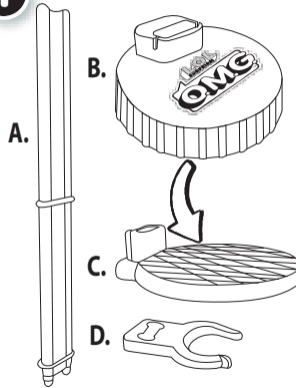
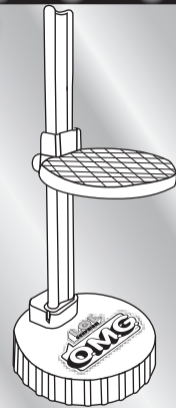
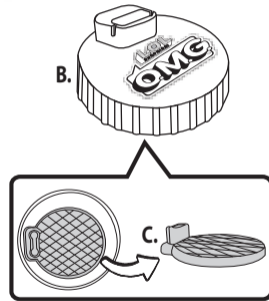
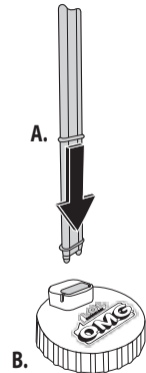
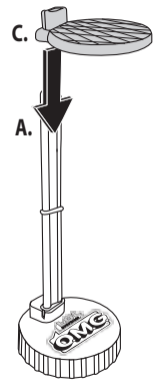
**1****2****2A****2B****2C****3**