

THANK YOU FOR PURCHASING THIS PRODUCT!

Please read this instruction carefully and keep it for future use!
Please always include the instructions when handing on the product to a third party.
This product must be assembled by an adult. This product is designed for industrial use. The use of the product requires specific skills and knowledge to be able to avoid injuries due to crashes and collisions.

TECHNICAL SPECIFICATIONS

Item: decoder SCOOTER (Wheel size: 200 mm)

Item Number: SA-101, SA-102, SA-202, without suspension, SA-301B, SA-301P, front suspension,

SA-401, double suspension/ front and back suspension

Products Size: SA-101: Height 710mm-830mm Deck size 400mmX100mm

SA-202: Height 720mm-900mm Deck size 510mmX120mm

SA-301: Height 700mm-900mm Deck size 510mmX120mm

SA-401: Height 900mm-1035mm Deck size 465mmX135mm

Deck approx. 46.5 x 13.5 cm

Weight: SA-101: 2.7kgs SA-202: 3.7kgs SA-301: 3.87kgs SA-401: 5.5kgs

Maximum user weight: 50-100kg

If you have assembly problems or would like further information on the product, please contact us

CONTENTS

- 1 X Scooter
- 1 X Instruction manual
- 1 X Tool Kit

SAFETY CAUTIONS

Warnings! Protective equipment should be worn always. Not to used in traffic. 100 kg max.

- The scooter is only intended for use by one person and supervised by adult
- Only use it on surfaces that are suitable for it, i.e. those which are flat, clean, dry, and use the scooter where possible away from other road users. Avoid sloping ground. The brakes may become hot after the scooter has been used a while! Don't touch until cooled down.
- Always be considerate of others.
- Wear suitable protective equipment for your own safety. Never use the scooter without a helmet and hand/wrist, elbow and knee pads. Never use the scooter without shoes!
- Before begin- Ensure that all fasteners and locking parts are intact and tight, e.g. the folding mechanism and the height setting of the handlebar. The functions of self-securing screw threads can be impaired after repeated loosening and tightening of the connecting elements. Check especially for the correct alignment and fastening of the steering set-up.
- Make sure that the foot stand is folded rightly while driving.
- Do not use the scooter at twilight, at night or in poor visibility.
- Off road use only. Do not use it on roads, thorough fares & slopes or hills. Avoid being in the proximity of stairs and open water.
- The scooter is not suitable for jumps.

The scooter is not a vehicle in the sense of the road traffic regulations! It is intended for use on footpaths.

PARTS DIAGRAM



EN

ASSEMBLY INSTRUCTIONS

No tools are required to assemble the product. The tools attached is for maintenance use only.
The scooter is delivered in its transport form (folded)!



PLEASE PROCEED STEPS AS FOLLOWS TO GET THE SCOOTER READY

Step 1 Pull the level of quick release NO. 1 away the deck (Picture 2)

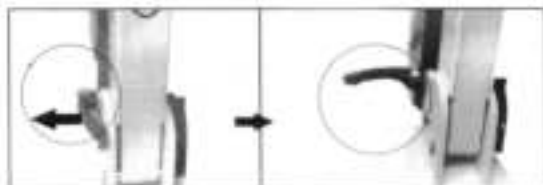

Step 2 Press the level of folding mechanism lock to loosen the transportation lock. Push the the handlebar stem until you hear it click into place. (Picture 3)



Step 3. Fasten the quick release NO. 1 (Picture 4)



Step 4: Insert the handlebar grips into the T-section of the handlebar stem. Use thumbs to press down both locking buttons until the grips can be easily pushed into the T-section. Turn the handlebar grips until the locking buttons are positioned in the two openings and hear them click into place. (Picture 5)



Step 5. Loosen the quick release NO. 2 lock on the handlebar stem by pushing the lever of the quick release lock until the lever is parallel to the handlebar grip. The handlebars can be locked into place at 3 different heights. Please adjust the height to required height. The maximum height is 103.5 cm, and cannot be exceeded due to the integrated lock. If the handlebar does not sit firmly at the required height, open the quick release lock again (Picture 6)



Always check all parts before use to ensure they are fitting tightly, particularly the folding mechanism, the handlebar locking and the wheels.

FOLDING INSTRUCTIONS

PLEASE PROCEED STEPS AS FOLLOWS FOLD THE SCOOTER

Step 1 Loosen the quick release lock NO. 2 by posting the lever away from the handle bar stem

press the locking button so that the handlebar rod can be moved
 Push the T-Section as far as it will go into the handlebar stem.
 Close the quick release lock by pushing the lever down to the handlebar stem (Picture7)

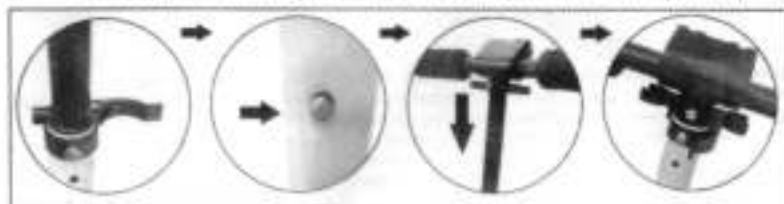

Step2: Use your thumbs to press both locking buttons in the handlebar grips and pull the handlebar grips outwards until they are released completely from the T-section.
 Hang the handle bar grips into bracket properly (Picture8),

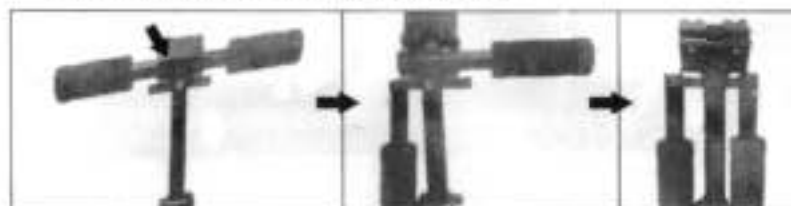

Step3: Pull the lever of quick release NO. 1 away the deck.
 Press level of folding mechanism towards ground in order to loosen the folding lock.
 Fold up the scooter by moving the handlebar stem towards the rear wheel until you hear transport lock click into place.
 Fasten the quick release NO.1. (Picture9)

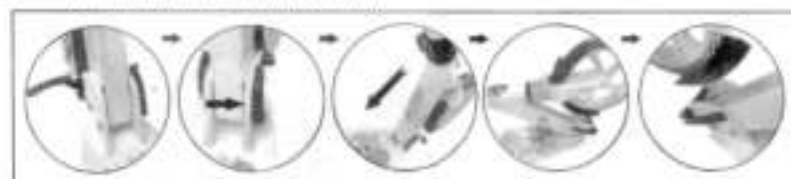

EN

RECOMMENDATIONS FOR USE

Before each use, make sure each component in good condition.
 The scooter moves when a foot is used to regularly push off, just as children's scooters.
 Braking is easy to use - simply step on the friction brake over the rear wheel.
 We recommend folding the scooter by hand after each use or using the stand, Aluminium is a good and light material but should also be handled carefully as it is not as hard as steel, for example.

MAINTENANCE AND STORAGE

Use a dry or damp cloth only to clean the product; do not use special cleaning agents!
 Check the product for damage or traces of wear and tear before and after each use.

Do not make any structural changes. For your own safety, please use original spare parts only.
 Store the product in a safe place where it is protected from the elements, cannot be damaged, and cannot injure anyone.

WHEEL CHANGE

Replacement wheels are available as accessories from SERVICE and should be replaced when they are worn down. To change the wheels, loosen the axle fitting with two size 05 Allen keys and take the wheels off the axle. A screwdriver or Allen key can be used to push the bearings out of the wheel to use them in the new wheel. However, it is usually advisable to change the bearings when the wheels are changed. Put the bearings into the new wheel with the bolt spacer and mount them to the frame with the axle screws. Make sure the axle has been screwed on tightly before starting again!

BEARINGS

Your scooter is equipped with precision ball bearings which were filled with lubricant on at high pressure during manufacture. For this reason, the wheels only run easily and quickly when there is a load on the scooter. The bearings are maintenance free. If a bearing fail, it should be replaced completely.

DISPOSAL

At the end of the product's life, please dispose of it at an appropriate collection point.

SPARE PARTS AND ORIGINAL ACCESSORIES AVAILABLE AT: