

SENA

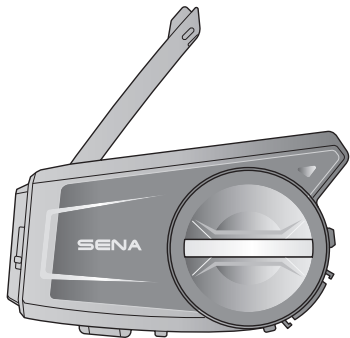

SOC

MOTORCYCLE CAMERA &
COMMUNICATION SYSTEM
WITH MESH INTERCOM™

— SOUND BY —
harman/kardon®

QUICK START GUIDE

ENGLISH / 1.1.1

Downloadable Sena Software

Download the **SENA MOTORCYCLES App** at **Google Play Store** or **App Store**.



SENA MOTORCYCLES

- Device configuration setting

Download the **Sena Camera App** at **Google Play Store** or **App Store**.



Sena Camera

- Live preview, video setting

Download the following items at **sena.com**.



Firmware



Sena Device Manager

- Firmware upgrade
- Device configuration setting



Quick Start Guide, User's Guide

Follow us on Facebook, YouTube, Twitter and Instagram to check the latest information and helpful tips.

SENA

SENA Technologies, Inc.

Customer Support: sena.com



Product Details

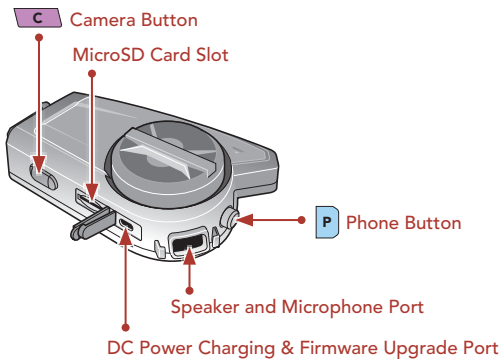
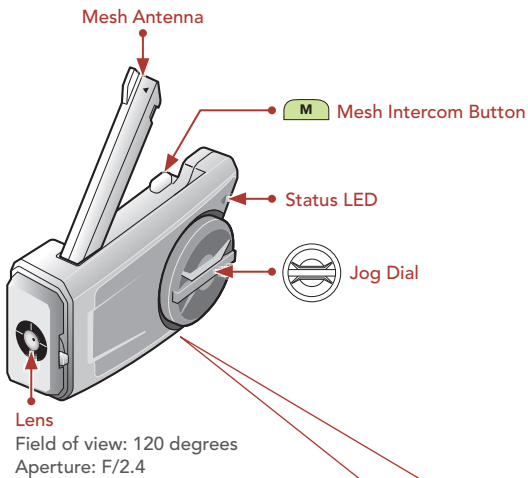

■ Installation

- For more information about installation, refer to the User's Guide.

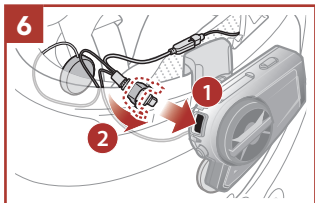
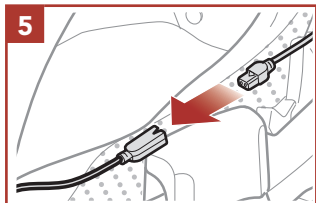
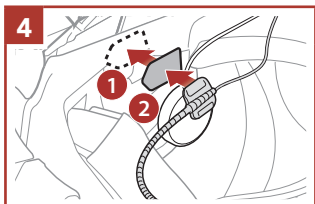
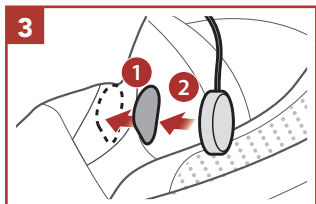
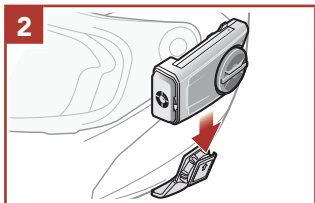
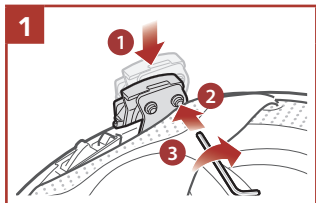

Mesh Intercom Antenna

Pull the Mesh Intercom Antenna inwards slightly to unfold it.

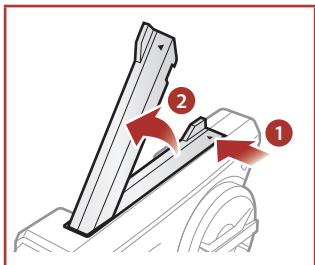

Icon Legend

TAP 1x Tap button/Jog Dial the specified number of times

HOLD 10s Press and Hold button/Jog Dial for the specified amount of time

ROTATE L **ROTATE R** **ROTATE** Rotate Jog Dial clockwise (right) or counterclockwise (left).

ROTATE L **ROTATE R** **ROTATE** Rotate while Pressing Jog Dial clockwise (right) or counterclockwise (left).



"Hello"

Audible prompt

Basic Operations

Powering On

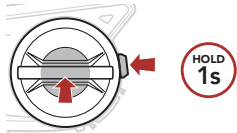

Powering Off

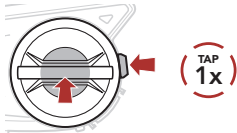

Volume Up

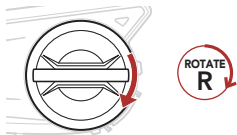

Volume Down



Checking the Battery Level

Powering On



■ Phone Pairing



- ② Select **50C** in the list of Bluetooth devices detected.

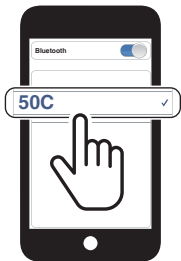

- For more information on phone pairing, refer to the User's Guide.

Using the Phone

Answer a Call

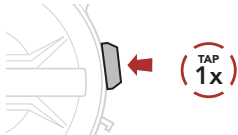

End a Call

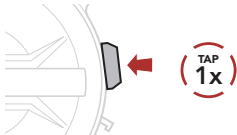

Reject a Call

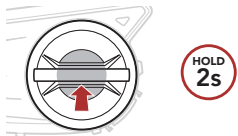

Siri and Google Assistant

Activate the Siri or Google Assistant Installed on Your Phone



"Hey Google"
or "Hey Siri"

or

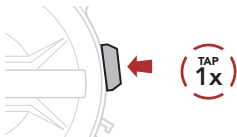

Music Control

Play/Pause



Track Forward

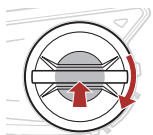

Track Backward

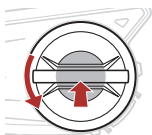

Camera Controls

Camera On

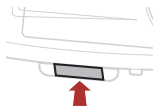

"Camera on"

Camera Off

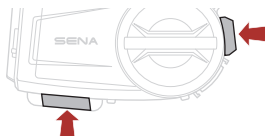

"Camera off"

Start Recording

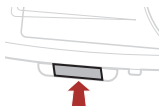



Blinking twice 

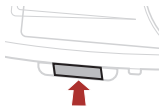

"Recording"

Stop Recording



Blinking twice 



"[Shutter sound]"

Take Photos

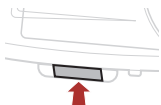

Blinking per shot 



"[Shutter sound]"

Format SD Card

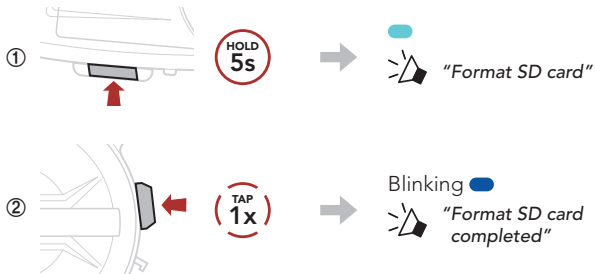

Note:

- If the **video resolution** is **2160p/30fps**, you cannot **take a photo** during video recording.
- You cannot record videos without a microSD card.
- Your **microSD card** needs to be formatted before using the camera.
- **MicroSD cards** up to **128 GB** and **U3** or higher cards are compatible.

Change Wi-Fi Channel (Default: 5 GHz)

①



② Select 5 GHz or 2.4 GHz.

- 5 GHz:



- 2.4 GHz:



Note: IF YOUR SMARTPHONE OR REGION DOES NOT SUPPORT 5 GHZ, YOU MUST CHANGE THE WI-FI CHANNEL TO 2.4 GHZ.

■ Mesh Intercom™

Open Mesh™: communication within the same channel.

Group Mesh™: communication within the same private group.

- For more information on **Mesh Intercom**, refer to the User's Guide.

Mesh Intercom On

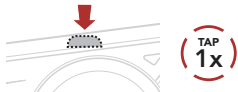

Blinking 



*"Mesh intercom on,
Open Mesh, channel 1"*

Mesh Intercom Off

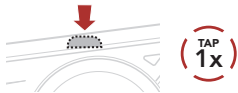

"Mesh intercom off"

Note: When **Mesh Intercom** is on, the **50C** will automatically connect to nearby **50C** users and the headset will be in **Open Mesh** (default: channel 1) initially.

Open Mesh

Channel Setting (Default: channel 1) in Open Mesh

- ① Enter into the **Channel Setting**.



- ② Navigate between channels.
(1 → 2 → ●●● → 8 → 9 → Exit → 1 → ●●●)

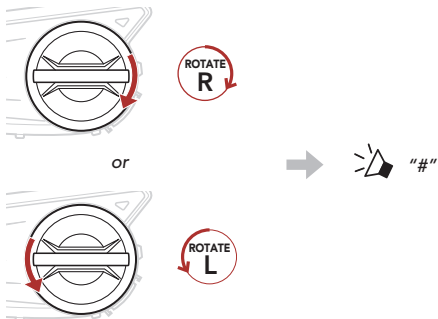

- ③ Save the channel.



Note: You can use the **SENA MOTORCYCLES App** to change the channel.

Group Mesh

Group Mesh is a closed group intercom function that allows users to join, leave, or rejoin a group intercom conversation without pairing each headset.

1) Creating a Group Mesh

Creating a **Group Mesh** requires **two or more Open Mesh users**.

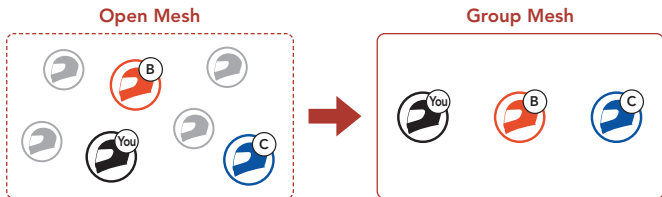

- ① **Users (You, B, and C)** enter into **Mesh Grouping** to create a **Group Mesh**.



- ② When **Mesh Grouping** is completed, the **users (You, B and C)** will hear a voice prompt on their headset as **Open Mesh** switches to **Group Mesh**.



2) Joining an Existing Group Mesh

One of the **current users** in an **Existing Group Mesh** can allow **new users (one or more)** in **Open Mesh** to join the **Existing Group Mesh**.

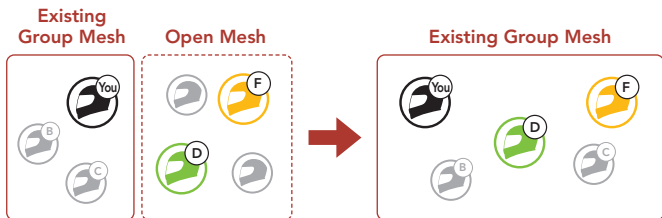

- ① One (**You**) of the **current users** in the **Existing Group Mesh** and **new users (D and F)** in **Open Mesh** enter into **Mesh Grouping** to join the **Existing Group Mesh**.



- ② When **Mesh Grouping** is completed, the **new users (D and F)** will hear a voice prompt on their headset as **Open Mesh** switches to **Group Mesh**.



■ Enable/Disable Mic (Default: Enable)

Users can enable/disable the microphone when communicating in a **Mesh Intercom**.



■ Reset Mesh

If a headset in an **Open Mesh** or **Group Mesh** resets the **Mesh**, it will automatically return to **Open Mesh (default: channel 1)**.



Bluetooth Intercom

Up to three other people can be paired with the headset for Bluetooth intercom conversations.

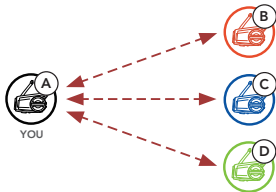



Intercom Pairing

There are two ways to pair the headset.

Using the Smart Intercom Pairing (SIP)

SIP allows you to quickly pair with your friends for intercom communication by scanning the QR code on the **SENA MOTORCYCLES App** without remembering the button operation.

- ① Pair the mobile phone with the headset.
- ② Open the **SENA MOTORCYCLES App** and tap  (**Smart Intercom Pairing Menu**).

- ③ Scan the **QR code** displayed on your friend **(B)**'s mobile phone.
- Your friend **(B)** can display the QR code on the mobile phone by tapping  > **QR code** () on the **SENA MOTORCYCLES App**.



- ④ Tap **Save** and check that your friend **(B)** is paired with **you (A)** correctly.
- ⑤ Tap **Scan** () and repeat steps 3-4 to pair with **Intercom Friends (C)** and **(D)**.

Note: The **Smart Intercom Pairing (SIP)** is not compatible with Sena products that use **Bluetooth 3.0** or **below**.

Using the Button



- ① The **users (You, B)** enter into **Intercom Pairing**.

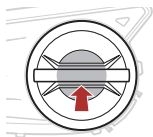

Blinking 
 "Intercom pairing"

- ② The **users' headsets** will be automatically paired.

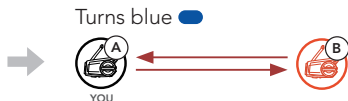

- ③ Repeat the steps above to pair with **other headsets (C and D)**.

■ Last-Come, First-Served

If a headset has multiple paired headsets for intercom conversations, the last paired headset is set as the first intercom friend.

Intercom Pairing Order

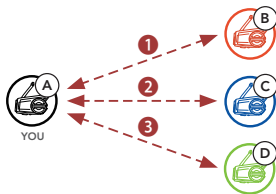

Last-Come, First-Served



Two-way Intercom

Start/End Conversation with the First Intercom Friend D

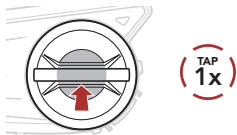

Start/End Conversation with the Second Intercom Friend C

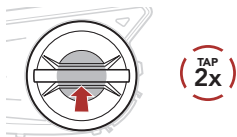

Start/End Conversation with the Third Intercom Friend B

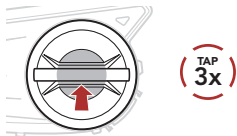

FM Radio

FM Radio On/Off

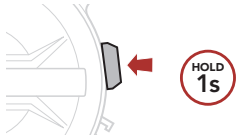

Start/Stop Scanning

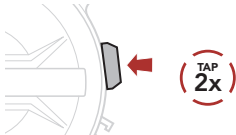

Seek Forward

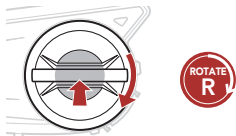

Seek Backward

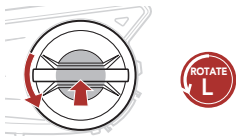

Navigating Preset Stations

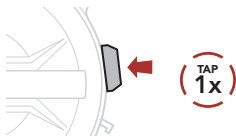

Note: You can save current station from the **Sena Device Manager** or the **SENA MOTORCYCLES App**.

Headset Configuration Menu

Accessing the Configuration Menu



Navigating Between Menu Options



Execute Menu Options

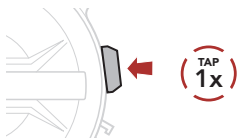

Troubleshooting

Fault Reset

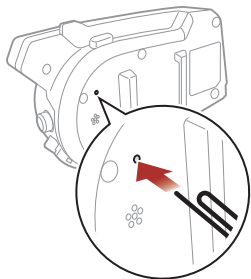





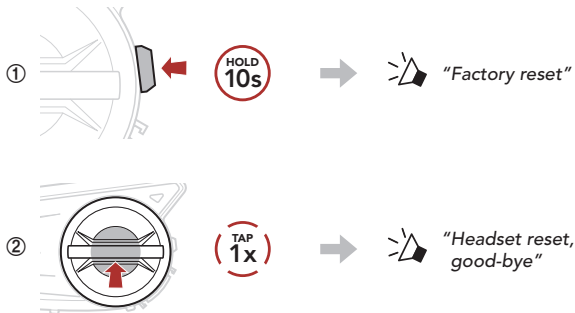















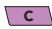

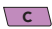





















Note: Fault Reset will not restore the headset to the factory default settings.













Factory Reset

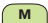

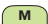
Quick Reference

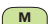
TYPE	OPERATION	BUTTON COMMANDS
 Basic Operations	Power on / Power off	     
	Volume up / Volume down	  or 
 Camera	Camera On	 
	Camera Off	  
	Start/Stop recording	 
	Taking Photos	 
 Mobile Phone	Answer phone call	 
	End phone call	 
	Reject phone call	 

TYPE	OPERATION	BUTTON COMMANDS
 Siri and Google Assistant	Activate the Siri or Google Assistant	 
 Music	Play/Pause music	 
	Track forward	 
	Track backward	 
 FM Radio	FM radio on/off	 
	Select preset	 
	Seek forward/backward	  or 
	Scan up FM band/stop scanning	 

TYPE	OPERATION	BUTTON COMMANDS
 Mesh Intercom™	Mesh Intercom on/off	 
	Channel setting	 
	Mesh Grouping	 
	Reset Mesh	 
	Enable/Disable Mic	 
 Intercom	Intercom pairing	 
	Start/End intercom	