

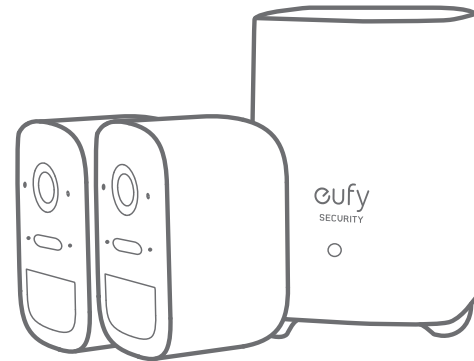

# QUICK START GUIDE

EUFYCAM 2C  
WIRE-FREE HD SECURITY CAMERA SET



Anker Innovations Limited. All rights reserved. eufy Security and eufy Security Logo are trademarks of Anker Innovations Limited, registered in the United States and other countries. All other trademarks are the property of their respective owners.

51005001817 V01

English	01
Deutsch	13
Español	23
Français	33
Italiano	43
Nederlands	53
Portuguese	63
العربية	73

# TABLE OF CONTENTS

Getting started	<b>02</b>	<b>06</b>	Mounting the camera
Product overview	<b>03</b>	<b>10</b>	Charging eufycam 2c
Connecting the homebase 2	<b>04</b>	<b>11</b>	Safety statement
Setting up the system	<b>05</b>		

# GETTING STARTED

## For HomeBase 2 installation



HomeBase 2  
(T8010)

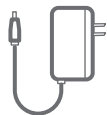

Power Adapter  
for HomeBase 2



Ethernet  
Cable



Metal Pin  
for Resetting

## For eufyCam 2C installation



eufyCam 2C  
(T8113)



Micro-USB  
Charging Cable



Mounting  
Bracket



Mounting Screws  
and Anchors

1. Camera quantity and accessories vary by bundle package.  
2. HomeBase 2 power adapter varies by region.

# 2 / PRODUCT OVERVIEW

## HomeBase 2

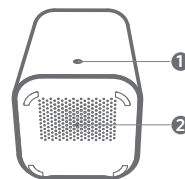

1. Status LED
2. Speaker

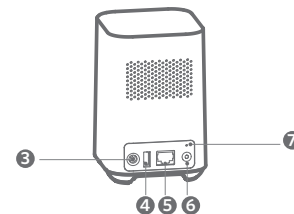

3. Power port
4. USB port
5. Ethernet port
6. SYNC/ALARM OFF button
7. Reset button

## eufyCam 2C

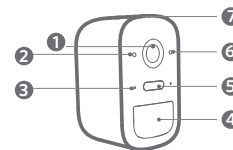

1. Lens
2. Light sensor
3. Microphone
4. Motion sensor
5. Spotlight
6. Status LED
7. SYNC button

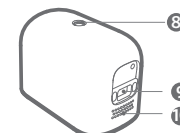

8. Mounting hole
9. Charging port
10. Speaker

# 3 / CONNECTING THE HOMEBASE 2

## Connect the HomeBase 2 to the Internet

1. Power on the HomeBase 2, then use the ethernet cable provided to connect the HomeBase 2 to your home router.

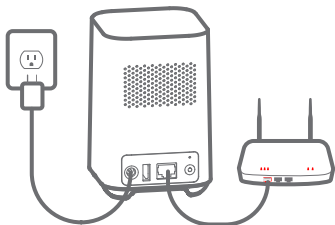

2. The LED indicator turns blue (this may take up to 1min) when HomeBase 2 is ready for setup.

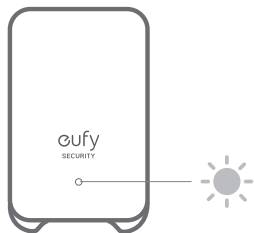

# 4 / SETTING UP THE SYSTEM

## Download the App and Set up the System

Download the Eufy Security app from the App Store (iOS devices) or Google Play (Android devices).



Sign up for a Eufy Security account, then follow the onscreen instructions to complete the setup.

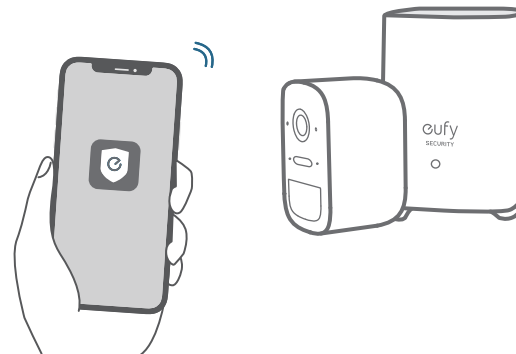

# 5 / MOUNTING THE CAMERA

## Find a Good Mounting Spot

To find a spot to mount eufyCam 2C, you need to test wireless signal strength.

- ① Open the Eufy Security app, go to Camera Settings > Mounting Guide.
- ② To test the wireless signal strength, take your camera and phone to the location where you want to mount the camera.
- ③ Move the camera as close to the HomeBase 2 as possible if the wireless.

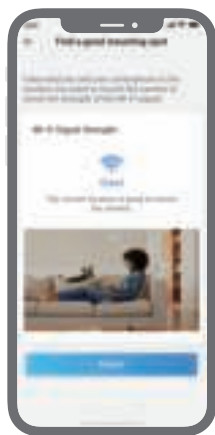

## Select Height and Location

Hang eufyCam 2C 7-10 ft (2-3 m) above the ground. This height maximizes the detection range of the motion sensor of eufyCam 2C. Avoid placing eufyCam 2C under direct sunlight.

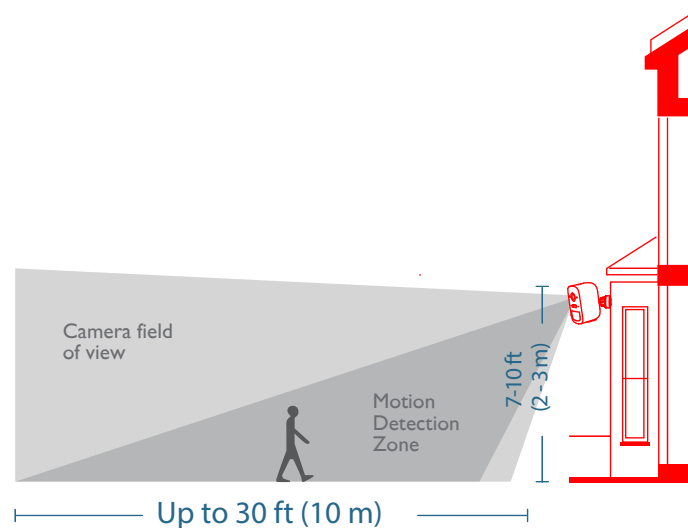

## Mount the camera

The camera can be mounted both indoors and outdoors.

1. Turn the knob of the mounting bracket clockwise to loosen and disassemble it.

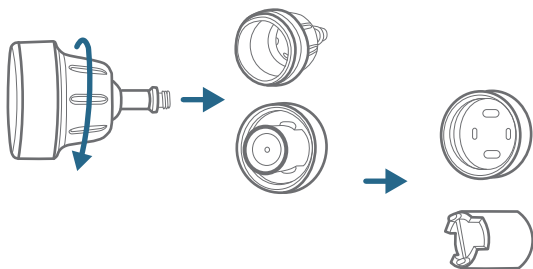

2. Drill holes with a 15/64 inch (5.95mm) drill bit, then insert the anchors into the holes; anchors are necessary for walls that are made out of hard materials such as concrete, brick, or stucco.

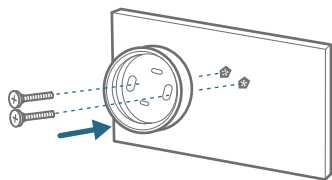

## Mount the camera

3. Firmly screw the base of the mounting bracket onto the wall. Fasten the ball knob of the bracket to the base of the bracket.

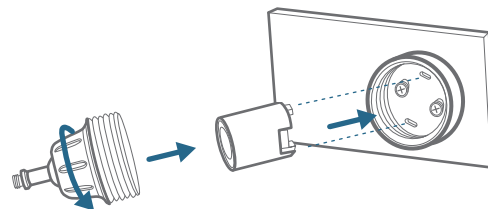

4. Tighten eufyCam 2C to the mounting bracket and adjust the viewing angle by checking the live stream feed in the Eufy Security app.

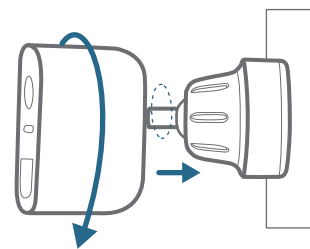

### Tips:

1. The Homebase 2 pairs up to 16 cameras, you can repeat the steps mentioned above to add more eufyCam 2C cameras to meet different needs of use.
2. For troubleshooting, check Help on the Eufy Security App. Refer to App page for LED indicator status.

# 6 / CHARGING EUFYCAM 2C

## Charge eufyCam 2C

### Method 1

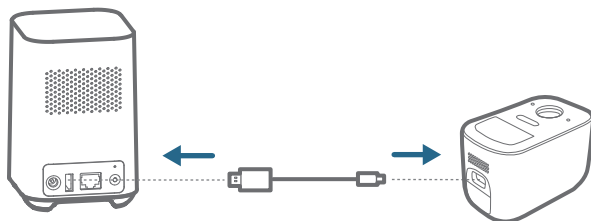

### Method 2

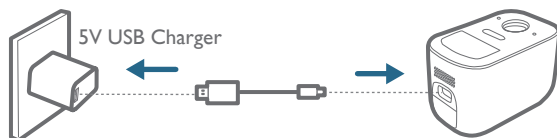

LED indication	Charging: Steady blue
	Fully charged: Off
Charging time	5 hours

# 7 / NOTICE

### FCC Statement

This device complies with Part 15 of the FCC Rules. Operation is subject to the following two conditions: (1) this device may not cause harmful interference, and (2) this device must accept any interference received, including interference that may cause undesired operation.

**Warning:** Changes or modifications not expressly approved by the party responsible for compliance could void the user's authority to operate the equipment.

**Note:** This equipment has been tested and found to comply with the limits for a Class B digital device, pursuant to Part 15 of the FCC Rules. These limits are designed to provide reasonable protection against harmful interference in a residential installation.

This equipment generates uses and can radiate radio frequency energy and, if not installed and used in accordance with the instructions, may cause harmful interference to radio communications. However, there is no guarantee that interference will not occur in a particular installation. If this equipment does cause harmful interference to radio or television reception, which can be determined by turning the equipment off and on, the user is encouraged to try to correct the interference by one or more of the following measures: (1) Reorient or relocate the receiving antenna. (2) Increase the separation between the equipment and receiver. (3) Connect the equipment into an outlet on a circuit different from that to which the receiver is connected. (4) Consult the dealer or an experienced radio/TV technician

for help.

### FCC Radio Frequency Exposure Statement

The device has been evaluated to meet general RF exposure requirements. The device can be used in fixed/mobile exposure condition. The min separation distance is 20cm.

### Notice: Shielded cables

All connections to other computing devices must be made using shielded cables to maintain compliance with FCC regulations.

The following importer is the responsible party  
Company Name: Fantasia Trading LLC  
Address: 9155 Archibald Avenue, Suite 202,  
Rancho Cucamonga, CA 91730, USA  
Telephone: 1-909-484-1530

**CE** This product complies with the radio interference requirements of the European Community.

### Declaration of Conformity

Hereby, Anker Innovations Limited declares that this device is in compliance with the essential requirements and other relevant provisions of Directive 2014/53/EU. For the declaration of conformity, visit the Web site [www.eufylife.com](http://www.eufylife.com). Due to the used enclosure material, the product shall only be connected to a USB Interface of version 2.0 or higher.

The adapter shall be installed near the equipment and shall be easily accessible. Do not use the Device in the environment at too high or too low temperature, never expose the Device under strong sunshine or too wet environment.

The suitable temperature for HomeBase 2 and accessories is -10°C-45°C.

The suitable temperature for eufyCam 2C and accessories is -20°C-50°C.

When charging, please place the device in an environment that has a normal room temperature and good ventilation.

It is recommended to charge the device in an environment with a temperature that ranges from 5°C~25°C.

Please ensure to use only the charger offered by the manufacturer. Using unauthorized charger may cause danger and violate the authorization of the device and the guarantee article.

This charger is for indoor use only

The charger type is ASSA67W-120200, output voltage/current is 12Vdc/2A. The plug considered as disconnect device of adapter. RF exposure information: The Maximum Permissible Exposure (MPE) level has been calculated based on a distance of d=20 cm between the device and the human body.

To maintain compliance with RF exposure requirement, use product that maintain a 20cm distance between the device and human body.

**CAUTION RISK OF EXPLOSION IF BATTERY IS REPLACED BY AN INCORRECT TYPE. DISPOSE OF USED BATTERIES ACCORDING TO THE INSTRUCTIONS.**

#### Wi-Fi Operating Frequency

Range: 2412~2472MHz ; Wi-Fi Max

Output Power: 19dBm

SUB-1G Frequency range: 866~866.8MHz;

SUB-1G Output Power: 12.4dBm

The following importer is the responsible party (contact for EU matters only)

Importer: Anker Technology (UK) Ltd

Importer Address: Suite B, Fairgate House, 205 Kings Road, Tyseley, Birmingham, B11 2AA, United Kingdom



This product is designed and manufactured with high quality materials and components, which can be recycled and reused.



This symbol means the product must not be discarded as household waste, and should be delivered to an appropriate collection facility for recycling. Proper disposal and recycling helps protect natural resources, human health and the environment.

For more information on disposal and recycling of this product, contact your local municipality, disposal service, or the shop where you bought this product.

#### IC Statement

This device complies with Industry Canada licence-exempt RSS standard(s). Operation is subject to the following two conditions:

(1) this device may not cause interference, and  
(2) this device must accept any interference, including interference that may cause undesired operation of the device."

Le présent appareil est conforme aux CNR d'Industrie Canada applicables aux appareils radio exempts de licence. L'exploitation est autorisée aux deux conditions suivantes:

(1) l'appareil n' doit pas produire de brouillage, et  
(2) l'utilisateur de l'appareil doit accepter tout brouillage radioélectrique subi, même si le brouillage est susceptible d'en compromettre le fonctionnement."

This Class B digital apparatus complies with Canadian ICES-003.

Cet appareil numérique de la classe B est conforme à la norme NMB-003 du Canada.

#### IC RF Statement:

When using the product, maintain a distance of 20cm from the body to ensure compliance with RF exposure requirements.

Lors de l'utilisation du produit, maintenez une distance de 20 cm du corps afin de vous conformer aux exigences en matière d'exposition RF.

# INHALTSVERZEICHNIS

Im Lieferumfang enthalten	14	18	Montieren der Kamera
Produktübersicht	15	22	Aufladen der eufyCam 2c
Anschliessen an HomeBase 2	16		
Einrichten des Systems	17		



# IM LIEFERUMFANG ENTHALTEN

## Für die HomeBase 2-Installation



HomeBase 2  
(T8010)



Netzteil für  
HomeBase 2



Ethernet-  
Kabel



Metallstift zum  
Zurücksetzen

## Fpr eufyCam 2C-Installation



eufyCam 2C.  
(T8113)



Mikro-USB-  
Ladekabel



Montage-  
halterung



Befestigungsschrau-  
ben und Dübel

1. Die Anzahl der Kameras und Zubehörteile variiert je nach Angebotspaket.
2. Das HomeBase 2-Netzteil ist je nach Region unterschiedlich..

# 2 / PRODUKT- ÜBERSICHT

## HomeBase 2

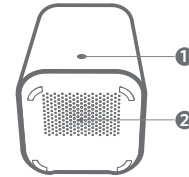

1. Status-LED
2. Lautsprecher
3. Stromversorgungs-Anschluss
4. USB-Anschluss

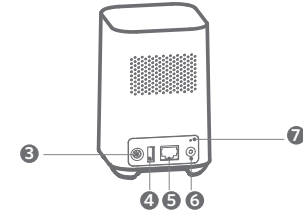

5. Ethernet-Anschluss
6. SYNC/ALARM AUS-Taste
7. Reset-Taste

## eufyCam 2C

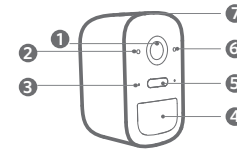

1. Objektiv
2. Lichtsensor
3. Mikrophon
4. Bewegungssensor
5. Spotlight
6. Status-LED
7. SYNC-Taste
8. Montagebohrung

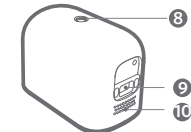

9. Ladeanschluss
10. Lautsprecher

# 3 / ANSCHLIESSEN AN HOMEBASE 2

## HomeBase 2 mit dem Internet verbinden

1. Schalten Sie die HomeBase 2 ein und schließen Sie sie über das im Lieferumfang enthaltene Ethernet-Kabel an Ihren Heimrouter an.

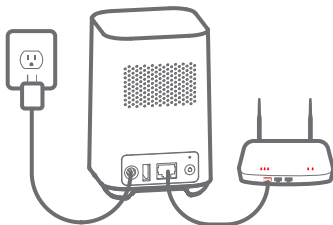

2. Die LED-Anzeige leuchtet blau, wenn die HomeBase 2 bereit für die Einrichtung ist (dies kann bis zu 1 Minute dauern).

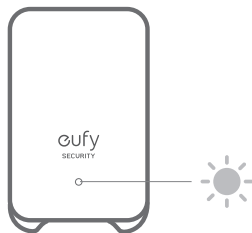

# 4 / EINRICHTEN DES SYSTEMS

## Laden Sie die App herunter und richten Sie das System ein

Laden Sie die Eufy Security-App aus dem App Store (iOS-Geräte) oder bei Google Play (Android-Geräte) herunter.



Melden Sie sich für ein Eufy Security-Konto an und befolgen Sie dann die Anweisungen auf dem Bildschirm, um die Einrichtung abzuschließen.

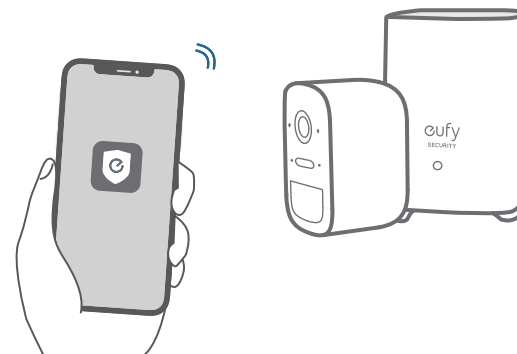

# 5 / MONTIEREN DER KAMERA

## Einen geeigneten Befestigungsort finden

Um einen guten Befestigungsort für die eufyCam 2C zu finden, müssen Sie die Stärke des WLAN-Signals prüfen.

- 1 Öffnen Sie die Eufy Security-App, gehen Sie zu Kameraeinstellungen > Montageanleitung.
- 2 Um die Stärke des WLAN-Signals zu testen, bringen Sie Ihre Kamera und Ihr Telefon an den Ort, an dem Sie die Kamera montieren möchten.
- 3 Bewegen Sie die Kamera so nah wie möglich an die HomeBase 2, falls das Signal schwach ist.



## Höhe und Position wählen

Hängen Sie die eufyCam in einer Höhe von 2–3 m über dem Boden auf. Dadurch wird der Erfassungsbereich des Bewegungssensors der eufyCam 2C maximiert. Bringen Sie die eufyCam 2C nicht an Orten mit direkter Sonneneinstrahlung an.

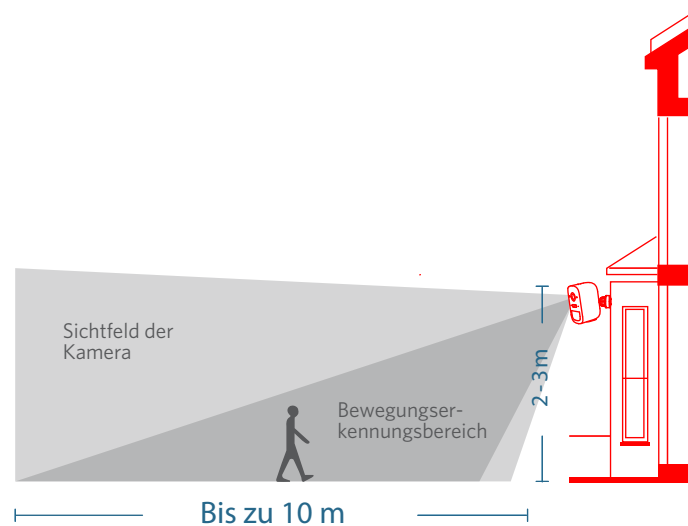

## Kamera montieren

Die Kamera kann sowohl im Innen- als auch im Außenbereich montiert werden.

1. Drehen Sie den Knopf der Montagehalterung im Uhrzeigersinn, um ihn zu lösen und zu demontieren.

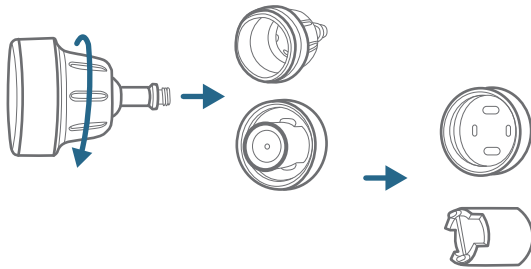

2. Bohren Sie Löcher mit einem 6-mm-Bohrer in die Wand und stecken Sie anschließend die Dübel in die Löcher. Dübel sind für Wände erforderlich, die aus einem harten Material wie Beton, Ziegel oder Stuck bestehen.

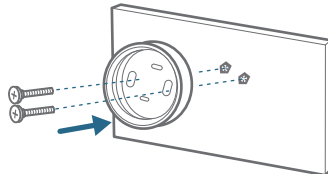

## Kamera montieren

3. Schrauben Sie die Basis der Montagehalterung fest an die Wand. Befestigen Sie den Kugelknopf der Halterung an die Basis der Halterung.

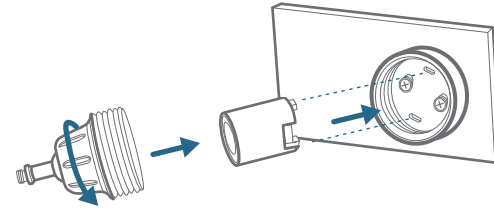

4. Befestigen Sie die eufyCam 2C Kamera an der Montagehalterung und passen Sie den Blickwinkel an, indem Sie den Live-Stream über die Eufy Security-App prüfen.

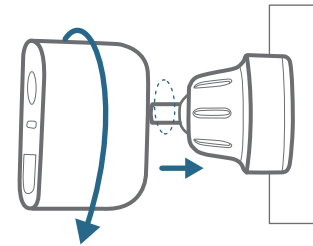

### Tipps:

1. Die Homebase 2 kann mit bis zu 16 Kameras gekoppelt werden. Je nach Nutzungsanforderungen können Sie die obigen Schritte wiederholen, um weitere eufyCam 2C-Kameras hinzuzufügen.
2. Tipps zur Fehlerbehebung finden Sie in der Hilfe der eufy Security-App. Informationen zum Status der LED-Anzeige finden Sie auf der App-Seite.

# 6 / AUFLADEN DER EUFYCAM 2C

## eufyCam 2C aufladen

### Methode 1

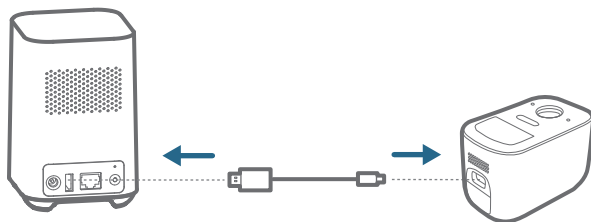

### Methode 2

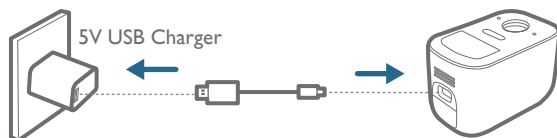

LED-Anzeige	Ladevorgang: Leuchtet blau
	Vollständig aufgeladen: Aus
Ladedauer	5 Stunden

## TABLA DE CONTENIDO

Contenido	24	28	Montaje de la cámara
Descripción del producto	25	32	Carga de la eufycam 2c
Conexión de homebase 2	26		
Configuración del sistema	27		

# CONTENIDO

## Para la instalación de HomeBase 2



HomeBase 2  
(T8010)



Adaptador de  
alimentación para  
HomeBase 2

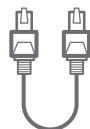

Cable  
Ethernet



Clavija metálica  
para el  
restablecimiento

## Para la instalación de la eufyCam 2C



eufyCam 2C  
(T8113)



Cable de carga  
micro-USB



Soporte de  
montaje



Tornillos y anclajes  
de montaje

1. La cantidad de cámaras y los accesorios varían en función del paquete.
2. El adaptador de alimentación de HomeBase 2 varía según la región.

# 2 / DESCRIPCIÓN DEL PRODUCTO

## HomeBase 2

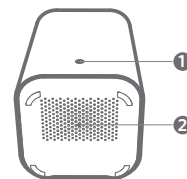

1. Led de estado
2. Altavoz

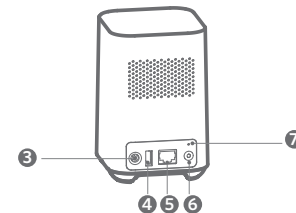

3. Puerto de alimentación
4. Puerto USB
5. Puerto Ethernet
6. Botón Sincronizar/Desactivar alarma
7. Botón Restablecer

## eufyCam 2C

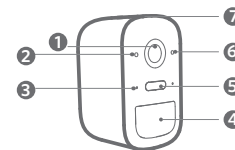

1. Lente
2. Sensor de luz
3. Micrófono
4. Sensor de movimiento
5. Foco
6. Led de estado
7. Botón Sincronizar

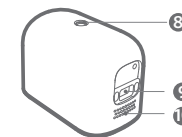

8. Orificio de montaje
9. Puerto de carga
10. Altavoz

# 3 / CONEXIÓN DE HOMEBASE 2

## Conexión de HomeBase 2 a Internet

1. Encienda el sistema HomeBase 2 y utilice el cable Ethernet suministrado para conectarlo al router.

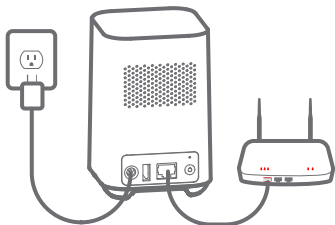

2. Cuando el sistema HomeBase 2 está listo para la configuración, el indicador led se ilumina en color azul (puede tardar hasta 1 minuto).

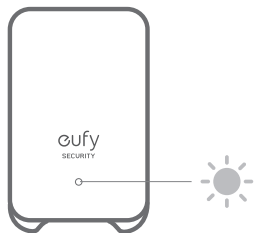

# 4 / CONFIGURACIÓN DEL SISTEMA

## Descarga de la aplicación y configuración del sistema

Descargue la aplicación eufy Security desde la App Store (dispositivos iOS) o Google Play (dispositivos Android).



Regístrese para crear una cuenta de eufy Security y siga las instrucciones que aparecen en pantalla para completar la configuración.

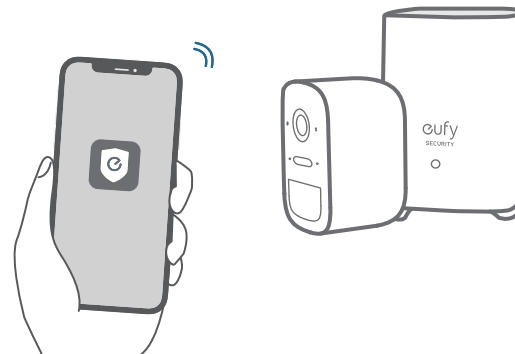

# 5 / MONTAJE DE LA CÁMARA

## Localización de un punto de montaje adecuado

Para localizar un punto de montaje para la cámara eufyCam 2C, debe probar la intensidad de la señal inalámbrica.

- 1 Abra la aplicación eufy Security, vaya a Configuración de la cámara > Guía de montaje.
- 2 Para probar la intensidad de la señal inalámbrica, diríjase al punto de montaje deseado con su teléfono y la cámara.
- 3 Si la intensidad de la señal inalámbrica es débil, acerque la cámara al sistema HomeBase 2 lo máximo posible.

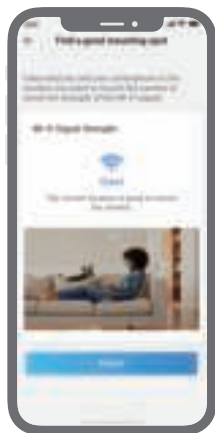

## Selección de la altura y la ubicación

Coloque la eufyCam 2C de 2 a 3 m por encima del suelo. Esta altura maximiza el alcance de detección del sensor de movimiento de la eufyCam 2C. Evite colocar la eufyCam 2C bajo la luz solar directa.

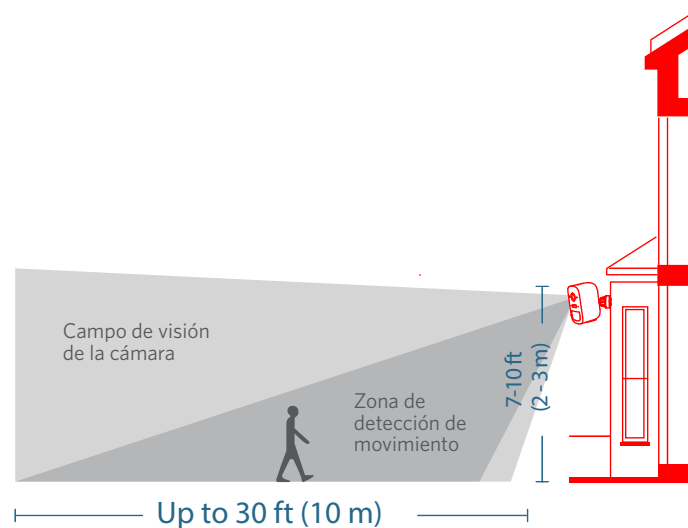



## Montaje de la cámara

La cámara se puede instalar en interiores y en exteriores.

1. Gire la perilla del soporte de montaje hacia la derecha para aflojarlo y desmontarlo.

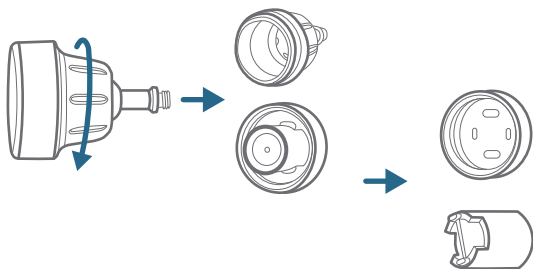

2. Taladre orificios de 5,99 mm con una broca y, a continuación, introduzca los anclajes en los orificios. Es necesario utilizar los anclajes en paredes hechas de materiales duros como hormigón, ladrillo o yeso.

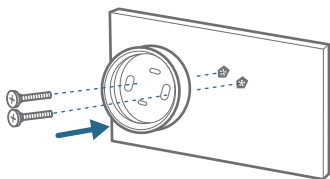

## Montaje de la cámara

3. Atornille firmemente la base del soporte de montaje a la pared. Fije la perilla del soporte a la base del soporte.

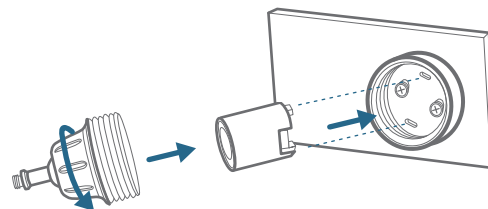

4. Fije la eufyCam 2C al soporte de montaje y ajuste el ángulo de visión con ayuda de la transmisión en directo disponible en la aplicación eufy Security.

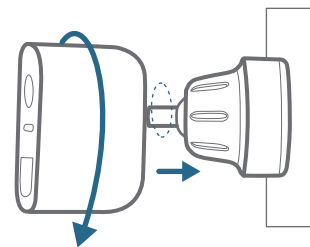

### Consejos:

1. El sistema Homebase 2 se puede emparejar con un máximo de 16 cámaras. Repita los pasos indicados anteriormente para añadir más cámaras eufyCam 2C y satisfacer las distintas necesidades de uso.
2. Para solucionar problemas, consulte la sección Ayuda de la aplicación eufy Security. Visite la página de la aplicación para consultar los estados del indicador led.

# 6 / CARGA DE LA EUFYCAM 2C

## Carga de la eufyCam 2C

### Método 1

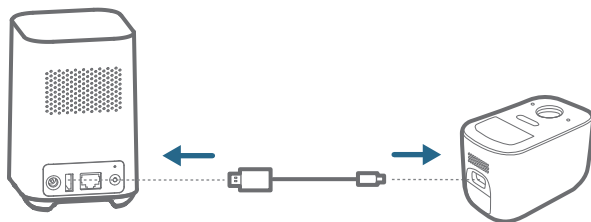

### Método 2

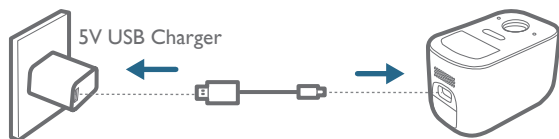

Indicación led	Carga: azul fijo
	Carga completa: apagado
Tiempo de carga	5 horas

## SOMMAIRE

Contenu	34	38	Montage de la caméra
Présentation du produit	35	42	Charge de l'eufycam 2c
Connexion du homebase 2	36		
Configuration du système	37		

# CONTENU

## Pour une installation HomeBase 2



HomeBase 2  
(T8010)

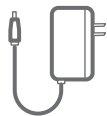

Adaptateur  
d'alimentation  
pour HomeBase 2

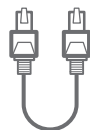

Câble  
Ethernet



Tige métallique  
pour  
réinitialiser

## Pour une installation eufyCam 2C



eufyCam 2C  
(T8113)



Câble de charge  
micro-USB



Support de  
montage



Vis de montage  
et ancrages

1. La quantité de caméras et d'accessoires varie selon le pack.
2. L'adaptateur d'alimentation HomeBase 2 varie selon les régions.

# 2 / PRÉSENTATION DU PRODUIT

## HomeBase 2

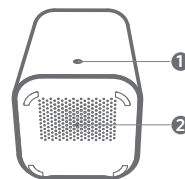

1. LED d'état
2. Haut-parleur
3. Port d'alimentation
4. Port USB

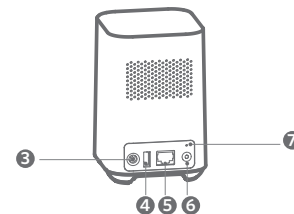

5. Port Ethernet
6. Bouton SYNC/ALARM OFF
7. Bouton de réinitialisation

## eufyCam 2C

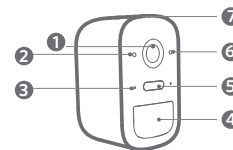

1. Objectif
2. Capteur de luminosité
3. Microphone
4. Détecteur de mouvement
5. Projecteur
6. LED d'état
7. Bouton SYNC
8. Trou de montage

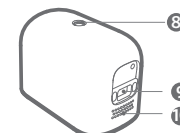

9. Port de charge
10. Haut-parleur

# 3 / CONNEXION DU HOMEBASE 2

## Connecter la station HomeBase 2 à Internet

1. Mettez le HomeBase 2 sous tension, puis utilisez le câble Ethernet fourni pour brancher le HomeBase 2 au routeur de votre domicile.

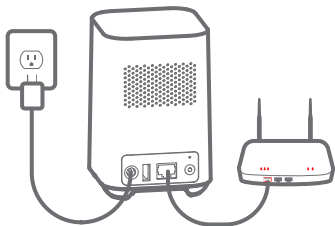

2. L'indicateur LED devient bleu (cela peut prendre une minute) lorsque HomeBase 2 est prêt à être configuré.

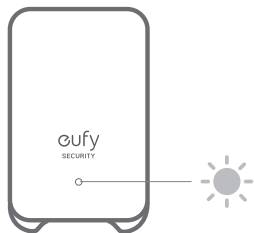

# 4 / CONFIGURATION DU SYSTÈME

## Télécharger l'application et configurer le système

Téléchargez l'application Eufy Security depuis l'App Store (appareils iOS) ou Google Play (appareils Android).



Ouvrez un compte Eufy Security, puis suivez les instructions à l'écran pour terminer la configuration.

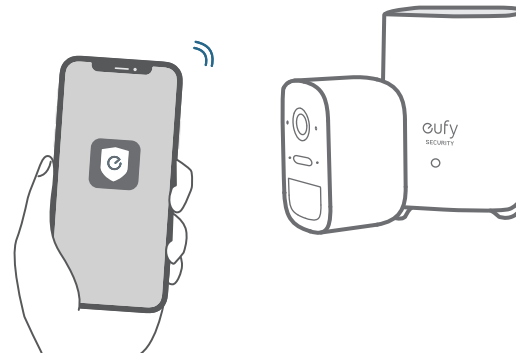

# 5 / MONTAGE DE LA CAMÉRA

## Trouver un emplacement de montage adapté

Pour trouver l'endroit où installer l'eufyCam 2C, vous devez tester la force du signal sans fil.

- ① Ouvrez l'application Eufy Security, accédez à Camera Settings (Paramètres de la caméra) > Mounting Guide (Guide de montage).
- ② Pour tester la force du signal sans fil, apportez votre caméra et votre téléphone à l'endroit où vous souhaitez installer la caméra.
- ③ Approchez la caméra aussi près que possible du HomeBase 2 si la force du signal sans fil est faible.

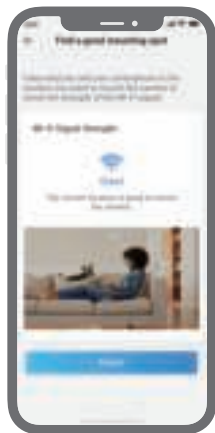

## Sélection de la hauteur et de l'emplacement

Positionnez l'eufyCam 2C entre 2 et 3 mètres (7-10 pi) au-dessus du sol. Cette hauteur optimise la portée de détection du détecteur de mouvement de l'eufyCam 2C. Évitez d'exposer l'eufyCam 2C en plein soleil.

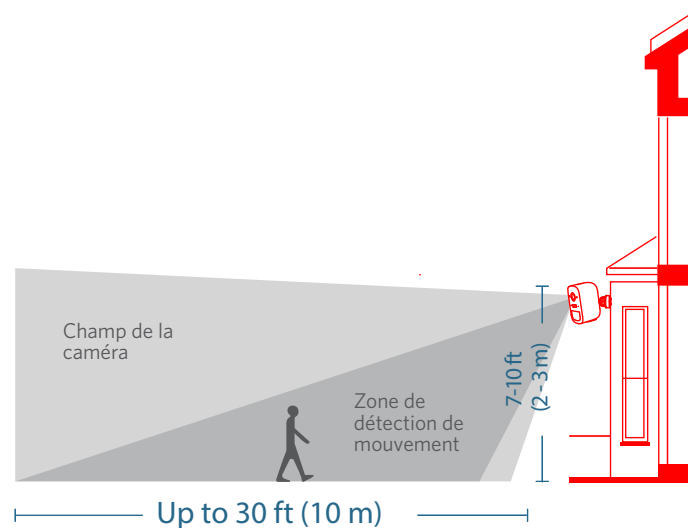

## Montage de la caméra

La caméra peut être montée en intérieur comme en extérieur.

1. Tournez le bouton du support de montage dans le sens des aiguilles d'une montre pour le desserrer et le démonter.

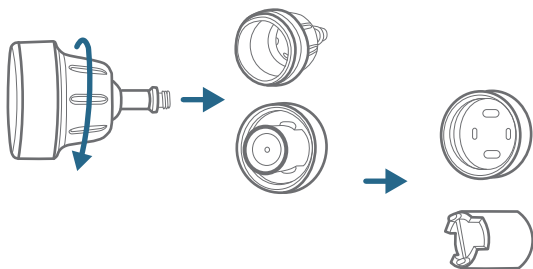

2. Forez des trous de 5,99 mm (15/64 pouces) avec une mèche, puis insérez les chevilles dans les trous. Les chevilles sont nécessaires pour les murs fabriqués dans des matériaux durs tels que le béton, la brique ou le stuc.

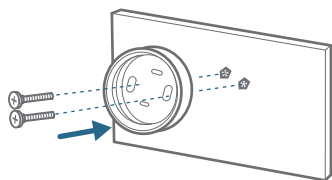

## Montage de la caméra

3. Vissez fermement la base du support de montage dans le mur. Fixez la poignée circulaire du support sur la base du support.

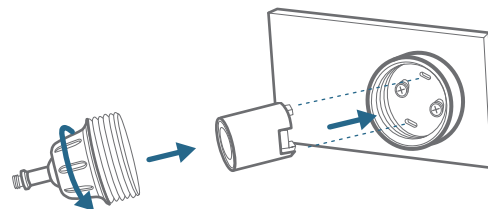

4. Resserrez la caméra eufyCam 2C sur le support de montage et ajustez l'angle de vue en contrôlant le flux d'alimentation en direct dans l'application Eufy Security.

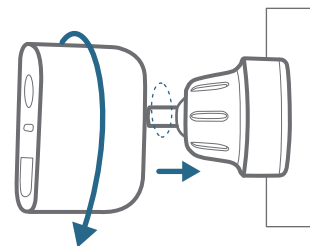

### Conseils:

1. Le Homebase 2 peut coupler jusqu'à 16 caméras. Vous pouvez répéter les étapes décrites ci-dessus pour ajouter d'autres caméras eufyCam 2C pour répondre à vos différents besoins.
2. Pour les opérations de dépannage, consultez la section [Help \(Aide\)](#) de l'application Eufy Security. Pour connaître l'état du voyant LED, reportez-vous à la page [App](#).

# 6 / CHARGE DE L'EUFYCAM 2C

## Charger la caméra eufyCam 2C

### Méthode 1

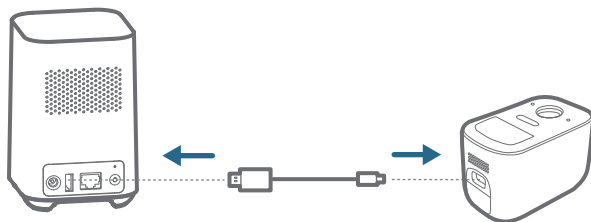

### Méthode 2

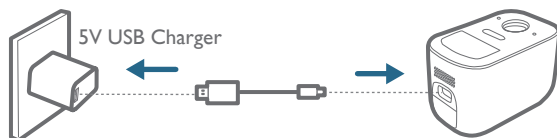

Indication de LED	Charge en cours : bleu fixe
	Charge complète : éteint
Temps de charge	5 heures

## INDICE

Contenuto della confezione	44	48	Montaggio della telecamera
Panoramica del prodotto	45	52	Ricarica di eufycam 2c
Collegamento di homebase 2	46		
Configurazione del sistema	47		

# 1 / CONTENUTO DELLA CONFEZIONE

## Per l'installazione di HomeBase 2



HomeBase 2  
(T8010)



Adattatore di alimentazione per HomeBase 2



Cavo Ethernet



Pin metallico per reimpostazione

## Per l'installazione di eufyCam 2C



eufyCam 2C  
(T8113)



Cavo di ricarica micro-USB



Staffa di fissaggio



Viti e tasselli di fissaggio

1. Il numero e gli accessori delle telecamere variano in base alla confezione.
2. L'adattatore di alimentazione di HomeBase 2 varia in base alla regione di riferimento.

# 2 / PANORAMICA DEL PRODOTTO

## HomeBase 2

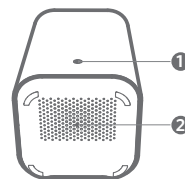

1. LED di stato
2. Altoparlante
3. Porta di alimentazione
4. Porta USB

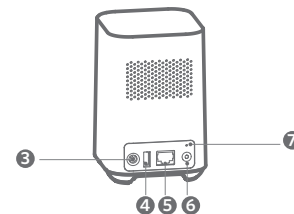

5. Porta Ethernet
6. Pulsante SYNC/ALARM OFF
7. Pulsante di ripristino

## eufyCam 2C

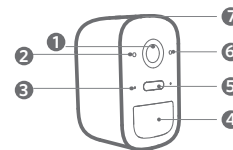

1. Obiettivo
2. Sensore ottico
3. Microfono
4. Sensore di movimento
5. Faretto
6. LED di stato
7. Pulsante SYNC
8. Foro di fissaggio

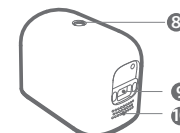

9. Porta di ricarica
10. Altoparlante



# 3 / COLLEGAMENTO DI HOMEBASE 2

## Connessione di HomeBase 2 a Internet

1. Accendere HomeBase 2, quindi collegarlo al router domestico tramite il cavo Ethernet in dotazione.

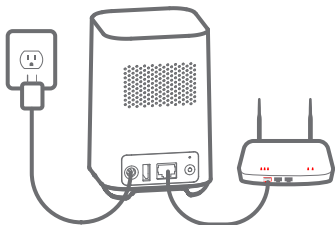

2. La spia LED diventa blu (questa operazione potrebbe richiedere fino a 1 minuto) quando HomeBase 2 è pronto per la configurazione.

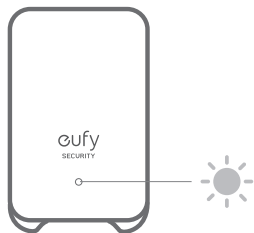

# 4 / CONFIGURAZIONE DEL SISTEMA

## Download dell'app e configurazione del sistema

Scaricare l'app Eufy Security dall'App Store (dispositivi iOS) o da Google Play (dispositivi Android).



Registrare un account personale Eufy Security, quindi seguire le istruzioni visualizzate sullo schermo per completare la configurazione.

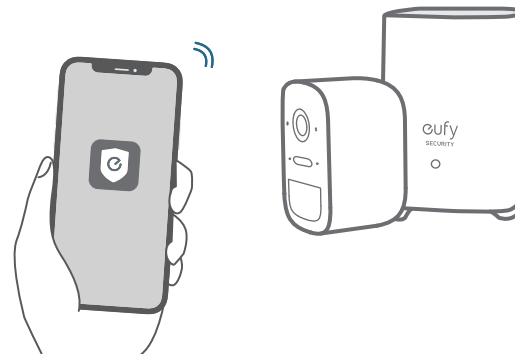

# 5 / MONTAGGIO DELLA TELECAMERA

## Individuazione di un punto di montaggio adeguato

Per individuare un punto in cui montare eufyCam 2C, occorre testare l'intensità del segnale wireless.

- ① Aprire l'app Eufy Security e andare su Impostazioni telecamera > Guida al montaggio.
- ② Per testare l'intensità del segnale wireless, collocare la telecamera e il proprio telefono nel punto in cui si desidera montare la telecamera.
- ③ Se l'intensità del segnale wireless è debole, spostare la telecamera quanto più vicino possibile a HomeBase 2.

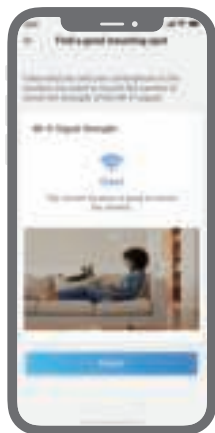

## Selezione di altezza e posizione

Posizionare eufyCam 2C a 2-3 m (7-10 piedi) da terra. Tale altezza ottimizza la portata di rilevamento del sensore di movimento di eufyCam 2C. Non posizionare eufyCam 2C alla luce solare diretta.

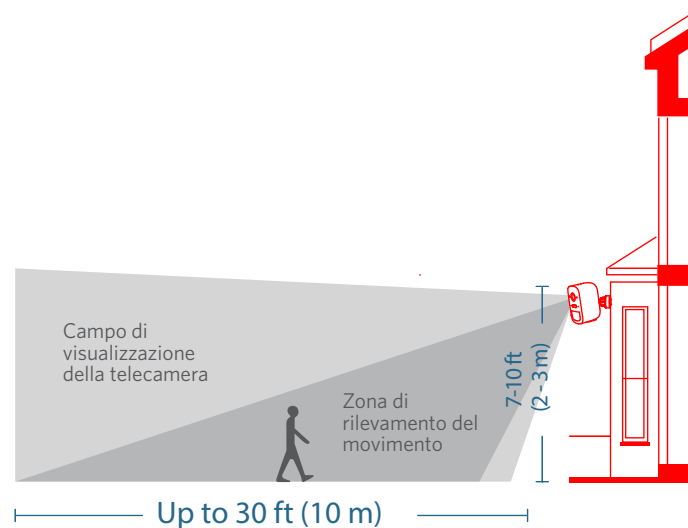

## Montaggio della telecamera

La telecamera può essere montata sia all'interno che all'esterno.

1. Ruotare in senso orario la manopola della staffa di fissaggio in modo tale da allentarla e smontarla.

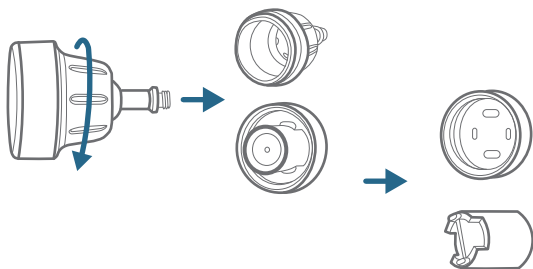

2. Praticare fori da 5,99 mm (15/64 pollici) utilizzando una punta da trapano, quindi inserire i tasselli all'interno dei fori; I tasselli sono necessari nel caso in cui le pareti siano in materiali duri come calcestruzzo, mattoni o stucco.

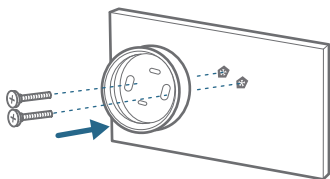

## Montaggio della telecamera

3. Avvitare saldamente la base della staffa di fissaggio alla parete. Fissare la manopola a sfera della staffa alla relativa base.

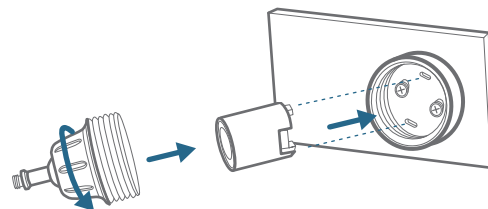

4. Serrare la telecamera eufyCam 2C alla staffa di fissaggio e regolare l'angolo di visualizzazione controllando le immagini in live streaming nell'app Eufy Security.

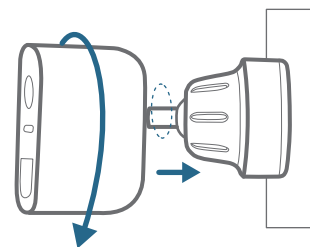

### Suggerimenti:

1. HomeBase 2 associa un massimo di 16 telecamere; è possibile ripetere i passaggi sovraindicati per aggiungere altre telecamere eufyCam 2C a seconda delle proprie esigenze di utilizzo.
2. Per la risoluzione dei problemi, consultare la Guida nell'app Eufy Security. Fare riferimento alla pagina dell'app per informazioni sullo stato della spia LED.

# 6 / RICARICA DI EUFYCAM 2C

## Ricarica di eufyCam 2C

Metodo 1

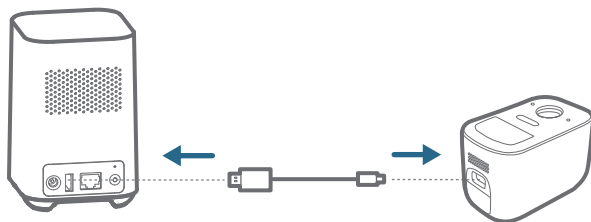

Metodo 2

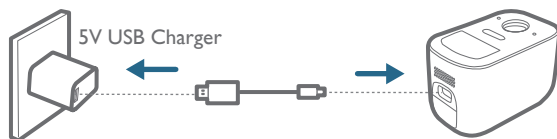

Spia LED	In carica: blu fisso
	Carica completata: spenta
Tempo di ricarica	5 ore

52 IT

## INHOUDSOPGAVE

Wat zit er in de doos?	54	58	De camera monteren
Productover-zicht	55	62	De eufycam 2c opladen
De homebase 2 aansluiten	56		
Het systeem instellen	57		

NL 53

# 1 / WAT ZIT ER IN DE DOOS?

## Voor de installatie van de HomeBase 2



HomeBase 2  
(T8010)

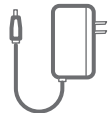

Voedingsadapter  
voor HomeBase 2

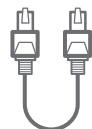

Ethernetkabel



Metalen pin  
voor het  
resetten

## Voor de installatie van de eufyCam 2C



eufyCam 2C  
(T8113)



Micro-USB-  
oplaadkabel



Montagebeugel



Montageschroeven  
en pluggen

1. Het aantal camera's en accessoires verschilt per bundel.
2. De HomeBase 2-voedingsadapter verschilt per regio.

# 2 / PRODUCTOVERZICHT

## HomeBase 2

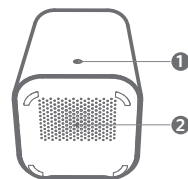

1. Status-LED
2. Luidspreker

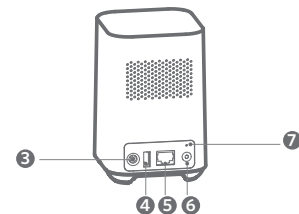

3. Voedingspoort
4. USB-poort
5. Ethernetpoort
6. SYNC/ALARM OFF-knop
7. Resetknop

## eufyCam 2C

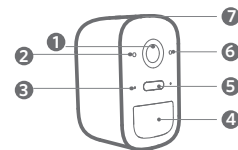

1. Lens
2. Lichtsensor
3. Microfoon
4. Bewegingssensor
5. Spot
6. Status-LED
7. SYNC-knop
8. Montagegat

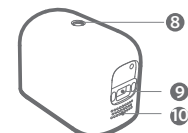

9. Oplaadpoort
10. Luidspreker

# 3 / DE HOMEBASE 2 AANSLUITEN

## De HomeBase 2 verbinden met het internet

1. Schakel de HomeBase 2 in en gebruik vervolgens de meegeleverde ethernetkabel om de HomeBase 2 aan te sluiten op uw thuisrouter.

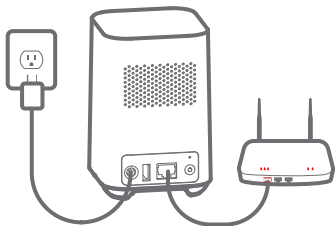

2. De LED-indicator wordt blauw (dit kan 1 minuut duren) wanneer HomeBase 2 klaar is voor de installatie.

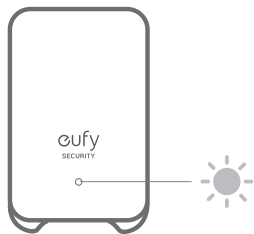

# 4 / HET SYSTEEM INSTELLEN

## De App downloaden en het systeem instellen

Download de Eufy Security-app uit de App Store (iOS-apparaten) of Google Play (Android-apparaten).



Meld u aan voor een Eufy Security-account en volg de instructies op het scherm om het instellen te voltooien.

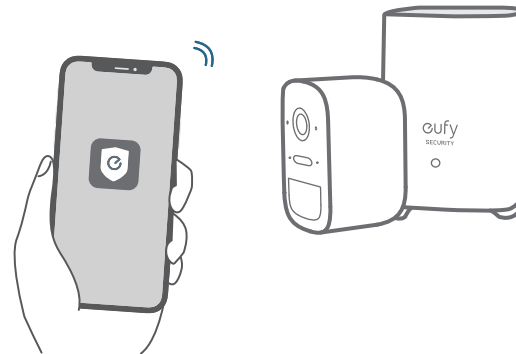

# 5 / DE CAMERA MONTEREN

## Een goede montageplek vinden

Om een plek voor het monteren van de eufyCam 2C te vinden, moet u de draadloze signaalsterkte testen.

- ① Open de Eufy Security-app en ga naar Camera-instellingen (Camera Settings) > Montagegids (Mounting Guide).
- ② Om de draadloze signaalsterkte te testen, neemt u uw camera en telefoon mee naar de locatie waar u de camera wilt monteren.
- ③ Plaats de camera zo dicht mogelijk bij de HomeBase 2 als de draadloze signaalsterkte zwak is.



## De hoogte en locatie bepalen

Hang de eufyCam 2C 2 tot 3 meter boven de grond. Op deze hoogte heeft de bewegingssensor van de eufyCam 2C het maximale detectiebereik. Plaats de eufyCam 2C niet in direct zonlicht.

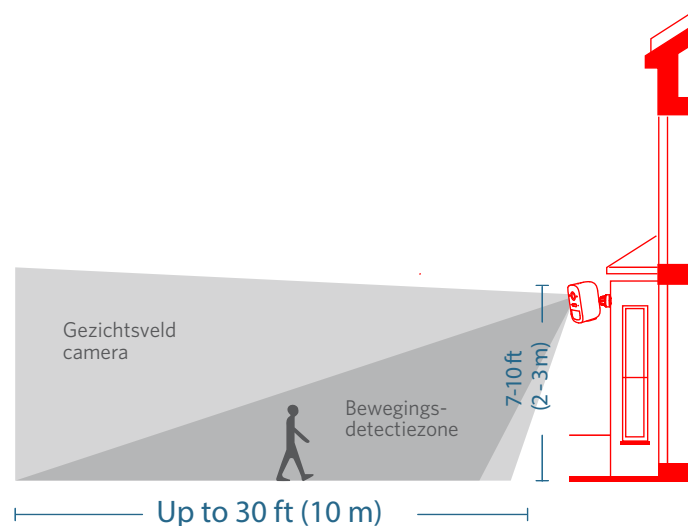

## De camera monteren

De camera kan zowel binnen als buiten worden gemonteerd.

1. Draai de knop van de montagebeugel met de klok mee los om de knop los te maken en te demonteren.

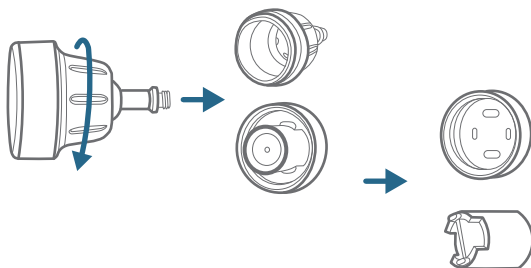

2. Boor gaten van 6 mm met een boortje en steek vervolgens de pluggen in de gaten; de pluggen zijn nodig voor harde muren van beton, baksteen, stucwerk, e.d.

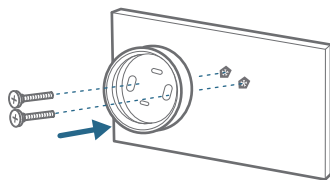

## De camera monteren

3. Schroef de grondplaat van de montagebeugel stevig op de muur. Bevestig de kogelknop van de beugel aan de grondplaat van de beugel.

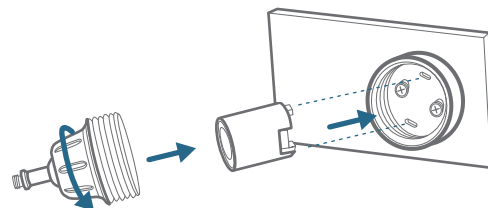

4. Bevestig de eufyCam 2C-camera aan de montagebeugel en pas eventueel de kijkhoek aan door de livestream te bekijken in de Eufy Security-app.

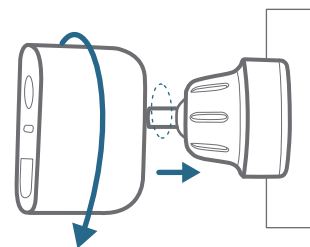

### Tips:

1. De Homebase 2 kan worden gekoppeld met maximaal 16 camera's. U kunt de bovenstaande stappen herhalen om indien gewenst meer eufyCam 2C-camera's toe te voegen.
2. Als u problemen ondervindt, raadpleeg dan Help in de Eufy Security-app. Raadpleeg de pagina in de app voor informatie over de status van de LED-indicator.



# 6 / DE EUFYCAM 2C OPLADEN

## De eufyCam 2C opladen

### Methode 1

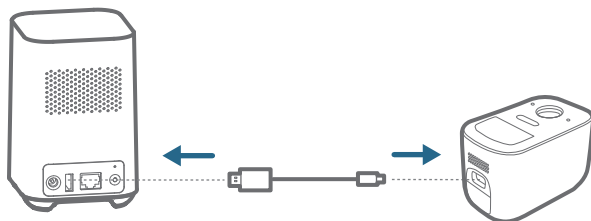

### Methode 2

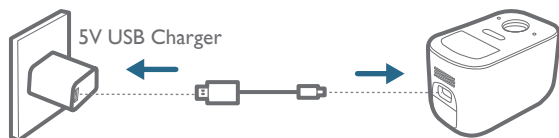

LED-indicatie	Opladen: brandt blauw
	Volledig opgeladen: uit
Oplaadtijd	5 uur

## ÍNDICE

Está Incluído	64	68	Instalar A Câmara
Descrição Do Produto	65	72	Carregar A Eufycam 2C
Ligar A Homebase 2	66		
Configurar O Sistema	67		

# 1 / ESTÁ INCLUÍDO

## Para a instalação da HomeBase 2



HomeBase 2  
(T8010)

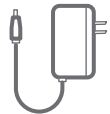

Adaptador de  
alimentação da  
HomeBase 2

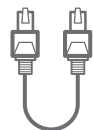

Cabo de  
Ethernet



Pino metálico  
para reposição

## Para a instalação da eufyCam 2C



eufyCam 2C  
(T8113)



Cabo de  
carregamento  
micro-USB



Suporte de  
instalação



Parafusos e âncoras  
de instalação

1. A quantidade de câmaras e de acessórios varia consoante o pacote.
2. O adaptador da HomeBase 2 varia consoante a região.

# 2 / DESCRIÇÃO DO PRODUTO

## HomeBase 2

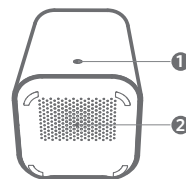

1. LED de estado
2. Altifalante
3. Porta de alimentação
4. Porta USB

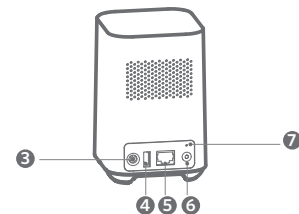

5. Porta de Ethernet
6. Botão SYNC/ALARM OFF
7. Botão de reposição

## eufyCam 2C

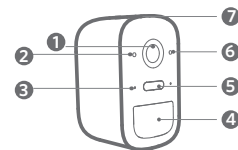

1. Lente
2. Sensor de luz
3. Microfone
4. Sensor de movimento
5. Holofote
6. LED de estado
7. Botão SYNC
8. Orifício de instalação

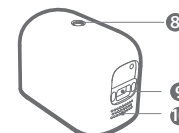

9. Porta de carregamento
10. Altifalante

# 3 / LIGAR A HOMEBASE 2

## Ligar a HomeBase 2 à Internet

1. Ligue a HomeBase 2, em seguida, utilize o cabo de Ethernet fornecido para ligar a HomeBase 2 ao seu router doméstico.

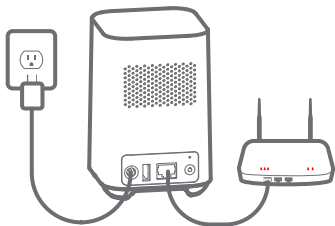

2. O indicador LED fica azul (isto poderá demorar 1 min.) quando a HomeBase 2 estiver pronta para configurar.

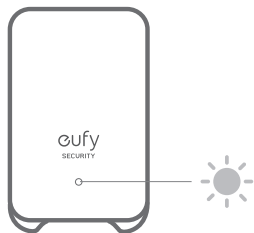

# 4 / CONFIGURAR O SISTEMA

## Transferir a aplicação e configurar o sistema

Transfira a aplicação Eufy Security a partir da App Store (dispositivos iOS) ou da Google Play (dispositivos Android).



Registe uma conta Eufy Security, em seguida, siga as instruções no ecrã para concluir a configuração.

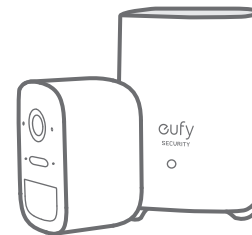
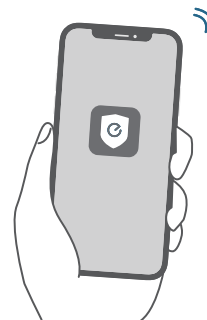

# 5 / INSTALAR A CÂMARA

## Encontre um bom local para a instalação

Para encontrar um local para a instalação da eufyCam 2C, deverá testar a intensidade do sinal sem fios.

- 1 Abra a aplicação Eufy Security, aceda a Camera Settings (Definições da câmara) > Mounting Guide (Guia de instalação).
- 2 Para testar a intensidade do sinal sem fios, leve a câmara e o telefone para o local onde pretende instalar a câmara.
- 3 Se a intensidade do sinal sem fios for fraca, aproxime o máximo possível a câmara da HomeBase 2.

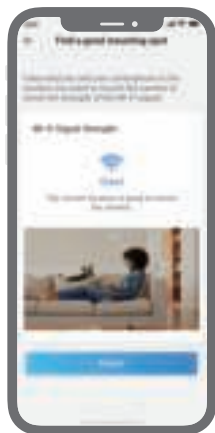

## Selecione a altura e o local

Pendure a eufyCam 2C a 2-3 metros do solo. Esta altura maximiza o alcance de deteção do sensor de movimento da eufyCam 2C. Evite colocar a eufyCam 2C sob a luz solar direta.

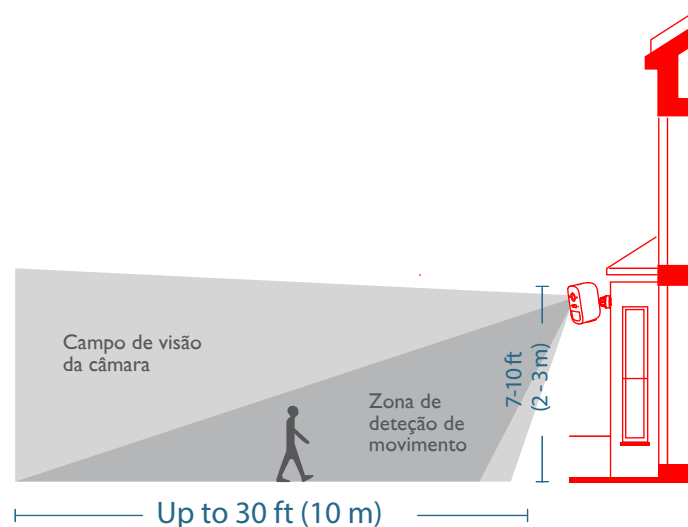

## Instale a câmara

A câmara pode ser instalada no interior e no exterior.

1. Rode o suporte de instalação no sentido dos ponteiros do relógio para o desapertar e desmontar.

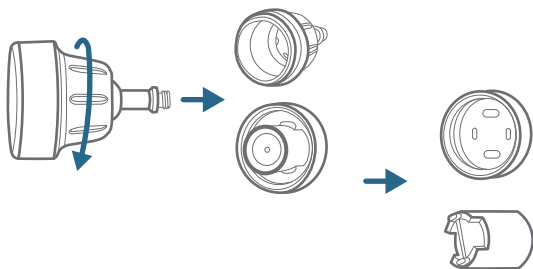

2. Utilize um berbequim para perfurar orifícios com 5,99 mm, em seguida, insira as âncoras nos orifícios. São necessárias âncoras para paredes feitas com materiais duros, tais como betão, tijolo ou estuque.

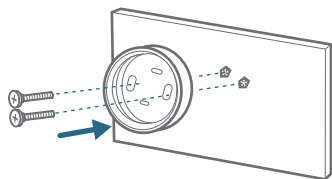

## Instale a câmara

3. Aparafuse bem a base do suporte de instalação à parede. Prenda o manípulo redondo do suporte à base do suporte.

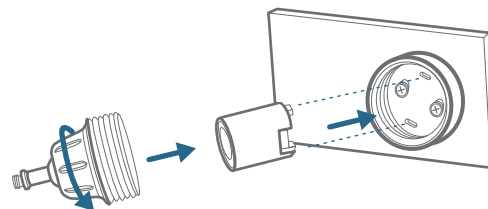

4. Fixe a câmara eufyCam 2C ao suporte e ajuste o ângulo de visualização ao verificar a transmissão em direto na aplicação Eufy Security.

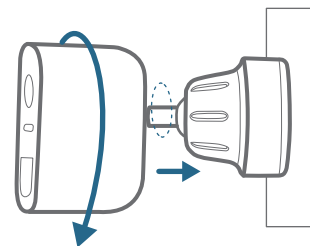

### Sugestões:

1. A HomeBase 2 emparelha um máximo de 16 câmaras. Pode repetir os passos acima mencionados para adicionar mais câmaras eufyCam 2C, para satisfazer mais necessidades de utilização.
2. Para a resolução de problemas, consulte a secção Help na aplicação Eufy Security. Consulte a página da aplicação para ver o estado do indicador LED.

# 6 / CARREGAR A EUFYCAM 2C

## Carregar a eufyCam 2C

### Método 1

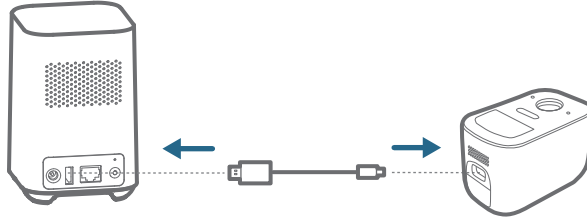

### Método 2

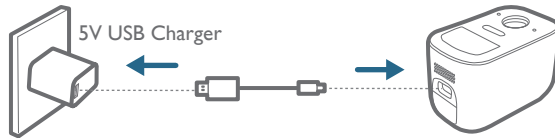

Indicação LED	A carregar: azul fixo
	Totalmente carregada: desligada
Tempo de carregamento	5 horas

## جدول المحتويات

محتويات العلبة	74	78	تركيب الكاميرا
نظرة عامة على المنتج	75	82	شحن eufyCam 2C
HomeBase 2 توصيل	76		
إعداد النظام	77		

## محتويات العبوة

## 2 / نظرة عامة على المنتج

### HomeBase 2 تثبيت



HomeBase 2  
(T8010)



محول طاقة  
HomeBase 2



كبل إيثرنت



دبوس معدني  
لإعادة الضبط

### eufyCam 2C تثبيت



eufyCam 2C  
(T8113)



كبل شحن  
صغير



كتيفة تركيب



براغي التركيب  
ومثبتات

1. تختلف كمية الكاميرات والملحقات بحسب الحزمة.  
2. يختلف محول الطاقة HomeBase 2 بحسب المنطقة.

### HomeBase 2

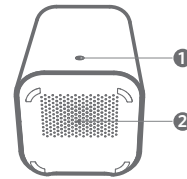

5. منفذ إيثرنت  
6. زر إيقاف المزامنة/التنبيه  
7. زر إعادة التعيين

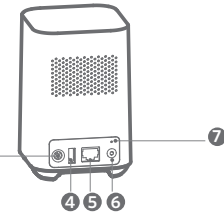

1. مؤشر LED للحالة  
2. مكبر صوت  
3. منفذ الطاقة  
4. منفذ USB

### eufyCam 2C

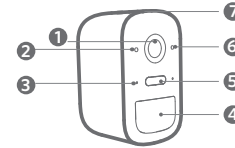

9. منفذ الشحن  
10. مكبر صوت

5. ضوء موضعي  
6. مؤشر LED للحالة  
7. زر المزامنة  
8. فتحة التركيب

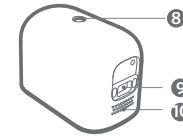

1. العدسة  
2. حساس الضوء  
3. ميكروفون  
4. حساس الحركة

## 3 / توصيل HomeBase 2

### توصيل HomeBase 2 بالإنترنت

1. شغّل HomeBase 2، ومن ثم استخدم كبل إيثرنت المرفق بالجهاز لتوصيل HomeBase 2 بالموجه المنزلي الخاص بك.

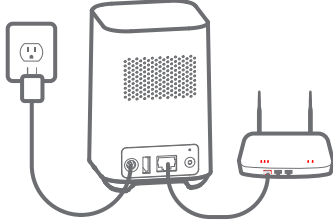

2. يتحوّل مؤشر LED إلى اللون الأزرق (قد تستغرق العملية دقيقة واحدة) عندما يصبح HomeBase 2 جاهز للإعداد.

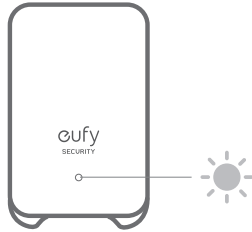

## 4 / إعداد النظام

### تنزيل التطبيق وإعداد النظام

نزل تطبيق Eufy Security من App Store (للأجهزة التي تعمل بنظام iOS) أو من Google Play (للأجهزة التي تعمل بنظام Android).



اشترك لإنشاء حساب Eufy Security، من ثم اتبع التعليمات التي تظهر على الشاشة لإكمال عملية الإعداد.

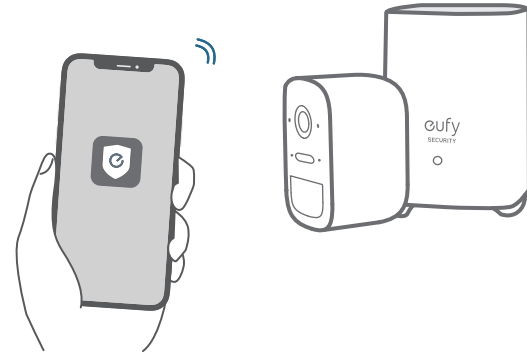



# 5 / تركيب الكاميرا

## العثور على موقع مناسب للتثبيت

للعثور على مكان لتركيب eufyCam 2C، تحتاج إلى اختبار قوة الإشارة اللاسلكية.

- 1 افتح تطبيق Eufy Security app، وانتقل إلى إعدادات الكاميرا < دليل التركيب.
- 2 لاختبار قوة الإشارة اللاسلكية، اصطحب الكاميرا والهاتف إلى الموقع الذي تريد تركيب الكاميرا فيه.
- 3 انقل الكاميرا إلى أقرب موقع ممكن من HomeBase 2 إذا كانت قوة الإشارة اللاسلكية ضعيفة.

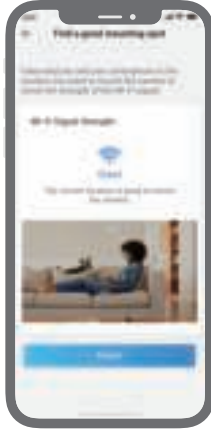

## حدد الارتفاع والموقع

علّق eufyCam 2C على ارتفاع يتراوح ما بين 7 و10 أقدام (أي ما بين مترين وثلاثة) عن الأرض. يزيد هذا الارتفاع نطاق اكتشاف جهاز استشعار الحركة الخاص بـ eufyCam 2C إلى أقصى حد ممكن. تجنب وضع eufyCam 2C تحت أشعة الشمس مباشرةً.

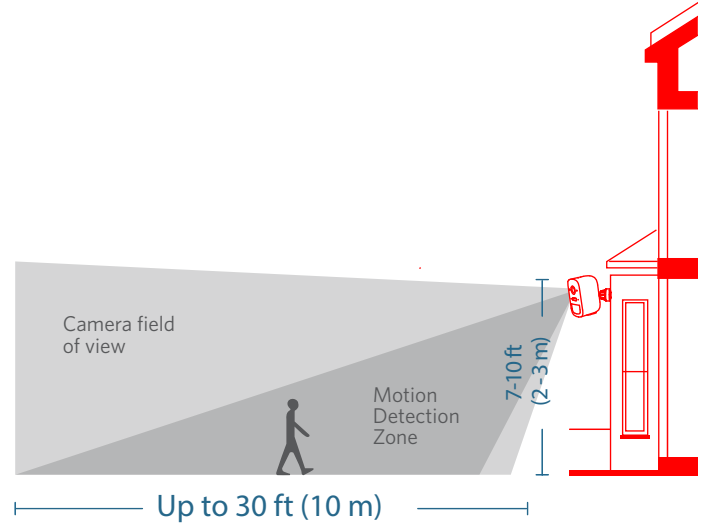

## تركيب الكاميرا

- يمكن تركيب الكاميرا في الداخل والخارج على حد سواء.
1. أدر مفتاح كتيفة التركيب في اتجاه عقارب الساعة لجعلها سائبة وتفكيكها.

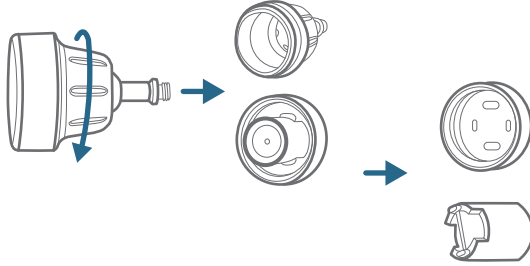

2. انقب بحجم 15/64 بوصة (5.99 مم) بواسطة مثقاب، ثم أدخل المثبتات في الفتحات؛ تُعد المثبتات ضرورية للجدران المصنوعة من مواد صلبة مثل الباطون أو القرميد أو الجص.

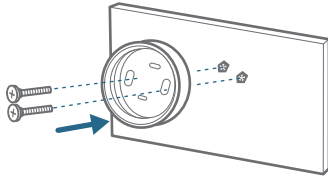

## تركيب الكاميرا

3. ثبت بإحكام قاعدة جهاز كتيفة التركيب على الحائط باستخدام البراغي. شد مفتاح الكتيفة بإحكام على قاعدة الكتيفة.

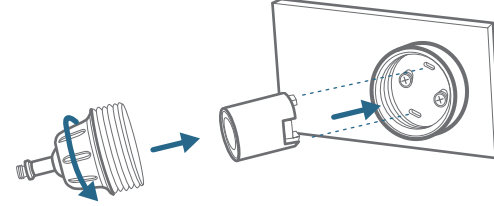

4. أحكم ربط كاميرا eufyCam 2C على كتيفة التركيب واضبط زاوية عرض الكاميرا من خلال التحقق من موجز البث المباشر في تطبيق Eufy Security.

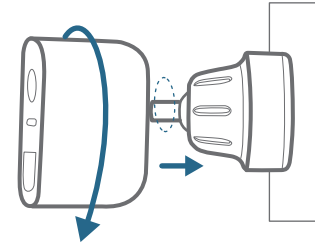

نصائح:

1. تصل عدد كاميرات Homebase 2 إلى 16 كاميرا، يمكنك تكرار الخطوات المذكورة أعلاه لإضافة المزيد من كاميرات eufyCam 2C لتلبية الاحتياجات المختلفة للاستخدام.
2. لاستكشاف الأخطاء وإصلاحها، يرجى التحقق من "المساعدة" على تطبيق Eufy Security. راجع صفحة التطبيق لمعلومات عن حالة مؤشر LED.

# شحن eufyCam 2C / 6

## شحن eufyCam 2C

### الطريقة 1

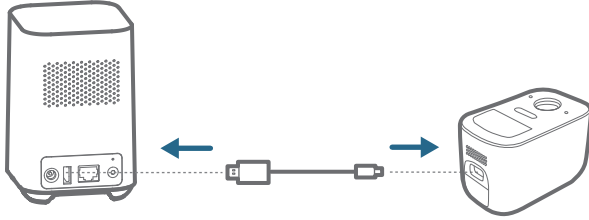

### الطريقة 2

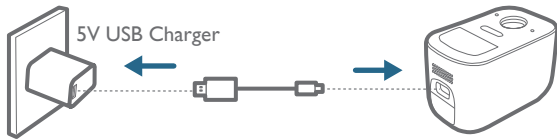

الشحن: أزرق ثابت	مؤشر LED
الشحن بالكامل: إيقاف	
5 ساعات	مدة الشحن

## Customer Service

Kundenservice | Servicio de atención al cliente | Service client  
Servizio clienti | Klantenservice | Serviço de Apoio ao Cliente | خدمة العملاء

### Warranty

Garantie | Garantía | Garantie | Garanzia | Garantie | Garantie | الضمان

### 12-month limited warranty

12 Monate eingeschränkte Garantie | Garantía limitada de 12 meses  
Garantie limitée de 12 mois | Garanzia limitata di 12 mesi | 12 maanden beperkte garantie  
12 meses de garantía limitada | ضمان محدود لمدة 12 شهرًا

### Call Us

Rufen Sie uns an | Contacto por teléfono | Par téléphone | Telefono | Bel ons  
اتصل بنا | Ligue para nós

United States +1 (800) 988 7973 Mon-Fri 9AM-5PM (PT)  
United Kingdom +44 (0) 1604 936 200 Mon-Fri 6AM-11AM (GMT)  
Germany +49 (0) 69 9579 7960 Mon-Fri 6:00-11:00

### Email Us

Senden Sie uns eine E-Mail | Contacto por correo electrónico | Par e-mail | E-mail  
ارسل لنا بريدا إلكترونيا | Email ons | Envia-nos um email

Customer Support: support@eufylife.com

Anker Innovations Limited

Room 1318-19, Hollywood Plaza, 610 Nathan Road, Mongkok, Kowloon, Hong Kong

f @EufyOfficial

t @EufyOfficial

ig @EufyOfficial

