

SYMONS & PANCHENKO



Customer service and more about us on our website
www.symonspanchenko.com

SYMONS & PANCHENKO

CERTIFICATE PURCHASE APPROVAL

DATE OF PURCHASE : _____
PLACE & NAME SHOP : _____
SIGNATURE/STAMP SHOP : _____
NAME Salesperson _____
REF SERIES BACKSIDE WATCH : _____
NUMER _____

Register your watch on www.symonspanchenko.com
for a 2 years warranty and full support :
Keep this certificate for service, warranty and repairs.

THANK YOU FOR PURCHASING SYMONS & PANCHENKO

We are sure you will not regret your choice. More models and full service support can be found on our site : www.symonspanchenko.com There you can also read more about us and contact our customer service.

Register, join and follow us on : twitter, pinterest, facebook and instagram. (symonspanchenko)

POLICY INTERNATIONAL WARRANTY READ CAREFULLY

For service and repairs your product has a 2 years warranty on all defaults.

We reimburse all costs for repairs, service and up and down shipment of/to an established watchmaker or warehouse commonly agreed upon between product-owner and our customer service at (www.symonspanchenko.com)

Unfortunately we can't give any warranty if the product is naturally worn out or shows breakage due to misuse or improper maintenance. Always first contact the customer service on our website (www.symonspanchenko.com) and be sure to keep your Certificate Purchase Approval.

Be sure the crown is closed before there is contact with water. Our Watches are water resistant when leaving our warehouses.

WATER RESISTANCE

Our watches are 3, 5, or 10 ATM and is mentioned on dial, back-cover or on our website.

3 ATM : you can shower, wash the dishes and hands.

5 ATM : you can swim but don't jump or dive from high distance into the water – a shock can also damage the inside rubber O'rings.

10 ATM allows you to jump and dive and practice scuba diving too.

If any doubts about or just interested please ask your watchmaker or ask our customer service.

Be sure the crown is closed before there is contact with water.

All SYMONS & PANCHENKO Watches are equipped with a quality stainless steel screw down system to assure water resistance. Be sure the crown is closed before there is contact with water.

ANALOG

(3 hands watches)



Unscrew the crown by turning to the left to open the crown and adjust the settings. (2 and 3) for time and date (depending the model)

After changing the settings push back the crown to position number 1.

Then press and screw the crown back down firmly but NEVER overtighten the crown as it will damage the gaskets inside.

CHRONOGRAPH

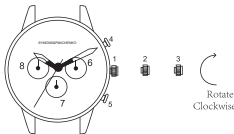

FUNCTIONS: (depending the model)

- | | |
|---------------------|--------------------|
| 1. Normal Position | 6. 24 Hour Hand |
| 2. Set Date | 7. 60 Second Timer |
| 3. Set Time | 8. 30 Minute Timer |
| 4. Start/Stop Timer | |
| 5. Reset Timer | |

SYMONS & PANCHENKO

FOLLOW US ON



[Pinterest/symonspanchenko](https://www.pinterest.com/symonspanchenko)



[Twitter/symonspanchenko](https://twitter.com/symonspanchenko)



[Facebook/symonspanchenko](https://www.facebook.com/symonspanchenko)



[Instagram/symonspanchenko](https://www.instagram.com/symonspanchenko)