

RAM® Upper Tele-Pole™ Assembly Instructions

Pat. Pend.

OPTION ONE SINGLE ARM

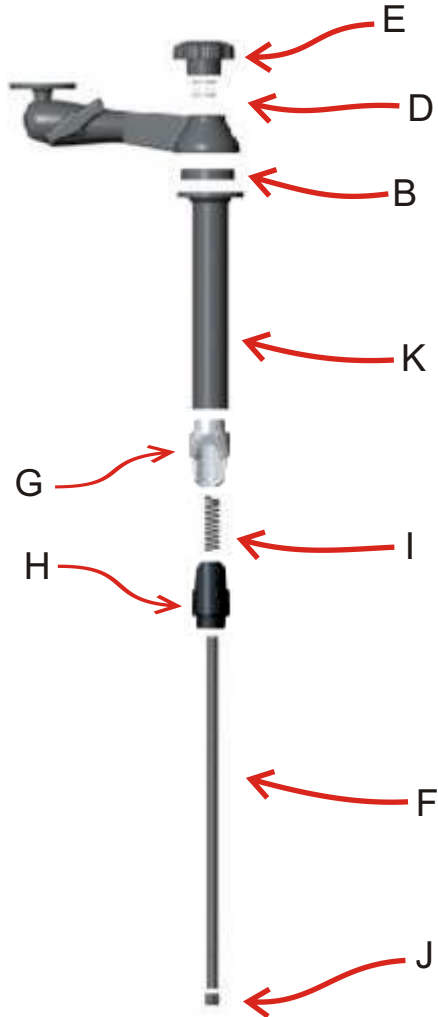

OPTION TWO DOUBLE ARM

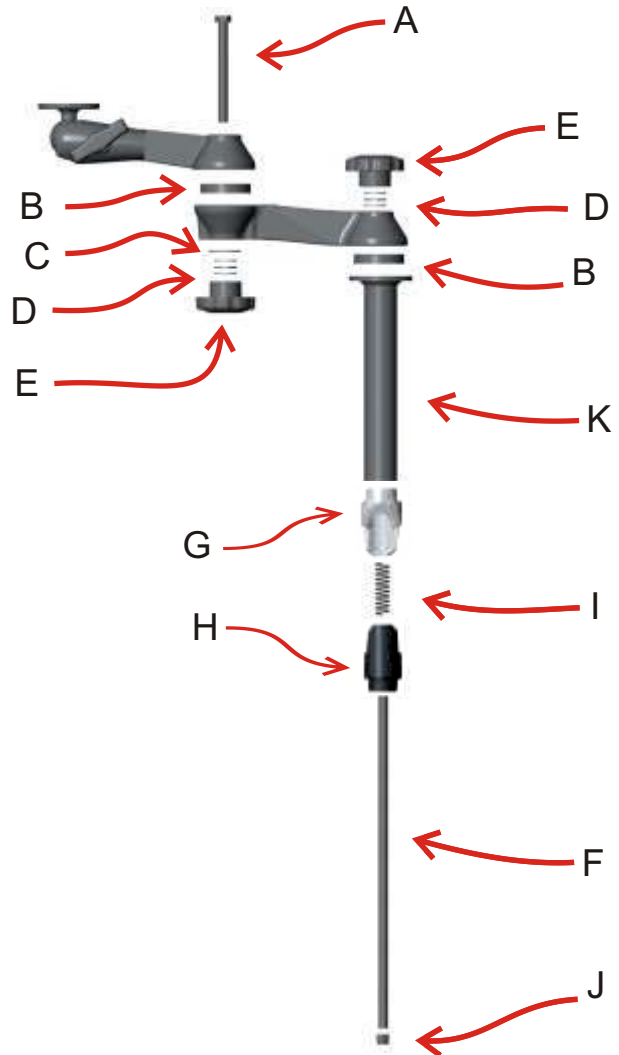

Parts Index

- A. 3/8" DIA. HEX BOLT
- B. RUBBER WASHER
- C. 3/8" ID X 1 1/4" OD WASHER
- D. THRUST WASHER ASSEMBLY (SEE DETAIL AA)
- E. 2 1/2"DIA. PLASTIC KNOB
- F. THREADED ROD
- G. ALUMINUM WEDGE
- H. PLASTIC WEDGE
- I. SPRING
- J. 3/8" HEX NYLOCK NUT
- K. UPPER TUBE



- 3/8" ID X .80" OD STEEL WASHER
- 3/8" ID BALL BEARING WASHER
- 3/8" ID X .80" OD STEEL WASHER



Detail AA

THRUST WASHER ASSEMBLY

Part Index: D

National Products, Inc., 8410 Dallas Ave S., Seattle, WA 98108, (206) 763-8361 www.RAM-MOUNT.com

This document, including images, may not be reproduced partly or fully without the expressed written consent of National Products, Inc.