



AG Store - Kledingtondeuse

Electric Lint Remover

AG1

(Battery Operated Is Allowed)

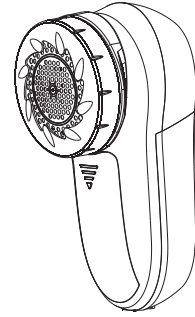

Operating manual

Unpacking

1. On/Off slide
2. LED Indicator
3. Storeroom
4. Head cutting
5. Net cover
6. Cleaning brush
7. User manual
8. Power cord
9. The peak
10. Batteries house(2× AA I. 5V ALKALINE BATTERIES)

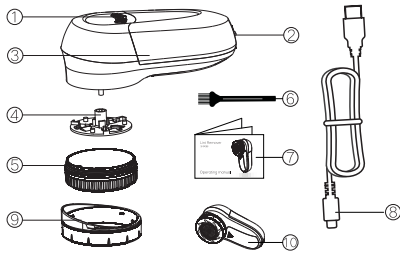

Read the user manual before using, and safekeep it properly.

1

Attention matters

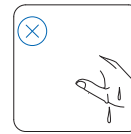
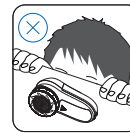

1. Keep the lint remover in dry.
2. The clothes must be leveled before use to prevent the clothing from wrinkling, so as to avoid the damage of clothing during pruning.
3. It is forbidden to press the hair ball pruner with force so as to avoid damage of clothing.
4. Do not use the appliance to remove the lint on clothing that worn on the body, otherwise it may cause damage to the body and clothing.
5. When connecting the product, please ensure that the marked voltage of the product is consistent with the power supply voltage.
6. The lint remover has protection function, please make sure to tighten the foil cover and install the storage room, otherwise it can not work properly.
7. In order not to affect the using life of the appliance, please remove the battery when lint remover do not using for a long time.

8. Avoid falling products or let this product be hit by a strong impact.
9. It is necessary to charge, use or store the hair ball pruner at a temperature between 5°C and 35°C.
10. Please make ensure that the protective cover on the inner blade when you take the appliance in travel to protect the inner blade and the outer foil cover.
11. This appliance is not intended for use by persons (including children) with reduced physical, sensory or mental capabilities, or lack of experience and knowledge, unless they have been given supervision or instruction concerning use of the appliance by a person responsible for their safety.
12. When the shaver is used, it shall be slightly heated up, and this is a normal phenomenon, please rest assured to use it.



Environmental tips

- The batteries in the apparatus may contain harmful substances to the environment;
- The battery must be removed from the appliance before the waste apparatus is removed;
- Before the battery is removed, the appliance must be powered off;
- Batteries should be disposed safely;
- When discarding the expired product, please put the motor components and other metal parts in the metal recovery box.

3

Instructions for operation

- Note the following parts.



- Do not take for other use except removing lint.

Method use

The method of fast-remove

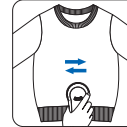

Removing to the stiking lint

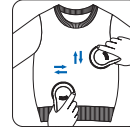

The thin texture clothes



Textured clothes



4

Cleaning and maintenance

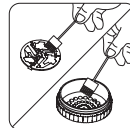
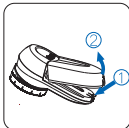

Product	Lint Remover
Model	SN9088
Rated voltage	DC 3V
Rated power	3W

5

Issue	Reason	Solution
The product does not work after start-up	Battery power shortage	Change a new pair of batteries
	Circuit breakdown	we'll provide a satisfied after-sale service
The product is not used to remove lint	The outer foil net or storeroom is not installed in place	Make sure to install the outer foil and the storeroom into the right place
	lint is accumulated inside product	Clean the storeroom
Charging indicator does not work	Not connected to the power supply	Make sure the power supply is connected
	Indicator is damaged	we'll provide a satisfied after-sale service

6