

Configuration Flow Chart

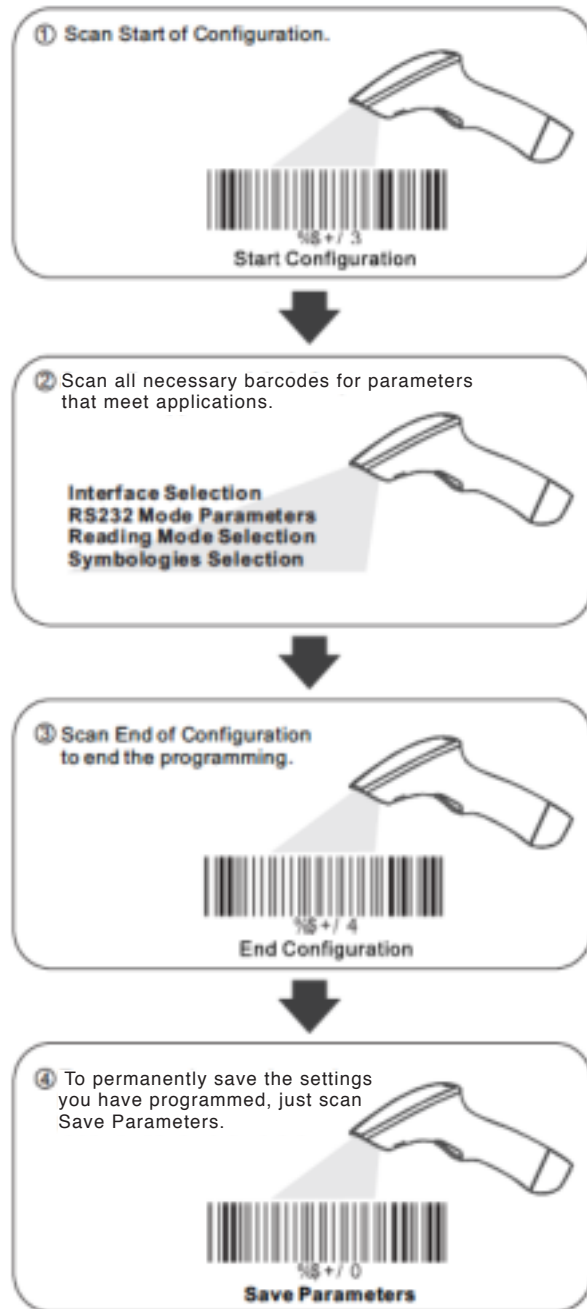

- Set All Defaults
%S+7
- Interface Selection
<Keyboard Mode>
%S+3
- USB Mode
%X06
- Reading Mode Selection
<Good Read OFF>
%S271
- Continuous/Trigger OFF
%S272
- Continuous/Auto Power On
%S273
- Flash/Auto Power On
%S276
- Select Terminator
<CR+LF>
%S52+
- CR
%S50+
- Space
%S44+
- STX-ETX
%S55+

- Version Information
%S+5
- RS232 Mode
%S008
- Trigger ON/OFF
%S270
- Testing
%S275
- Flash
%S274
- Auto Sense (Option)
%S9F8
- None
%S7+
- LF
%S1+
- HT(TAB)
%S31+

- ### Symbologies Selection
- UPC-A <ON>
%SA14
 - UPC-E <ON>
%S008
 - EAN-13/JAN-13/ISBN-13 <ON>
%SA22
 - EAN-8/JAN-8 <ON>
%SA11
 - CODE 39 <ON>
%S106
 - CODE 128 <ON>
%S108
 - CODABAR/NW7 <ON>
%S109
 - Interleaved 2 of 5 <ON>
%S008
 - CODE 93 ON
%S109
 - China Postage ON
%S109
 - Telepen ON
%S118
 - GS1 DataBar Omnidirectional ON
%S113K
 - GS1 DataBar Limited ON
%S0VC8
 - GS1 DataBar Expanded ON
%S0VCR
 - Select All Bar Codes
%S1+

- UPC-A OFF
%SA10
- UPC-E OFF
%S008
- EAN-13/JAN-13/ISBN-13 OFF
%SA20
- EAN-8/JAN-8 OFF
%SA10
- CODE 39 OFF
%S106
- CODE 128 OFF
%S108
- CODABAR/NW7 OFF
%S109
- Interleaved 2 of 5 OFF
%S008
- CODE 93 <OFF>
%S109
- China Postage <OFF>
%S109
- Telepen <OFF>
%S118
- GS1 DataBar Omnidirectional <OFF>
%S113K
- GS1 DataBar Limited <OFF>
%S0VC8
- GS1 DataBar Expanded <OFF>
%S0VCR

RS232 Mode Parameters

A> Set Up BAUD Rate

1200



4800



19200



B> Set Up Data Bits 7 Data Bits



C> Set Up Stop Bits <1 Bit>



D> Set Up Parity <None>



Odd



Space



E> Handshaking RTS/CTS Enable



ACK/NAKEnable



XON/XOFF Enable



2400



<9600>



38400



<8 Data Bits>



2 Bits



Even



Mark



<RTS/CTS Disable>



<ACK/NAK Disable>



<XON/XOFF Disable>



Warranty Information

English: For warranty information, go to manhattanproducts.com/warranty.

Deutsch: Garantieinformationen finden Sie unter manhattanproducts.com/warranty.

Français: Pour consulter les informations sur la garantie, visitez manhattanproducts.com/warranty

Waste Electrical & Electronic Equipment

Disposal of Electric and Electronic Equipment

(applicable in the European Union and other European countries with separate collection systems)

English: This symbol on the product or its packaging indicates that this product shall not be treated as household waste. Instead, it should be taken to an applicable collection point for the recycling of electrical and electronic equipment. By ensuring this product is disposed of correctly, you will help prevent potential negative consequences to the environment and human health, which could otherwise be caused by inappropriate waste handling of this product. If your equipment contains easily removable batteries or accumulators, dispose of these separately according to your local requirements. The recycling of materials will help to conserve natural resources. For details about recycling this product, contact your local city office, your household waste disposal service or the shop where you purchased this product. *In countries outside of the EU:* If you wish to discard this product, contact your local authorities and ask for the correct manner of disposal.

Deutsch: Dieses auf dem Produkt oder der Verpackung angebrachte Symbol zeigt an, dass dieses Produkt nicht mit dem Hausmüll entsorgt werden darf. In Übereinstimmung mit der Richtlinie 2002/96/EG des Europäischen Parlaments und des Rates über Elektro- und Elektronik-Altgeräte (WEEE) darf dieses Elektrogerät nicht im normalen Hausmüll oder dem Gelben Sack entsorgt werden. Wenn Sie dieses Produkt entsorgen möchten, bringen Sie es bitte zur Verkaufsstelle zurück oder zum Recycling-Sammelpunkt Ihrer Gemeinde.

Français: Ce symbole sur le produit ou son emballage signifie que ce produit ne doit pas être traité comme un déchet ménager. Conformément à la Directive 2002/96/EC sur les déchets d'équipements électriques et électroniques (DEEE), ce produit électrique ne doit en aucun cas être mis au rebut sous forme de déchet municipal non trié. Veuillez vous débarrasser de ce produit en le renvoyant à son point de vente ou au point de ramassage local dans votre municipalité, à des fins de recyclage.

CE Compliance

English: This device complies with the requirements of R&TTE Directive 1999/5/EC.

The Declaration of Conformity for this product is available at:

Deutsch: Dieses Gerät entspricht der Direktive R&TTE Direktive 1999/5/EC.

Die Konformitätserklärung für dieses Produkt finden Sie unter:

Français: Cet appareil satisfait aux exigences de la directive R&TTE 1999/5/CE.

La Déclaration de Conformité pour ce produit est disponible à l'adresse :

manhattanproducts.com



For specifications, go to manhattanproducts.com.
Die Spezifikationen finden Sie auf manhattanproducts.com.
Vous trouvez les spécifications sur manhattanproducts.com.

North & South America

IC Intracom Americas
550 Commerce Blvd.
Oldsmar, FL 34677
USA

Asia & Africa

IC Intracom Asia
4-F, No. 77, Section 1, Xintai 5th Rd.
Xizhi Dist., New Taipei City 211
Taiwan, ROC

Europe

IC Intracom Europe
Löhbacher Str. 7
D-58553 Halver
Germany

© IC Intracom. All rights reserved.

Manhattan is a trademark of IC Intracom, registered in the U.S. and other countries.

Contact CCD Barcode Scanner Quick Install Guide 178488



manhattanproducts.com