

Combination Key Safe Box Instruction

To open the key box:

1. Slide shutter board to reveal the dials.
2. Rotate dials to the current combination. (factory combination is 0-0-0-0)
3. Push down button near the dials, the cover is open.
4. After closing the cover, upset the dials to protect your combination.
5. Close the shutter board.

To set your combination:

1. Open the key box, leave dials at current combination. (factory combination is 0-0-0-0)
2. Push the RESET button from position A to position B, as shown in Pic 1.
3. Now rotate dials to set your desired combination.
4. Push the RESET button back to position A. Now the new password has been set.

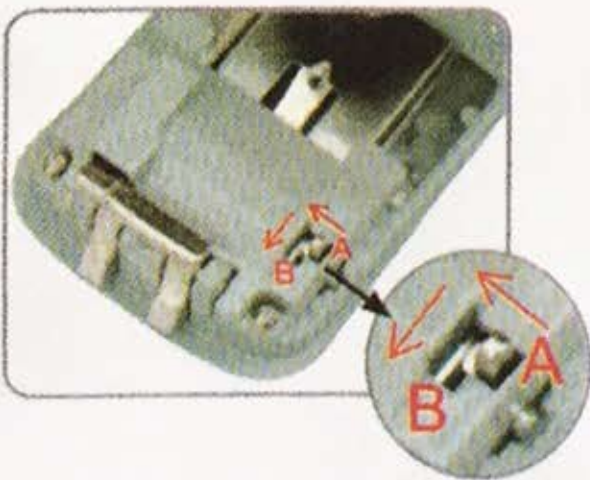

(Pic 1)



(Pic 2)

IMPORTANT NOTES

1. Keep the shutter board closed for water resistance.
2. It is recommended that the dials are rotated weekly to keep them work well.
3. Take a photo to save your password.

Instruction:

On the wall:

1. Open the box, inside there will be 5 holes in the back of the box.
2. Hold the box to the wall and mark position of 3 holes with a pencil. (every small hole diameter = 6mm)
3. Using a masonry drill to drill the holes into wall.
4. Place plastic expanded plugs into the wall.
5. Place box against wall with screws.

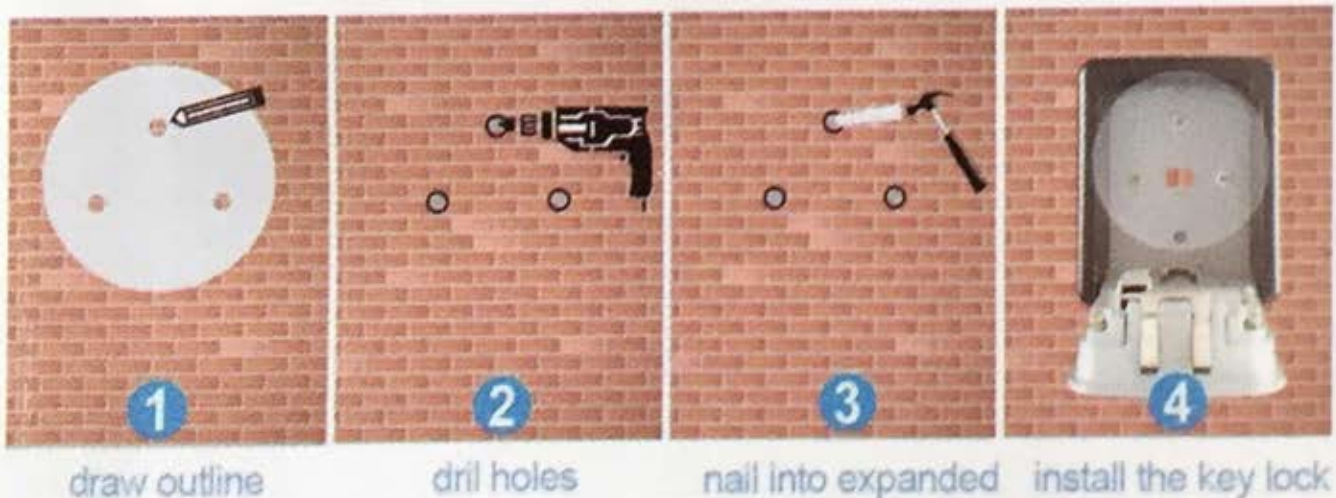

On the peephole:

1. Dismantle the peephole.
2. Install the box by long screw. (Long screw through the backplate then through the the big hole of middle)
3. Fix the backplate and screw on the nut. (The long screw through the peephole then install the other backplate, screw on the nut)