

GASTROBACK®

Operating Instructions **ELECTRICAL DESIGN ICE-CRUSHER**



Art.-Nr. 41127

Important Instructions

- Always clean the appliance right after use and before first usage.
- Ensure the feeding chute is empty and place the ice container in position before turning on the appliance. Ensure that no foreign substance is getting into the feeding chute. **ATTENTION:** The appliance is intended for crushing ice cubes only.
- **IMPORTANT:** Only fill in ice cubes while the motor is running and do not overload the feeding chute. The locking cap has to close automatically.
- If you open the locking cap during operation pieces of ice could spout. Never hold your face over the appliance during operation. Never open the locking cap with your hands during operation. Never put your hand or fingers into the feeding chute or the flap valve to avoid personal injury.
- Turn the appliance 'OFF', wait for the motor to stop completely, and then unplug the appliance, if the appliance is likely to be damaged, the motor runs sluggish slows down or stops.
- Never leave the appliance unattended when the plug is connected to the power outlet. Always **IMMEDIATELY** turn the appliance 'OFF', wait for the motor to stop completely, and then unplug the appliance, if the appliance is not in use (even for a short break) and before assembling, disassembling or cleaning.
- Do not immerse the appliance or power cord in any liquids or spill any liquids on it or place the motor on wet surfaces. Never let any liquids run into the motor or underneath it to avoid electric shock. When liquids are spilled on the motor housing, immediately unplug the appliance and dry the motor housing to avoid risk of electric shock or fire. **Do not** attempt to operate the appliance, when liquids are on or in the motor housing. Immediately unplug the appliance and return the entire appliance (including all parts and accessories) to an authorised service centre for examination and repair.
- **CAUTION: DO NOT** place the appliance in an automatic dishwasher.
- **The appliance is for household only.**

Important Safeguards

Carefully read all instructions before operating and save the instructions for further reference. Do not attempt to use this appliance for any other than the intended use, described in these instructions. Any other use, especially misuse, can cause severe injury or damage by electric shock, fire or moving mechanical parts. These instruction is an essential part of the appliance. When passing on the appliance to a third person, ensure to include these instructions.

Any operation, repair and technical maintenance of the appliance or any part of it other than described in these instructions may only be performed at an authorised service centre. Please contact your vendor.

Safeguards for Daily Operation

- The appliance is designed for normal household quantities. **Do not** operate or store the appliance outdoors or in damp or wet areas.
- **Do not** attempt to operate the appliance using any parts or accessories not recommended by the manufacturer. **Do not** operate the appliance, when the appliance or any part of it is likely to be damaged, to avoid risk of fire, electric shock or any other damage or injury to persons. **Do not** attempt to open the motor housing or to repair the power cord. Check the entire appliance regularly for proper operation. The appliance is likely to be damaged if the appliance was subject to inadmissible strain (i.e. overheating, mechanical, or electric shock) or if there are any cracks, excessively frayed parts, distortions or the motor stalls or stuck. In this case, immediately unplug the appliance and return the entire appliance (including all parts and accessories) to an authorised service centre for examination and repair.
- **Do not** lift, pull or carry the appliance by the power cord. To move or operate the appliance, always grasp the motorblock.
- Close supervision is necessary when the appliance is used near young children. **Do not** let young children play with any parts of the appliance or the packaging. The appliance is **NOT** intended for use by children or infirm persons without supervision. Take care that no one will pull the appliance by the power cord, especially when young children are near.
- Always place the appliance on a clean, dry and stable surface where it is protected from inadmissible strain (i.e. mechanical or electric shock, overheating, frost, moisture) and where young children cannot reach it.
- Operate the appliance on a well accessible, stable, level, dry, and suitable large surface. **Do not** place the appliance or any part of it on or near hot surfaces (heater, gas burner, grill, or oven). **Do not** place the appliance near the edge of the table or

counter or on inclined or wet surfaces or where it can fall. Keep the entire appliance away from direct sunlight and sharp edges.

- Never leave the appliance unattended when the plug is connected to the power outlet. Always **IMMEDIATELY** turn the appliance 'OFF', wait for the motor to stop completely, and then unplug the appliance, if the appliance is not in use (even for a short break) and before assembling, disassembling or cleaning.
- **Do not** immerse the appliance or power cord in water or any other liquid. **Do not** pour or drip any liquids on the motor housing or power cord. When liquids are spilled on the motor housing, immediately unplug the appliance and dry the motor housing to avoid risk of electric shock or fire. **Do not** attempt to operate the appliance, when liquids are on or in the motor housing.
- **Do not** place the motorblock in an automatic dishwasher!
- To avoid damage, **do not** use any abrasive cleaners, corrosive chemicals (i.e. disinfectants, bleach) or cleaning pads for operation or cleaning. **Do not** use any hard or sharp utensils for operation or cleaning. Always handle the entire appliance and all parts of it with care and without violence.
- Ensure the feeding chute is empty and that the ice container is in the right position before you start operating (see 'Operating the Ice-Crusher'). The processed ice cubes should not contain any foreign substance. After operation get leftover ice out off the feeding chute.
- Always **IMMEDIATELY** turn the appliance 'OFF' and pull the plug if malfunction occurs (i. e. the crushing gear cants). Do not operate the appliance if the crushing gear or the motor runs sluggish or seems to be damaged. The appliance is likely to be damaged if the appliance was subject to inadmissible strain (i.e. overheating, mechanical, or electric shock) or if there are any cracks, excessively frayed parts, distortions or the motor stalls or stuck. In this case, immediately unplug the appliance and return the entire appliance (including all parts and accessories) to an authorised service centre for examination and repair.
- Do not overload the feeding chute and do not process anything but ice cubes to avoid damaging the motor.
- **The appliance is for household only.**

Movable units – risk of injury

- **Never** put your hands, hair or other foreign substance (such as cloth, brush, towels) into the feeding chute when the motor is running or the appliance is connected to the power outlet. If the crushing gear is canted or the motor stops during operation act according to the chapter 'Trouble Shooting' page 21.

- If you open the locking cap during operation pieces of ice could spout.
- Never hold your face over the appliance during operation. Never open the locking cap with your hands during operation.

Important Safeguards for all Electrical Appliances

- Always operate the appliance near a suitable wall power outlet and connect the appliance directly to the power outlet. Do not use any extension cords or a multiple desk outlet.
- Ensure that the voltage rating of your mains power supply corresponds to the voltage requirements of the appliance (220/230 V, 50 Hz, AC). Always connect the appliance directly to a mains power supply wall socket with protective conductor (earth/ground) connected properly. The installation of a residual current safety switch with a maximum rated residual operating current of 30 mA in the supplying electrical circuit is strongly recommended. If in doubt, contact your local electrician for further information.
- **Do not** leave the appliance unattended while connected to the power supply. Always turn the appliance 'OFF' and **IMMEDIATELY** unplug the appliance after operation and if it is not in use (even for a short break) and before cleaning and/or assembling or disassembling. Always grasp the plug to disconnect the appliance from the power outlet.
- Always handle the power cord with care. **Do not** pull or strain the power cord. The power cord may never be knotted or squeezed. **Do not** let the power cord hang over the edge of the table or counter. Take care not to entangle in the power cord. **Do not** touch the appliance with wet hands to avoid risk of electric shock. **Do not** touch the appliance, if it is damp or wet or is touching wet surfaces while connected to the mains power supply. In this case, immediately unplug the appliance and dry the appliance (see 'Care and Cleaning').
- Do not immerse the appliance or power cord in any liquids or spill any liquids on it or place the motor on wet surfaces. Never let any liquids run into the motor or underneath it to avoid electric shock. When liquids are spilled on the motor housing, immediately unplug the appliance and dry the motor housing to avoid risk of electric shock or fire. **Do not** attempt to operate the appliance, when liquids are on or in the motor housing.
- **Never** use the appliance if the power cord, the plug or the appliance are damaged. The appliance is likely damaged if it does not operate as intended or liquid got into the motor housing. In this case, immediately unplug the appliance and return the entire appliance (including all parts and accessories) to an authorised service centre for examination and repair.

Get to know your Ice-Crusher

Carefully read all instructions before operating and save the instructions for further reference.

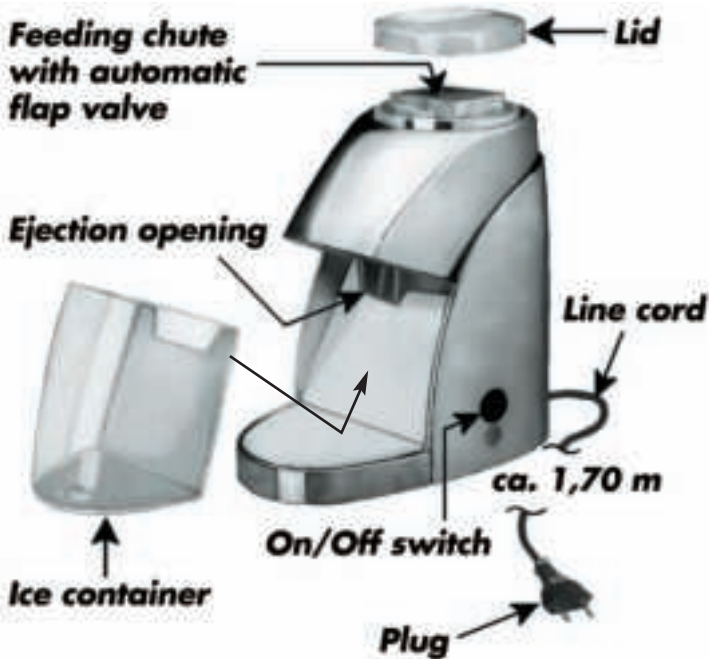

The GASTROBACK electrical Ice-Crusher is intended for crushing ice that fits through the opening of the feeding chute. Do not use force filling in the ice cubes. The appliance is crushing ice using a 60 Watt motor. To avoid injury with spouting ice the feeding chute covers automatically with a locking cap. Using slight pressure the locking cap opens inwardly. The Ice-Crusher is easy to handle and maintenance-free. Always clean the appliance after use. The appliance is for household use only! There is an ice spoon included in delivery.

Operating the Ice-Crusher

Before first use

After unpacking, remove all promotional and packing materials as well as any foreign objects. Before first use and after a long period of storage, clean the appliance with a damp soft cloth and warm soapy water (see 'Care and Cleaning').

Operating the Ice-Crusher

During operation melt water or condensation water can develop. Keep a dry absorbent towel ready to dry off running water on the working surface.

WARNING – To avoid injury by electric shock: Never let any water run underneath the appliance or place wet towels underneath it.

Place the appliance on a suitable, stable, dry, and clean working surface and get the appliance ready-for-use:

1. Take off the lid and ensure there is no foreign substance in the feeding chute.
2. Place the ice container in position.
3. Put the plug into the power outlet.

Crushing the ice:

IMPORTANT: Only fill in ice cubes while the motor is running and do not overload the feeding chute. The locking cap has to close automatically.

4. Turn the appliance on.
5. Fill in the ice cubes.

For the case that the locking cap does not open automatically push the ice cubes with slight pressure down using the ice spoon. Do not use force!

IMPORTANT: Only fill in ice cubes that fit through the opening of the feeding chute without using any force and ensure that no foreign substance gets into the feeding chute.

WARNING: Never put your hands, hair or other foreign substance (such as cloth, brush, towels) into the feeding chute when the motor is running or the appliance is connected to the power outlet. If you open the locking cap during operation pieces of ice could spout. Never hold your face over the appliance during operation. Never open the locking cap with your hands during operation. Never put your hand or fingers into the feeding chute to avoid personal injury.

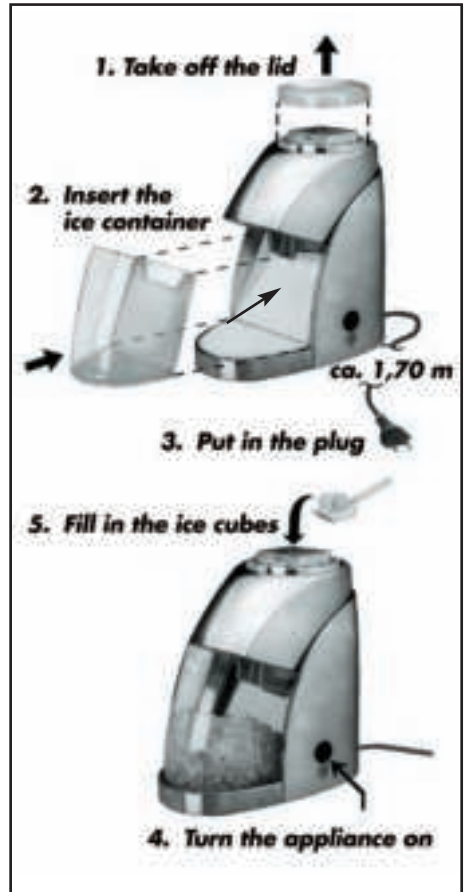

Empty the ice container the latest if the ice container is filled up to 3/4 of its height (see picture):

6. Turn the appliance off.
7. Take out the ice container.

ATTENTION: Turn the appliance off after 10 minutes to avoid overheating the motor and let the motor cool down for 10 minutes.



The appliance is not intended for permanent operation.

After use

8. If you are finished with your operation turn the appliance off and pull the plug.
9. Empty the feeding chute and the container.

IMPORTANT: If necessary and the crushing gear moves sluggish empty the feeding chute according to the instructions 'Trouble Shooting'.

10. Clean the appliance and dry them carefully according to the instructions 'Care and Cleaning'.

Care and Cleaning

Always clean the appliance right after use. **WARNING** – To avoid injury to persons and damage, always turn the appliance 'OFF', wait for the motor to stop completely and unplug the appliance, immediately after operation and before assembling/disassembling or cleaning the appliance. **Do not** place the appliance in an automatic dishwasher or pour boiling water over it. Do not immerse the motor or power cord in any liquids or spill any liquids on it or place the motor on wet surfaces.

1. Always turn the appliance 'OFF', wait for the motor to stop completely, and unplug the appliance from the power outlet before you start cleaning. Take the lid off and remove leftover ice out of the feeding chute and the container (see 'Trouble Shooting'). Put the empty ice container back in position.
2. If you have only crushed pure ice cubes you can move on to point 3.
Before first use or crushing ice with flavour, clean the feeding chute and the crushing gear really carefully with a nylon washing brush.

ATTENTION: Do not use abrasive cleaners, cleaning pads, corrosive chemicals (disinfectants, bleach) or any sharp or hard objects (i.e. metal scouring pads) for cleaning,

for this could damage the surfaces. Always handle the entire appliance with care and without violence.

Dip the nylon washing brush in warm soapy water. Open the locking cap with your fingers and move the nylon brush in circles to clean the feeding chute. Rinse the brush with clear water afterwards and repeat the procedure.

3. Rinse the feeding chute with a little bit of clear, cold water.
4. Take the ice container and empty it. Moisten a clean, soft cloth with warm soapy water and wipe the surface of the appliance and the ice container.
5. Dry the appliance and all the units. Assemble the appliance.

Storage

Always clean the appliance before storing (see 'Care and Cleaning'). Ensure to store the appliance where it is clean, dry and safe from frost, direct sunlight and inadmissible strain (mechanical or electric shock, heat, moisture) and where it is out of reach of young children. Place the appliance on a clean and stable surface, where it can not fall. Do not place any hard or heavy objects on the appliance. To avoid touching the blade unintentionally, it is good advice to store the blade in the container with the lid in place.

Trouble shooting

If the feeding chute is overloaded or you filled in ice before you started the motor the motor might stucks, stalls or run sluggish. Act upon the following instructions:

1. Turn the appliance off and pull the plug out of the power outlet.
2. Take the leftover ice out of the feeding chute. Act upon the following instructions:

WARNING – To avoid injury to persons and damage, **never** place your fingers or foreign substance into the feeding chute while the appliance is still connected to the power outlet. Always turn the appliance 'OFF' and unplug the appliance before assembling/disassembling or cleaning the appliance.

Remove the ice container. Hold the locking cap open with one hand and turn the appliance upside down over the sink.

ATTENTION: Turning the appliance around ensure that no water can run into the motor housing. Dry the appliance before turning it if necessary. Carefully shake the appliance to get the stucked ice cubes out of the feeding chute.

3. Turn the appliance into the upright position, dry it and put the ice container in position.
4. Put the plug into the power outlet and turn the appliance on. The motor should

run smooth again. Otherwise return the entire appliance (including all parts and accessories) to an authorised service centre for examination and repair.

Waste disposal

The appliance has to be deposited by the definition of the regional waste disposal of electricalscrap.

If necessary get information of the regional waste management enterprise.

Warranty

We guarantee that all our products are free of defects at the time of purchase.

Any demonstrable manufacturing or material defects will be to the exclusion of any further claim and within 2 years after purchasing the appliance free of charge repaired or substituted.

There is no Warranty claim of the purchaser if the damage or defect of the appliance is caused by inappropriate treatment, over loading or installation mistakes.

The Warranty claim expires if there is any technical interference of a third party without an written agreement.

The purchaser has to present the sales slip in assertion-of-claims and has to bear all charges of costs and risk of the transport.

GASTROBACK GmbH

Gewerbestraße 29

D-21279 Hollenstedt/Germany

<http://www.gastroback.de>

E-Mail: info@gastroback.de