

PHIPRO Series Therapy Light

User Manual

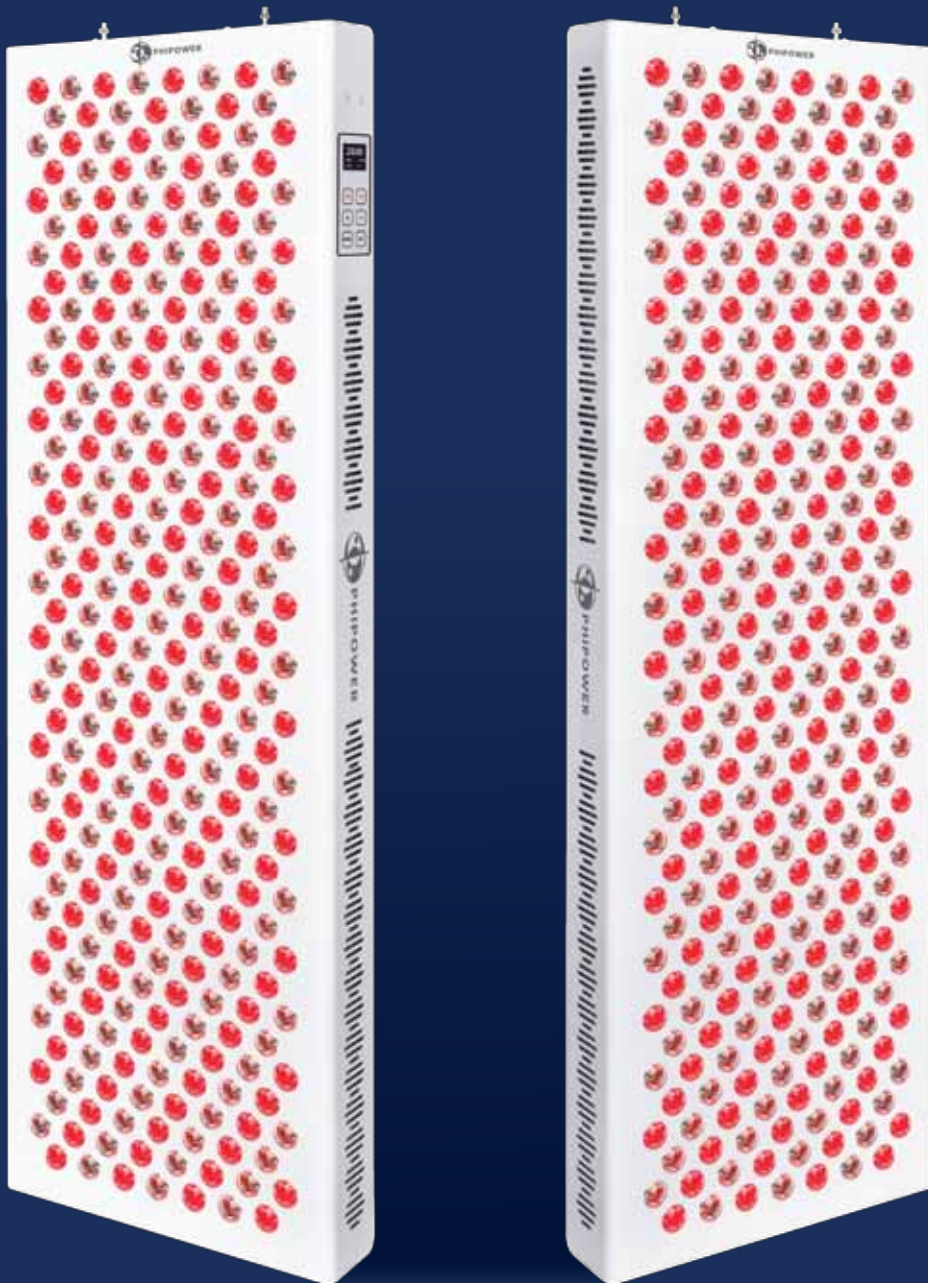

Light Therapy Overview

The benefits of red light: Red light between 600-700nm offers benefits for skin texture and tone, smoothing fine lines and wrinkles, promoting collagen production and generally rejuvenating the appearance of skin and hair.

The benefits of near-infrared light: Near-infrared light (NIR) 700nm - 1100nm. penetrates deeper into the tissues to assist with wound healing, muscle recovery, nerve injury and joint pain.

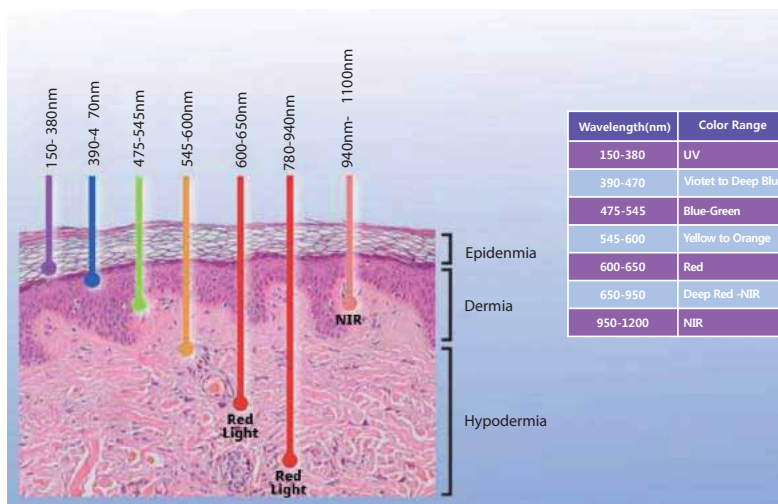

Red light boosts cellular energy production

The most well studied mechanism of action surrounding red and near infrared light therapy is increased mitochondrial energy production in the cells. Mitochondria are tiny organelles that are the energy power plants of all the cells in our body. Red and near infrared light therapy helps the mitochondria create more of that energy.

The specific photons found in red and near infrared light interact with a photoreceptor within our cells called cytochrome c oxidase. This interaction stimulates the mitochondria in our cells to use oxygen more efficiently, which allows the mitochondria to produce more ATP (adenosine triphosphate). Adenosine triphosphate is a complex organic chemical that provides energy to drive many processes in living cells, e.g. muscle contraction, nerve impulse propagation, and chemical synthesis. Found in all forms of life, ATP is often referred to as the "molecular unit of currency" of intracellular energy transfer. When our cells have more energy, they simply perform better and the body follows suit!

Light Therapy Overview

What is Red and Near-Infrared Light Therapy?

Red and near-infrared light therapy are one of the biggest break-through discoveries in health in the last half century. Scientists have quietly accumulated thousands of studies on the power of red and near-infrared light to enhance human health for the past several decades.

Red and near-infrared light are the electromagnetic spectrum, and more specifically part of the spectrum of light emitted by the sun. The photo below demonstrates the type of light that affect the function of our cells.

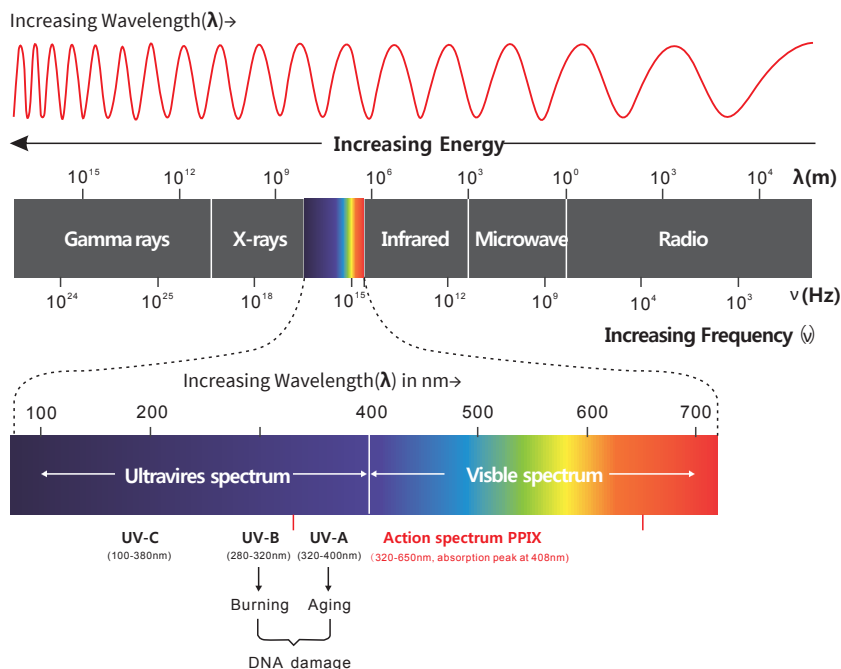

The red and near-infrared wavelengths have amazing effects on our bodies. Most research showing benefits of red and near-infrared light has used wavelengths in the narrow ranges of 630-680nm and 800-880nm.

PHIPRO1500



LED Power	1500W
Wavelengths	RED 660nm & NIR 850nm
Amps @110v	4.86A
Amps @220v	2.25A
Dimensions	35.8" x 11.8" x 2.6"
Power Consumption	500W
LEDs	300 x 5W
Beam Angle	30 Degree
Cooling Fans	4pcs
Weight	10.8KG/23.8LBS
LED Lifespan	100,000hrs
Flicker	Flicker Free
EMF Emission	- Negligible
Warranty	3 Years
Best For	Full Body Treatment
Max Area	47" x 24"

PHIPRO1500 Irradiance

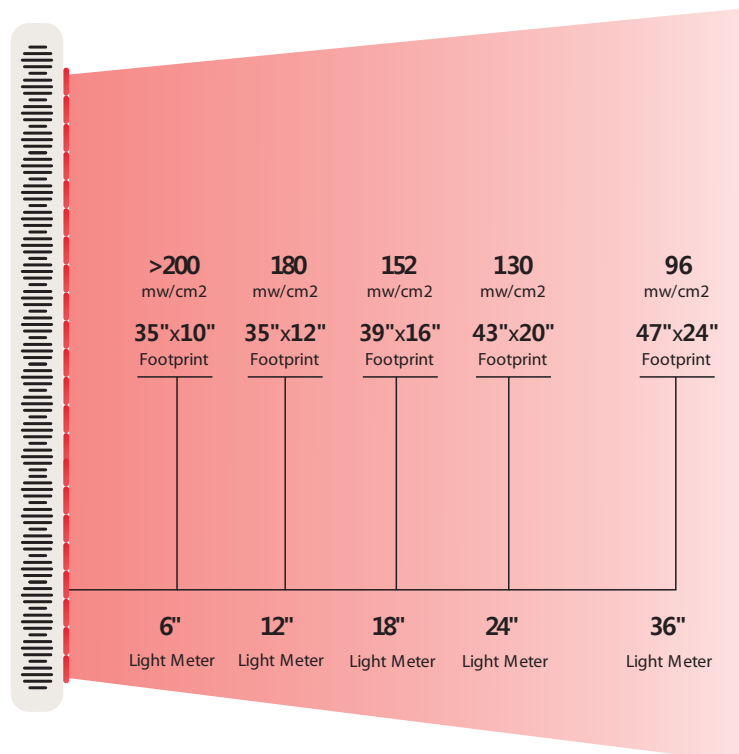

Setting up Your PHIPRO Series Light

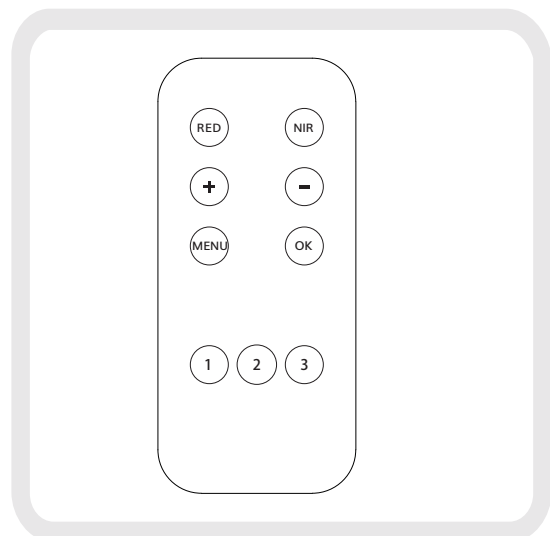
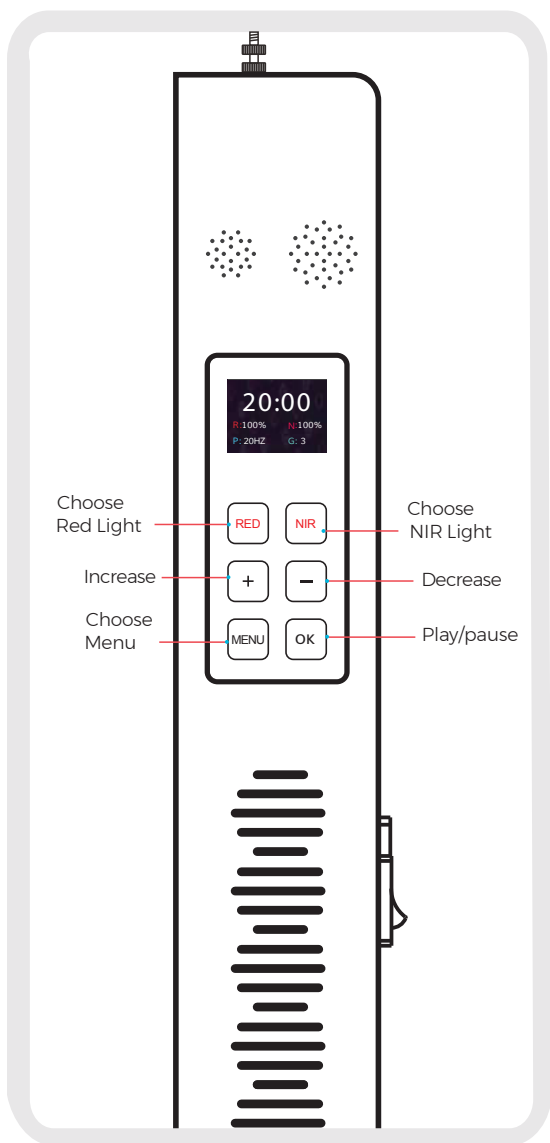

STEP ▶

- RED** Choose Red light
- NIR** Choose NIR light
- +** Increase time value, brightness percentage, group number, Pulse value
- Decrease time value, brightness percentage, group Number, pulse value
- MENU** Cyclically, you can switch time, group, pulse
- OK** Press the **OK** button once, start your treatment session. You can pause/resume the treatment at any time by pressing the **OK** button.



Note: A beep sound halfway in session, remind you can turn around.

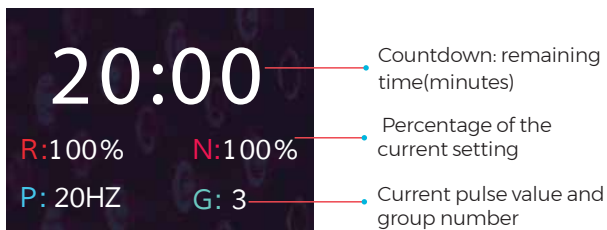
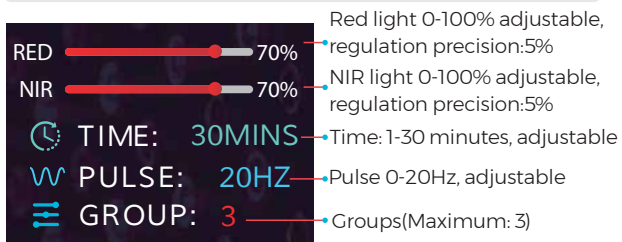

Remember that near infrared LEDs emit light that is NOT visible to the naked eye.

- 1 Press **1**, then press other buttons to set the brightness, time, pulse, all lights in Group 1 will follow the settings and work at the same time.
- 2 Press **2**, then press other buttons to set the brightness, time, pulse, all lights in Group 2 will follow the settings and work at the same time.
- 3 Press **3**, then press other buttons to set the brightness, time, pulse, all lights in Group 3 will follow the settings and work at the same time.

te: Please set the light in Group 1 or 2 or 3 first.



PHIPRO1500 Accessories

1. LED Therapy Light

3. Door Hook

5. Hanging Hardware

7. Patch Cable

2. Eye Protection

4. Remote control

6. Power Cable

8. Cable Assembly & Snap Links

Install Your Therapy Light

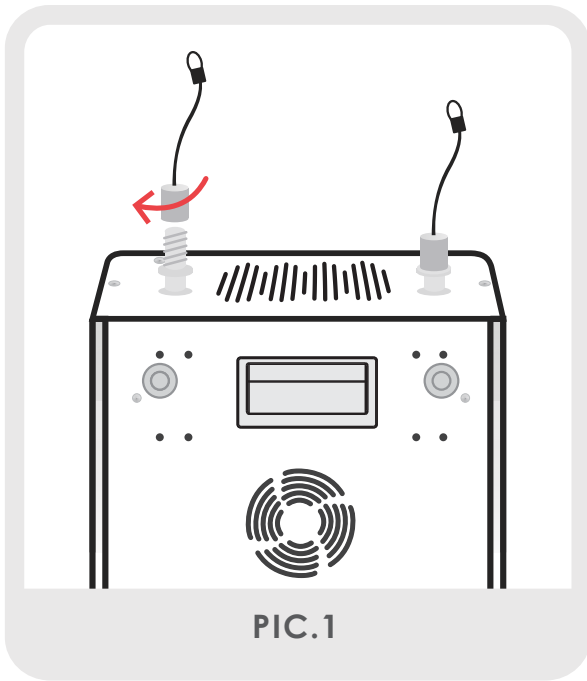

STEP 1 ▶

Lay all of the included hardware, including your Panel, on a padded surface. Next, screw in the threaded posts to the top of the device and hand-tighten with the included Allen wrench. Then, screw the cable supports to the threaded posts, as shown in PIC.1.

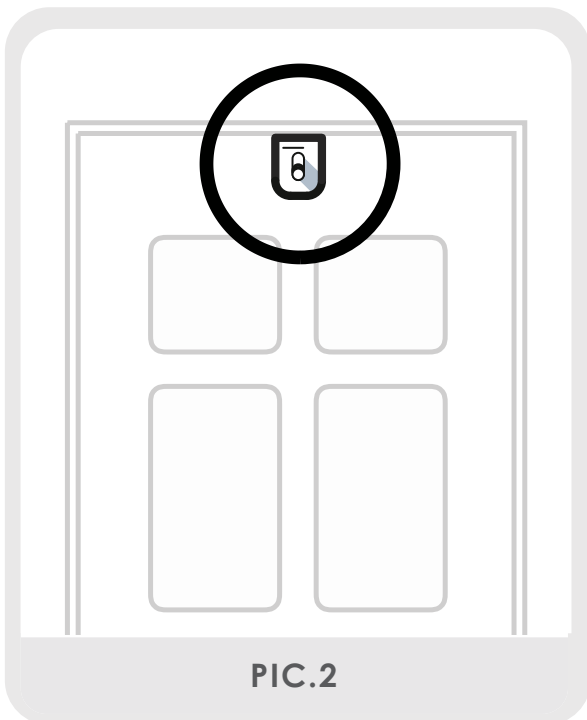

STEP 2 ▶

Hang the included custom hook on any standard-sized door, as shown in PIC.2.

Install Your Therapy Light

STEP 1 ▶

Connect the cable supports to the snap link attached to the height-adjusting system. Then, connect the snap link on the opposite end directly to the door hook, as shown in PIC.3.

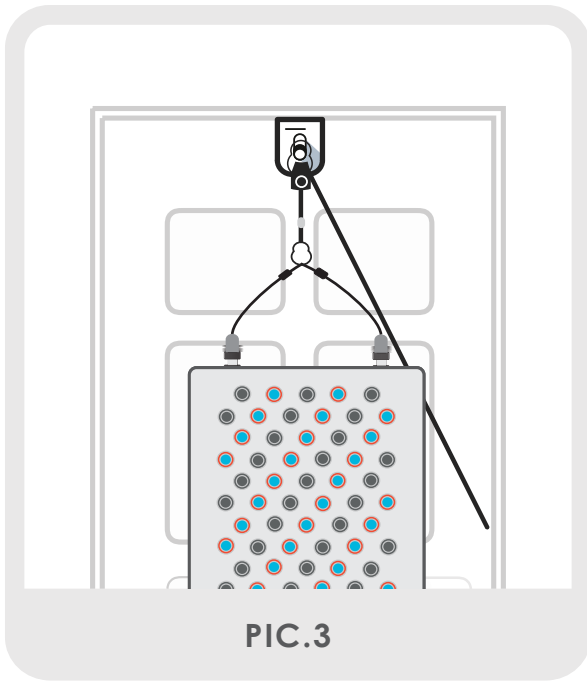

STEP 2 ▶

To raise your Panel to your desired height, pull down on the loose cable while supporting the device with your opposite hand, as shown in PIC.4.

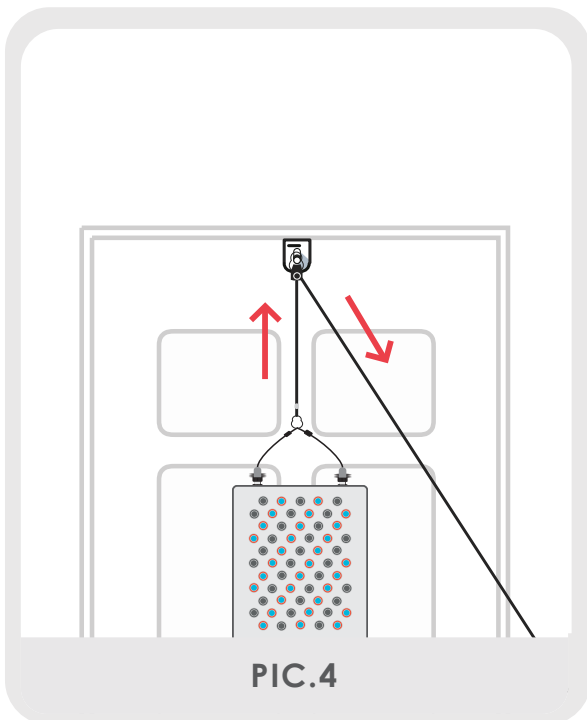

Be sure to adequately support the device while raising and lowering it with the height-adjusting system .

Connecting Multiple PHIPRO Series Light Units

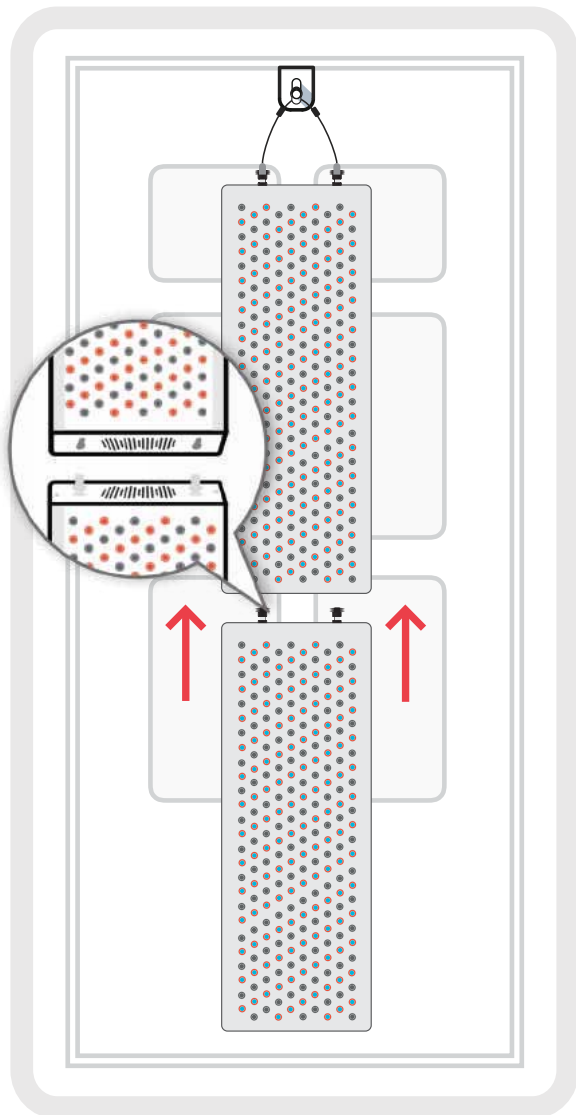

STEP ▶

To connect the lower device, lift it into position below the lead device that is already in place. Line up the threaded posts with the holes in the end caps of the upper device. Then, slide the lower threaded posts into the holes, and slide forward to lock in place.

Instructions

- Distance: Apply from 6-12 inches.
- Session Time: Continue for 2-15 minutes, depending on distance.
- Frequency: Do this 2 times to 4 times a week until results are felt.
- Maintenance: Continue using several times a week.

Warranty Card

Contact Information

Product

Comments

Warranty Clauses

1. Our products are warranted against defects in materials and workmanship for a period of THREE (3) YEAR from the purchase date.
2. Free replacements are warranted for a period of SIX (6) MONTH.
3. Warranty does not cover the following damage(s): product been modified, , improper installation or use, improper clean, electrical surges, or nature caused damage.
4. Warranty does not cover the loss of third party with direct or indirect damage(s).

Warning & Clean

1. Unplug fixture before cleaning.
2. Do not use cleaning sprays. Wipe with a dry or lightly damp cloth to clean.