

6. Wireless remote control

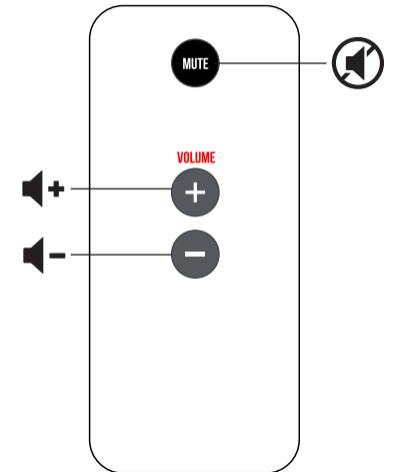

7. Volume control

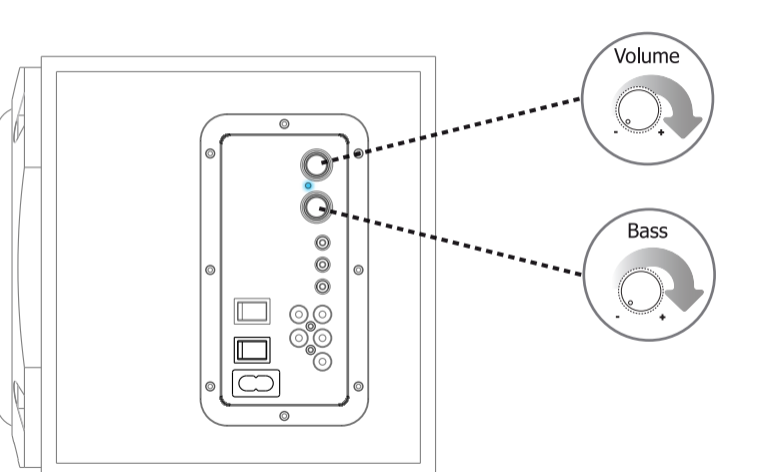

8. Installation Windows 10/8/7

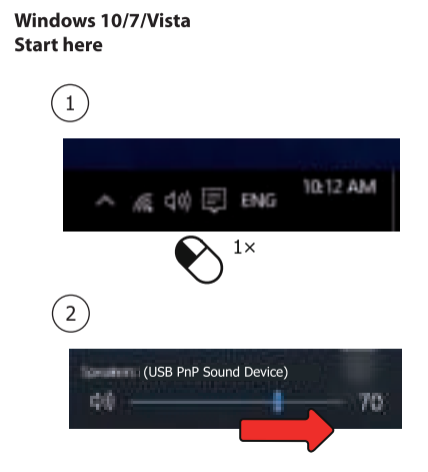
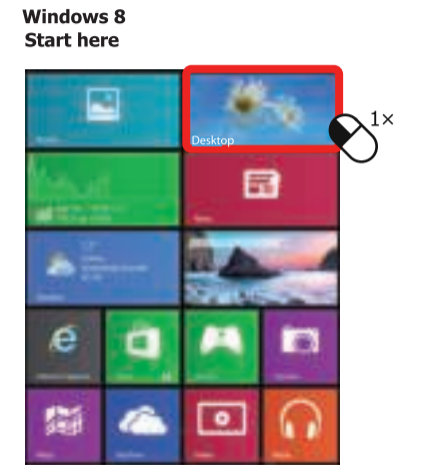

9. ECO Mode

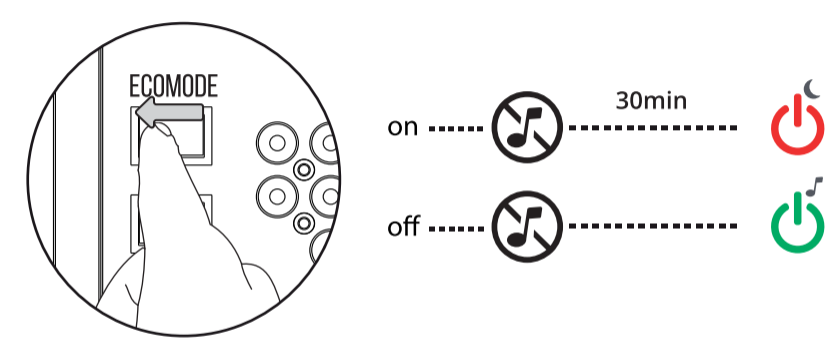

Frequently Asked Questions www.trust.com/21786/faq
©2017 Trust International B.V. - All rights reserved - Laan van Barcelona 600 - 3317DD - Dordrecht - NL



5.1 SURROUND
PC speaker system



Quick Installation Guide

1. Package contents

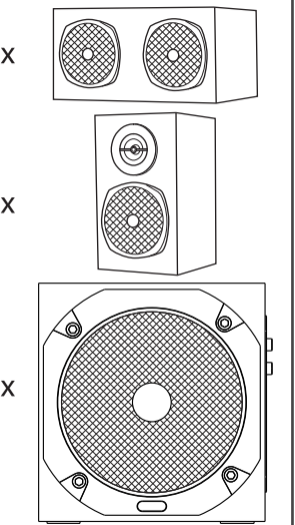
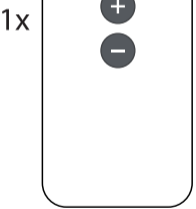
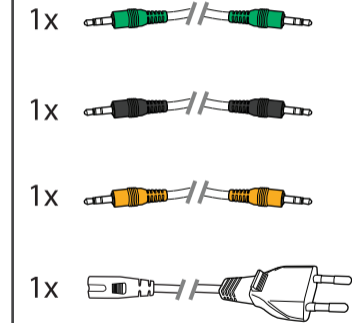

2. PC - 5.1 surround setup

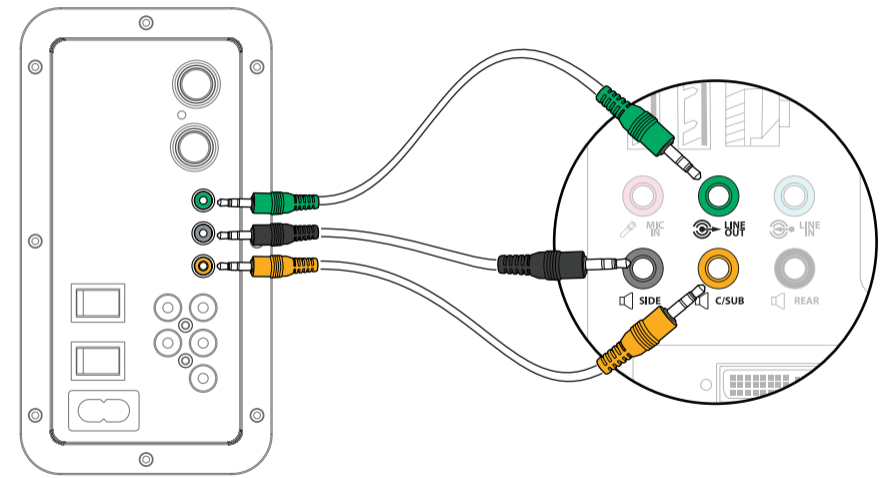

3. Speaker setup 1/2

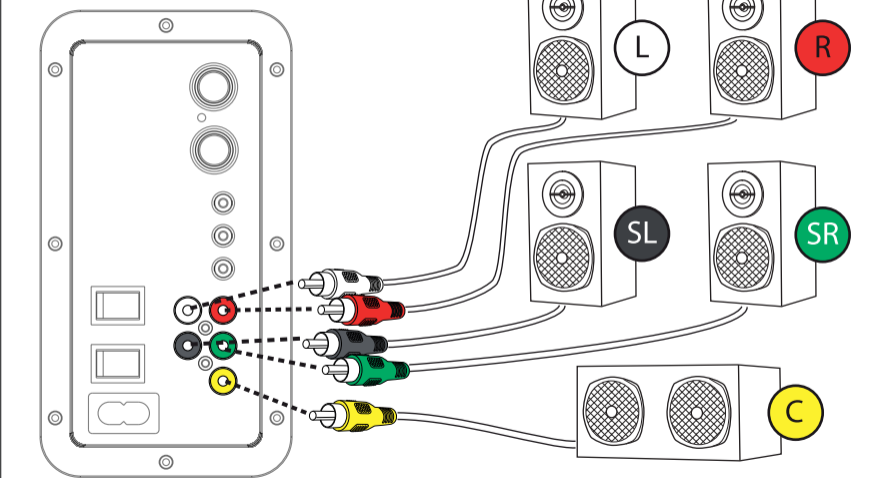

4. Speaker setup 2/2

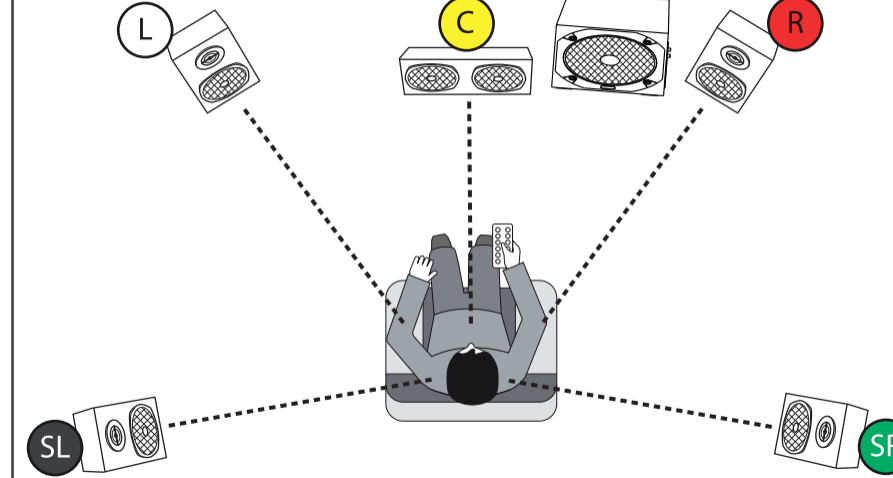

5. Power On

