

**PLEASE READ CAREFULLY THIS INSTRUCTION MANUAL AND
KEEP IT IN A SAFE PLACE FOR FUTURE REFERENCE!**

KIDS' TOY TRICYCLE „VECTOR MG”

VECTOR



This product **Chipolino** is produced in accordance with Toy safety Directive 2009/48/EC of the European Parliament and the Council, the standards applicable for this toy and the regulations of national legislation.

FOLLOW ALL WARNINGS, INSTRUCTIONS AND RECCOMENDATIONS IN THIS MANUAL IN ORDER TO GUARANTEE THE SAFE USE OF THIS PRODUCT:

CAUTION! WARNINGS!

- ❖ **CAUTION!** USE ONLY UNDER DIRECT ADULT SUPERVISION!
- ❖ **CAUTION!** THIS TOY HAS NO BRAKES!
- ❖ **CAUTION!** THE TOY IS NOT SUITABLE FOR CHILDREN UNDER 1,5 YEARS!
- ❖ **CAUTION!** USE FOR CHILDREN OLDER THAN 1,5 YEARS AND WEIGHT UP TO 25kg.
- ❖ **CAUTION!** DO NOT USE FOR CHILDREN OVER 25KG – DANGER OF OVERLOADING THE TOY!
- ❖ **CAUTION!** BEFORE USING THE TRICYCLE, TEACH THE CHILD THE CORRECT WAY TO USE IT AND THE SAFETY RULES.
- ❖ **CAUTION!** USE THE TOY ONLY FOR ITS PURPOSE.
- ❖ **CAUTION!** USE THE TOY ONLY DURING THE DAY ON EVEN PLAYGROUNDS AND AT A SAFE DISTANCE FROM STREETS OR ROAD LANES FOR VEHICLES.
- ❖ **CAUTION!** KEEP AWAY FROM FIRE OR OTHER HEAT SOURCES!
- ❖ **CAUTION!** TO AVOID THE DANGER OF INJURY ALWAYS REMOVE THE PUSH HANDLE WHEN EVER THE CHILD IS RIDING THE TOY ON HIS OWN!
- ❖ Adult assembly required!
- ❖ **DO NOT** allow presence of children under 3 years before assembly of the TOY is complete. In this way, you will avoid their access to small or loose parts!
- ❖ The TOY is intended for one child at a time **ONLY!**
- ❖ **DO NOT** let other children push the tricycle!
- ❖ The TOY is **NOT** suitable for running or skating!
- ❖ Cease using the TOY if you find missing or damaged parts.
- ❖ **DO NOT** let the child stand on the footrest or the seat to avoid injury.
- ❖ The child must wear shoes when using the TOY!
- ❖ **DO NOT** tie strings or accessories to the TOY in order to avoid the risk of suffocation.
- ❖ **DO NOT** place more than 0,2 kg load in the front storage basket.
- ❖ **DO NOT** place more than 0,5 kg load in the rear storage basket.
- ❖ **DO NOT** put items or luggage in the handle bar or the parent handle in order to avoid risk of injury resulting from the toy's instability and tipping over!
- ❖ **DO NOT** place items or heavy objects in the TOY or on it during storage or transportation to avoid damage to the frame.
- ❖ **DO NOT** use another transport means to move the TOY by pulling it.
- ❖ **DO NOT** allow the child using the TOY or other children around it to touch the wheels or put items in them.
- ❖ Use away from rivers, pools, stairs or hurdles!
- ❖ **Do not** make changes or modifications to the TOY frame! If necessary, contact the retailer or an authorized service center for advice and repair.
- ❖ Use only spare parts, which are approved by the producer and recommended by the distributor or company service! The producer revokes all responsibility in case parts different from the original ones have been used.
- ❖ Keep nylon packages away from children to avoid risk of suffocation!

PRODUCT FEATURES

This is a functional TOY whose purpose is to create in the child initial skills to coordinate its arms and feet when riding a tricycle or bicycle.

IMPORTANT! Remove the parent handle when you are sure that the child can ride the tricycle on his own and unaided.

- ❖ Suitable for children older than 1,5 years with weight up to 25 kg
- ❖ Can be driven by the child using the pedals;
- ❖ Can be pushed by an adult and the child lays his feet on the foot rest
- ❖ Two positions of the seat – **forward facing** and **face-to-face** mode;
- ❖ Push handle is height adjustable;
- ❖ Toy can be folded for better storage;
- ❖ Safety bumper;
- ❖ Foot rest;
- ❖ Adjustable canopy;
- ❖ Safety harness;
- ❖ Cup holder;
- ❖ Front and rear storage baskets.

MAIN PARTS

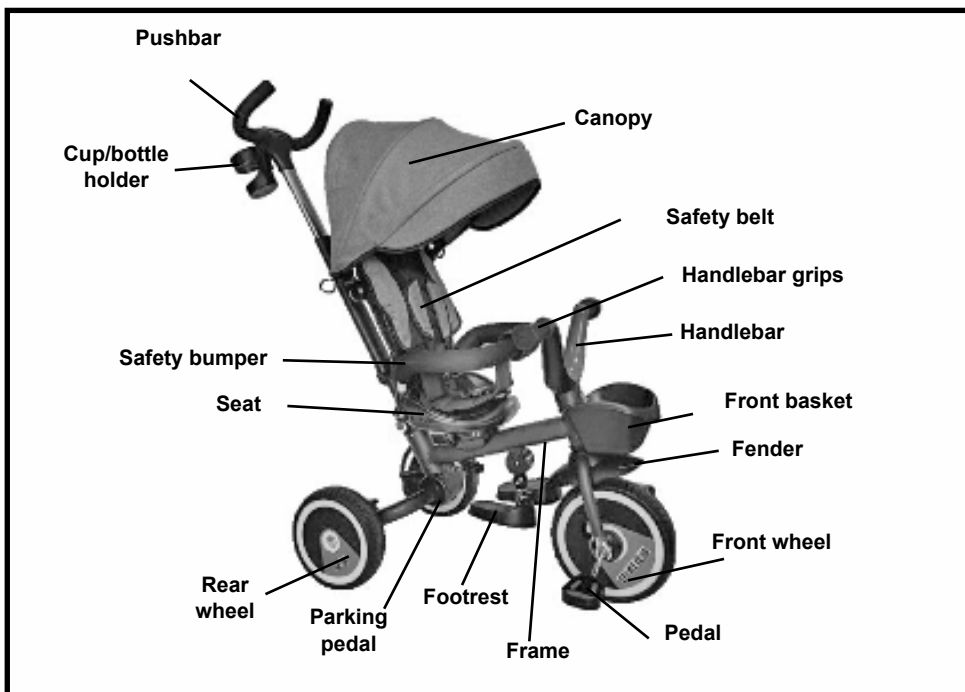

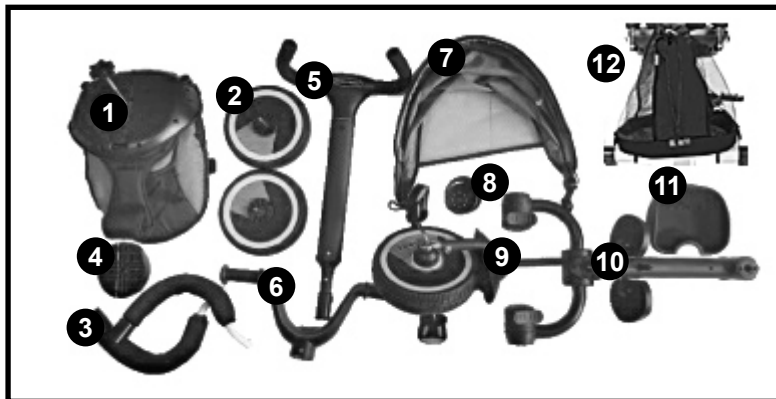

1	Set backrest / seat – 1 pc	7	Canopy – 1 pc
2	Rear wheel – 2 pcs	8	Cup holder – 1 pc
3	Safety bumper – 1 pc	9	Front wheel set – 1 pc
4	Seat base – 1 pc	10	Frame – 1 pc
5	Push handle – 1 pc	11	Front storage basket – 1 pc
6	Handlebar – 1 pc	12	Rear storage basket – 1 pc

Please, make sure if these parts are in the package. Some of the parts may be pre-installed by the manufacturer.

ASSEMBLY INSTRUCTIONS

IMPORTANT! Follow exactly the instructions given and check the pictures. Keep your hands from entrapment!

IMPORTANT! After each operation, make sure that you have followed the instructions correctly and the fixing is stable!

ASSEMBLY

1. ASSEMBLY OF REAR WHEELS.

Unfold the frame and install the rear wheel to the frame.

2. ASSEMBLY OF FRONT WHEEL TO THE FRONT TUBE OF THE FRAME.

3. ASSEMBLY OF THE HANDLEBAR TO THE FRONT TUBE OF THE FRAME.

4. ASSEMBLY OF SEAT BASE.

5. ASSEMBLY OF SEAT TO THE FRAME.

Unscrew the bolt of the plastic hub of the seat and put the seat on the frame.

6. FIXING THE SEAT TO THE FRAME.

Fix the plastic hub with the screw.

7. ASSEMBLY OF SAFETY BUMPER.

8. ASSEMBLY OF FABRIC COVER.

Note: After placing the corresponding part of the fabric cover, close the safety bumper.

9. ASSEMBLY OF CANOPY TO THE BACKREST.

10. FIXING THE CUP HOLDER TO THE PSUH HANDLE.

11. ASSEMBLY OF PUSH HANDLE TO THE REAR PART OF THE FRAME.

12. FIXING THE HANDLE (using the red lever).

13. ASSEMBLY OF REAR STORAGE BASKET ON THE HOOK OF THE PUSH HANDLE.

14. FIXING THE REAR STORAGE BASKET TO THE FRAME (USING VELCRO STRAPS).

15. ASSEMBLY OF FRONT BASKET.

16. FOLDING THE TRICYCLE.

Press the folding button (1). Fold the rear wheels inside (2). Fold the footrest to the frame (3). Fold the backrest (4) and the canopy (5).

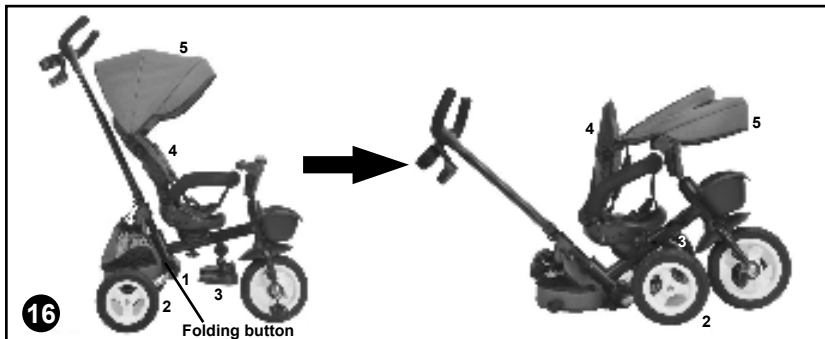

	<p>SEAT CAN BE ADJUSTED IN 2 POSITIONS:</p> <ul style="list-style-type: none"> • FORWARD (facing to the front) and • REARWARD (facing to the back);
--	---

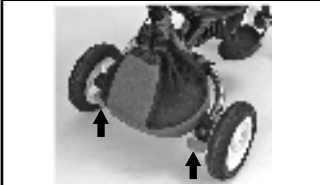

PARKING DEVICE

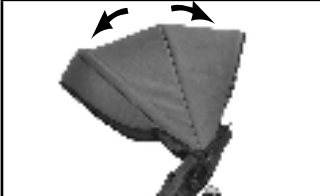

UNFOLD AND FOLD THE CANOPY



CLOSING THE FOOTREST TO THE FRAME

IMPORTANT! When directing the tricycle by the parent handle, use the footrest in unfolded position, and when the child is directing the tricycle by the pedals, fold the footrest to the frame.



ADJUSTING THE HEIGHT OF THE PUSH HANDLE

Press the button and move up/down to desired height.



CUP HOLDER

Opening and closing the front bumper

Safety harness

Adjusting the backrests in different position

GUIDING THE TRICYCLE BY USING THE PUSH HANDLE.

DRIVING THE TRICYCLE BY THE CHILD (AFTER REMOVING THE PUSH HANDLE).

MAINTENANCE GUIDELINES

- ❖ Periodically check the good working order of the tricycle parts.
- ❖ Do not wash it and do not soak it in water. Use a soft damp cloth and water or neutral liquid detergent.
- ❖ Do not use aggressive detergents, containing abrasive particles, ammonia, bleach or spirits.
- ❖ Regularly oil the moving parts.
- ❖ Do not use on sand.
- ❖ Do not store the tricycle in hot environment, in order to avoid the plastic parts from deforming.
- ❖ Store the product in clean and dry place indoors. Do not expose to direct sunlight, moisture or harsh weather!
- ❖ Always let the tricycle to dry out fully before storing or using it, in order to avoid mold and rust. Contact your authorized dealer if consultation or repair is needed

Materials used: plastic, metal, textile – 100% polyester.



TRKVEM21xxx /B56



Bulgaria, Plovdiv, Str. Golyamokonarsko shosse № 1

www.chipolino.com