

VGR[®]

V O Y A G E R

V-305 | PROFESSIONAL MEN'S SHAVER



Fully washable



800 mAh Lithium
battery



USB Charging

WASHABLE  IPX7

E N J O Y C O L O R F U L L I F E

Manual

Safety Instruction

V-305

ENGLISH	01
FRANÇAIS	05
DEUTSCH	09
ITALIANO	13
ESPAÑOL	17
PORTUGUÊS	21

GB ENGLISH

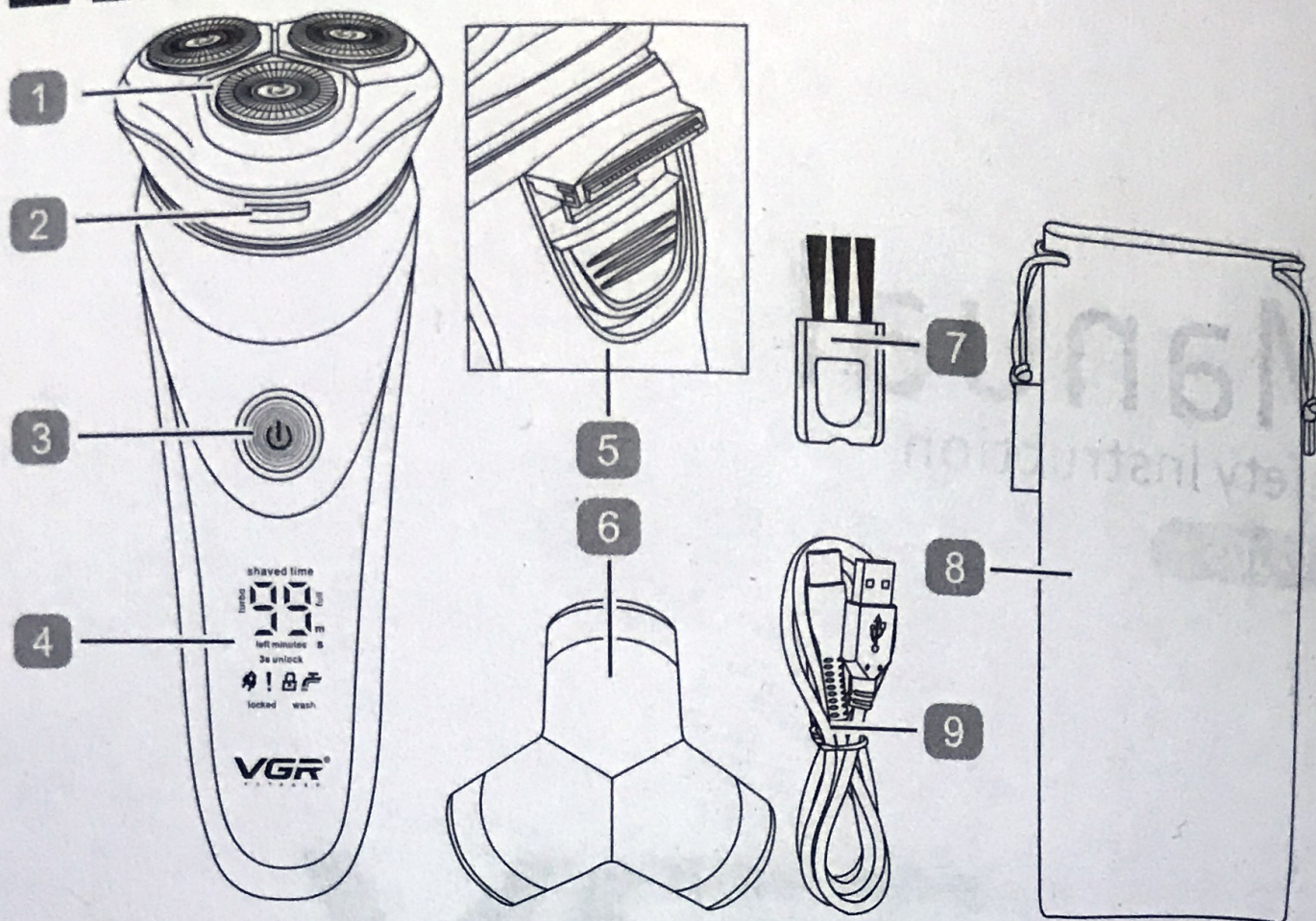

COMPONENTS OF MEN'S SHAVER

1. Shaving head
2. Release button
3. On/off button with turbo
4. LED display
5. Pop-up trimmer
6. Protection cap
7. Cleaning brush
8. Travel pouch
9. USB charging

SAFETY WARNINGS

This appliance may be used by children of more than 8 years of age, persons with physical, sensory or mental capabilities or inexperienced persons only if they have been previously trained in using it in a safe manner, and only if they have been informed of the dangers the product can cause.

Children may not play with the appliance. Children may not clean or carry out any maintenance on the appliance without adult supervision.

GENERAL SAFETY INSTRUCTIONS

It is advisable to save these instructions for a future use.

Always check the product and all accessories before using. Do not use the product or

any accessory if it is damaged, as this may cause injury. Always replace a damaged part with one of the original type.

For hygienic reasons, the product should only be used by one person.

Trimming is easier when the skin and hair are dry.

Do not open the appliance to replace the rechargeable battery.

Never use compressed air, scouring pads, abrasive cleaning agents or aggressive liquids, such as petrol or acetone to clean the appliance.

This appliance is suitable for cleaning under running water or shower. For safety reasons it can only be operated cordless.

Take your time when you first start to use the product. You have to acquire practice with the product.

IMPORTANT: This shaver has a built-in rechargeable battery. Do not throw into fire, apply heat, or charge, use, or leave in a high temperature environment.

HOW TO USE

Dry and wet shaving are all suitable.

Switch on the shaver.

Move the shaving heads over your skin in circular movements to catch all hairs growing in different directions. Make sure each shaving heads are fully in contact your face, neck and even the jaw, fits your face curve perfectly. Note: Do not press too hard as this can cause skin irritation.

For a more comfortable shave, you can also use this appliance on a wet face with shaving foam or gel.

To shave with shaving foam or gel, follow the steps below:

Apply some water to your skin.

Apply shaving foam or gel to your skin.

Note: Rinse the shaving unit regularly to ensure that it continues to glide smoothly over your skin.

POP-UP TRIMMER

It is located on the back of the cordless razor head. You can use the skin-friendly pop-up beard trimmer to shave sideburns, beard shapes, mustache and any facial hairstyle easily.

SMART LED DISPLAY

Travel lock remind: press the on/off button for 3 seconds, the shaver would be locked automatically and press for another 3 seconds to unlock it when you need to use. you will hear a alert sound.

Cleaning indicator: the cleaning indicator flashes per 30 minutes running or suffer stall protection.

Stall protection: the indicator flashes when the hair are full inside, remind you to clean the hair.

Charge indicator: shows the available time. Once less than 5min, the charging plug

flashes to remind you to recharge.

Turbo function: Press the on/off button to turn on the device; press again will turn on turbo function.

With LED lights up, it's very easy to see battery remaining run time, Charge Indicator, Cleaning indicator and Safe lock indicator.

USB CHARGING

This shaver is completely handy to carry and can be charged anywhere with the USB cable.

Rechargeable - Comes with built-in battery, a full charging time 1.5 hours to offer around 100 minutes of running time.

Charging through USB cord (comes with the shaver) Charge the device by connecting with the power bank or adapters (5V \approx 1A), or computer.

Designed with battery status countdown in percentage on large LED display to remind you of recharging when necessary.

CLEANING AND MAINTENANCE

Before starting cleaning the appliance, always switch it off and unplug it.

Cleaning the shaver under the tap, the whole body is washable.

Clean the shaver after every use for optimal performance.

Clean the unit with a damp and soft cloth.

Never use detergents and solvents to clean the appliance.

After having used the appliance remove the cutting guide and using the cleaning brush to clean the device in order to remove any hair from the cutting blade.

TECHNICAL FEATURES

- ON/OFF button
- Complete charging time: 1.5 hours
- 100 minutes of continuous operation
- Power supply: 5V \approx 1A
- Battery: 800mAh lithium battery

SYMBOL



This item is made in conformity with CE



DISPOSAL

The device (including its removable parts and accessories) must not be disposed of together with municipal waste at the end of its life, but in compliance with European Directive 2012/19/EC. Since it must be handled separately from household waste, either carry it to a separately-collected waste disposal centre for electrical and electronic appliances or give it back to the retailer on purchasing a new device with the same purpose. Any infringement will be severely prosecuted.

The built-in rechargeable battery contains substances that may pollute the environment. Always remove the battery before you discard and hand in the appliance at an official collection point. Dispose of the battery at an official collection point for batteries. First unplug the product and let the motor run until the battery is completely empty.

Remove both side panels from the appliance with a screwdriver.

Lift the power unit out of the appliance.

Specifications and designs are based on the latest information available at the time of printing and subject to change without notice.