



### Maintenance

The stove fans do not require particular maintenance in normal operation, wipe it with a clean damp cloth if needed. Do not immerse in water or any cleaning solution. Safely store the fan in the original packaging during the off-seasons.

⑤



### Warranty

Your stove fan is covered by warranty from any manufacturing defect or workmanship for a period of 1 year, from date of purchase. This warranty does not cover accidental damage nor covered for abnormal use. This warranty does not affect your statutory rights.

⑥



### Returns

Should the stove fan become defective or fail to operate under normal conditions, within the warranty period; simply contact the store where the fan was purchased, providing proof, if required, for a returns claim to be raised.

⑦



### Recyclable

All packaging materials and cardboards used are recyclable.

⑧



## Heat Powered Stove Fan

### User Instruction

*The manufacturer reserve the right to improve and amend the product design and the manual which are subject to change without further notification.*



### User Guide

Please read these instructions carefully to avoid injury and to help maintain the product, prevent damage.

①



### Operation

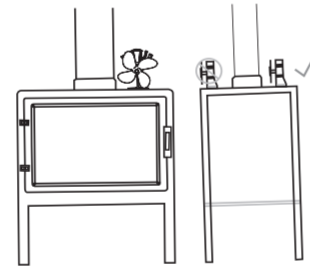

**\*DO NOT position the fan before or near the chimney.**  
**\*Do not over 350°C(662°F)**  
\*The optimum operating temperatures shown are for reference and guide only. They may vary in different environments as they have been tested in controlled laboratory conditions.

②

### How to use the stove fan

#### ① Hold Here

Ensure handle is upright before placing on stove.

#### ② Thermoelectric Module

#### ③ Cooling fans

#### ④ Base

DANGER: when in use the base is hot DO NOT TOUCH!!!

#### ⑤ Heat Sensitive Metal

A safety device to protect the motor from overheating when the surface temp exceeds 250°C(482°F)

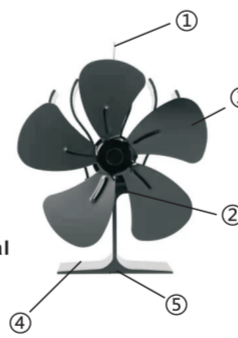

③

### WARNING

**\*The optimum operating temp is 80-250°C (176-482°F), DO NOT OVER 350°C(662°F).**

•A stove fan thermometer is recommended to monitor the temp, to avoid damage to the components due to overheating.

•Never place the fan on an unprotected surface if the fan base is still hot.

•Not recommended to move the fan when in use unless in an emergency. On this occasion, remember to wear gloves to protect against burns or injury by the rotating blades.

•Keep all obstacles at a distance while the fan is in use.

•Please ensure children and pets are supervised around your stove and the stove fan.

•Start temp 50°C. The fan will spin faster as the temperature increases and will slow down as it decreases. The fan base will cool along with the stove once the fuel has burnt.

④

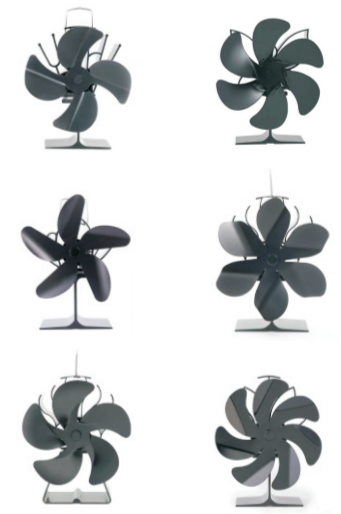

Please recycle