

Fabric shaver

USER MANUAL

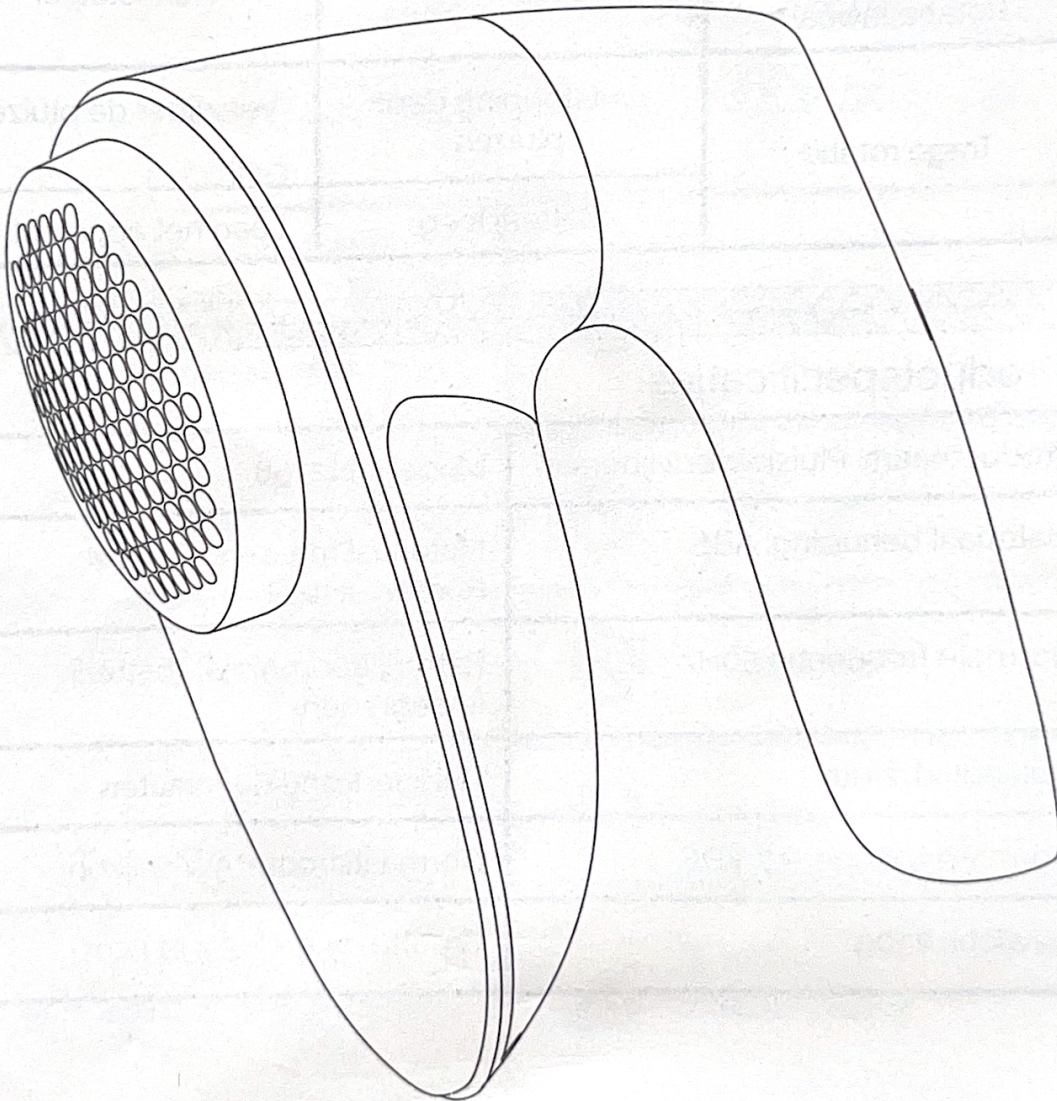

Please read these instructions carefully before use, to prevent damage to your new product.

1 About

Thank you for choosing our product! To ensure proper and safe functioning of the product, please read the manual carefully before use. Please always follow these instructions for safe usage.

2 Package contents

1x	Fabric shaver
1x	Fabric shaver head
1x	Pouch
1x	User manual
1x	Brush
1x	USB kabel
2x	Extra attachments

3 Connecting and charging

1. Please use the regular plug. The red light is on when charging; once it is full, the indicator light turns green; the blue light is on when working; the blue light flashes when the battery is low.
2. It takes 2 hours fully charging. The device can provide up to 60 minutes of working time.
3. When replacing the blade, please pay attention to clasp the rounded corner at the center buckle, otherwise the cutter net will not be properly tightened.

4 Important

1. The product can not contact water directly.
2. The product is not suitable for children under 3 years old.
3. Please clean the lint and dust of the collection box and the cutter head in time.
4. After the net cover is loosened, the switch should not be on.
5. During the cleaning process, the hand should be away from the cutter head.
6. This product should be kept dry and not suitable for use in the bathroom.

5 Product overview

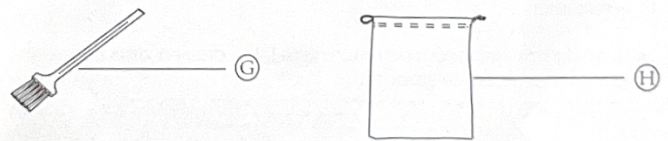
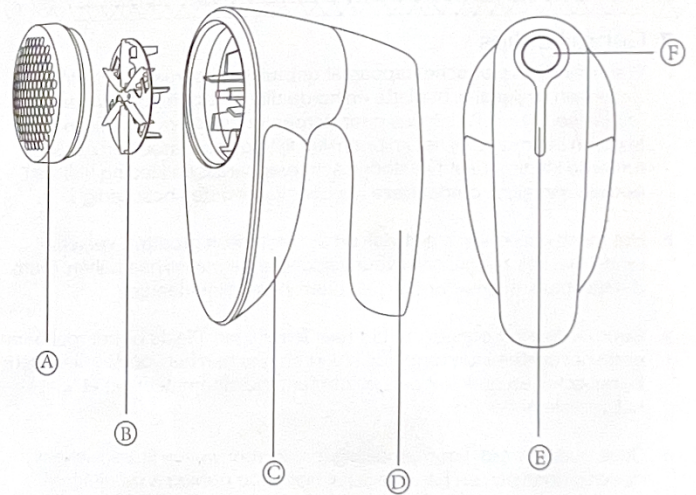

A	Stainless steel net cover
B	Stainless steel blade
C	Lint collection box
D	Rotating handle
E	Charging indicator
F	On/pause/off-button
G	Cleaning brush
H	Drawstring bag
I	Elektrostatic brush

6 Correct use

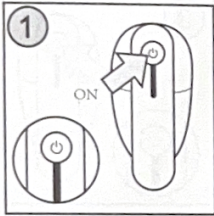

1. Pres the on/off button

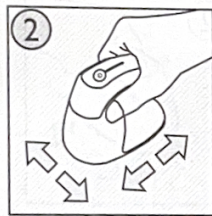

2. Move around the pilling

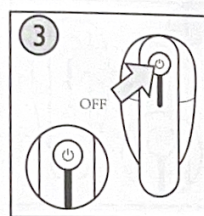

3. Turn off by pressing the button

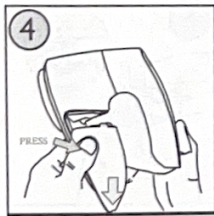

4. Remove the lint collection box and pour out.

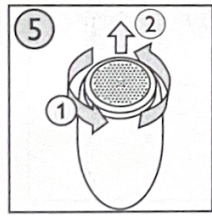

5. Rotate the cutter net counterclockwise

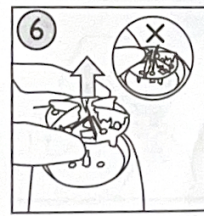

6. Remove the cutter head

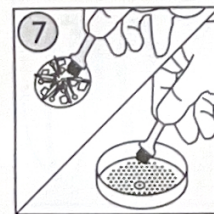

7. Clean the cutter with the added brush

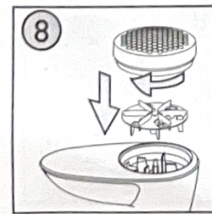

8. Reload the cutter net.

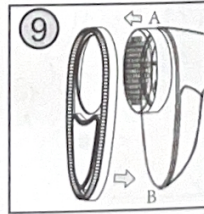

9. Assembling, first the tail (B), then press A.

7 User hints

1. When using the fabric shaver, it is recommended to place cardboard or ironing board, or flat and hard things between the 2 layers of fabric. So you don't have to worry about scratching textures or wrinkles when you trim fine plush coats and textured clothes. Do not let the fabric shaver touch the clothes forcefully, which may cause damage to them.
2. The surface of the mesh is not flat, and there are 3 different sizes of mesh. Different meshes are suitable for different sizes of hairballs: large particulate lint, intensive fuzz, and fine particle pills;
3. When cleaning the hair, use the 2 in 1 brush. When assembling, place the rear end against the tail first, and then make the fore part close to the baffle and press it in; when disassembling, disassemble it along the fore part.
4. This brush is mainly used for woolen coats, sheets, blankets, curtains and sofa cushions. The gray area is the electrostatic brush, used to remove the hair from the coats; the edge part is the dusting brush to remove dust from the clothes.
5. Press the switch to run the machine; press the switch again to stop running.

8 Extra information

The 180-degree rotating Y-handle can be adjusted according to usage habits to choose the best way to grip. The product is suitable for normal temperature environment. Please avoid direct sunlight and high temperature environment, so as to avoid deformation or failure of the product. This product uses USB to charge. The charging time is about 2 hours. There is direct power supply mode. Place your thumb on the back of the handle and the other four fingers on the bottom of the lint collection box. Gently press the handle down with your thumb to remove the lint collection box.

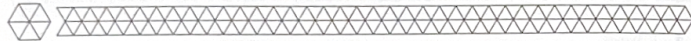





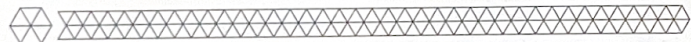

9 Cleaning and care

1. After removing the fabric, use a cleaning brush to clean the lint fragments between the cutter head and the collection box to avoid clogging the cutter head.
2. The product stains can be polished with neutral detergent. Do not wipe the parts with a damp cloth.
3. The built-in cutter head can be rinsed with water and completely dried before installation.
4. Prevent water from entering the interior of the product.
5. Place the product, cutter head and accessories in the storage bag.



10 Warning

This product is suitable for household use. Being overused in commercial use may result in a shortened service life.	 Prohibited
Do not immerse the product in water or near combustion sources.	 Prohibited
Do not place the product at high temperature and direct sunlight.	 Prohibited
Do not use it on a human body	 Prohibited
When the product is found abnormal or damaged, please stop using.	 Warning
When replacing the blade, do not touch the cutter head directly otherwise it would scratch your fingers.	 Warning



11 Troubleshooting

Problem	Possible cause	Solution
Lint pill can not be removed	Blade deformed	Replace the blade
	Blade wear	
Rotation pause	Blade loose	Reinstall
Rotatie noise		
Rotation slow	Backlog of pill fabric	Clean the pill
	Run out of battery	Charge the device

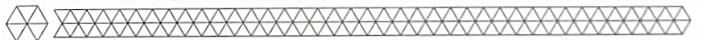

12 Product specifications

Productname: Fabric shaver	Model: SN2268
Outer material: ABS	Material blades + lids: Stainless steel
Normal frequency: 50Hz	Battery 800mAh Li - batterij (included)
Charging time: 2 hours	Duration: About 60 minutes
Normal voltage: 3,7 VDC	Normal current: 5W
Weight: 230g	Dimensions: 14,5 x 8,5 x 21,5cm

CE RoHS

