



WARNING:

1. Please seek the help of qualified technicians to perform the installation procedure. Otherwise injury and/or product damage may result from dropping or mishandling the display.
2. The surface of installation must be a Concrete Wall, Solid Brick Wall or equivalent type which can take the weight of Television.
3. Do not try to mount any equipment other than the specified product. This wall mount is designed for LED / LCD / Plasma TV's ranging from 23" to 42" with a maximum loading weight of 25Kgs [55lbs] Use of heavier screen than the specified weight might result in damage of the TV and the mounting surface as well.
4. Use a track level bar to balance the wall mount during installation for stability. Make sure that you install the TV bracket on a wall that is both perpendicular and flat.
5. Make sure that there is adequate space and distances available for installation as well as swiveling and tilting of the wall brackets [if the features are available in the product]. Avoid covering the view of important information [i.e. traffic information] behind the display panel.
6. Make sure that you tighten the screws securely in the designated position. Do not over tighten the screws.
7. After the installation of TV bracket, secure the cables properly. Do not allow the AC power cord or the connecting cable to be pinched.
8. Do not install on surfaces near the vent of air conditioner, structure that is prone to vibration, places directly blown by moisture, dust, smoke or steam [ex; stove, electric cooker, humidifier etc] and any other source of direct heat energy. Failure to do so might result in damage of the display and could increase the risk of fire.

USER MAUAL

Omega

TV MOUNT

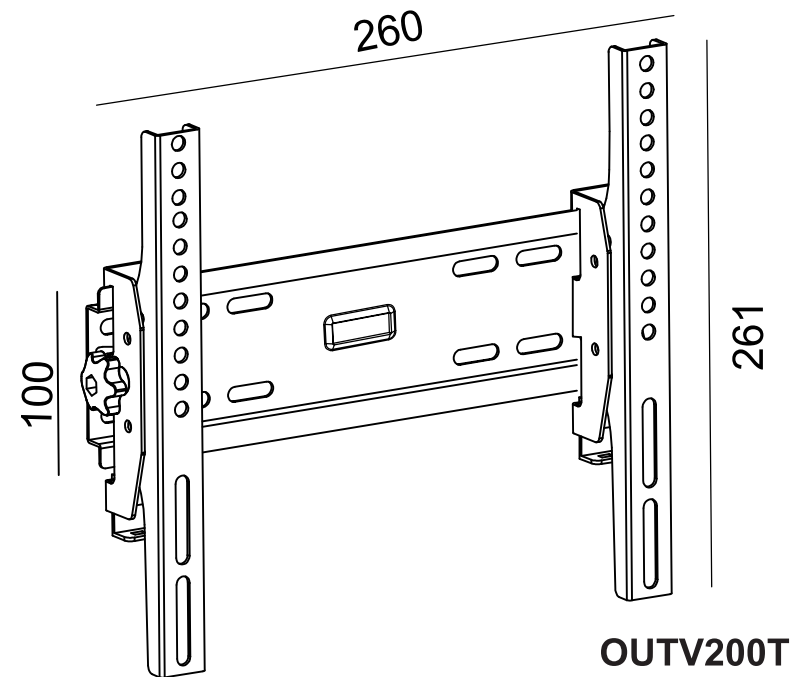
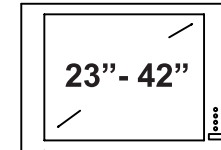

----- INSTALLATION SPECIFICATION:

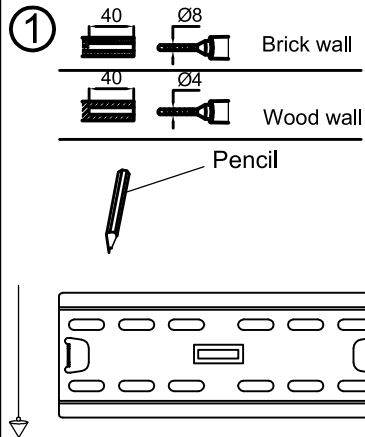

-----Put the hanging bracket vertically onto the qualified wall as picture, and then mark the four drilling holes with a pencil.

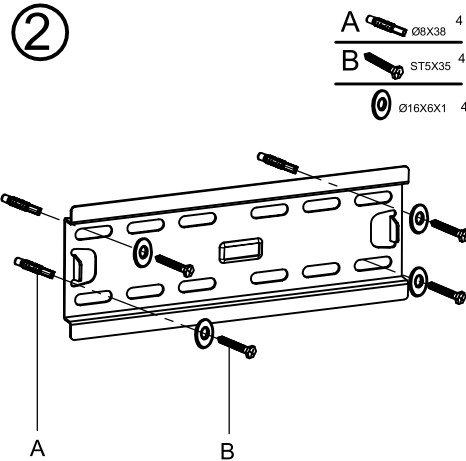

-----Drill holes of Ø8 with a driller over the marks. The holes depth should be 40mm at least. Use part A and B to assemble the LCD bracket onto the wall.

----- INSTALLATION SPECIFICATION:

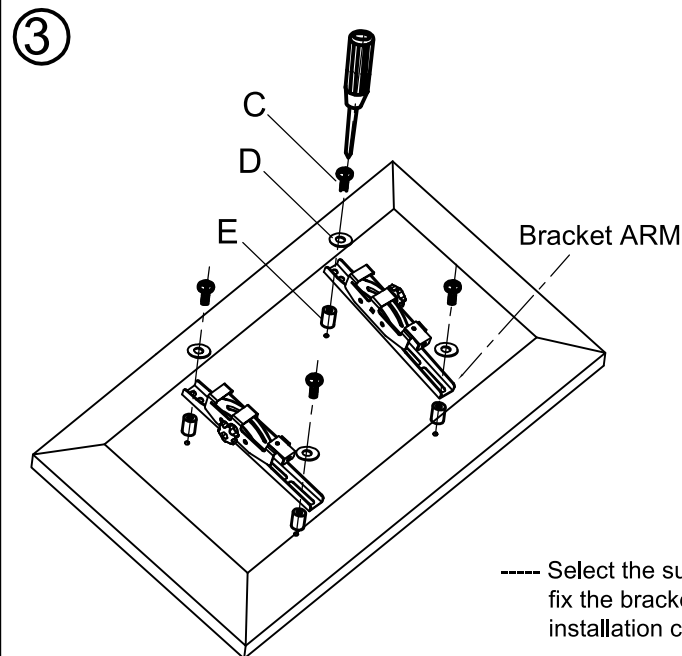
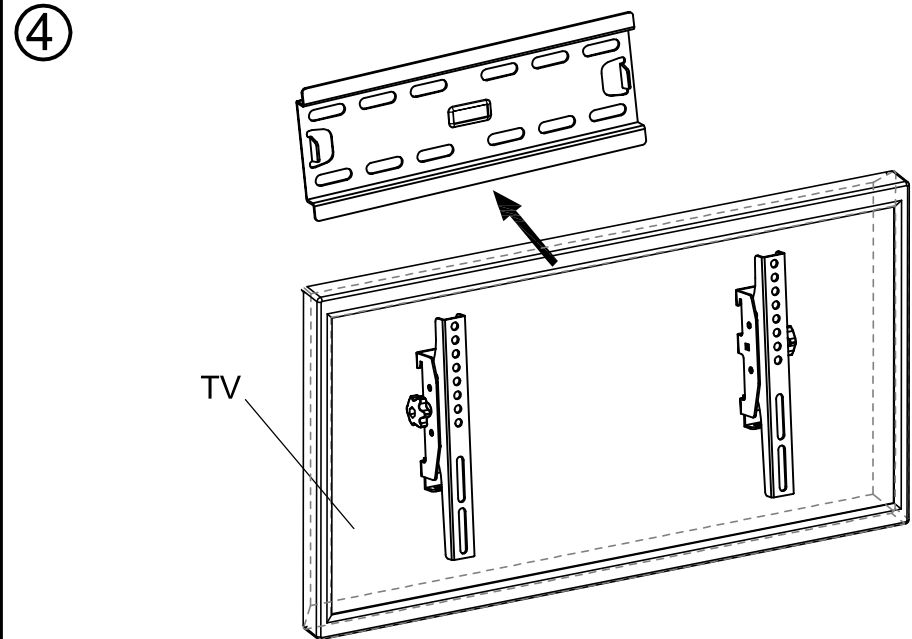

----- Select the suitable hardware to fix the bracket according to the installation chart.

