

USER MANUAL

Please read this manual thoroughly before using this product and keep it for future reference.

PACKING LIST



Projector



HDMI Cable



Remote



User Manual



AV Cable



Power Cable

NOTICE

Recommended

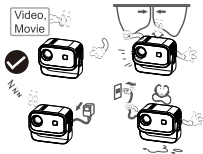

NOT Recommended

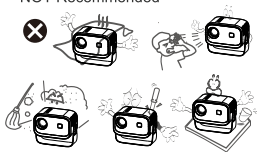

FUNCTION OVERVIEW

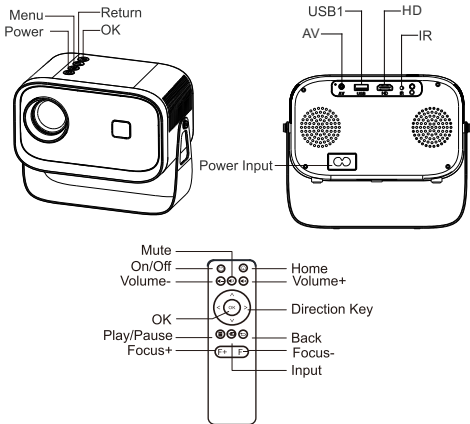

QUICK START

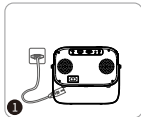

Plug the power cord into an outlet

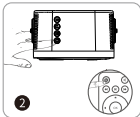

Press the power button to turn on the projector.

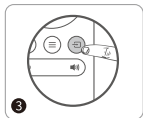

Select the correct input source to project your device.



Electric Focus to get the best image performance

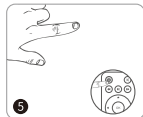

Press the power button to turn off the projector.

INPUT SOURCE

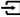
Press  on the there s no but ton on the projector remote to enter the interface of **input source**.

A. USB Connection

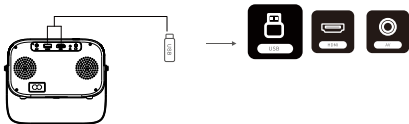

PROJECTOR CONNECTION

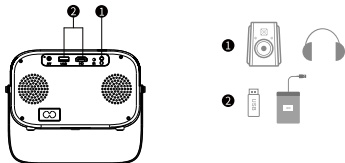

PROJECTION DISTANCE&SIZE

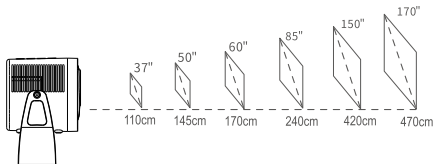

SPECIFICATION

| | | | |
|------------------------|----------------------------|------------------------|--|
| Display technology | LCD | Light Source | LED |
| Power supply | AC 100-240V 50/60Hz | Resolution Supported | 576i, 576P, 720i, 720P, 1080i, 1080P |
| Projection Distance | 3.8FT-18FT (1.16M-5.5M) | Projection Screen | 37" - 170" |
| Installation Type | Front/Rear/Ceiling | Aspect Ratio | 4:3/16:9/Auto |
| Focus | Electronic | Ports | HD In*1/USB2.0 Port*1/ AV In*1/Audio Out*1/ |
| Speaker | 3W/4ohm | Unit Net Weight | 2.2 lb (1 kg) |
| Unit Dimension | 6.45*6.3*6.77 inch | Audio Format Supported | MP2/MP3/PCM/FLAC/WMA |
| Photo Format Supported | BMP/JPG/PNG/ GIF/JPEG | Video Format Supported | AVI/MP4/MKV/FL/MOV/ RMVB/3GP/MPEG1/ MPEG2/H.264/XVID |

TROUBLESHOOTING GUIDE

1. Blurry Image

- * Adjust electronic focus/keystone.
- * Projector and screen/wall must be in effective distance.

2. Remote unresponsive

- * Make sure remote points at IR receiver directly.
- * Do not cover IR receiver.

3. Up Side Down Images

Enter "Menu" on projector or remote to flip the projection image.

Projection mode/Bluetooth speaker

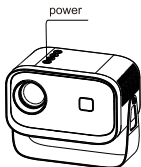

Indicator status is as below at the power button:

Standby mode: red light

Working mode: blue light

Speak mode: blue light

After short pressing the power button, the projector is on:

Enter speaker mode: In the working state, short press the power button to switch to speaker mode. After entering the speaker mode for 20 seconds, it will automatically enter the Bluetooth standby state

Exit speaker mode: In the speaker mode, short press the power button or any key on the remote control to exit speaker mode, and enter projection mode