

INSTALLATION INSTRUCTIONS

Installation method: By screws

Tools and accessories list:



1/4" Drill



Hammer



Driver



Mark Pen

not included

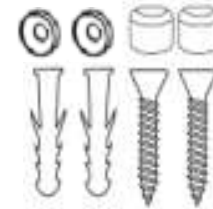

2pcs Screw Caps

2pcs Anchors

2pcs Long Screws

2pcs Washers

Instruction manual:

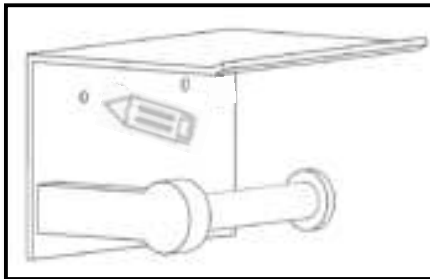

1. Mark mounting holes (x2)

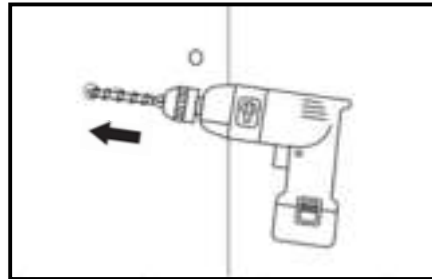

2. Drill the 1/4" screw holes

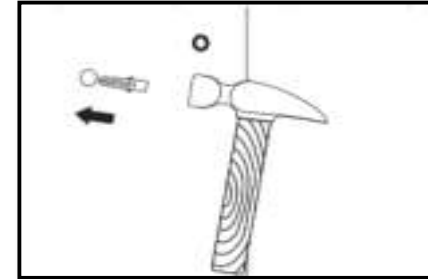

3. Insert the plastic anchors

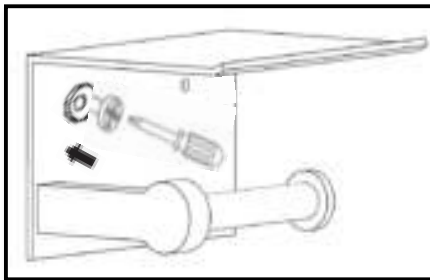

4. Screw the shelf into the anchor

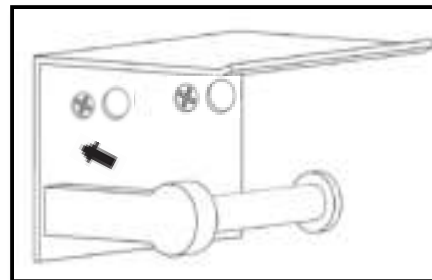

5. Install caps to hide the screws

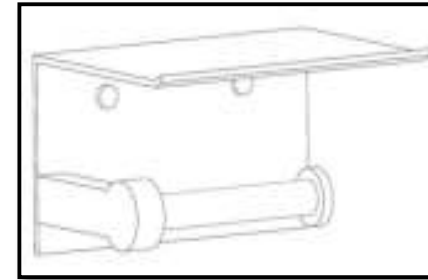

6. Installation completed