

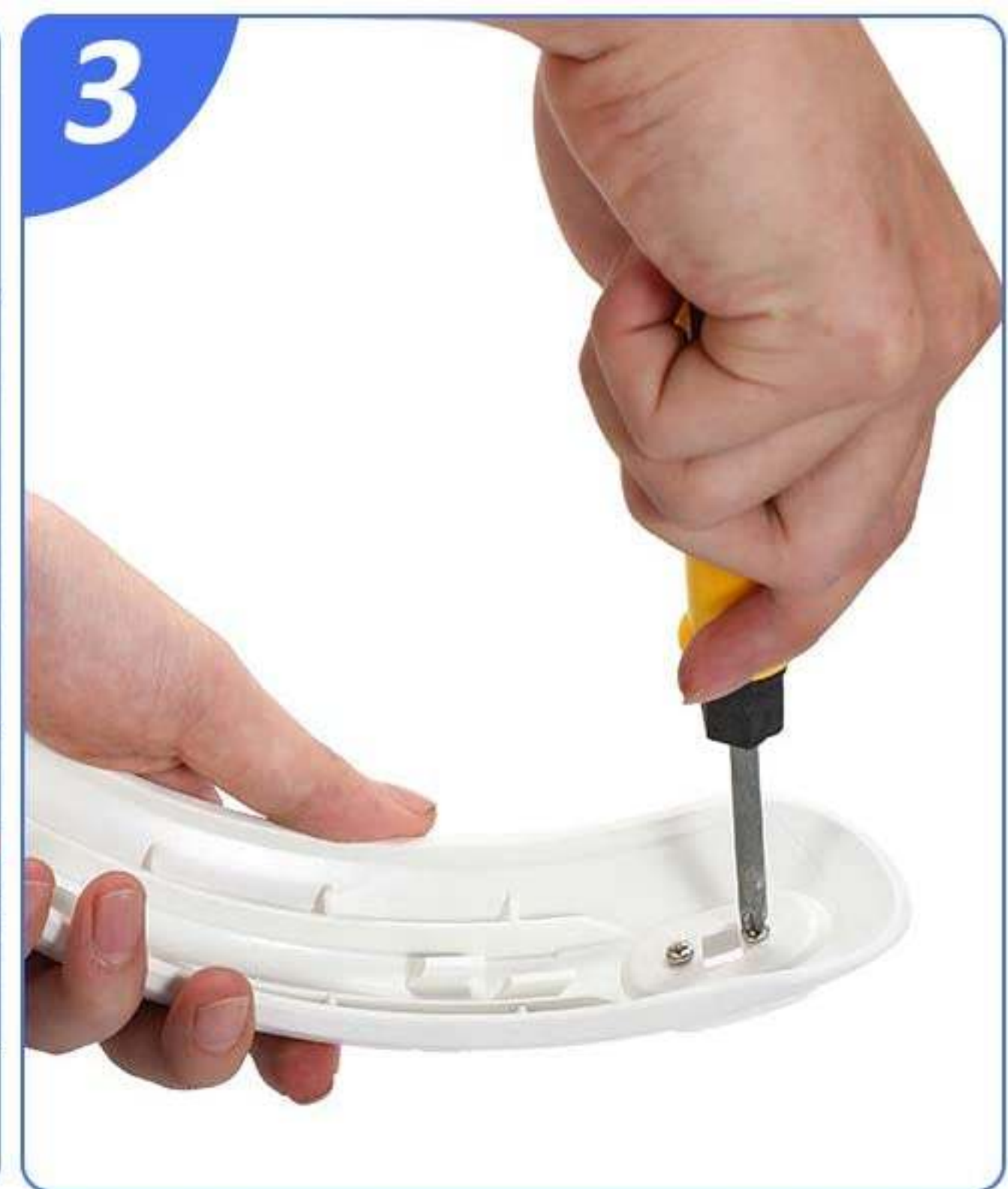

1
Remove the silicone cap



2
Unscrew the screw counterclockwise with an Allen wrench



3
Use a screwdriver to remove the screw from the rear fender warning taillight



4
Install the fender bracket with two screws that are delivered and tighten



5
Insert the sides of the bracket into the groove



6
Tighten the screws clockwise with an Allen wrench