

Schnellstartanleitung / Guide de démarrage rapide / Guía de inicio rápido

Guida rapida / Snabbstartsguide / Vejledning til hurtig start

Snelstartgids / Hurtigstartveiledning / Pikaopas



neato



Insert plug behind the charge base. Shorten the cord as needed by wrapping it behind the charge base.

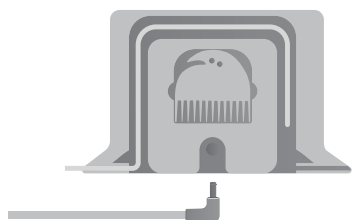

Select a clear area with good Wi-Fi coverage. Make sure the charge base is against the wall and plugged in.

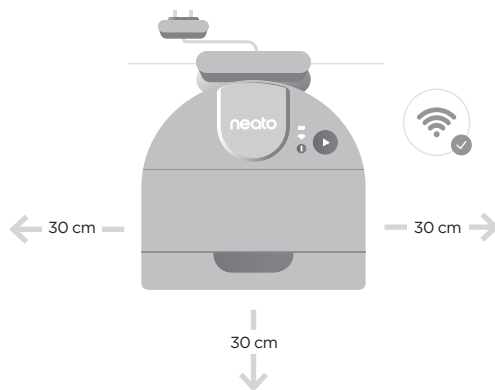

Place the robot against the charge base. When docked properly, the battery icon will light up.

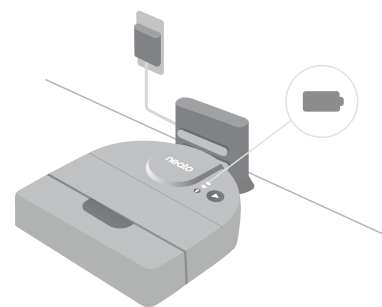

Download the MyNeato application.



Check your mobile device setting to make sure the Bluetooth is switched on.

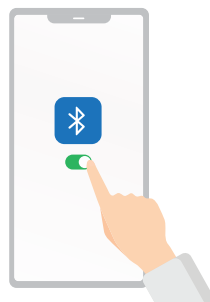

Finish your set up process with the MyNeato application.



Before the robot starts to vacuum, pick up items that could become tangled, such as cables, socks, and shoelaces. Tuck fringes under rugs.

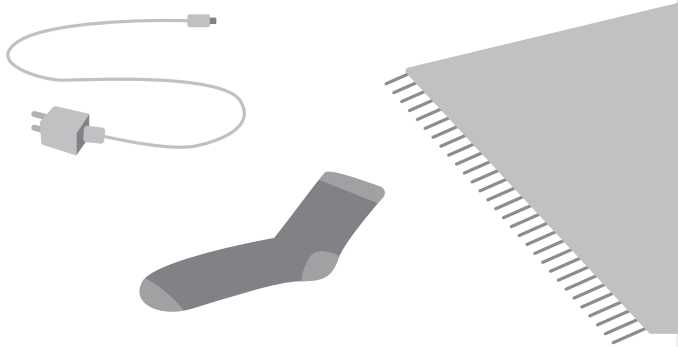

Your charge base comes with a pad designed to keep it secure on a hardwood floor. Remove these pads if you plan to place the charge base on carpet.

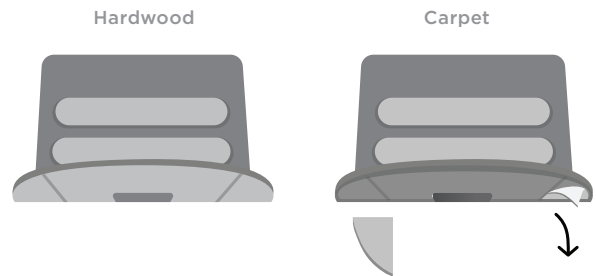

Use the MyNeato app to:

- Schedule your robot
- View cleaning maps
- Create No-Go lines or zones
- Clean specific rooms or areas

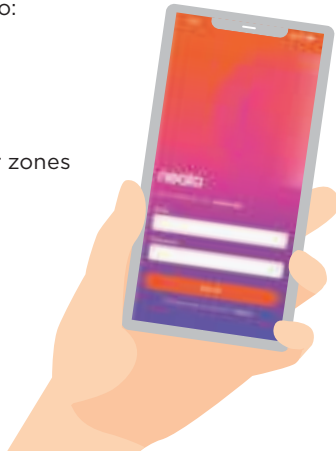

Learn more about your robot:
www.NeatoRobotics.com/UG

We are here to help. Contact us at:
www.NeatoRobotics.com/contact-us

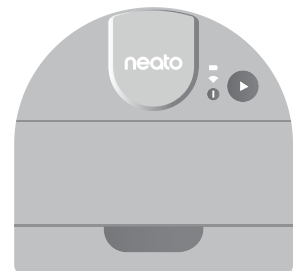

ENGLISH

Den Stecker hinter der Ladestation einstecken. Das Kabel nach Bedarf kürzen, indem Sie es hinter der Ladestation aufwickeln.

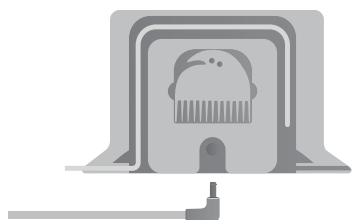

Wählen Sie einen freien Bereich mit guter WLAN-Abdeckung. Stellen Sie sicher, dass die Ladestation an der Wand steht und eingesteckt ist.

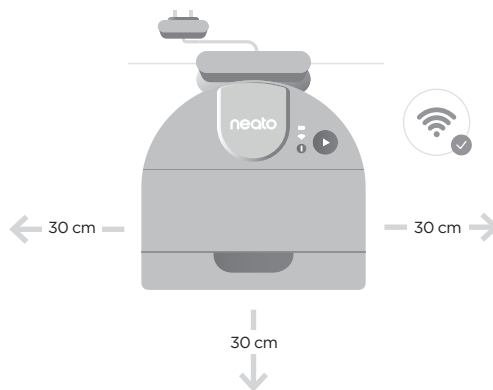

Stellen Sie den Roboter an die Ladestation. Wenn er richtig angedockt ist, leuchtet das Batteriesymbol auf.

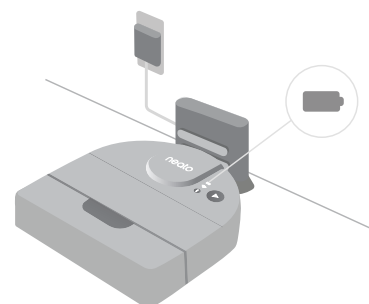

Die MyNeato-App auf Ihr mobiles Endgerät herunterladen.

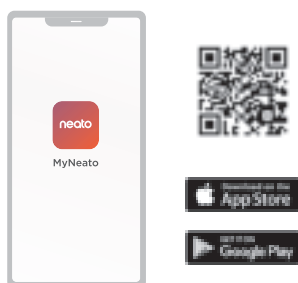

Überprüfen Sie in den Einstellungen auf Ihrem mobilen Endgerät, dass Bluetooth eingeschaltet ist.

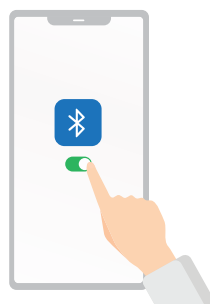

Schließen Sie Ihren Einrichtungsprozess mit der MyNeato-App ab.



Sammeln Sie, bevor der Roboter mit dem Staubsaugen beginnt, alle Gegenstände auf, die sich verfangen könnten, wie Kabel, Socken oder Schnürsenkel. Stecken Sie die Teppichfransen unter die Teppiche.

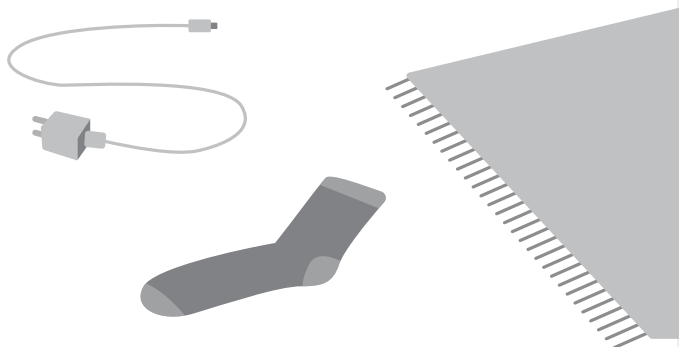

Ihre Ladestation ist mit einer Unterlage ausgestattet, damit sie sicher auf einem Parkettboden steht. Entfernen Sie diese Unterlage, wenn Sie die Ladestation auf einem Teppich stellen möchten.

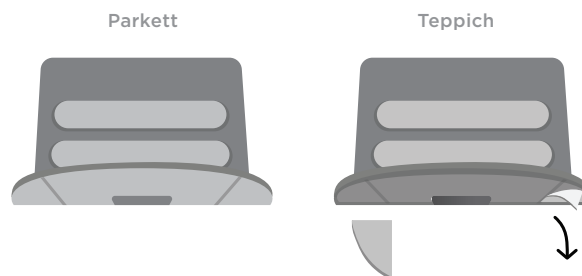

Sie können die MyNeato-App für Folgendes nutzen:

Zeitplan für Ihren Roboter festlegen

Reinigungskarten anzeigen

Legen Sie No-Go Linien oder zu reinigende Bereiche fest

Reinigen Sie einen bestimmten Raum oder Bereich



Erfahren Sie mehr über den Roboter:
www.NeatoRobotics.com/UG

Wir helfen gerne weiter.
Kontaktieren Sie uns unter
www.NeatoRobotics.com/contact-us

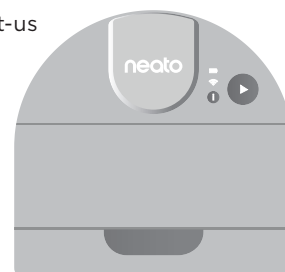

Insérez la fiche à l'arrière de la base de chargement. Raccourcissez le cordon selon vos besoins en l'enroulant derrière la base de chargement.

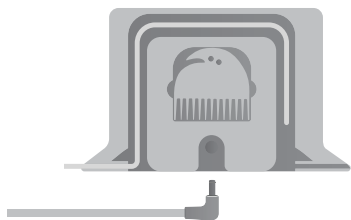

Choisissez un espace dégagé avec une bonne couverture Wi-Fi. Assurez-vous que la base de chargement est contre le mur et branchée.

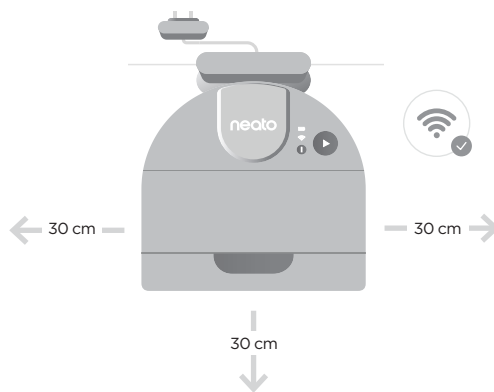

Placez le robot contre la base de chargement. Lorsqu'elle est correctement connectée, l'icône de la batterie s'allume.

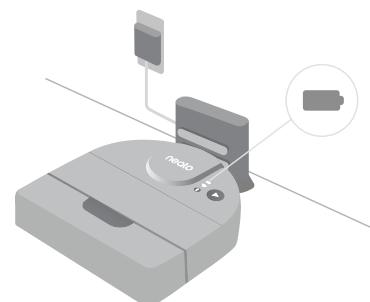

Téléchargez l'application MyNeato sur votre appareil mobile.

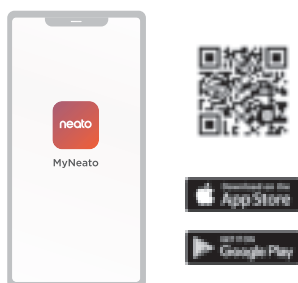

Vérifiez le réglage de votre appareil mobile pour vous assurer que la fonction Bluetooth est activée.

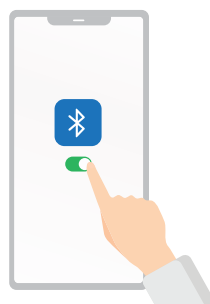

Utilisez l'application MyNeato pour.



Avant que le robot ne démarre le nettoyage, rangez les objets pouvant le gêner, comme les câbles, les chaussettes et les lacets de chaussures. Placez les franges de tapis sous les tapis.

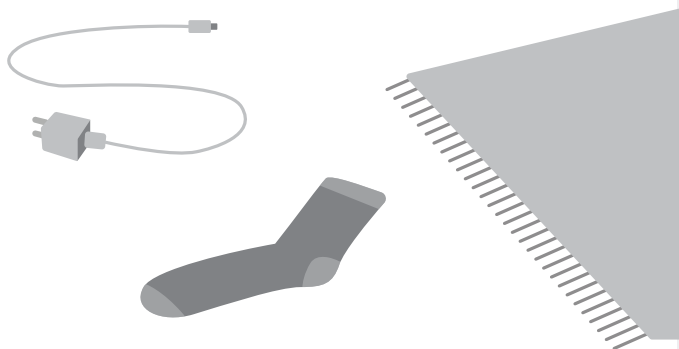

Votre base de chargement est fournie avec un coussinet conçu pour la protéger lors d'une utilisation sur un sol en bois dur. Retirez ce coussinet si vous prévoyez de placer la base de chargement sur une moquette.

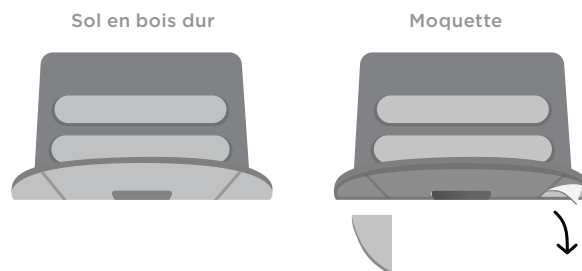

L'appareil de nettoyage par excellence:

Programmer votre robot

Voir les cartes de nettoyage

Créez des lignes de délimitations virtuelles ou des zones à nettoyer

Nettoyez une pièce ou un endroit spécifique



Pour en savoir plus sur votre robot, rendez-vous sur www.NeatoRobotics.com/UG

Nous sommes là pour vous aider. Pour en savoir plus, rendez-vous sur www.NeatoRobotics.com/contact-us

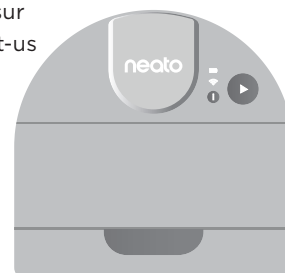

FRANÇAIS

Inserire la spina dietro la base di carica. Accorciare il cavo quanto è necessario avvolgendolo dietro la base di carica.

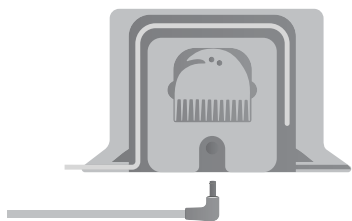

Selezionare un'area libera con una buona copertura Wi-Fi. Accertarsi che la base di carica sia appoggiata contro il muro e collegata.

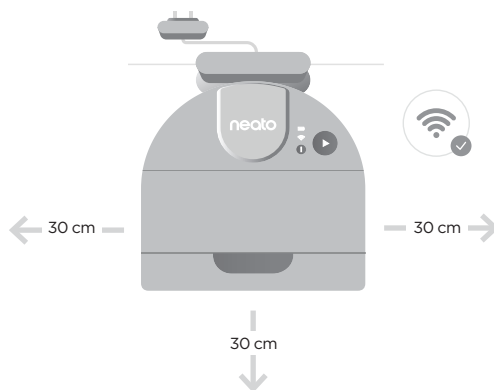

Appoggiare il robot alla base di carica. Una volta agganciato in modo appropriato, l'icona della batteria si accenderà.

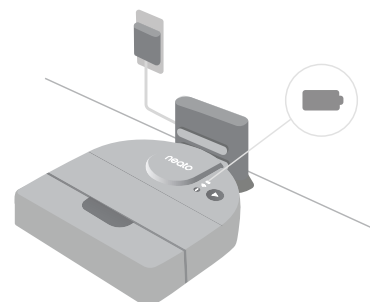

Scaricare l'applicazione MyNeato sul proprio dispositivo mobile.



Verificare le impostazioni del dispositivo mobile per verificare che la funzione Bluetooth sia attiva.

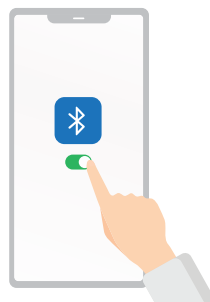

Termina il processo di configurazione con l'applicazione MyNeato.



Prima che il robot inizi la pulizia, raccogliere eventuali oggetti che potrebbero rimanere intrappolati, come cavi, calze o lacci da scarpe. Ripiegare le frange sotto i tappeti.

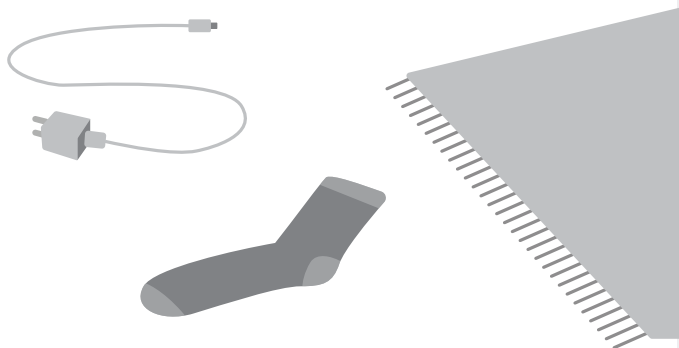

La tua base di carica è dotata di un cuscinetto progettato per mantenerla sicura su un pavimento in legno duro. Rimuovi questi tamponi se prevedi di posizionare la base di carica sulla moquette.

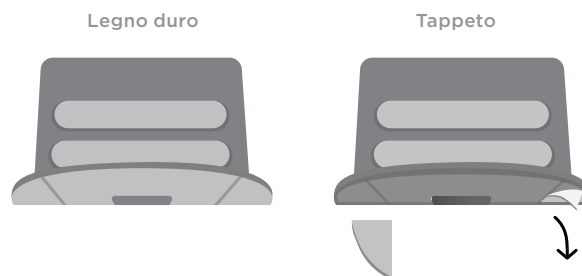

Usa l'app MyNeato per:

Programma il robot

Visualizza le mappe della pulizia

Crea linee di demarcazione virtuali o zone da pulire

Pulisci una stanza o una zona specifica



Per saperne di più sul tuo robot:
www.NeatoRobotics.com/UG

Siamo qui per aiutarti. Contattaci alla pagina
www.NeatoRobotics.com/contact-us



ITALIANO

Enchufe el conector en la parte posterior de la base de carga. Acorte el cable según sea necesario enrollándolo detrás de la base de carga.

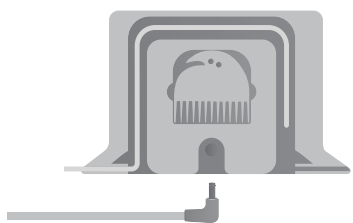

Seleccione un área despejada con buena cobertura Wi-Fi. Asegúrese de que la base de carga esté contra la pared y enchufada.

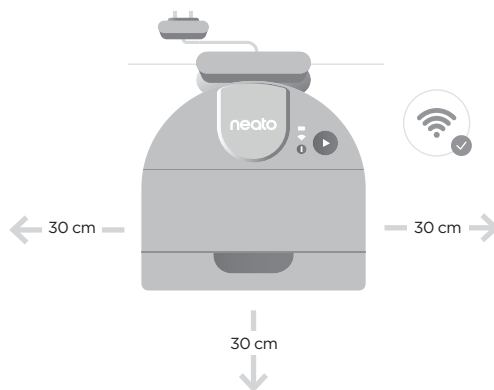

Coloque el robot contra la base de carga. Cuando está acoplado correctamente, el icono de la batería se enciende.

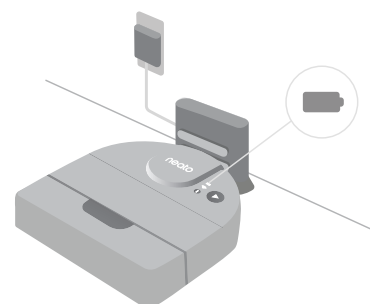

Descargue la app MyNeato en su dispositivo móvil.

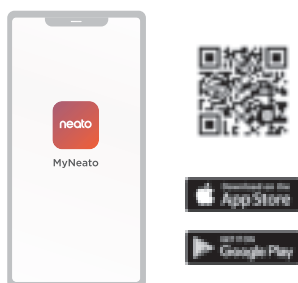

Compruebe la configuración de su dispositivo móvil para asegurarse de que Bluetooth esté activado.

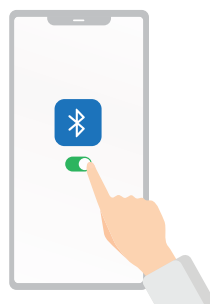

Termine su proceso de configuración con la aplicación MyNeato.



Antes de que el robot comience a aspirar, guarde cualquier elemento que pueda enredarse, como cables, calcetines y cordones. Doble los flecos por debajo de las alfombras.

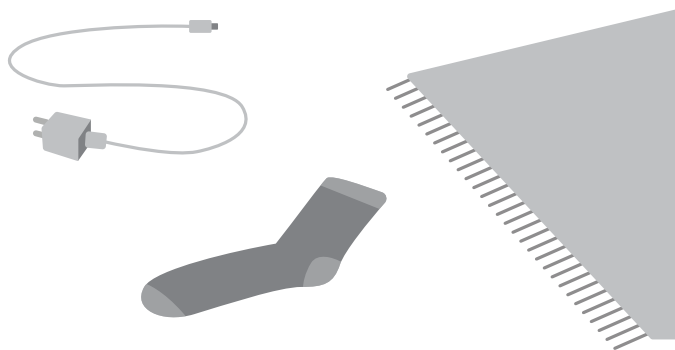

Su base de carga va acompañada de una almohadilla diseñada para mantenerla protegida de los suelos de madera dura. Retire la almohadilla si tiene previsto colocar la base de carga en una moqueta.

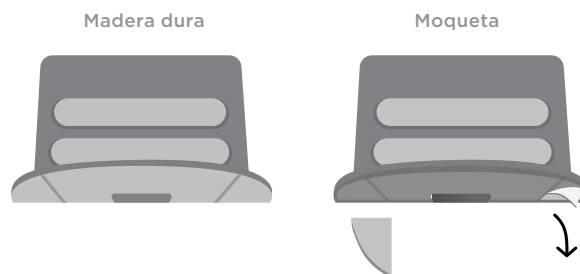

Utilice la aplicación MyNeato para:

- Programe su robot
- Visualice mapas de limpieza
- Cree líneas límite o zonas
- Limpie áreas o habitaciones específicas

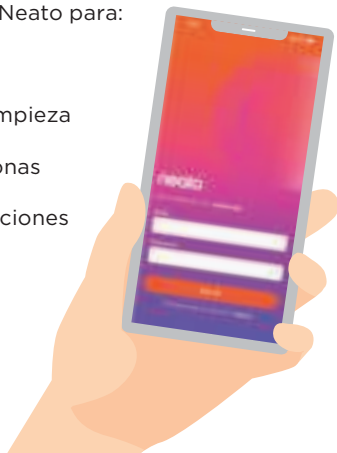

Más información acerca de su robot:
www.NeatoRobotics.com/UG

Estamos aquí para ayudar. Póngase en contacto con nosotros a través de
www.NeatoRobotics.com/contact-us

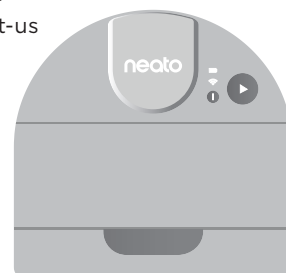

ESPAÑOL

Sätt i kontakten bakom laddningsstationen. Förkorta sladden efter behov genom att linda den bakom laddningsstationen.

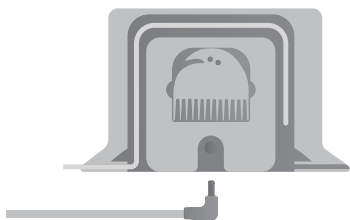

Välj ett tomt område med bra Wi-Fi-täckning. Säkerställ att laddningsstationen står mot väggen och är inkopplad.

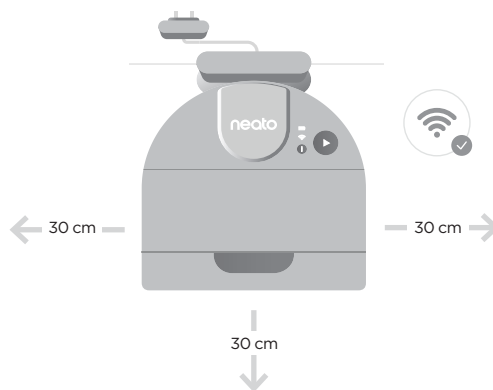

Placera roboten mot laddningsstationen. Batteriikonen tänds när roboten är ansluten korrekt.

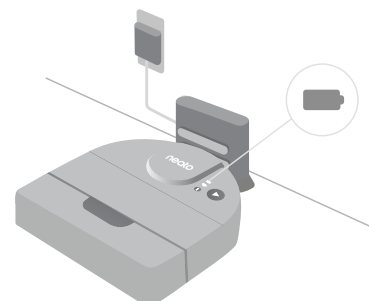

Hämta MyNeato-appen på din mobila enhet.

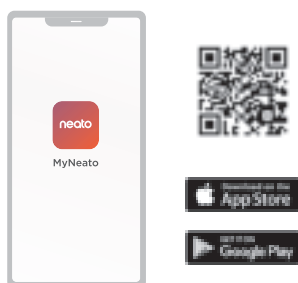

Kontrollera inställningarna i din mobila enhet för att säkerställa att Bluetooth är aktiverat.

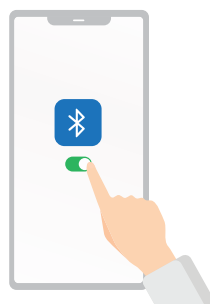

Slutför konfigurationen med MyNeato-appen.



Plocka upp saker som kan fastna, till exempel kablar, strumpor och skosnören innan roboten börjar dammsuga. Stoppa in fransarna under mattorna.

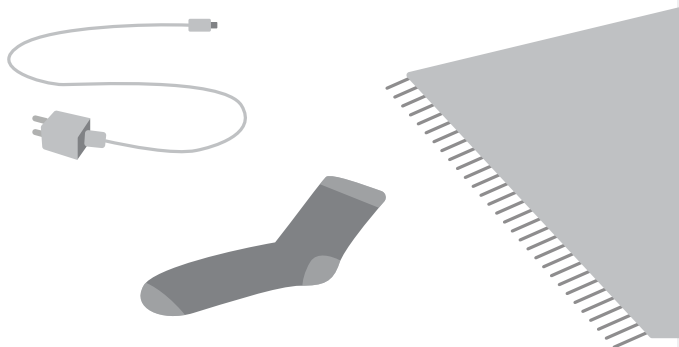

Laddningsstationen har ett underlag som är utformat för att den ska stå säkert på hårda golv. Ta bort detta underlag om du tänker ställa laddningsstationen på en matta.

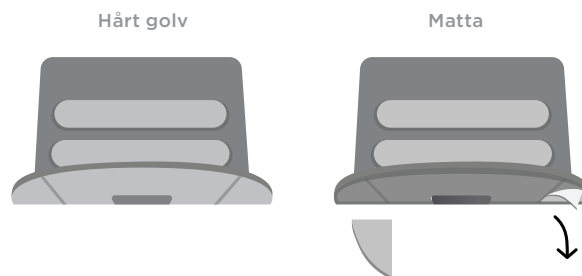

Använd MyNeato-appen till:

Schemalägg din robot

Visa städkartor

Skapa No-Go-linjer
eller zoner

Städa enskilda rum
eller ytor



Läs mer om din robot:

www.NeatoRobotics.com/UG

Vi finns här för dig. Kontakta oss på
www.NeatoRobotics.com/contact-us



SVENSKA

Steek de stekker achter het laadstation in. Kort het snoer indien nodig in door het achter het laadstation te wikkelen.

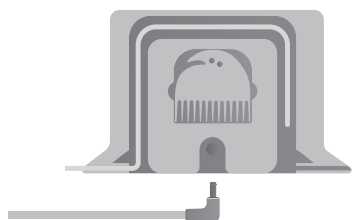

Selecteer een leeg gebied met goede Wi-Fi-dekking. Zorg ervoor dat het laadstation tegen de wand is geplaatst en is aangesloten.

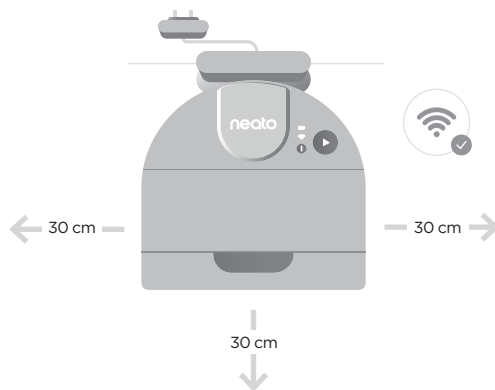

Plaats de robot tegen het laadstation. Als deze goed is gedokt, gaat het batterijpictogram branden.

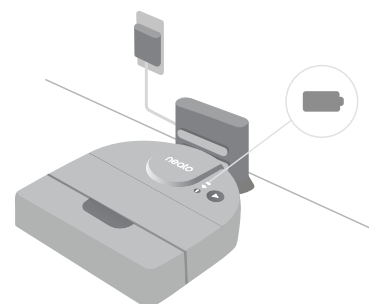

Download de applicatie MyNeato op uw mobiele apparaat.

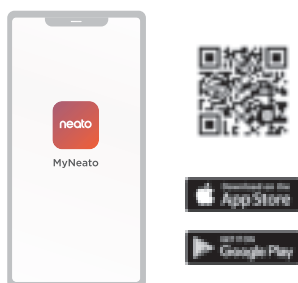

Controleer de instellingen van uw mobiele apparaat om ervoor te zorgen dat Bluetooth is ingeschakeld.

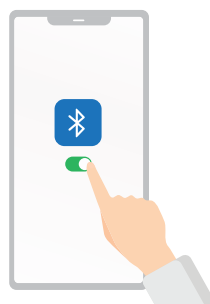

Afslut opsætningsprocessen med MyNeato-appen.



Pak voorwerpen die verstrikt zouden kunnen raken (zoals kabels, sokken en veters) op voordat u de robot laat stofzuigen. Stop franjes onder het tapijt.

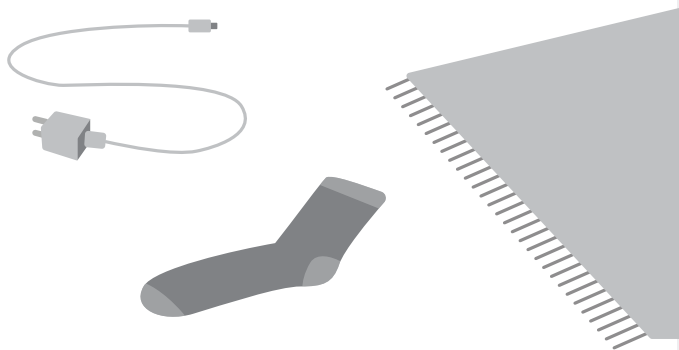

Uw laadstation wordt geleverd met een onderlegger waarmee dit veilig op een hardhouten vloer kan worden geplaatst. Verwijder deze onderlegger als u het laadstation op een tapijt wilt plaatsen.

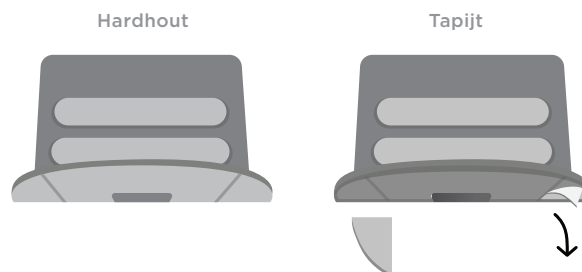

Gebruik de MyNeato-app voor:

Een planning voor uw robot maken

Reinigingskaarten bekijken

No Go-lijnen of -gebieden instellen

Specifieke kamers of gebieden schoonmaken

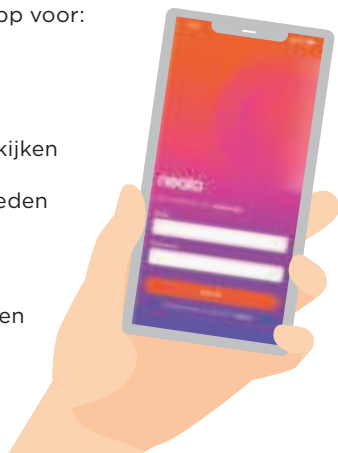

Meet informatie over uw robot:
www.NeatoRobotics.com/UG

Wij zijn hier om u te helpen.
Neem contact met ons op via
www.NeatoRobotics.com/contact-us

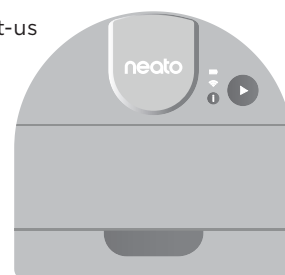

NEDERLANDS

Sæt stikket i bag på opladningsstationen: Afkort kablet efter behov ved at vikle det sammen bag på opladningsstationen.

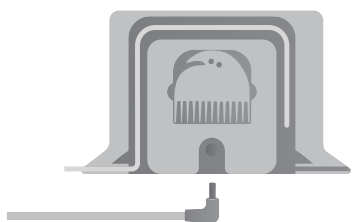

Vælg et ryddet område med god Wi-Fi-forbindelse. Sørg for, at opladningsstationen er placeret op imod væggen og tilsluttet en strømkilde.

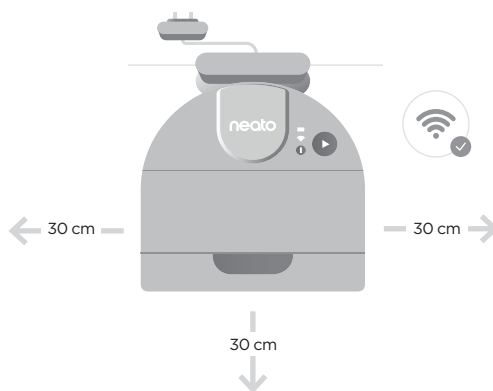

Placer robotten op mod opladningsstationen. Når den er korrekt tilsluttet, lyser batteriikonet.

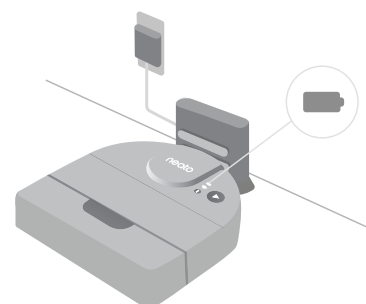

Download MyNeato-appen på din mobile enhed.

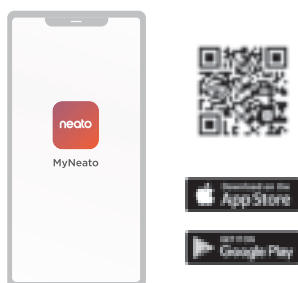

Kontrollér din mobile enheds indstillinger for at sikre dig, at Bluetooth er aktiveret.

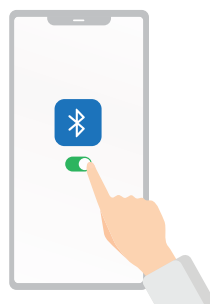

Voltooi uw instelproces met de MyNeato-toepassing.



Inden du påbegynder støvsugning, skal du fjerne alle genstande såsom kabler, sokker og snørebånd, som kunne blive viklet ind i robotten. Fold eventuelle frynser ind under gulvtæpperne.

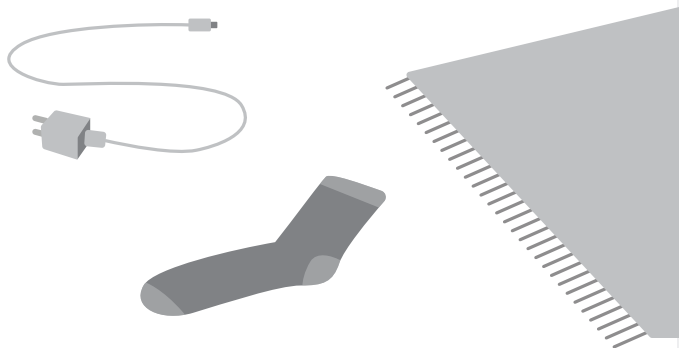

Der følger et underlag med til din opladningsstation, der er gør den skridsikker på trægulve. Fjern disse underlag, hvis du vil placere opladningsstationen på et tæppe.

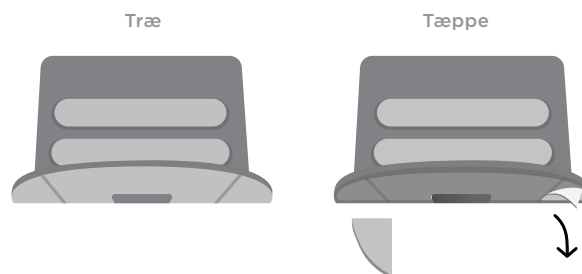

Brug MyNeato-appen til at:

Tidsindstil din robot

Se rengøringskort

Opret No Go Lines eller zoner

Rengør specifikke rum eller områder

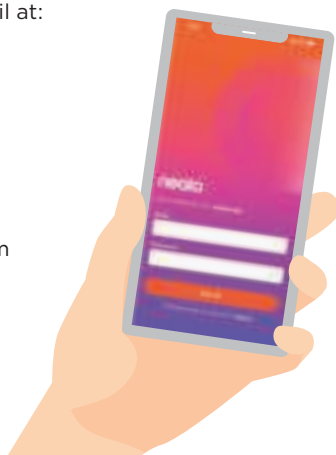

Få mere at vide om din robot på www.NeatoRobotics.com/UG

Vi står klar til at hjælpe. Kontakt os på www.NeatoRobotics.com/contact-us



DANSK

Sett i støpselet bak ladebasen.
Forkort ledningen etter behov
ved å brette den inn bak
ladebasen.

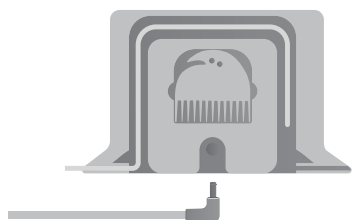

Velg et åpent område med god
Wi-Fi-dekning. Sørg for at ladebasen
står mot vegg og er koblet til.

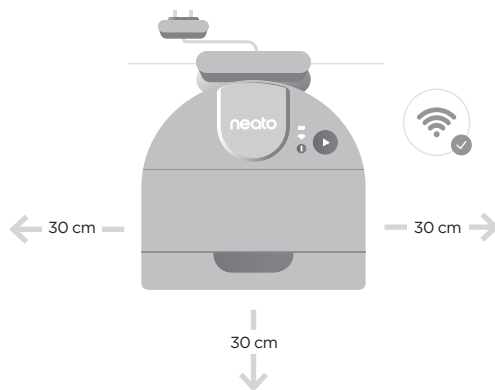

Plasser roboten mot ladebasen.
Når den er koblet til riktig, lyser
batteriikonet.

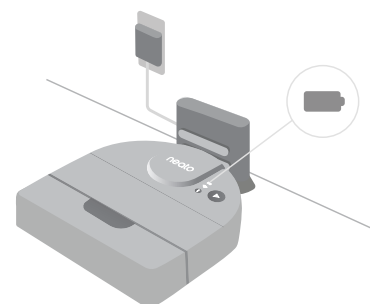

Last ned MyNeato-appen på
mobilenheten din.

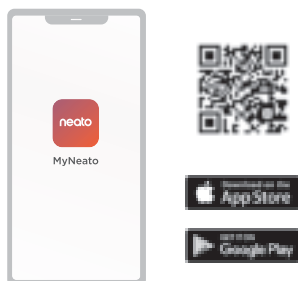

Kontroller innstillingen på
mobilenheten din for å forsikre deg
om at Bluetooth er slått på.

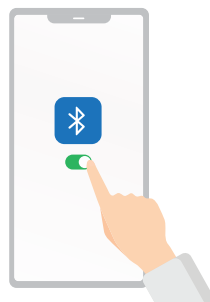

Fullfør konfigurasjonsprosessen
med MyNeato-applikasjonen.



Før roboten begynner å støvsuge, plukk opp gjenstander som kan bli tilfloket, for eksempel ledninger, sokker og skolisser. Brett frynser inn under tepper.

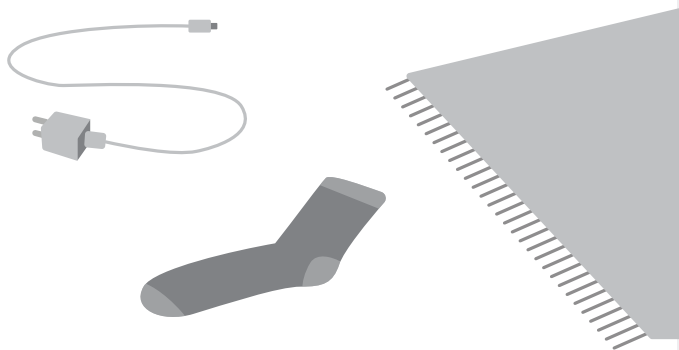

Ladebasen kommer med en pute som er utformet for å holde den sikker på et tregulv. Fjern disse putene hvis du planlegger å sette ladebasen på teppe.

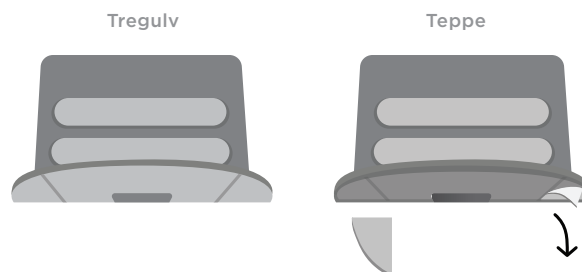

Bruk MyNeato-appen til å:

Lag en tidsplan for roboten

Vis rengjøringskart

Sett opp linjer eller soner der roboten ikke skal gå

Rengjør bestemte rom eller områder



Finn ut mer om roboten:

www.NeatoRobotics.com/UG

Vi er her for å hjelpe. Kontakt oss på

www.NeatoRobotics.com/contact-us



NORSK

Kytke liitin latausaseman takaosaan. Lyhennä johtoa tarvittaessa kiertämällä se latausaseman takaosaan.

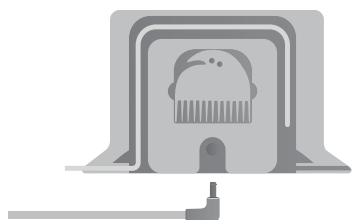

Valitse tyhjä alue, johon Wi-Fi-yhteys yltää hyvin. Varmista, että latausasema on seinää vasten ja kytketty pistorasiaan.

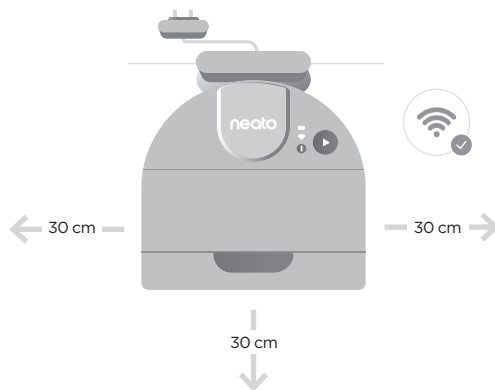

Aseta robotti latausasemaa vasten. Oikein telakoituna akkukuvakkeen valo syttyy.

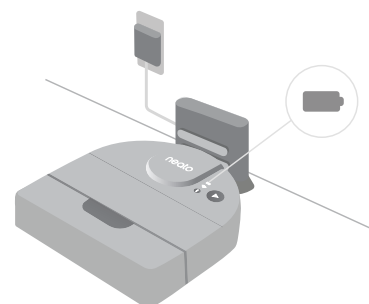

Lataa MyNeato-sovellus mobiililaitteeseen.

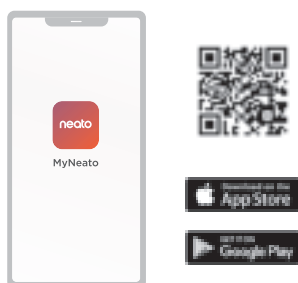

Tarkista mobiililaitteen asetus ja varmista, että Bluetooth on kytketty.

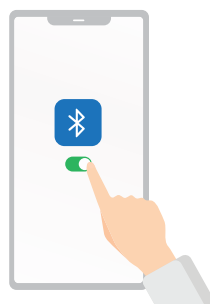

Viimeistele asennusprosessi MyNeato-sovelluksella.



Ennen kuin robotti alkaa imuroida, poimi pois esineet, jotka voisivat sotkeutua robottiin, kuten johdot, sukat ja kengännauhat. Työnnä hapsut mattojen alle.

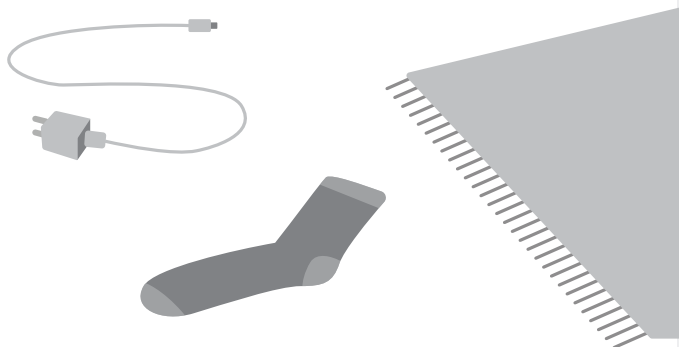

Latausaseman mukana on alusta, jonka tarkoitus on pitää asema paikallaan parkettilattialla. Poista alustat, jos aiot asettaa latausaseman maton päälle.

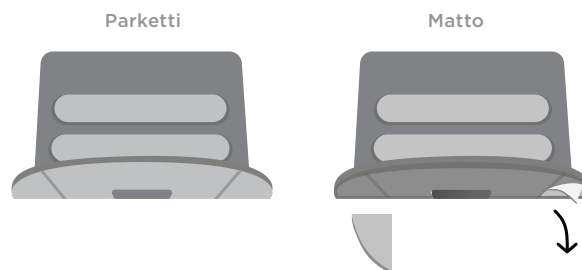

Käytä MyNeato-sovellusta seuraaviin tarkoituksiin:

Robotin ajastus

Siivouskarttojen tarkastelu

Luo hylkylinjoja tai vyöhykkeitä

Siivoa tiettyjä huoneita tai alueita



Lue lisää robotistasi:
www.NeatoRobotics.com/UG

Olemme valmiit auttamaan.
Ota yhteys osoitteessa
www.NeatoRobotics.com/contact-us

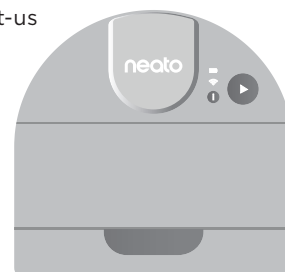

Neato Robotics®, Inc.
50 Rio Robles
San Jose, CA 95134, USA

Neato B.V.
WTC Schiphol Airport, Toren D
Schiphol Boulevard 359

NeatoRobotics.com

P/N 515-0073 Rev C