

PHILIPS

9000 series

S98XX / S97XX
S95XX / S93XX
S90XX / S90XX



www.philips.com/support/ifu

EN The accessories supplied may vary for different products. The box shows the accessories that have been supplied with your appliance.

DE Das mitgelieferte Zubehör kann für verschiedene Produkte variieren. Die Verpackung zeigt das Zubehör, das mit Ihrem Gerät mitgeliefert wurde.

EL Τα παρεχόμενα εξαρτήματα ενδέχεται να διαφέρουν για διαφορετικά προϊόντα. Η συσκευασία δείχνει τα εξαρτήματα που παρέχονται με τη συσκευή σας.

FR Les accessoires fournis peuvent varier selon les différents produits. Les accessoires qui ont été fournis avec votre appareil sont indiqués sur l'emballage.

IT Gli accessori forniti potrebbero variare a seconda del prodotto. La confezione mostra gli accessori forniti con l'apparecchio.

NL De meegeleverde accessoires kunnen per product verschillen. Op de doos wordt aangegeven welke accessoires bij het apparaat worden geleverd.

ةفلتخم لالتاچت نم لایف ةچردم لالتاچ لمل لالتخت دق
كزا هچ عم ةقح لمل لالتاچ لمل قودن ص لالنئی

AR

اب فلتخم تالوصحم رد تسا نکمم هدش هئارا یبناچ لیسو
یاه هلیسو هدهد ناشن رداک نیا. دنشاب توافقتم رگی دکی
دنا هدش هئارا ناتهاگتسد اب هارمه هک تسا یبناچ

FA

ES

Los accesorios suministrados pueden variar según los diferentes productos. La caja muestra los accesorios suministrados con el aparato.

PT

Os acessórios fornecidos podem variar consoante os produtos. A caixa mostra os acessórios que são fornecidos com o seu aparelho.

TR

Cihazla birlikte verilen aksesuarlar ürünlere göre farklılık gösterebilir. Kutuda, cihazının ile birlikte gönderilen aksesuarlar gösterilir.

NO

Tilbehøret som følger med, kan variere for de ulike produktene. Du kan se hva slags tilbehør som følger med apparatet, på esken.

SV

Olika tillbehör kan medfölja olika modeller. Information om vilka tillbehör som medföljer apparaten finns på produktkartongen.

DA

Det medfølgende tilbehør kan variere for forskellige produkter. Boksen viser det tilbehør, der leveres sammen med apparatet.

FI

Toimitukseen sisältyvät tarvikkeet voivat vaihdella tuotekohtaisesti. Tämän laitteen mukana toimitetut tarvikkeet näkyvät laatikossa.

MS

Aksesori yang dibekalkan mungkin berbeza-beza untuk berlainan produk. Kotak di bawah menunjukkan aksesori yang telah dibekalkan bersama perkakas anda.

TH

อุปกรณ์เสริมที่ให้มาอาจแตกต่างกันไปตามผลิตภัณฑ์ อุปกรณ์เสริมที่มีมาพร้อมกับเครื่องของคุณจะแสดงไว้ที่กล่อง

VI

Phụ kiện đi kèm có thể khác nhau cho những sản phẩm khác nhau. Hộp cho biết các phụ kiện được đi kèm với thiết bị của bạn.

ZH-T

隨附配件可能隨產品而異。包裝盒會顯示您產品隨附的配件。

ZH-S

隨附的附件可能因產品而異。包裝盒上會顯示隨附於您產品的附件。

ID

Aksesori yang disertakan dapat berbeda-beda, tergantung pada produk. Kemasan menunjukkan aksesori yang telah disertakan dengan peralatan Anda.

KO

제공되는 액세서리는 제품에 따라 다를 수 있습니다. 보관함에 제품과 함께 제공된 액세서리가 있습니다.

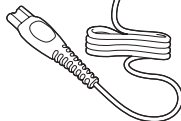
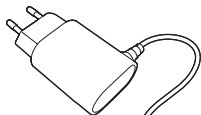
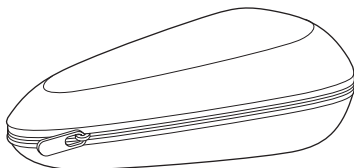
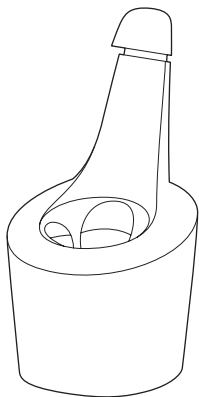
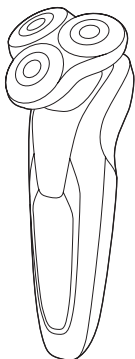
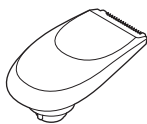
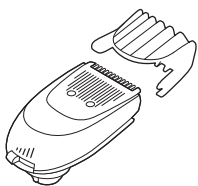

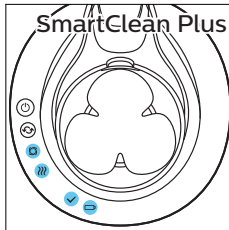
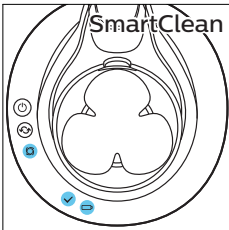
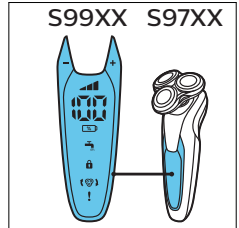
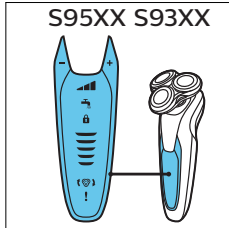
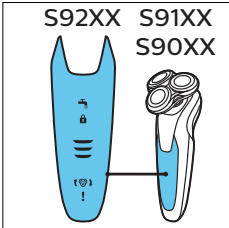
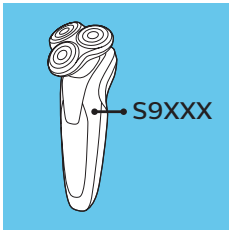

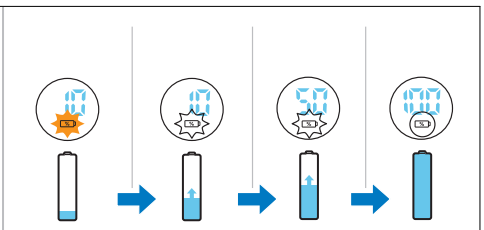
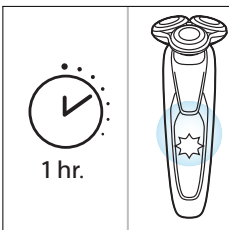
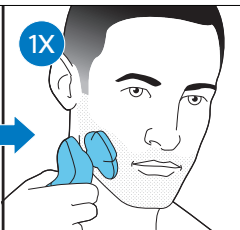
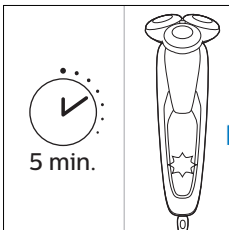
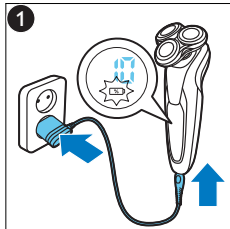
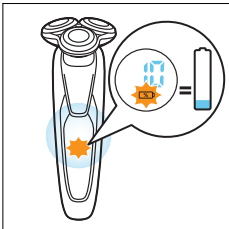
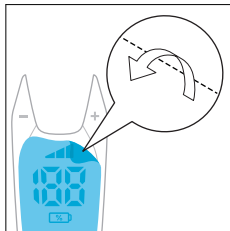
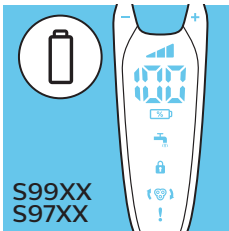

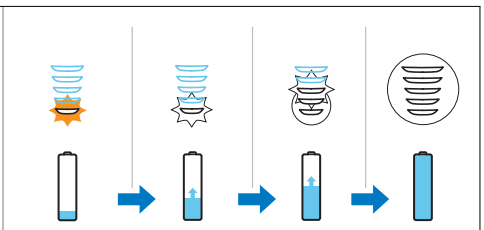
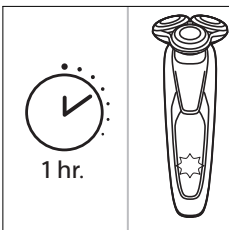
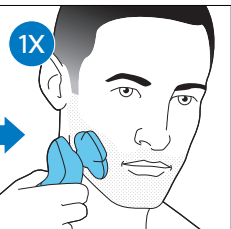
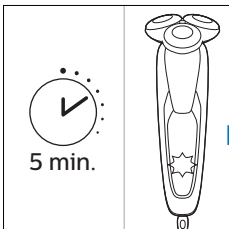
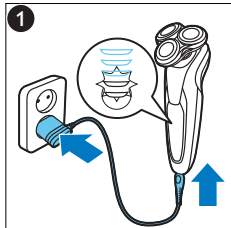
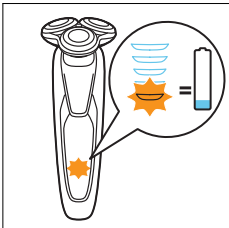
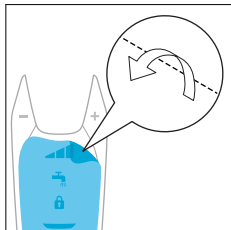
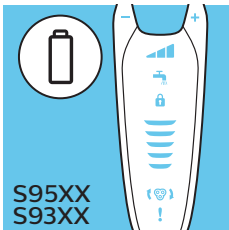

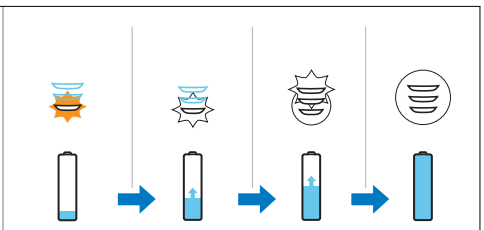
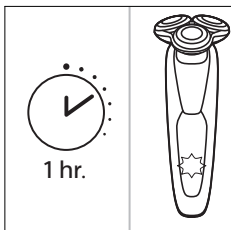
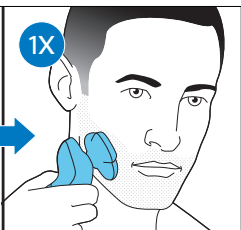
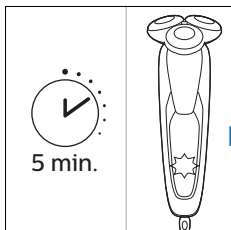
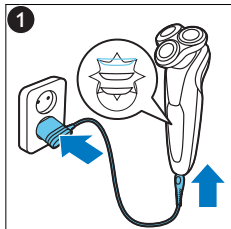
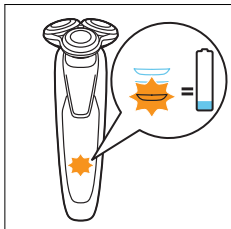
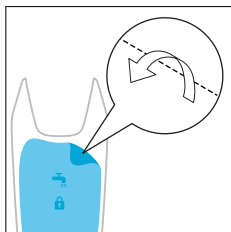
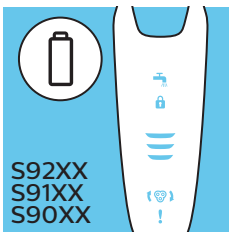

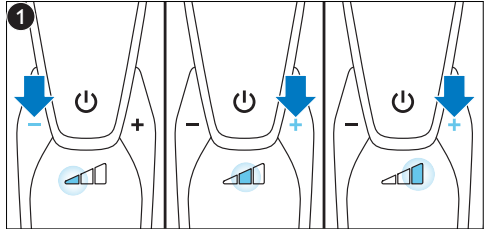
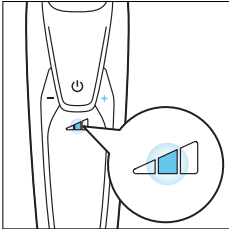
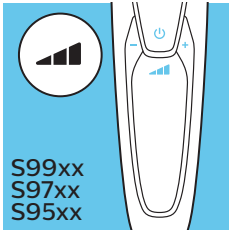

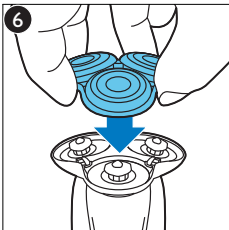
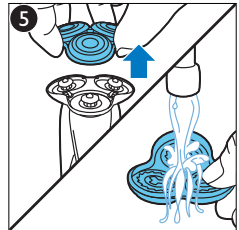
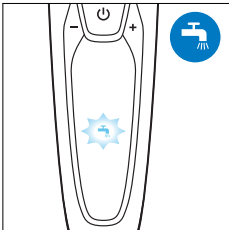
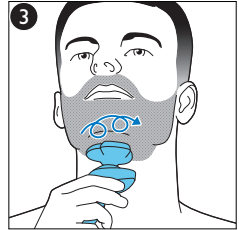
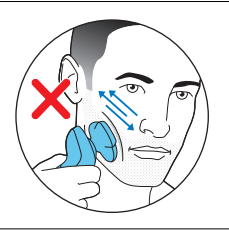
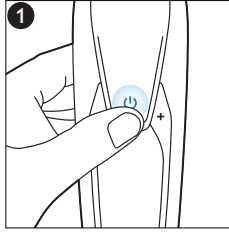
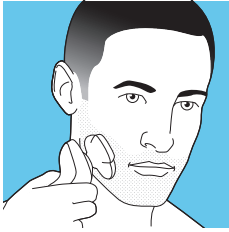

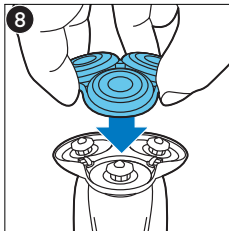
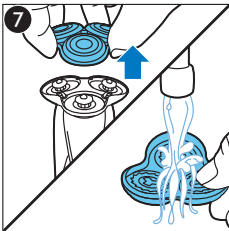
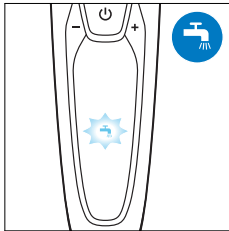
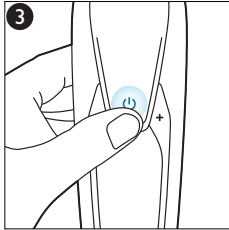

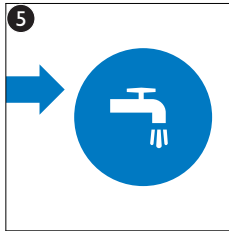
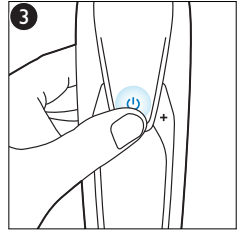
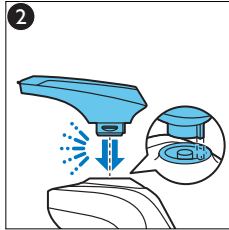
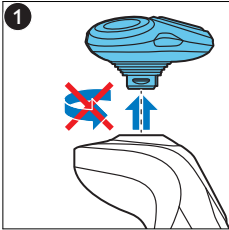
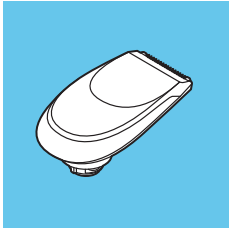

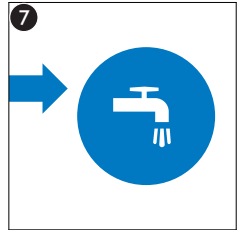
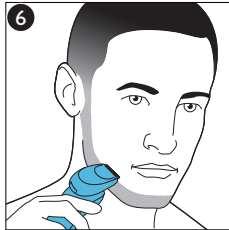
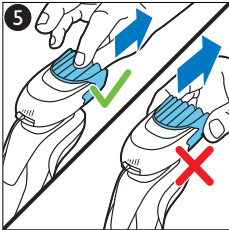
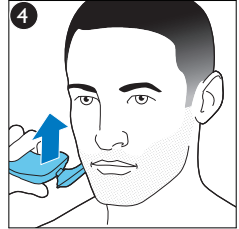
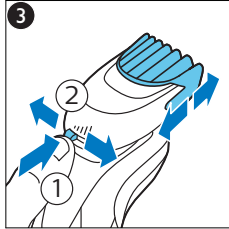
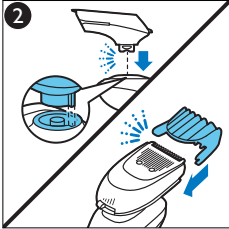
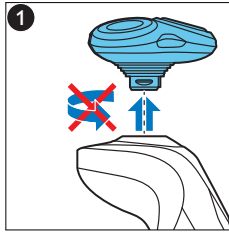
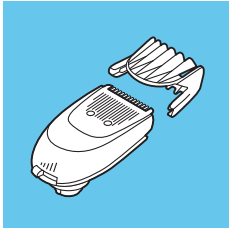

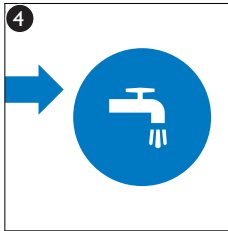
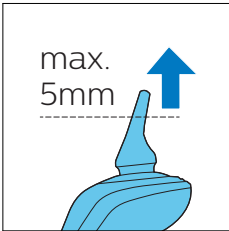
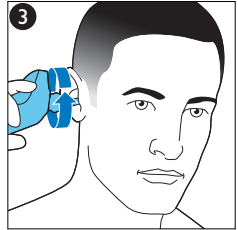
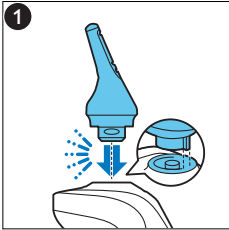
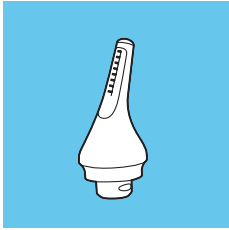

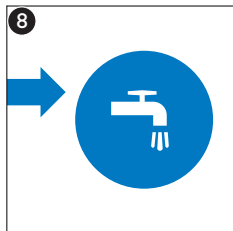
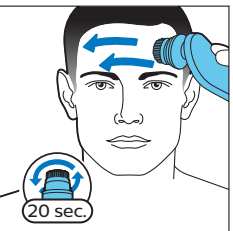
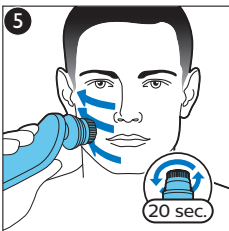
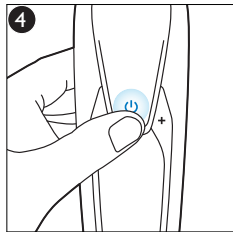
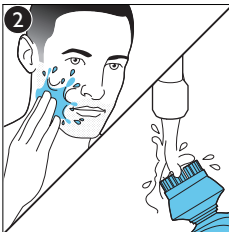
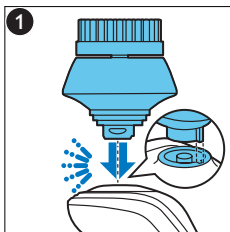
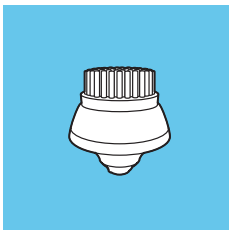

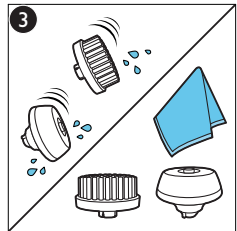
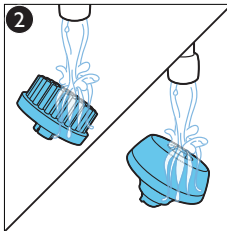
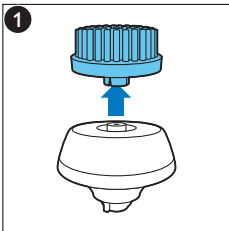
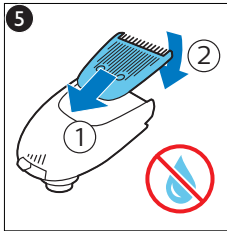
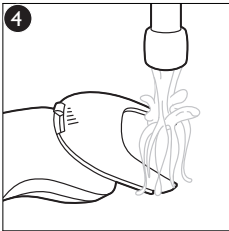
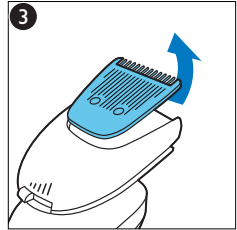
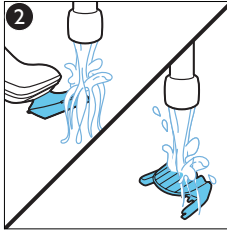
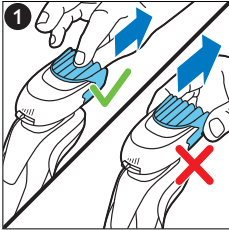
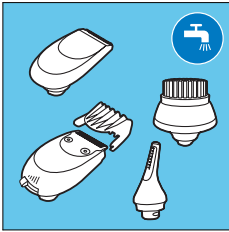

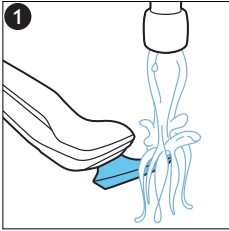
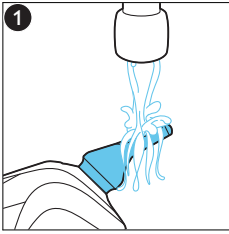

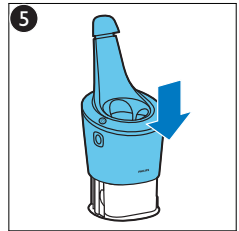
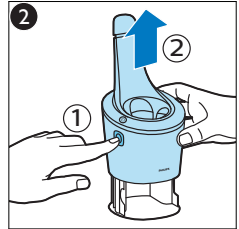
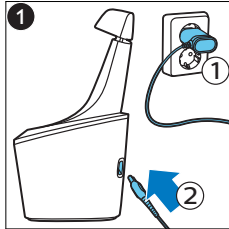
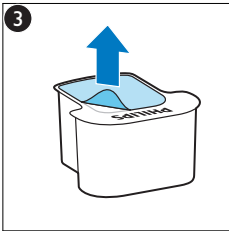
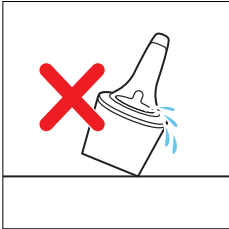
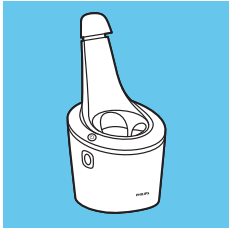

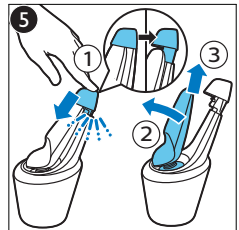
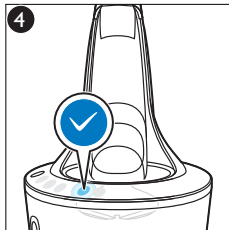
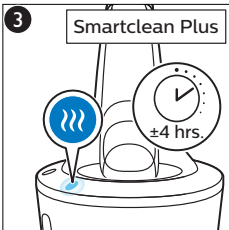
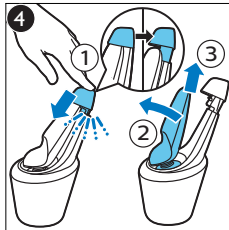
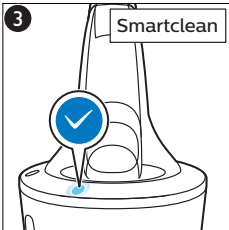
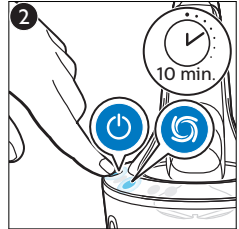
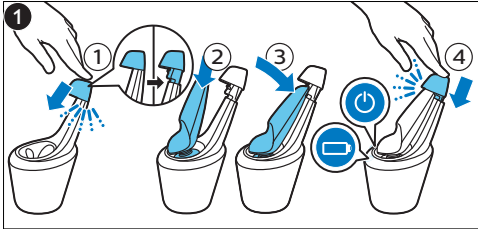
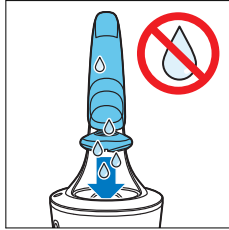
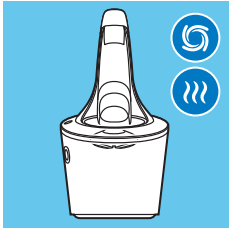

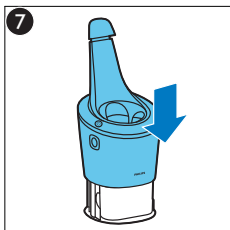
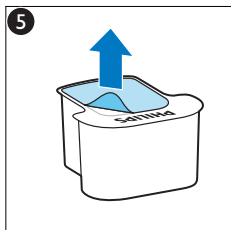
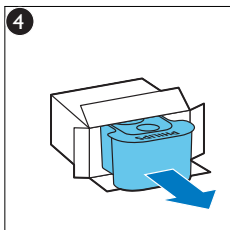
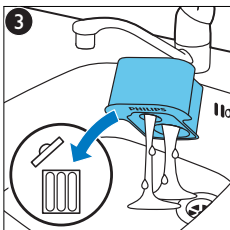
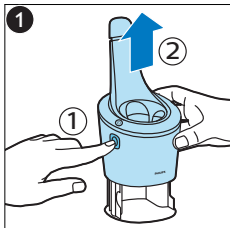
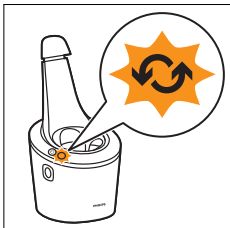

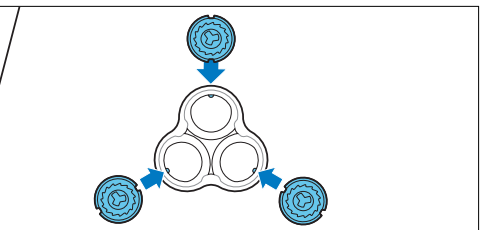
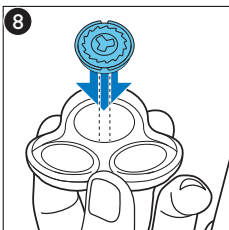
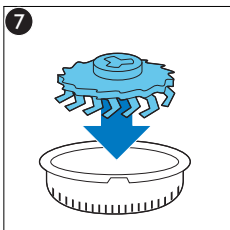
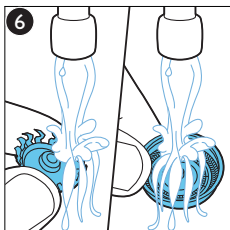
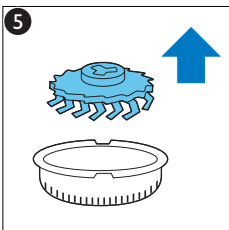
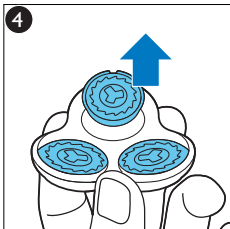
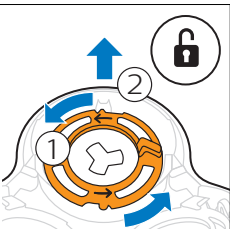
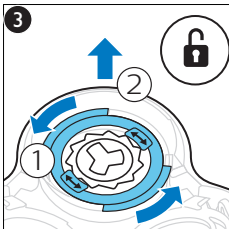
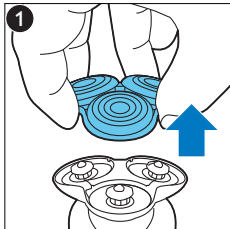
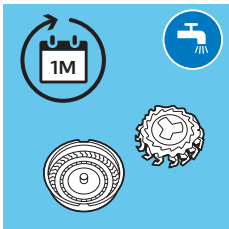

9

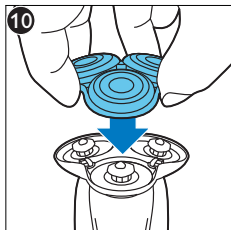
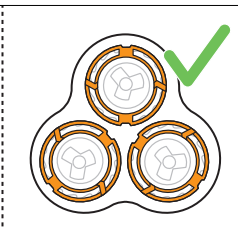
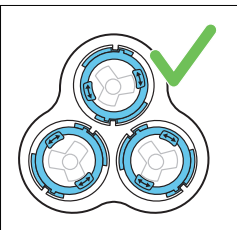
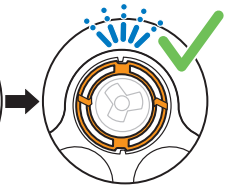
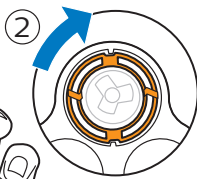
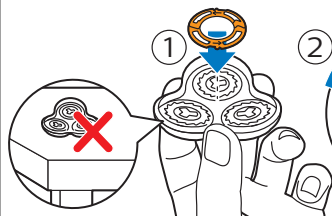
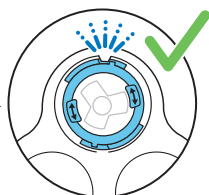
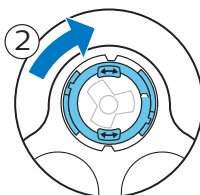
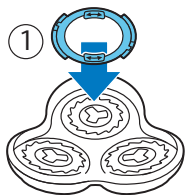

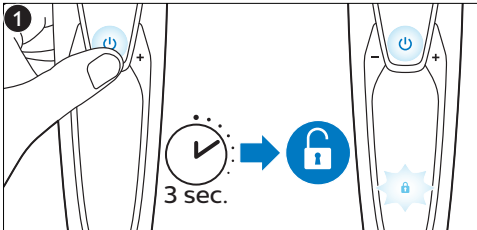
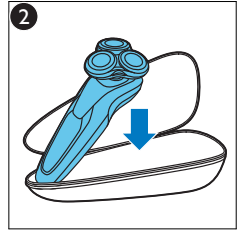
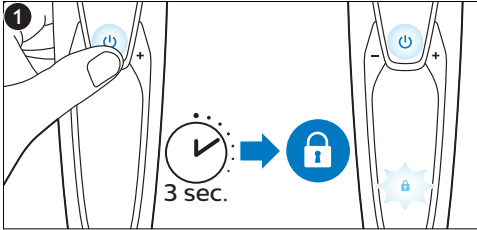

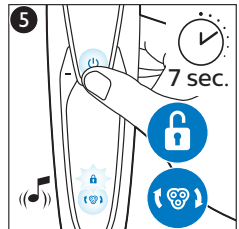
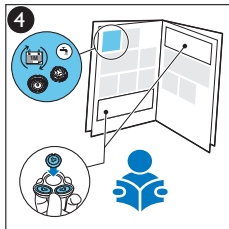
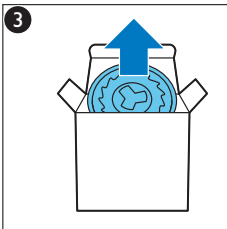
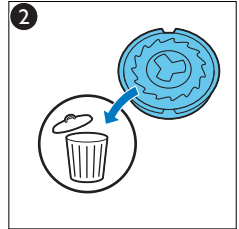
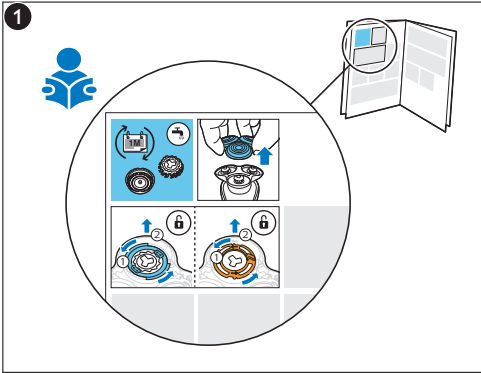
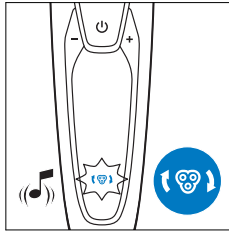

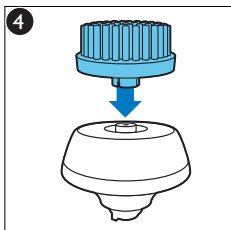
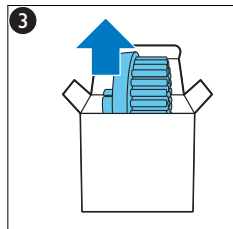
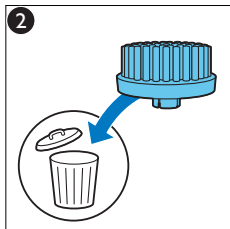
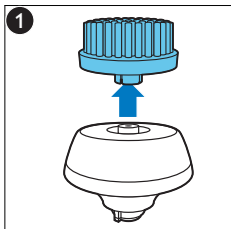
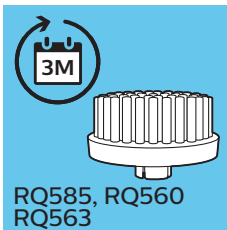

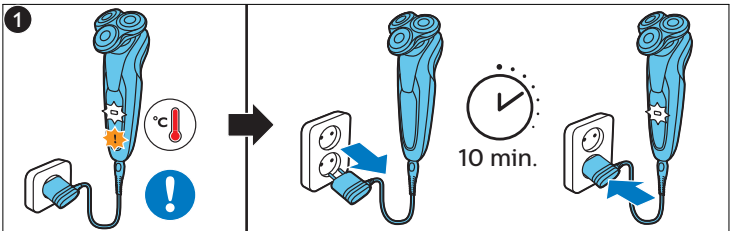
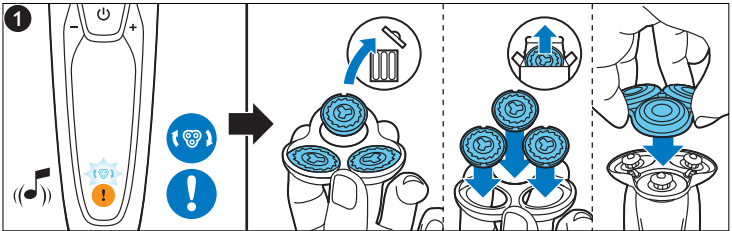
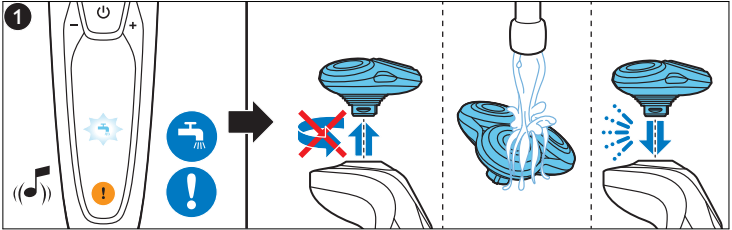
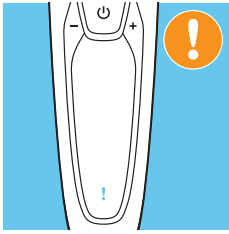



www.philips.com/support

設備名稱: 飛利浦電鬚刀 型號: S9751, S9161, S9111

單元 Unit	限用物質及其化學符號					
	鉛 (Pb)	汞 (Hg)	鎘 (Cd)	六價鉻 (Cr ⁺⁶)	多溴聯苯 (PBB)	多溴二苯醚 (PBDE)
電路板 PCBs	-	○	○	○	○	○
刀片 Electrical contact pins	-	○	○	○	○	○
電源供應器 Supply unit	-	○	○	○	○	○
金屬部件 Internal metal parts	-	○	○	○	○	○

備考1. “超出0.1 wt %”及“超出0.01 wt %”係指限用物質之百分比含量超出百分比含量基準值。
備考2. “○”係指該項限用物質之百分比含量未超出百分比含量基準值。
備考3. “-”係指該項限用物質為排除項目。

— |

| —

— |

| —

— |

| —

— |

| —

— |

| —

— |

| —

© 2018 Koninklijke Philips N.V.
All rights reserved
4222.002.7314.5 (15/10/2018)



>75 % recycled paper
>75 % papier recyclé