

Instruction Manual Smart Switch Module MS-104Z

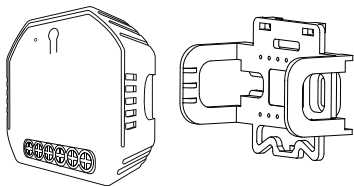

English

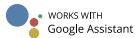

- Bitte scannen Sie den QR-Code, um das deutsche Handbuch, das Installationsvideo und die Funktionseinführung zu erhalten
- Escanee el código QR para obtener el manual en español, el video de instalación y la introducción de la función
- Veuillez scanner le code QR pour obtenir le manuel en français, la vidéo d'installation et l'introduction des fonctions
- Отсканируйте QR-код, чтобы получить руководство на русском языке, видео по установке и описание функций
- Leia o código QR para obter o manual em português, o vídeo de instalação e a introdução das funções



请扫描二维码获取中文说明书、安装视频及功能介绍

Global international operation Whenever & Wherever
You are, All-in-one Mobile App

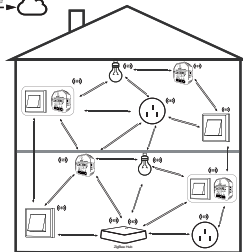

ZigBee
Mesh

Inhouse local operation

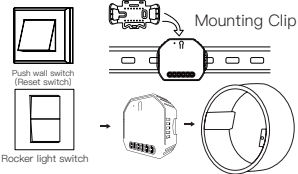
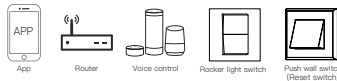

Step 1

- Turn off the circuit breaker and use the electrical tester to test the power.
- Ensure the circuit breaker is off before wiring.



⚠ Attention:

Please disconnect the power supply before installing or removing the device for avoiding irreversible damage on the device from the electric current or some unpredictable problems such as lamp flashing.

1

English

2

Step 2

- Remove the old switch

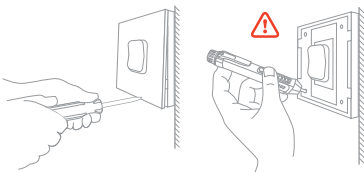

Step 3

- Remove the switch and pull it away from the wall. Identify Line/Load Wire (Note: The color of your wire may be different from the color shown on the manual.)

⚠ Verify power is off

- We recommend you remove the faceplate from the old switch and use an electrical tester to test all wires connected to the switch to ensure there is no voltage in the circuit.
- You may need to turn off more than one circuit breaker.

INSTALLATION

⚠ Warnings:

1. Installation must be carried out by a qualified electrician in accordance with local regulations.
2. Keep the device out of the reach of children.
3. Keep the device away from water, damp or hot environment.
4. Install the device away from strong signal sources such as microwave oven that may cause signal interruption resulted in abnormal operation of the device.
5. Obstruction by concrete wall or metallic materials may reduce the effective operation range of the device and should be avoided.
6. Do NOT attempt to disassemble, repair or modify the device.

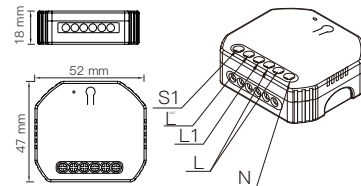

TECHNICAL SPECIFICATIONS

Model	MS-104Z
Voltage	90-250V AC
Current	10A
Wireless Protocol	Wi-Fi 2.4GHz IEEE 802.11 b/g/n
RF Frequency	RF433 MHz
Operation Temp.	-10°C - +40°C
Case Temp.	T _c : +80°C (Max.)
Dims (WxDxH)	52x47x18 mm
IP Rating	IP20

WIRING DIAGRAM

1. With one switch

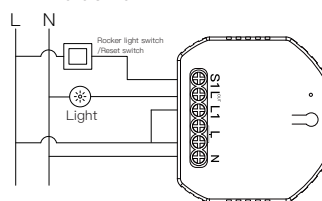

2. Without switch

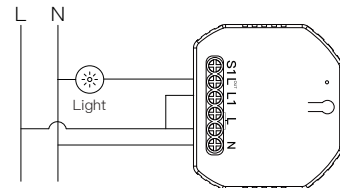

3. With 2 Way switches

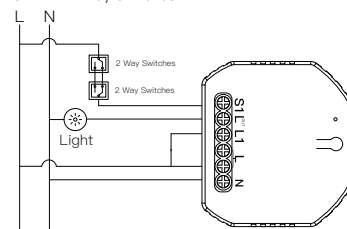

5

English

English

6

7

English

English

8

4. With Wall Socket

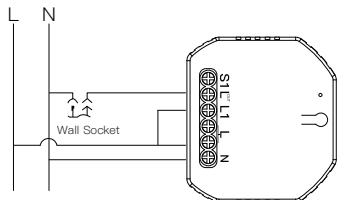

Wiring Instructions and Diagrams

1. Turn off the power supply before carrying out any electrical installation work.
2. Connect wires according to the wiring diagram.
3. Insert the module into the junction box.
4. Connect the power supply and follow switch module configuration instructions.

Notes: Put your smartphone close to the switch module when you re configuring, and make sure you have min. 50% Wi-Fi signal.

9

English

English

10

FAQ:

- Q1: What should I do if I can't configure the switch module?
- a. Please check whether device is powered on.
 - b. Make sure your mobile and Zigbee gateway hub are under the same 2.4GHz WiFi network.
 - c. Whether it's in good internet conditions.
 - d. Make sure the password entered in App is correct.
 - e. Make sure the wiring is correct.

Q2: What device can be connected to this Zigbee switch module?

Most of your household electrical appliances can be, such as lamps, laundry machine, coffee maker, etc.

Q3: What happens if the WiFi goes off?

You can still control the device connected the switch module with your traditional switch and once WiFi is active again the devices connected to App will connect automatically for normal control.

Q4: What should I do if I change the WiFi network or change the password?

You have to re-connect your Zigbee gateway hub to the new WiFi network according to the App User Manual.

3 Zigbee link method:(two matching methods)

Complete the wiring of the switch module before pairing

3.1 Method one:

Scan the QR code to configure the network guide.

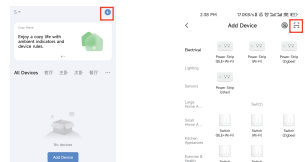

(1)

(2)



Scan the QR code



Please connect the device according to the configuration process.

13

English

English

14

Add Devices

1 Download Smart Life App



Please scan the QR code or download Smart Life on App store.

2 Registration or Log in

- Download "Smart Life" Application
- Enter the Register/Login interface; tap "Register" to create an account by entering your phone number to get verification code and "Set password". Choose "Log in" if you already have a Smart Life account.

11

English

English

3 Configure the APP to the switch

- Preparation: Ensure the switch has been connected with electricity; ensure your phone has been connected to Wi-Fi and is able to connect to the Internet.

Note:

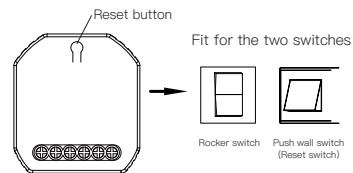

3.2 Method two:

Confirm the device beeps continuously, if not, please refer to page 14 for how to enter the network configuration.

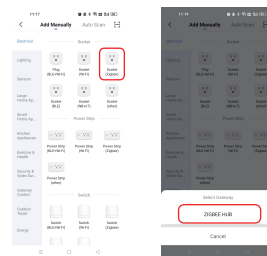

1

Open the App, select "+" on top right, choose "Switch (Zigbee)" to add device. And select the right Gateway to confirm the connection.

Note:

Make sure you have successfully connected one ZigBee gateway hub.

15

English

English

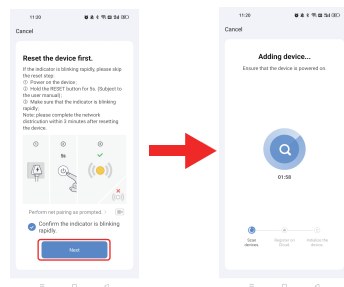

The connecting will take about 10-120 seconds to complete depending on your network condition.

16



When pairing is done, the Zigbee switch will be shown on the App.

17

Pair and clear up the RF code

1. How to pair the RF code

1.1 For reset switch: Press the switch button for 5 times until you hear Di-Di(2 times).Then press the RF transmitter switch for successful pairing.

1.2 For rocker light switch: Press the switch button for 10 times (ON/OFF cycle for 5times) until you hear Di-Di(2 times).Then press the RF transmitter switch for successful pairing.

1.3 For reset button: Long press the reset button on the switch module for 5 seconds until the beep sounds as Di-Di for 2 times. Then press the RF transmitter switch for successful pairing.

2. How to clear up the RF code

2.1 For reset switch: Press the switch button for 5 times until you hear Di-Di(2 times),waiting for 5 seconds,press the switch button for 5 times again until you hear Di-Di-Di-Di(4 times).Then the RF code is now cleared up.

2.2 For rocker light switch: Press the switch button for 10 times (ON/OFF cycle for 5times) until you hear Di-Di(2 times),waiting for 5 seconds,press the switch button for 10 times(ON/OFF cycle for 5 times) again until you hear Di-Di-Di-Di(4 times).Then the RF code is now cleared up.

English

English

18

2.3 For reset button: Long press the reset button on the switch module and release your finger until the beep sounds as Di-Di for 2 times.Then press the button after 5 seconds for 5 seconds until the beep sounds as Di-Di-Di-Di for 4 times.

3.3 How to achieve multi-control association

Note:Please confirm you have successfully finished the WiFi link method above for adding this switch to your Smart Life App before the association.

1.WiFi add another smart switch to the same Smart Life/Tuya App.(If there is a smart switch having been added before to the app,just go to next step.)**Note:There is no need to wire the new added switch to the light,only L and N are required for wiring.**



19

English

English

20

2.Then you will see two devices in the app and click the main switch(as One gang switch as below) by entering into the next operation.

3.Click in the upper right corner and choose "Multi-Control Association, and then click "+" in the right corner

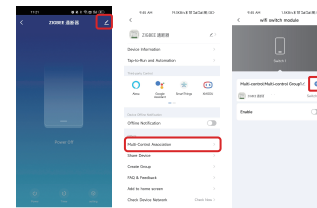

4.Choose the switch that you want to associate to and then choose the switch button that you want to control the same light.

5.Then go back to previous page,you will see two items in the page,one is your main switch,the other is the one you associate just now.

Note:Please confirm the associated switch is enabled.



6.Now you are able to control your light with two switches.Do not associate another button in the same switch for multi-control.



21

English

English

7.If you want to add another third or more smart switches to control your light,just repeat the steps above.And you will see the result as below when you associate another new switch.

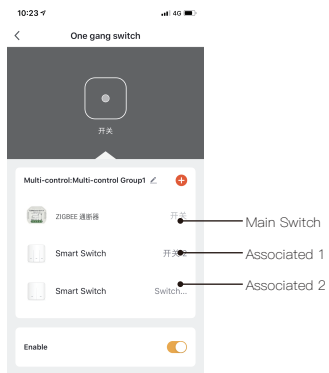

22

Enter Smart Life Skill in Alexa APP

1. Complete product networking configuration in the App

Complete the device's networking configuration according to the prompts in the App.

Note: In the App, change the name of the device to an easily identifiable name such as Alexa; names are usually in English, such as "bed light".

2. Configure the Amazon Echo device

(If you have already configured Amazon Echo, you can skip this step. The following instructions are based on the iOS client.)

•Make sure your Amazon Echo device is powered on and connected to a Wi-Fi network.

•Open the Alexa App on your phone. After successful login, tap on the menu in the upper left corner of the Home page, select "Settings" and tap "Set Up A New Device" to set up the Amazon Echo.

•Choose your Amazon Echo device type and language for connecting. Press and hold the small dot on the device until the light turns yellow. Then tap "Continue" to connect to the hotspot.

23

English

English

•After connecting to the Amazon Echo hotspot, return to the page. At this point, the connection is successful.

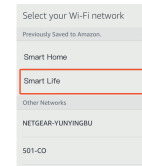
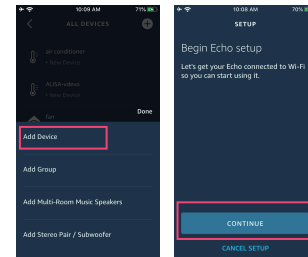

24

Tap "Continue" to proceed to the next step. Choose a Wi-Fi network to connect to. Amazon Echo will take a few minutes to try to connect to the network. After the network connection is successful, tap "Continue". An introduction video will appear. After the video ends, tap "Continue" to jump to the Alexa Home page. You have now completed the Alexa Echo's configuration process.

3. Key step —— Link Skill

Tap on "Skill" in the Alexa App menu.

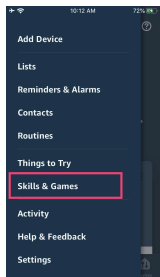

25

English

English

- Then search for "App Name". Tap "Enable" to enable the Skill.
- Enter the App account and password, then tap "Link Now" to link your App account to enable the Skill. Now you can start your smart home journey.

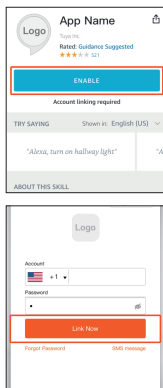

26

4. Common commands

Control the device via voice commands, now you can control your smart device with Echo. You can control your device (such as your bedroom light) with the following commands:

Alexa, turn on/off bedroom light. (Turn on/off the light)

Alexa, set bedroom light to 50 percent. (Set the light to any brightness)

Alexa, brighten/dim bedroom light. (Increase/weaken the brightness of the light)

Alexa, set bedroom light to green. (Adjust the color of the light)

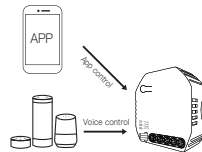

Enjoy your smart life of home automation for lighting control by using our All-in-one mobile App wherever you are in the world or simply by voice control when you are sitting at home comfortably.

27

English

SERVICE

1. During the free warranty period, if the product breaks down during normal use, we will offer free maintenance for the product.

2. Natural disasters/man-made equipment failures, disassembly and repair without the permission of our company, no warranty card, products beyond the free warranty period, etc., are not within the scope of free warranty

3. Any commitment (oral or written) made by the third party (including the dealer/service provider) to the user beyond the warranty scope shall be executed by the third party

4. Please keep this warranty card to ensure your rights

5. Our company may update or change the products without notice. Please refer to the official website for the updates.

28

RECYCLING INFORMATION

All products marked with the symbol for separate collection of waste electrical and electronic equipment (WEEE Directive 2012/19 / EU) must be disposed of separately from unsorted municipal waste. To protect your health and the environment, this equipment must be disposed of at designated collection points for electrical and electronic equipment designated by the government or local authorities.



Correct disposal and recycling will help prevent potential negative consequences for the environment and human health. To find out where these collection points are and how they work, contact the installer or your local authority.

25

English

English

WARRANTY CARD

Product Information

Product Name _____

Product Type _____

Purchase Date _____

Warranty Period _____

Dealer Information _____

Customer's Name _____

Customer Phone _____

Customer Address _____

Maintenance Records

Failure date	Cause Of Issue	Fault Content	Principal

Thank you for your support and purchase at we Moes, we are always here for your complete satisfaction, just feel free to share your great shopping experience with us.



If you have any other need, please do not hesitate to contact us first, we will try to meet your demand.

FOLLOW US

- @moessmart
- MOES.Official
- @moes_smart
- @moes_smart
- @moes_smart
- www.moeshouse.com

27

English

English



WENZHOU NOVA NEW ENERGY CO.,LTD

Address: Power Science and Technology Innovation Center, NO.238, Wei 11 Road, Yueqing Economic Development Zone, Yueqing, Zhejiang, China

Tel:+86-577-57186815

Email:service@moeshouse.com



AMZLAB GmbH

Laubenhof 23, 45326 Essen

Made In China

28