

# Electric Clothes Dryer Instruction Manual



Art. no. 2341 Batch no. 21313

CE  IPX1  
MADE IN CHINA

**KARSTEN**  
INTERNATIONAL

Overschiestraat 63  
1062XD Amsterdam  
The Netherlands  
info@karsten.nl

Thank you for purchasing the Electric clothes dryer. This manual will provide directions for effective and safe use of the product. Please read it carefully before use and store the manual in a safe place for future reference.

### 1. Specifications

Model: EV-230  
Size: 147 x 54 x 94cm  
Weight: 2.8 kg  
Power: 220-240V AC 50-60Hz 230W

### 2. Safety instructions

- For intended use only.
- Maintenance should be done by, or under the supervision of an adult.
- Do not place, store or use the product near water.
- Do not attempt to repair, disassemble or alter the product yourself.

### Notice

- Avoid exposure to high temperatures, and high humidity.
- Only place fabrics that are tumble dry of has been wrung out.
- Only use to dry machine washable fabrics (45°C and up).

### 3. Description of parts

1. Power cord with EU plug
2. Switch button
3. Support legs
4. Heating region

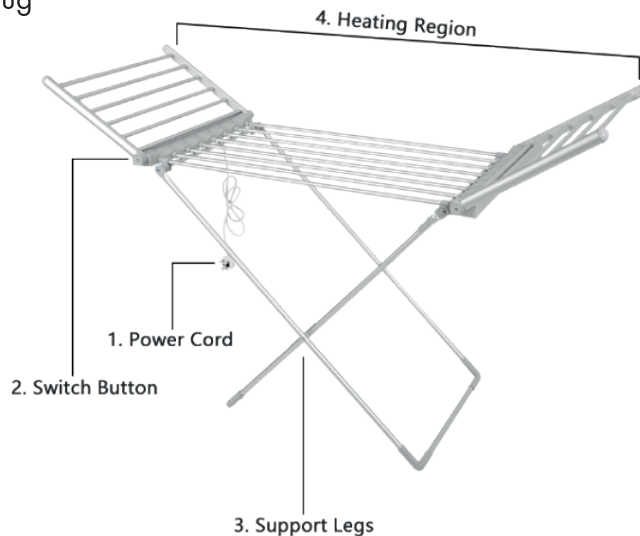

### 4. Operation

1. Place the product on flat, hard surface and extend the support legs fully for maximum stability.
2. Connect the electric clothes dryer to the mains socket.
3. Flick the switch to activate the product. After 5 minutes, the temperature of the heating region remains constant at 45-50°C.

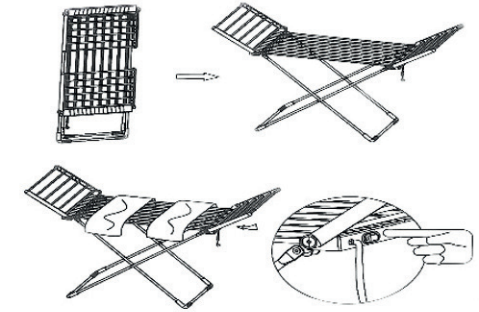

**Note:** Unplug for long-term storage.

### 5. Maintenance

Unplug the electric clothes dryer and allow the heating region to cool down. Clean the product with a slightly damp towel and wipe it dry with a soft cloth. Store it in a cool, dry place. Make sure the power cord and plug are completely dry before reuse.

**Note:** Do not use scouring pads or an abrasive detergent to clean the device.

### 6. Disposal



The crossed out wheellie bin symbol on this product is to remind you that electrical products should not be disposed of with household waste. Please dispose of it responsibly at an approved waste or recycling facility. Check with your local authority for recycling advice.



Dispose of all packaging materials in an environmentally friendly manner.