

Manuals+ — User Manuals Simplified.



Mi Smart Standing Fan 1C User Manual

	<p>Odlo Performance Evolution Light Short...</p> <p>€ 34,95</p>	<p>Ezviz X5S Draadloze Wifi NVR</p> <p>€ 48,95</p>	<p>6 Paar Nomad Hiking Sokken Crew, Quart...</p> <p>€ 19,95</p>	<p>Knomo London Barbican Sleeve 13" ..</p> <p>€ 39,95</p>
	<p>Craft Polo Casual Pique Navy</p> <p>€ 16,95</p>	<p>Nike Dri-Fit Park Trainingsjack Heren 41...</p> <p>€ 19,95</p>	<p>Craft T-shirt ADV Charge Wit</p> <p>€ 19,95</p>	<p>Dare 2b Aces II Cycle Top Heren Athlet/Ebony</p> <p>€ 11,95</p>

Home » [Xiaomi](#) » Mi Smart Standing Fan 1C User Manual

Contents [hide

- 1 User Manual
 - 1.1 Mi Smart Standing Fan 1C
- 2 Safety Instructions
 - 2.1 Precautions
 - 2.2 Warnings
 - 2.3 Warnings
- 3 Package Contents
- 4 Overview
- 5 Installation Instructions
- 6 How to Use
- 7 Turn on/off
- 8 Troubleshooting
- 9 Specifications

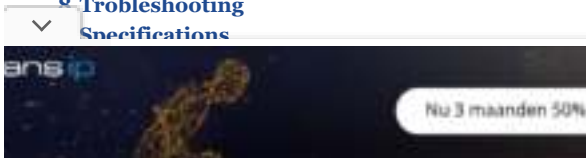

User Manual



Mi Smart Standing Fan 1C

Safety Instructions

Read this manual carefully before use, and retain it for future reference.

Precautions

Installation

- Make sure the fan is properly installed according to the instructions, so as to avoid electric shocks, fire, personal injury, or other damage.
- Do not connect the fan to a power outlet as long as it is not assembled.

Handling the Fan

- Turn off and unplug the fan before moving it.
- Firmly hold the fan stand to avoid it from falling down and causing personal injury.

Using the Fan

- Immediately stop using the fan if it makes unusual sounds, gives off bad odors, overheats, or rotates irregularly.
- Do not lean on or tilt the fan while it is running.
- Do not push the fan's head repeatedly so as to avoid damage to the internal mechanism.

Power Cord

- Unplug the power cord before repairing or moving the fan.
- Always unplug the fan by pulling the power plug rather than the cord.



Warnings

Improper use may lead to electric shocks, fire, personal injury, or other damage.

- This appliance can be used by children aged from 8 years and above and persons with reduced physical, sensory or mental capabilities or lack of experience and knowledge if they have been given supervision or instruction concerning use of the appliance in a safe way and understand the hazards involved. Children shall not play with the appliance. Cleaning and user maintenance shall not be made by children without supervision. (For European countries or regions)
- This appliance is not intended for use by persons (including children) with reduced physical, sensory or mental capabilities, or lack of experience and knowledge, unless they have been given supervision or instruction concerning use of the appliance by a person responsible for their safety.
- Children should be supervised to ensure that they do not play with the appliance. (For no European countries or regions)
- Once assembly completed, it's strictly forbidden to remove the guards for any purpose.
- Children should be supervised to ensure that they do not play with the appliance.
- If the supply cord is damaged, it must be replaced by the manufacturer, its service agent or similarly qualified persons in order to avoid a hazard.

Warnings

Improper use may lead to electric shocks, fire, personal injury, or other damage.

- Do not use this fan in place where it is easy to fall over or where there are other unstable objects nearby.
- Do not use this fan in hot and humid environments such as a bathroom.
- Do not use this fan if its power cord is damaged or its power plug is loose.
- Do not use this fan if its front grille is not installed, or its rear grille is loose or fell off.
- Do not allow adults who are incapable of operating this fan or children to use it.
- Do not disassemble or repair this fan.
- Do not pinch, bend, or twist the power cord too much, so as to prevent from exposing or breaking its core.
- Do not insert your fingers or any object into the front grille, rear grille, or the fan blades when the fan is in use.
- Keep hair and fabrics away from the fan to avoid getting them caught in the fan.
- Do not use any improper power outlet.
- Do not use the supplied power cord with any other device.
- Under normal use of condition, this equipment should be kept a separation distance of at least 20cm between the antenna and the body of the user.

Package Contents



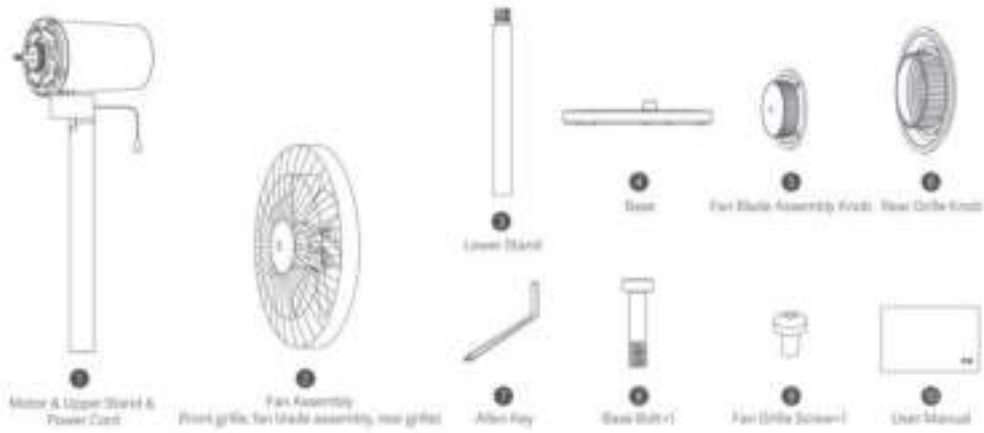

Note: Illustrations of the product, accessories, and user interface in the user manual are for reference purposes only. The actual product and functions may vary due to product enhancements.

Overview

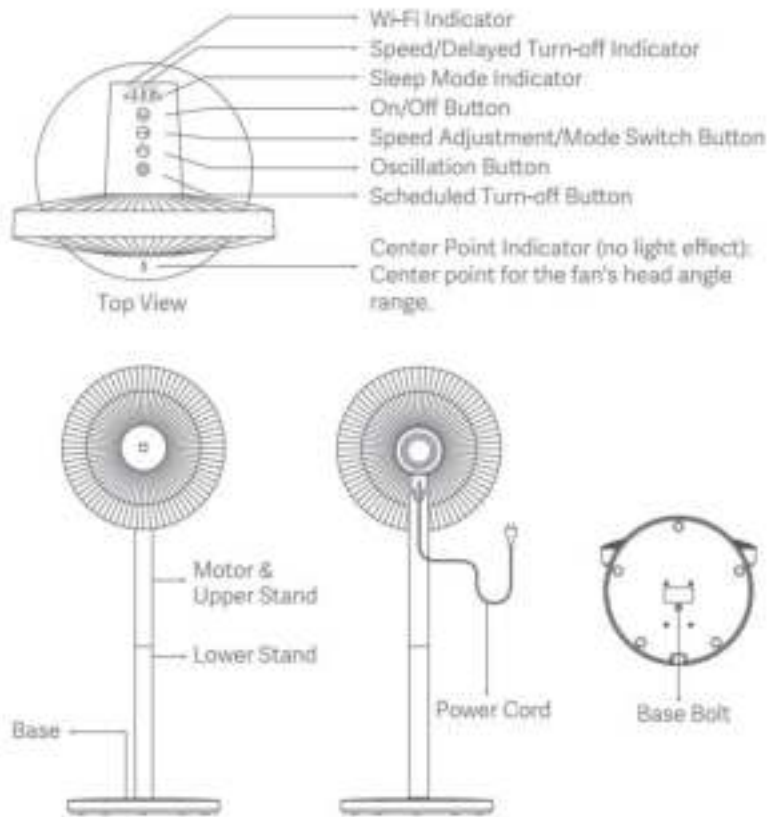

Installation Instructions

Step 1: Base installation

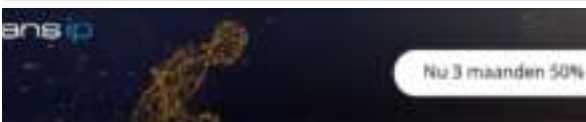

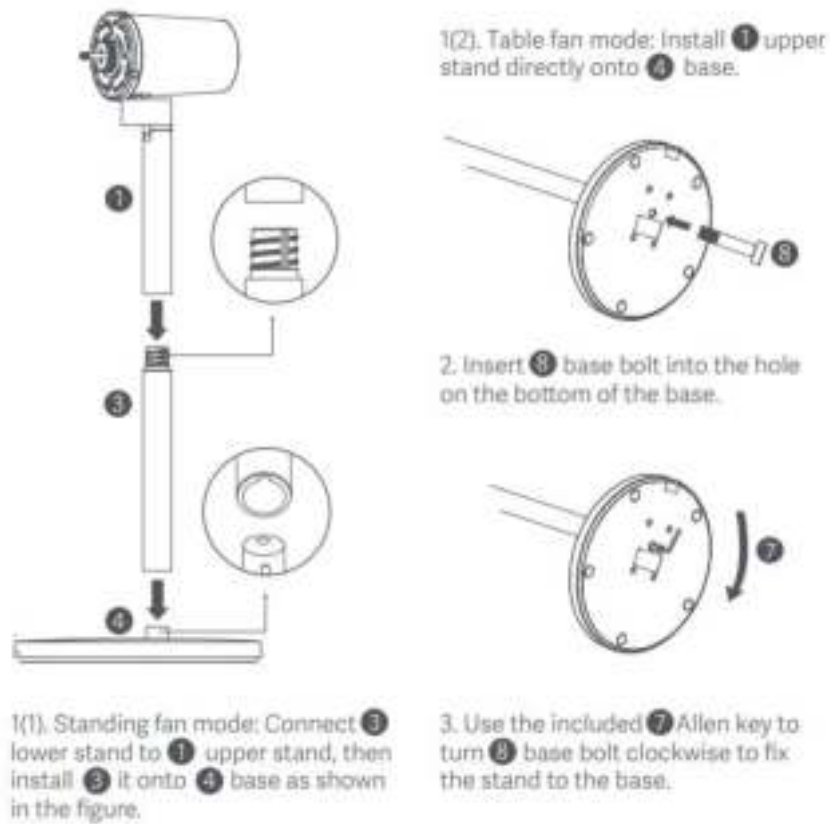

Step 2: Open the fan assembly

Disassemble ② fan assembly as shown in the figures below: ① Turn the front grille counterclockwise until the grilles are properly loosened. ② Then remove ⑪ front grille from ⑬ rear grille and take out ⑫ fan blade assembly.

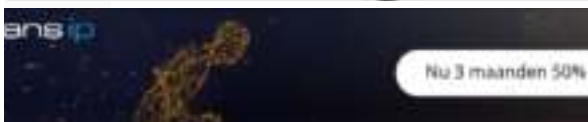
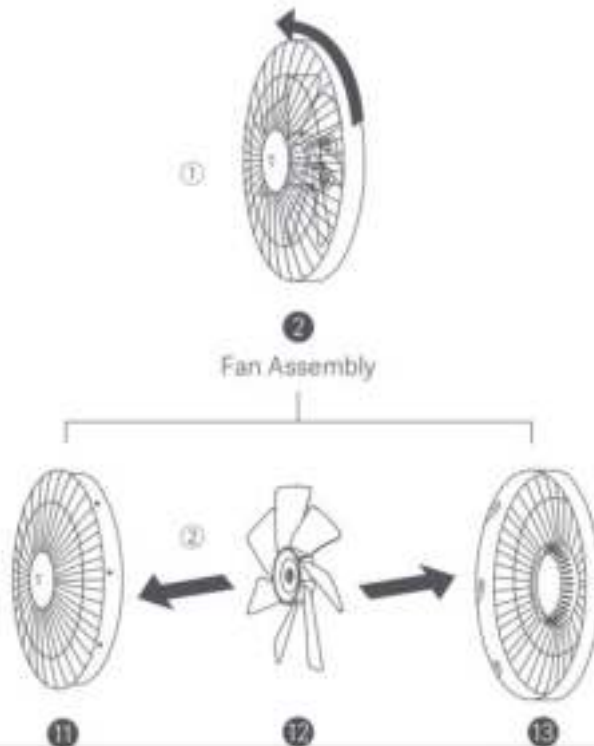

Step 3: Install the rear grille

Make sure  points up when installing **13** rear grille onto the motor, and turn **6** rear grille knob clockwise to tighten the rear grille to the motor.

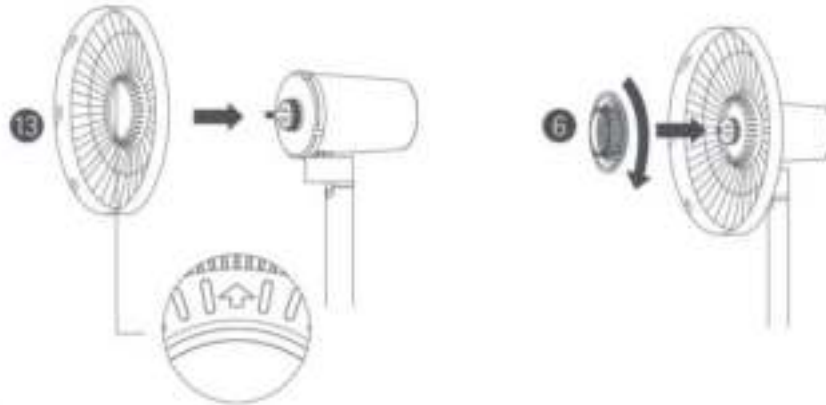

Step 4: Install the fan blade assembly

Align the center hole of **12** fan blade assembly with the motor's shaft and install it onto the shaft, then install **5** fan blade assembly knob onto the motor's shaft. Turn the knob counterclockwise in order to fix the fan blade assembly to the motor's shaft.

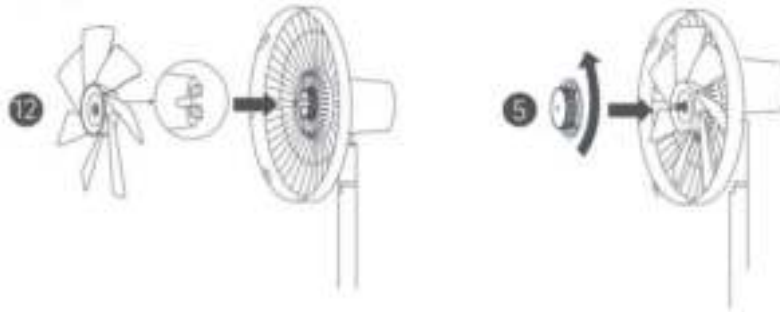

Step 5: Install the front grille



1. Align **11** Front Grille Alignment Mark with **13** Rear Grille Left Alignment Mark, and make sure the front grille is properly embedded into the rear grille.
2. Turn the front grille clockwise until the Front Grille Alignment Mark aligns the Rear Grille Right Alignment Mark. Make sure the grilles are securely fastened.

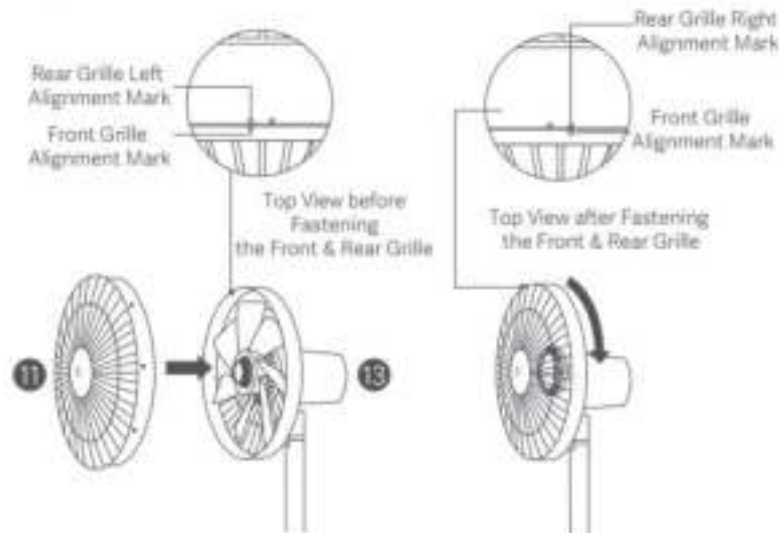

Step 6: Fasten the front grille

Insert **9** fan grille screw into the hole at the bottom of the fan grille. Turn the screw clockwise by using the included **7** Allen key to tighten it.



How to Use

Connect to a power outlet

Plug the power cord into a power outlet. Once you hear a beep, the fan is connected successfully.

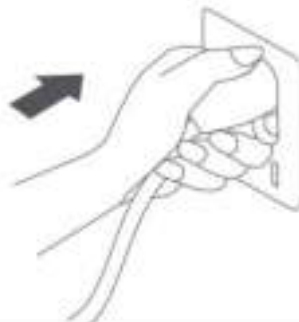

Turn on

- Press the button  to start the fan. When turned on for the first time, the default speed is slow (1).

Turn off

- When the fan is working, press and hold the button to stop it.

Switching Speed/Mode

Switching speed

Press the button  to adjust the speed. With each press, the corresponding status indicator will be on (see the table below). The fan will remember and apply the last used speed mode when turned on again.

Fan Speed	Slow (1)	Medium (2)	Fast (3)
Indicator Status	● ● ●	● ● ●	● ● ●

Note: ● means the indicator is on; ● means the indicator is off.

Switching mode

Press and hold the button  to switch between direct breeze and sleep mode. The sleep mode indicator is on while in sleep mode, and off while in direct breeze mode.

Note: The fan is set to direct breeze by default. The fan will remember and apply the last used mode when turned on again.

Enable/Disable Oscillation

Press the button  to enable or disable 90° oscillation. The fan will remember and apply the last used oscillation setting when turned on again.

Delayed Turn-off



Press the button  to cycle through the delayed turn-off times: 1 hour, 2 hours, 3 hours, and disabled, and the corresponding status indicator(s) will be on (see the table below). Five seconds after using the delayed turn-off function, the status indicator(s) will display the corresponding status of the currently selected speed.

Scheduled Status	Disabled	1 hour	2 hours	3 hours
Indicator Status	● ● ●	● ● ●	● ● ●	● ● ●

Note: ● means the indicator is on; ● means the indicator is off.

For more delayed turn-off options (up to 8 hours), please go to the Mi Home/Xiaomi Home app.

Adjust the Airflow Direction

Connect with Mi Home/Xiaomi Home App

Wi-Fi Indicator Status:

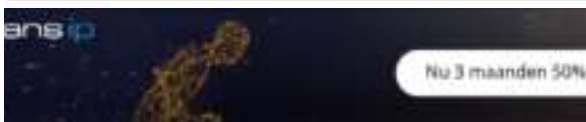

Resetting the Wi-Fi

The Wi-Fi connection needs to be reset on the circumstances listed in the table below.

Child Safety Lock

Enabling

You can enable the function of child lock in the Mi Home/Xiaomi Home app. Once it is enabled, the fan will not respond to usual operations but instead of all indicators blinking twice with two beeping sounds.

Disabling

You can disable the function of child lock in the Mi Home/Xiaomi Home app. Resetting the Wi-Fi connection or unplugging and plugging in the fan again can also disable this function.

Troubleshooting

Specifications

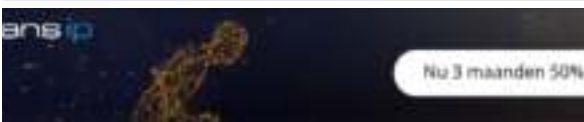

Hereby, Zhejiang Xingyue Electric Equipment Co., Ltd. declares that the radio equipment type JLLDS01XY is in compliance with Directive 2014/53/EU. The full text of the EU declaration of conformity is available at the following internet address:

<http://www.mi.com/global/service/support/declaration.html>

All products bearing this symbol are waste electrical and electronic equipment (WEEE as in directive 2012/19/EU) which should not be mixed with unsorted household waste. Instead, you should protect human health and the environment by handing over your waste equipment to a designated collection point for the recycling of waste electrical and electronic equipment, appointed by the government or local authorities. Correct disposal and recycling will help prevent potential negative consequences to the environment and human health. Please contact the installer or local authorities for more information about the location as well as terms and conditions of such collection points.

Manufactured for: Xiaomi Communications Co., Ltd.
Manufactured by: Zhejiang Xingyue Electric Equipment Co., Ltd.
(a Mi Ecosystem company)

Address: South Side, 24th Floor, Jinpin Building, Headquarters
Center, Yongkang City, Zhejiang Province, China

For further information, please go to www.mi.com

WARRANTY NOTICE

THIS WARRANTY GIVES YOU SPECIFIC RIGHTS, AND YOU MAY HAVE OTHER RIGHTS CONVEYED BY LAWS OF YOUR COUNTRY, PROVINCE OR STATE.

INDEED, IN SOME COUNTRIES, PROVINCES OR STATES, CONSUMER LAW MAY IMPOSE A MINIMUM WARRANTY PERIOD. OTHER THAN AS PERMITTED BY LAW, XIAOMI DOES NOT EXCLUDE, LIMIT OR SUSPEND OTHER RIGHTS YOU MAY HAVE. FOR A FULL UNDERSTANDING OF YOUR RIGHTS WE INVITE YOU TO CONSULT THE LAWS OF YOUR COUNTRY, PROVINCE OR STATE.

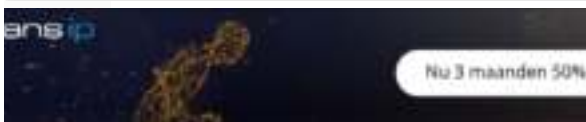

accordance with the respective Product user manual, during the Warranty Period. The duration and conditions related to the legal warranties are provided by respective local laws.

For more information about the consumer warranty benefits, please refer to Xiaomi's official website <https://www.mi.com/en/service/warranty/>. Xiaomi warrants to the original purchaser that its Xiaomi Product will be free from defects in materials and workmanship under normal use in the period mentioned above. Xiaomi does not guarantee that the operation of the Product will be uninterrupted or error free. Xiaomi is not liable for damages arising from non-compliance with the instructions related to the use of the Product.

2. REMEDIES

If a hardware defect is found and a valid claim is received by Xiaomi within the Warranty Period, Xiaomi will either (1) repair the product at no charge, (2) replace the product, or (3) refund the Product, excluding potential shipping costs.

3. HOW TO OBTAIN WARRANTY SERVICE

To obtain warranty service, you must deliver the Product, in its original packaging or similar packaging providing an equal degree of Product protection, to the address specified by Xiaomi. Except to the extent prohibited by applicable law, Xiaomi may require you to present proofs or proof of purchase and / or comply with registration requirements before receiving warranty service.

4. EXCLUSIONS AND LIMITATIONS

Unless otherwise stipulated by Xiaomi, this Limited Warranty applies only to the Product manufactured by or for Xiaomi and identifiable by the trademarks, trade name or "Xiaomi" or "Mi" logo.

The Limited Warranty does not apply to any (a) Damage due to acts of nature or God, for example, lightning strikes, tornadoes, flood, fire, earthquake or other external causes; (b) Negligence; (c) Commercial use; (d) Alterations or modifications to any part of the Product; (e) Damage caused by use with non-Xiaomi products; (f) Damage caused by accident, abuse or misuse; (g) Damage caused by operating the Product outside the permied or intended uses described by Xiaomi or with improper voltage or power supply; or (h) Damage caused by service (including upgrades and expansions) performed by anyone who is not a representative of Xiaomi.

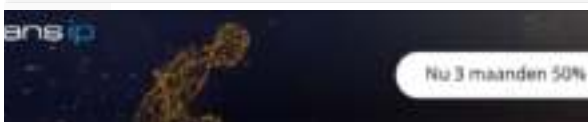

It is your responsibility to backup any data, software, or other materials you may have stored or preserved on the product. It is likely that the data, software or other materials in the equipment will be lost or reformatted during the service process, Xiaomi is not responsible for such damage or loss. No Xiaomi reseller, agent, or employee is authorized to make any modification, extension, or addition to this Limited Warranty. If any term is held to be illegal or unenforceable, the legality or enforceability of the remaining terms shall not be affected or impaired.

Except as prohibited by laws or otherwise promised by Xiaomi, the after-sales services shall be limited to the country or region of the original purchase. Products which were not duly imported and/or were not duly manufactured by Xiaomi and/or were not duly acquired from Xiaomi or a Xiaomi's official seller are not covered by the present warranties. As per applicable law you may benefit from warranties from the non-official retailer who sold the product. Therefore, Xiaomi invites you to contact the retailer from whom you purchased the product. The present warranties do not apply in Hong Kong and Taiwan.

5. IMPLIED WARRANTIES

Except to the extent prohibited by applicable law, all implied warranties (including warranties of merchantability and fitness for a particular purpose) will have a limited duration up to a maximum duration of this limited warranty. Some jurisdictions do not allow limitations on the duration of an implied warranty, so the above limitation will not be applied in these cases.

6. DAMAGE LIMITATION

Except to the extent prohibited by applicable law, Xiaomi shall not be liable for any damages caused by accidents, indirect, special or consequential damages, including but not limited to loss of profits, revenue or data, damages resulting from any breach of express or implied warranty or condition, or under any other legal theory, even if Xiaomi has been informed of the possibility of such damages. Some jurisdictions do not allow the exclusion or limitation of special, indirect, or consequential damages, so the above limitation or exclusion may not apply to you.

7. XIAOMI CONTACTS

For customers, please visit the website: <https://www.mi.com/en/service/warranty/>

The contact person for the after-sale service may be any person in Xiaomi's authorized service network, Xiaomi's authorized distributors or the final vendor who sold the products to you. If in doubt please contact the relevant person as Xiaomi may identify.

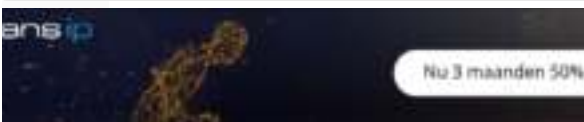

Mi Smart Standing Fan 1C User Manual – [Optimized PDF](#)

Mi Smart Standing Fan 1C User Manual – [Original PDF](#)

Questions about your Manual? Post in the comments!

Related Manuals

1. [Mi Smart Band 5 User Manual](#) Mi Smart Band 5 User Manual Read this manual carefully...
2. [Mi Smart Band 4 User Manual – XMSH07HM](#) Mi Smart Band 4 User Manual – XMSH07HM – Optimized...
3. [Mi 10000mAh Mi 18W Fast Charge Power Bank 3 User Manual](#) 10000mAh Mi 18W Fast Charge Power Bank 3 User Manual...
4. [Xiaomi Mi 10T 5G Smart Phone User Manual](#) Mi 10T User Guide Thank you for choosing Mi 10T...
5. [Mi 10T 5G Smartphone User Manual](#) Mi 10T 5G Smartphone User Manual – Optimized PDF Mi...
6. [Mi True Wireless Earphones 2S User Manual](#) Mi True Wireless Earphones 2S Product Overview Charging Case Earphones...



