

尺寸:宽220X高110mm

Know about the Smart Gateway

This smart gateway, adopting super low power consumption Bluetooth technology, can work with kinds of smart sensors and smart home appliances to build a smart home system and the gateway works as the central controller. Built-in Wi-Fi module support direct connection to user's home Wi-Fi network.

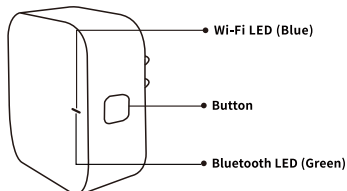

Wi-Fi LED(Blue)

Blinking:The gateway enters wi-fi configuration mode
ON:Connected to the wi-fi network

Button

Reset or enter Wi-fi configuration mode :Press and hold the button for 5 seconds until the blue LED blinks, the gateway will enter Wi-fi configuration mode

Bluetooth LED(Green)

Blinking:The gateway enters Bluetooth network configuration mode(preparing to add subdevice)
ON:The gateway is under standby status

(1)

Quick Installation Guide

1.(If you have installed the smart life APP on your mobile phone ,please go to step2)Scan below QR code or search **Smart Life** in APP Store or Google Play to install APP(new user must register account first).



2.Connect mobile phone to your 2.4GHz Wi-Fi router (with internet) and plug in the Smart Gateway to outlet.

(2)

3.Run **Smart Life** APP, Click"+" at the top right corner, **turn on bluetooth at your phone.**

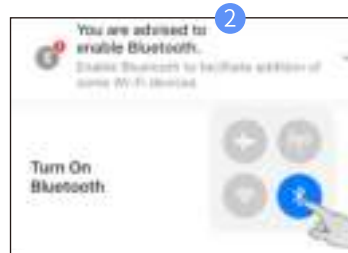
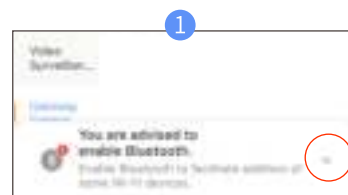

(3)

4. Select Gateway Control-> Wireless Gateway(Bluetooth)

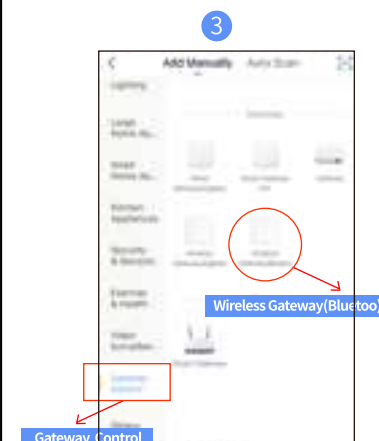

(4)

5.Pressing the button for 5 seconds until the blue LED blinks, then follow the in-app instructions to connect the smart gateway to your network.

1

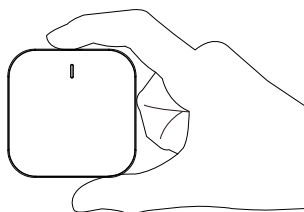

2



(5)

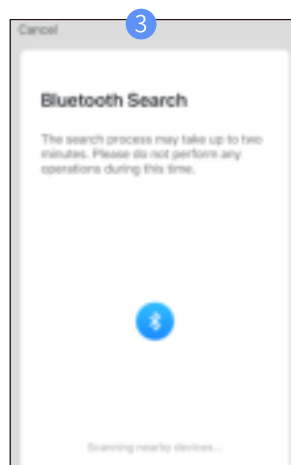

3

4

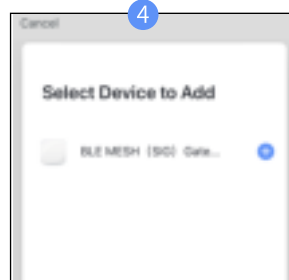

(6)

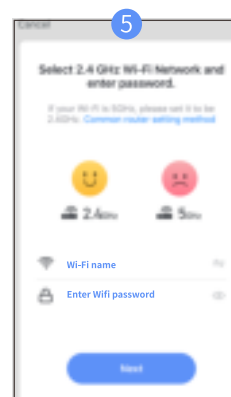

5

6

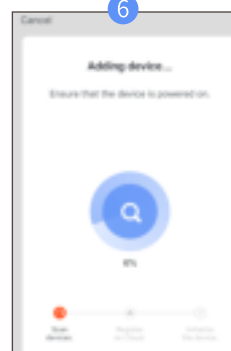

(7)

6.Waiting for a few seconds,you can see the gateway is shown and you may rename it

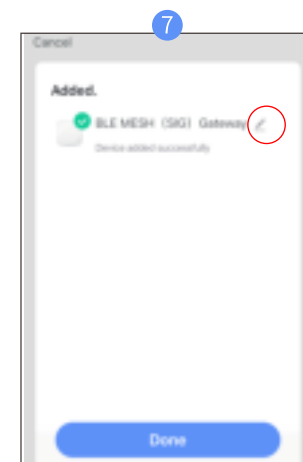

7.Press Done to finish the installation of gateway

(8)

正面

反面