

9 Battery level

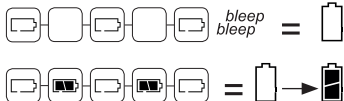

10 Lock

on/off
3 sec

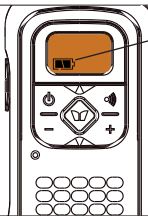
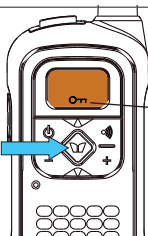

11 Channel scan

3 sec

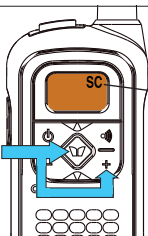

SC
1 (...) 16

Stop:
PTT

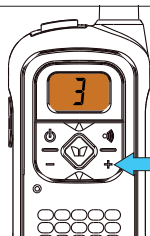

Next

12 Squelch

3 sec

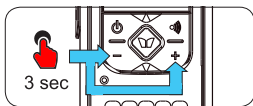

ON

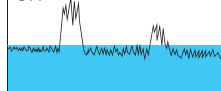

OFF

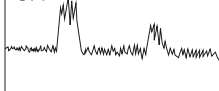

Squelch on to suppress the sound of channel noise when the radio is not receiving a transmission.

13 Display light off

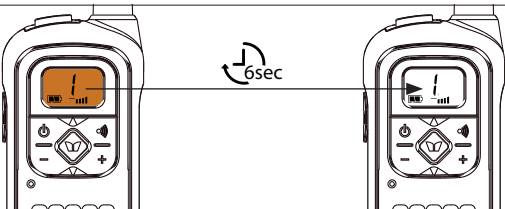

14 Power by chargerpod

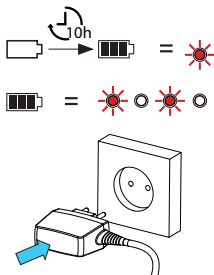
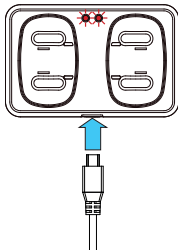
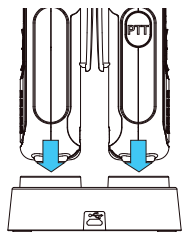

15 Power by cable

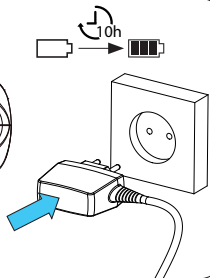
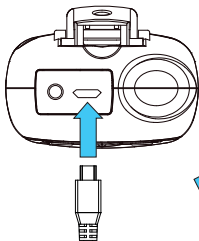
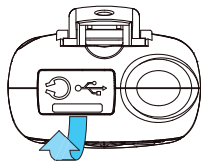

DECLARATION OF CONFORMITY

Hereby, Hesdo declares that the radio equipment type Alecto FR-125 is in compliance with directive 2014/53/EU. The full text of the EU declaration of conformity is available at the following internet address: <http://DOC.hesdo.com/FR-125-DOC.pdf>

Use only supplied adapter



Input: 100-240V~
50/60Hz 100mA
Output: 5V --- 550mA
Model: TGE050P055



Frequency Range : 446.00625 - 446.09375 MHz
Maximum Power : < 6,5 dBm

Hesdo bv.
Aziëlaan 12, 5232 BA
's-Hertogenbosch
The Netherlands
www.alecto.com

CE
v1.2