

English



Electric Baby Nasal Aspirator

This manual contains important information. Please keep it

EN-01

01/ PRODUCTS DESCRIPTION

This product is an electric waterproof nasal aspirator(IPX 6 waterproof), which is used for cleaning nasal secretions of babies. The product has 4 different silicone tips, which are the gourd-shaped (flat, oblique) suction tip and funnel-shaped (flat, oblique) suction tip respectively, suitable for babies of different ages. These tips are made of silica gel, which is soft, non-irritating, safe and environmentally friendly. Different shapes of silicone tips make it easy to absorb secretions from different parts. Large-capacity lithium battery and USB charging design make it more convenient to use and carry.



This operation manual contains safety attentions and instructions for the proper use of the product. Therefore, please read the manual carefully before use and keep it properly so as to avoid loss and hurt caused by improper use.

EN-02

02 / PRODUCT FEATURES

- **Replaceable Design of The Silicone Tip**
There are 4 different suction tips, which can be flexibly chosen according to baby's age and needs.
- **Adjustable Operation Mode**
Soft, moderate and strong suction mode, can be switched freely according to your own needs, and designed with 3 minutes automatic power-off function, to prevent machine idling for a long time.
- **Safety Design**
The 90° bending design can prevent accidental touching and causing injuries, making it safer to use.
- **The FDA Certification**
Conforms to international standard suction range 20-60kpa, passed FDA as well Eu agreement CE /ROHS certification, this product is made of all safe materials and is harmless to baby's skin. Please rest assured to use!
- **Night Mode**
The LED lamp can be turned on when the device is in operation. The warm color light will not irritate the baby's skin and eyes. It is convenient to use at night and helps to see the inside of the baby's nasal cavity.

EN-03

● Easy to Clean

This product is IPX 6 waterproof, can be washed by absorbing water, or rinse under the tap (but please don't immerse in the water). Suction components and reservoir can be removed for cleaning, which allows better removal of residues and more thorough cleaning of the machine.

● Small & Easy to carry

Rechargeable design, manipulating ease and comfort grip. Compact device, lightweight and easy to carry.

● Large Capacity & Rechargeable

Equipped with built-in 400mAH large capacity rechargeable lithium battery and USB portable charging port design, this machine can be charged via computers, power banks and any other devices with a USB port. You can use it at any time whether at home or out.

EN-04

03/ GENERAL INTRODUCTION



EN-05

04 / COMPONENTS INFORMATION

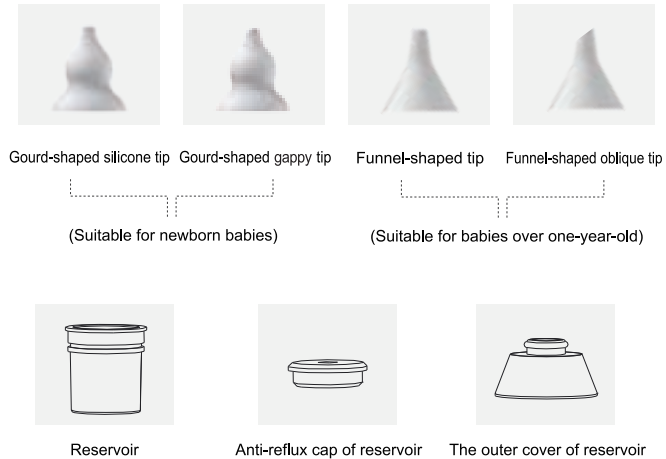

EN-06

05 / INSTALLATION

01



Cover the reservoir with anti-reflux cap

02

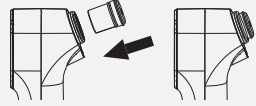

Install the assembled reservoir into the groove of the aspirator body

03



Then install the outer cover on the body and then tighten clockwise to ensure the suction part is working properly

04

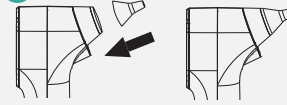

Choose the suitable tip and install it on the outer cover of reservoir

EN-07

06 / INSTALLATION ORDER

When installing, please pay attention to the installation sequence of components and please tighten it clockwise to ensure that the parts will not fall off.

Reservoir → Anti-reflux cap of reservoir → The outer cover of Reservoir → The silicone tip

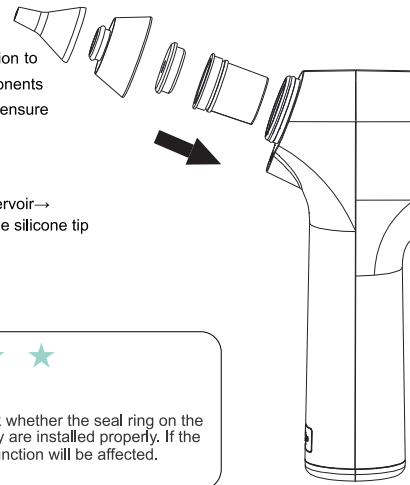

Note

During assembly, please check whether the seal ring on the reservoir and the aspirator body are installed properly. If the seal ring falls off, the suction function will be affected.

EN-08

07 / INTRODUCTIONS OF SILICONE TIPS



Gourd-shaped Tips (Flat, Gappy)

Suitable for newborn babies, smaller tips can be appropriately extended into the nostril. The hoist can block off nostrils, making it easier to suck out the nasal mucus. The oblique tip can be better close to the sidewall of the nasal cavity, and it will be easier to absorb attached nasal mucus.



Funnel-shaped Tips (Flat, Oblique)

Suitable for children over 1 year old. The funnel-shaped tip goes deeper into the nasal cavity, which is more suitable for deeper nasal mucus. The oblique tip can be better close to the sidewall of the nasal cavity, and it will be easier to absorb attached nasal mucus.



EN-09

08 / HOW TO USE

Firstly assemble the nasal aspirator according to the section "Assembling". Please make sure that the seal ring of the aspirator body has been fixed and install a suitable silicone tip on the outer cover. At last, choose the appropriate mode according to your needs.

Specific Method

1. If the baby's snot is dry, it is better to soften the mucus with saline first and then use the electric nasal aspirator. This will achieve a better effect.
2. If the baby's mucus is thin, you can directly use the electric suction device to suck out.
3. If you can not see the baby's mucus but can hear the sound of "wheeze", the baby is also in a state of nasal congestion. It is recommended to gently stimulate the baby's nose and let the baby sneeze and then use the electric nasal aspirator suck out.

Use Suggestions

Before using the electric nasal aspirator for the baby, parents should first test the suction with the back of the hand and adjust it to the appropriate mode.

- 1 Please charge the battery for 2 hours before using it for the first time to extend battery life.
- 2 Press the "button" once for soft suction mode
Press the "button" twice for moderate suction mode
Press the "button" three times for strong suction mode
Then press "button" again for shutdown mode

EN-10

09 / CLEAN AND MAINTENANCE

- 01 The tips and reservoir can be removed separately for cleaning, you can also rinse them directly under the tap, with included cleaning brush.
- 02 You can use a cotton swab dipped with medical alcohol to clean the exhaust vent and make sure the parts are completely dry before assembly to prevent bacteria forming. (Do not use sharp or corrosive, volatile cleaning materials, so as not to affect the life of the machine.)
- 03 Before use, please make sure that the components have been cleaned and there is no liquid residue, to avoid bacteria growth and affect suction.
- 04 Please turn off the machine when cleaning and maintaining. Do not immerse machine into water.

10 / SAFETY ATTENTION

- 01 Do not allow children to use this product by themselves. Please adjust the suction mode first on the back of the adult's hand before use.
- 02 Please use the supporting USB cable for charging, to ensure that the charging voltage meets the product requirements.
- 03 Do not charge during use.
- 04 If it is not in use for a long time (about three months), please take out the machine and fully charge it before storing.
- 05 Do not disassemble or repair this product by yourself. For repairs, please kindly contact us.

EN-11

11 / ENVIRONMENTAL PROTECTION TIPS

For everybody's interest and to participate actively in protecting the environment, please do not stack together with other normal household waste when throwing away the product. It should be handed over to an official designated recycling center that will be better for environmental protection.
The battery must be removed from the appliance before the device is discarded. When removing the battery, the appliance must be powered off. The battery should be disposed of safely.

12 / SPECIFICATION

Product Name	Electric Baby Nasal Aspirator
Model No.	X10S
Charging Voltage	5V
Operating Voltage	3.7V
Power	2.2W
Battery Capacity	400MAH
Executive Standard	GB4706.1 GB4705.15