

□ DC515 XX

DE Contents **DE** Inhalt **FR** Contenu **M** Inhoud **FI** Sisältö
 UK Inhold **IT** Contenuto **ES** Contenido **PT** Conteúdo
GR Περιεχόμενα **SE** Innehåll



x1



x1



x2



x2

CR2032



x2



x1

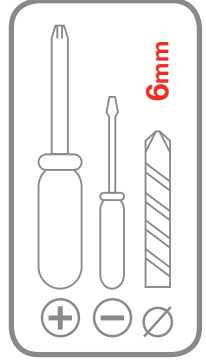

6mm

GR Getting started **DE** Erste Schritte **FR** Démarrage **UK** Aan de slag **FI** Aloitusopas **ES** Kom i gang
IT Operazioni preliminari **ES** Para empezar **PT** Para começar **GR** Πρώτα βήματα **SE** Kom igång

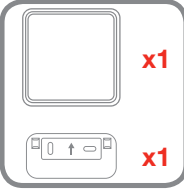
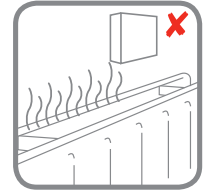
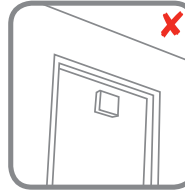

x1

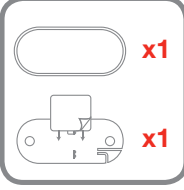

x1

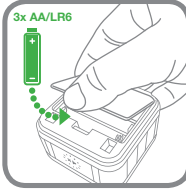

3x AA/LR6

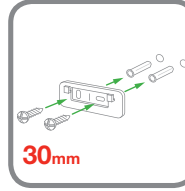

30mm

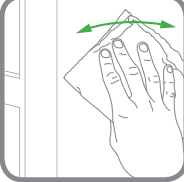
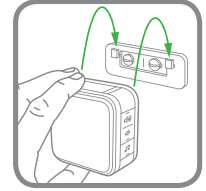

15mm

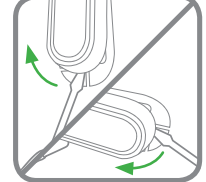
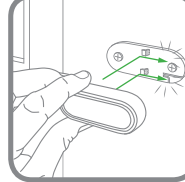

GB Optional features 05 Optionale Funktionen 06 Options disponibles 07 Opções disponíveis 08 Valinnaiset ominaisuudet 09 Valgrie funkcioner 10 Funzionalità opzionali 11 Opciones disponibles
 PT Funções opcionais 02 Προαιρετικές λειτουργίες πρόσθετων 03 Μόλιγα funkcioner



	Hello	Ding Dong	Westminster	Marimba	Piano	Bell	Telephone	Soft Alert
	•	•					•	•
	•	•	•	•			•	•
	•	•	•	•	•	•	•	•

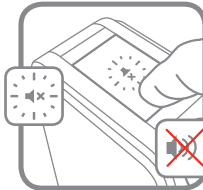
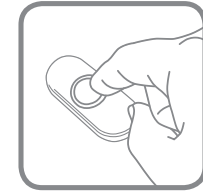
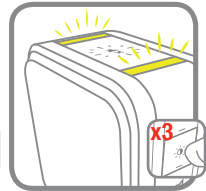
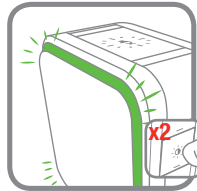
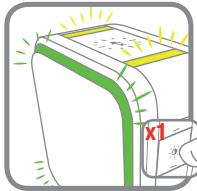
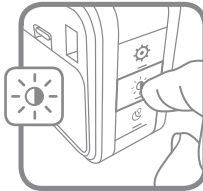

		3Hrs			6Hrs
		9Hrs			12Hrs

GB Linking 05 Einlernen 06 Programmation 07 Forbinde
 08 Verknüpfung 09 Linkittäminen 10 Forbinde
 11 Coligamento 12 Enlace
 PT Programação 06 Ουδέσση 05 Länkning

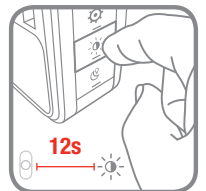
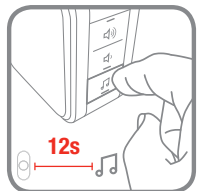
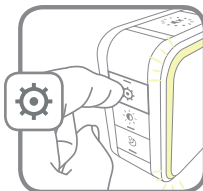

GB Trouble shooting 09 Fehlerbehebung 04 Dépannage 11 Probleemoplossing
 FI Vianmääritys 04 Problemlösning 11 Risoluzione dei problemi 12 Solución de
 problemas 07 Resolução de problemas 08 Αντιμετώπιση προβλημάτων 05 Felsökning

livewell.honeywell.com

