

57.00 mm

285.00 mm

95.00 mm

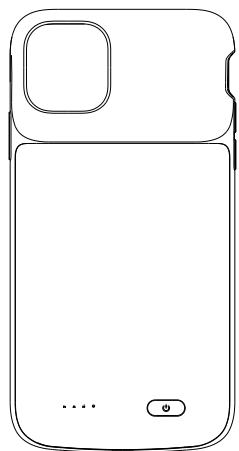

For iPhone Series
背夹电池说明书

产品图解

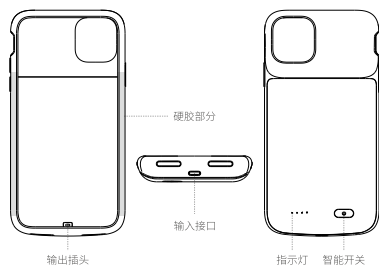

充电说明

将手机数据线 with 背夹电池连接好,即可对背夹充电.充电时四个白色的LED灯闪烁表示背夹电池的相对电量,充电时白灯长亮表示背夹电池已充满。

将手机按要求装入背夹电池中,长按智能开关3秒即为手机充电,再长按智能开关3秒可停止对手机充电。

注意



带此标识支持同时充电听歌。



支持数据传输功能。

安装图解

先将软胶弯曲向后翻至少45°,再将手机沿背夹水平方向插入,至完好贴合底部充电插头,将手机顶部按入背夹即完成安装。

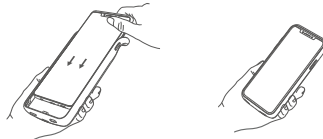

拆卸图解

左手握住背夹,将软胶向后翻至少45°,按住手机沿背夹水平方向向上取出,完成拆卸。

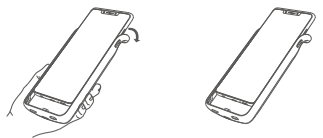

注意:背夹左右边缘中段部分为硬胶,安装/拆卸过程中需沿背夹水平方向平行滑入/滑出。

电量显示图:

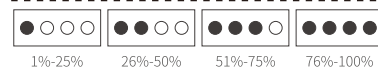

产品规格

适用: iPhone系列 | 电芯类型: A+级锂电池

包装清单

背夹电池 X1 | 使用说明书 X1

注意事项

- 1.请您在购买后,先将电池充满电后再使用。
- 2.谨防背夹电池严重坠落,磨损或其他,如有任何不正常现象请立即停止使用。
- 3.请勿把背夹电池置于潮湿的环境中,请务必保持干燥。
- 4.请勿在散热的电器装置旁使用该产品。
- 5.建议使用原装数据线给背夹电池充电,以避免不兼容等问题。
- 6.请勿拆开或更换任意配件。
- 7.由于高输出功率,充电时背夹电池表面会逐渐发热,此为正常反应。
- 8.当使用时请取下手机保护壳,然后再使用背夹。



NO: 5050563200000

For iPhone Series
背夹电池说明书



For iPhone Series
battery case user manual

Product Diagram

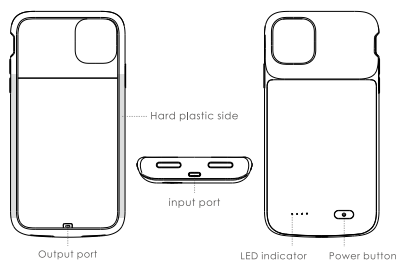

Operating Guide

Connect the lightning USB input port to USB cable with battery case, then plug the cable to power adapter for charging the battery case, when charging, the LED indicator is lighting.

Press and hold the power button for 3 seconds to activate or stop charging, the charging signal will be showed on the phone screen.

Notice



Only the audio model is compatible with original lightning headset and charging simultaneously.



Sync data with iTunes.

Installation Instruction

First bend the top soft TPU backwards, then gently slide the phone into the case until the connector perfectly fit the phone, cover the top to finish installation.

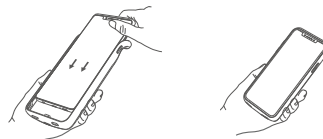

Disassembly Instruction

First bend the soft TPU backwards, then push the phone horizontally upwards to finish the disassembly.

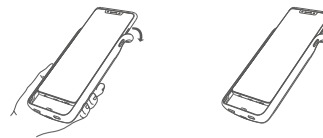

Attention: The middle side of this product both hard plastic, please assemble / disassemble your phone horizontally.

LED Indicator

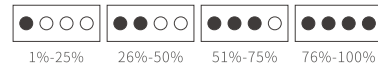

Product Specifications

Suitable for: iPhone Series | Battery Type: Grade A+Li-polymer

Package Contents

External Battery Case X1 | User Manual X1

Warnings

1. When you buy it, the battery case need to be charged fully in the first time
2. Beware of the battery case serious fall, wear, or other effects, if any unusual phenomenon, please stop using it immediately
3. Do not expose this battery case to moisture or submerge it in liquid keep battery dry all the time.
4. Do not place battery case in fire or other excessively hot environment
5. Recommend that you use phone's original data cable to connect the battery case to avoid incompatibility issues
6. Do not disassemble or replace any spare parts.
7. Due to high output power, when charging battery case, the surface of battery case will gradually become hot, this is a normal reaction.
8. Due to the battery case is ultra thin. when you use it, please remove the phone's protective case first.



For iPhone Series
battery case user manual