

INFINITY
G O O D S

10 INCH LED RING LIGHT



**USER MANUAL
HANDLEIDING**

PRODUCT NAME

10" LED Ring Light

PRODUCT DETAILS

- 1) Wattage: 12W
- 2) Outer ring size: 26CM
- 3) LED Qty: 120PCS 2835 LED Chip
- 4) CCT: 2700-7000K
- 5) RA/CRI>80
- 6) Input: DC 5V/1A(5V/2A)
- 7) Body Color: Black
- 8) Materials: ABS+PC
- 9) Certificate: CE, ROHS, FCC







SWITCH DETAILS

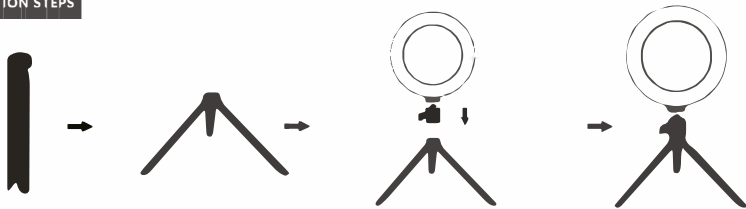

INSTALLATION STEPS



OPERATION INSTRUCTIONS

1. CONNECT TO POWER SUPPLY (10INCHES USB CONNECTOR TO MOBILE PHONE CHARGER)
- 2.THROUGH  CONTROL BUTTON TO POWER ON AND POWER OFF
- 3.THROUGH  MODE BUTTON TO CONVERT WHITE LIGHT, WARM LIGHT, NATURAL LIGHT
- 4.THROUGH   BUTTONS TO ADJUST BRIGHTNESS
- 5.PLEASE USE STANDARD USB CHARGER ,OTHERWISE IT MAY BE DAMAGE THE LAMP

PRODUCT NAAM

10" LED Ring Light

PRODUCT DETAILS

- 1) Wattage: 12W
- 2) Buitendiameter: 26CM
- 3) Aantal LED's: 120s stuks 2835 LED Chip
- 4) Kleurentemperatuur: 2700-7000K
- 5) RA/CRI>80
- 6) Ingang: DC 5V/1A(5V/2A)
- 7) Kleur: Zwart
- 8) Materialen: ABS+PC
- 9) Certificaten: CE, ROHS, FCC



SCHAKELAAR

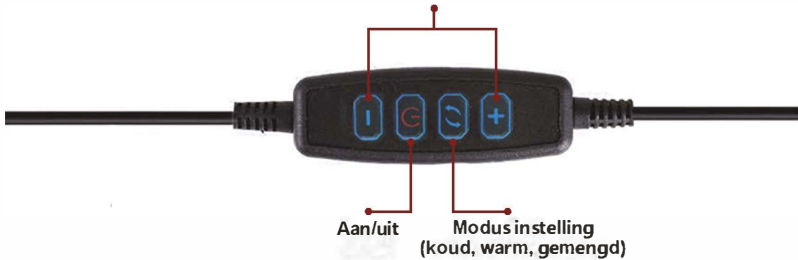

Helderheidsinstellingen: 10 niveaus

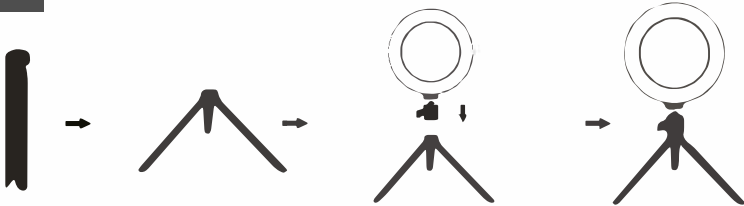

INSTALATIE



BEDIENINGSINSTRUCTIES

1. Verbind met de stroomvoorziening (10 INCH USB Connector naar mobiele telefoon oplader)
2. Gebruik de  besturingsknop om aan en uit te zetten
3. Gebruik de  modeknop om tussen wit licht, warm licht en natuurlijk licht te schakelen
4. Gebruik de  knoppen om de helderheid te veranderen
5. Gelieve een standaard USB lader te gebruiken, anders kan dit de lamp beschadigen