

# TANSEER

## Portable Espresso Maker

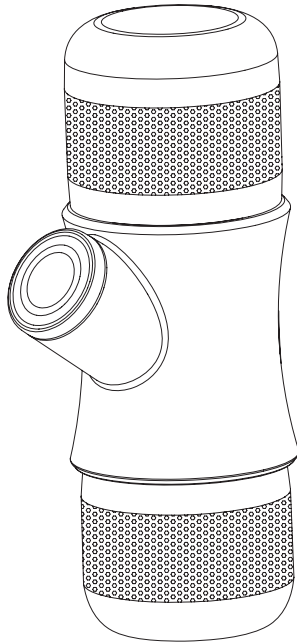

# User Manual

**Model HS-8201**

Please read all instructions carefully before operating the product and keep for future reference.

# GENERAL INSTRUCTIONS

PLEASE, TAKE TIME TO READ WELL THE INSTRUCTIONS FOR USE PARTICULARLY BEFORE THE FIRST USE.

A misuse of the appliance can damage it or hurt the user. Assure that you use the appliance for the use for which it is designed, we refuse any responsibilities as for the damages by an incorrect use or a bad manipulation.

1. The Mini portable espresso machine is intended to a personal use. It is not suitable for commercial, professional, collective or industrial use. Use of the Mini portable espresso in any manner Other than as directed herein could cause harm to persons and avoid the warranty.
2. Do not use the Mini portable espresso for other than its intended use.
3. After removing the packaging, make sure that the Mini portable espresso machine is intact.
4. The packaging elements ( gift box, plastic etc.) must not be left within reach of children as they are potential sources of danger.
5. Do not allow the Mini portable espresso machine to be used by children or persons with reduced physical, sensory or mental capabilities or lack of experience and knowledge.
6. Children must be kept under supervision to prevent them from play with the mini portable espresso machine.
7. Do not action the piston if the water tank and the outlet head are not in position.
8. Never consume liquid directly from the mini portable espresso machine as contents may be hot.
9. Do not put Mini portable espresso machine on a gas or electric hot plate, in an oven, a microwave or a dishwasher.
10. Only use clean water in the Mini portable espresso machine. Do not use any other fluid.
11. Never heat up the water directly in the water tank. Water must be heated by an external heating source such as a pot or a kettle and then poured into the water tank.
12. Do not use the Mini portable espresso machine if it is showing any sign of breakdown or malfunction
13. If you burn yourself, immediately pour cold water on burnt area and call a doctor if necessary.
14. Please clean the product carefully each time after using.

# DESCRIPTION

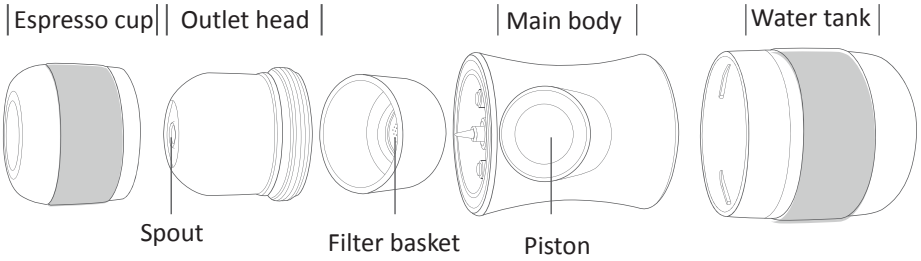

# INSTRUCTIONS

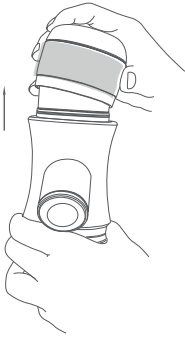

①

Unclips the cup

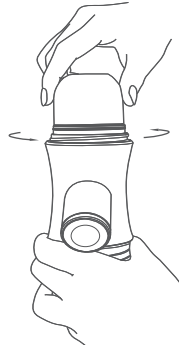

②

Unscrew the outlet head

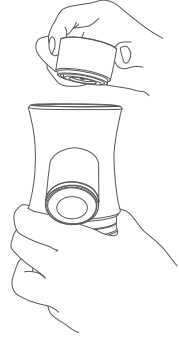

③

Remove the filter basket

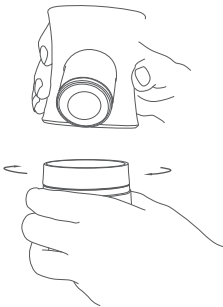

④

Unscrew the water tank.



⑤

Remove the scoop from the water tank.



⑥

Fill the scoop with ground coffee.

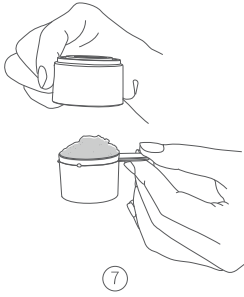

Position the filter basket on the top of the scoop.

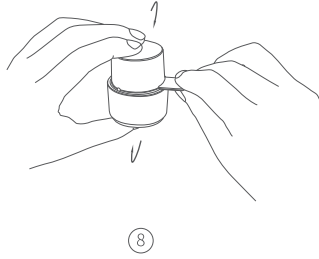

Reverse to transfer all the powder into the filter basket.



Put back the filter basket on the top of the main body. Clean up if any coffee remain on the edge of the filter basket.

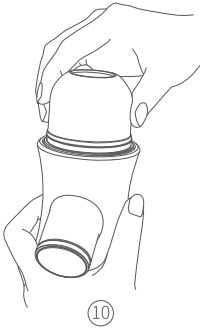

Screw tightly the outlet head into the main body until the stop

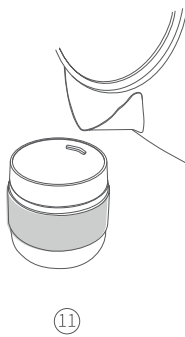

Add boiling water into the water tank. Stop pouring before reaching the step.



Screw tightly the main body onto the water tank until the stop.

 Place water tank on level and stable surface in order to fill it.

 Avoid burning yourself. Handle with care.



13

Unlock the piston from its travel position by rotating it to the left.

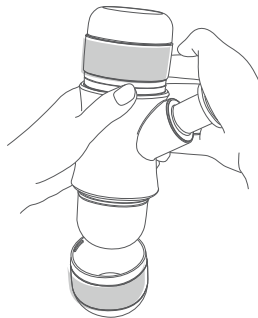

14

Bring the Mini Portable Espresso Machine above the cup and start pumping.

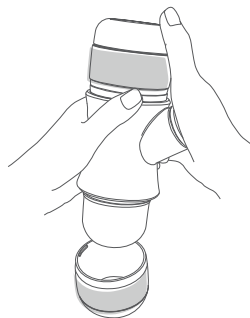

15

The first 6 strokes will fill the filter basket of water. Continue pumping until no more coffee comes out.

## TIPS

- . Different tastes of practice
- . Press 10 times: Ristretto
- . Press 15 times: Espresso
- . Press 25 times: Double Espresso
- . Water + Espresso = Americano
- . Milk + Chocolates + Espresso = Mocha

## NOTE

For best results, we highly suggest you to:

- . Use fresh roasted coffee beans and filtered water.
- . Grind coffee beans just prior to prepare your espresso shot.
- . Gently tamp the ground coffee into the filter basket with the back of the scoop

## WARNING

- . Avoid burning yourself, handle hot water with care.
- . Do not apply higher than usual force on the piston if this one is stuck.
- . High pressure may cause damage.
- . Do not fill to the rim the filter basket with tamped ground coffee,
- . Only use one scoop of ground coffee (7 grams) to fill the filter basket.

# CLEANING AND STORAGE

Clean the hatched areas under running water to remove all remain coffee. For all others areas, we highly recommend to only use a humid soft cloth when cleaning.

## WARNING

- Do not put water into the orange area.
- Do not put any Mini Portable Espresso Machine Part into dishwasher.

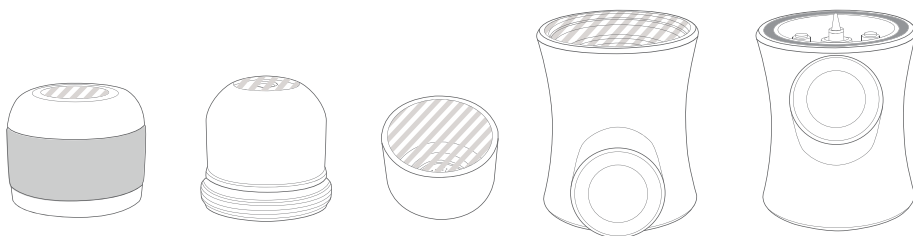

## DISPOSAL

The Mini Portable Espresso Machine has been manufactured using high quality materials that can be reused or recycled.

Dispose of the appliance in a suitable waste collection center.

