

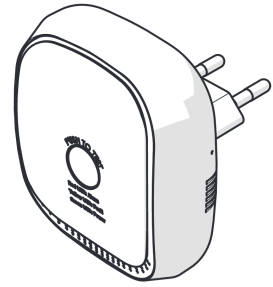

# Zigbee gas detector

Article number: ZBDG11WT



CE Nedis BV  
De Tweeling 28, 5215 MC 's-Hertogenbosch, The Netherlands 06/22

## Preface

Thank you for purchasing the Nedis ZBDG11WT.

This document is the user manual and contains all the information for correct, efficient and safe use of the product.

This user manual is addressed to the end user. Read this information carefully before installing or using the product.

- Always store this information with the product for use in the future.

- 
- 

## Product description

- 
- 

## Intended use

- This product is intended to detect gas build-up in residential environments.

The alarm goes off when the gas density exceeds the alarm level.

The product is intended for indoor use only.

Any modification of the product may have consequences for safety, warranty and proper functioning.

## Specifications

<b>Product</b>	Zigbee gas detector
<b>Article number</b>	ZBDG11WT

<b>weight</b>	92 g
<b>Input power</b>	100 - 240 VAC ; 50 / 60 Hz
<b>Fuse rating</b>	Non-replaceable
<b>Power consumption</b>	1.5 W
<b>Sensor lifespan</b>	Up to 5 years
<b>Alarm volume</b>	70 dB/m
<b>Alarm output</b>	Visual and audible indication
<b>Alarm gas density</b>	6% LEL $\pm$ 3% LEL (natural gas)
<b>Operating temperature</b>	-10 °C - 50 °C
<b>Operating humidity</b>	Maximum 95 % RH
<input type="radio"/> <b>Wireless technology</b>	Zigbee
<input type="radio"/> <b>Zigbee transmission distance</b>	100 m
<input type="radio"/> <b>FM frequency range</b>	2400 - 2485 MHz
<input type="radio"/> <b>Maximum transmission power</b>	13 dBm
<input type="radio"/>	

Main parts (image **A**)

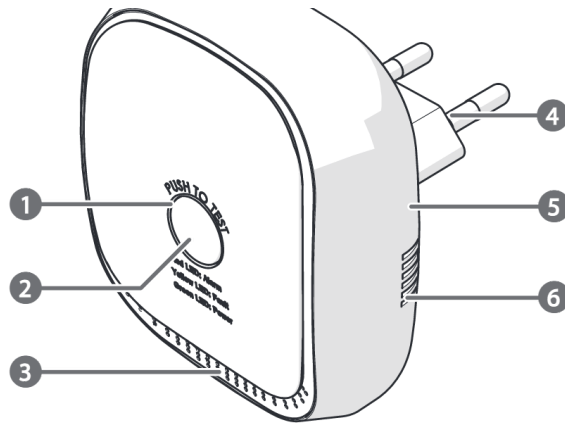

## A

① LED indicator

② Test button

③ Air inlet

④ Power plug

⑤ Pairing button

⑥ Buzzer

## Safety instructions

### ⚠ WARNING

- Ensure you have fully read and understood the instructions in this document before you install or use the product. Keep the packaging and this document for future reference.
- Only use the product as described in this document.
- Do not use the product if a part is damaged or defective. Replace a damaged or defective product immediately.
- Do not drop the product and avoid bumping.
- This product may only be serviced by a qualified technician for maintenance to reduce the risk of electric shock.
- Do not expose the product to water or moisture.
- Test the product once every month to ensure the product still functions.

- Do not use this product in a dusty or smoky ambience.
- Some wireless products may interfere with implantable medical devices and other medical equipment, such as pacemakers, cochlear implants and hearing aids. Consult the manufacturer of your medical equipment for more information.
- Do not use the product at locations where the use of wireless devices is prohibited due to potential interference with other electronic devices, which may cause safety hazards.
- The product is intended for use in household environments for typical housekeeping functions. The product is not suitable for commercial or industrial applications nor for use on recreational or commercial vehicles.
- The installation of the product should not be used as a substitute for proper installation, use and maintenance of fuel fired facilities, including appropriate ventilation and exhaust systems.
- Make sure that the product is powered continuously for maximum safety. An interruption from the power source could cause a spark that could cause ignition.
- Be aware that gas can be smelled before the alarm goes off.
- Always check your home and appliances for potential problems after an alarm.
- Consult a qualified appliance technician to check your appliances if the alarm reactivates within 24 hours.
- Always notify the manufacturer if a problem with an appliance is identified.
- Never ignore an alarm.

---

## Installation

---

### Check the contents of the package

Check that all parts are present and that no damage is visible on the parts. If parts are missing or damaged, contact the Nedis B.V. service desk via the website: [www.nedis.com](http://www.nedis.com).

---

### Choosing a location (image B)

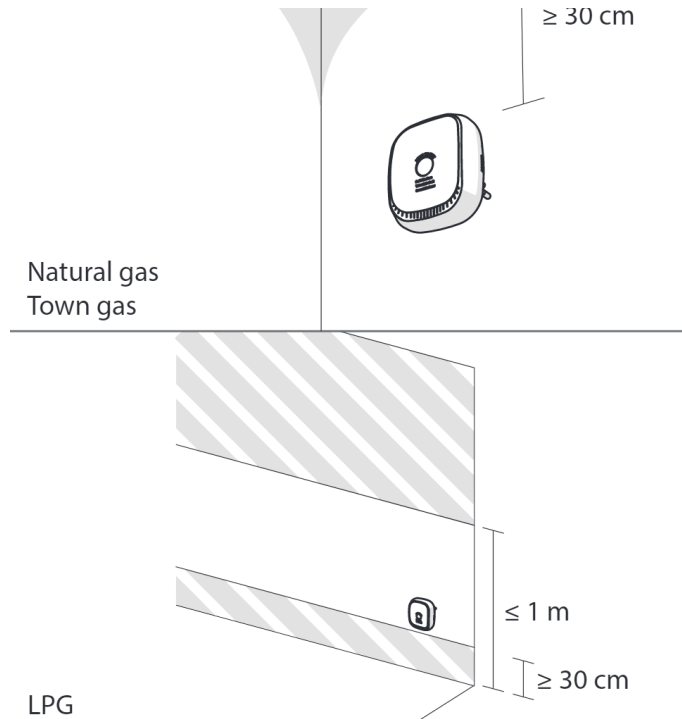
**B**

- i** Make sure the gas installation is in accordance with national regulations.
- For safe use, it is recommended to install the product in the following locations:
  - Every room with devices that are connected to gas.
- i** If this is not possible, install the product in room where gas is most likely to escape, e.g. the kitchen.
- 
- 
- In areas with natural gas or town gas:
  - Above the level of a possible gas leak.
  - Above the level of the highest window or door opening.
  - At least 30 cm from the ceiling.
  - Within 1.5 m from the gas source.

In areas with LPG:

- At least 30 cm above the floor.
- At most 1 m above the floor.
- Within 1.5 m from the gas source.
- Away from exits.

Do not install the product:

- behind objects like curtains or closets.
- in temperatures below -10 °C.

- in damp or humid areas.
- directly above a sink.

To prevent unwanted alarms, do not install the product:

- directly above or next to devices that are connected to gas.
- near cooking devices.
- ❗ Unwanted alarms may be caused by cooking vapours and small gas releases before ignition. The product is not malfunctioning.
- ⚠ Grease contamination may impede the sensitivity of the product.

## Installing the product

1. Plug the product into a power outlet.
2. Wait 3 minutes to allow the product to warm up.
- ❗ Do not press the test button **A2** during warm up.
- ❗ The LED indicator **A1** lights up green when warm up is finished.

## Installing the Nedis SmartLife app

1. Download the Nedis Smartlife app for Android or iOS on your phone via Google Play or the Apple App Store.
2. Open the Nedis Smartlife app on your phone.
3. Create an account with your mobile phone number or your e-mail address and tap **Continue**.
4. You will receive a verification code on your mobile phone or e-mail address.
5. Enter the received verification code.
6. Create a password and tap **Done**.
7. Tap **Add Home** to create a SmartLife Home.
8. Set your location, choose the rooms you want to connect with and tap **Done**.

## Adding a product to the Nedis SmartLife app (image C)

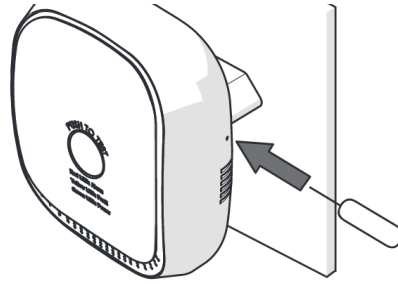

## C

1. Make sure the LED indicator **A1** is burning green.
2. Press and hold the pairing button **A5** with a pin (not included) for 2 seconds.
- i** **A1** Blinks green.
3. Tap + in the Nedis SmartLife app.
4. Select the product type you want to add from the list.
5. Follow the instructions in the Nedis SmartLife app.
6. The alarm and battery status are shown in the Nedis SmartLife app.
7. Press the test button **A2** to test the connection. The alarm goes off notification is shown in the Nedis SmartLife app.

## Use

### When the alarm goes off

- When the alarm goes off:
  - Extinguish all open flames.
  - Extinguish all smoking materials.
  - Switch off all gas appliances.
  - Switch off the gas supply at the gas main control and/or the storage tank.
  - Open doors and windows.
  - ⚠ Never ignore an alarm.
  - ⚠ Do not use a telephone in the building where the alarm goes off.
  - ⚠ Do not switch any electrical devices (including gas detectors) on or off.

When the alarm stops or is reset and the reason for the alarm is identified:

1. Check if the combustible gas concentrations are low enough to safely enter the building.
2. Enter the building with care.

detected and fixed.

4. Make sure all devices are switched off.
5. Switch on the gas supply at the gas main control and/or the storage tank.



The product status is indicated through the LED indicator **A1**. An overview of the different statuses and indications is shown in the table below.

Mode	LED indicator	Sound alarm	Information
Power up and warm up mode	The LED indicator <b>A1</b> blinks green, red and yellow alternately.	Off	Check installation to power the product. Warm up lasts approximately 3 minutes.
Standby mode	<b>A1</b> lights up green.	Off	After warm up, the product will activate standby automatically.
Test	The LED indicator <b>A1</b> blinks green, red and yellow alternately.	Two beeps continuously.	Press and release <b>A2</b> to test the product.
Alarm	The LED indicator <b>A1</b> blinks red.	Two beeps continuously.	Presence of a high concentration of gas.
Malfunction	The LED indicator <b>A1</b> lights up yellow.	One long beep	The product is malfunctioning. Contact Nedis.

## Maintenance

- Vacuum the product once a month to remove dust.



- Do not use aggressive chemical cleaning agents such as ammonia, acid or acetone when cleaning the product.
- Do not clean the inside of the product.
-  Do not use aerosols (air fresheners, hair spray, paint) near the product.
-  Do not paint the product.

---

## Warranty

Any changes and/or modifications to the product will void the warranty. We accept no liability for damage caused by improper use of the product.

This product is designed for private use (normal domestic use) only. Nedis is not responsible for wear, defect and/or damages caused by commercial use of the product.

---

## Disclaimer

- Designs and specifications are subject to change without notice. All logos, brands and product names are trademarks or registered trademarks of their respective owners and are hereby recognized as such.
- 
- 

---

## Disposal



This symbol indicates that this product should not be thrown away with other household waste throughout the EU. To prevent possible harm to the environment or human health by uncontrolled waste disposal, you are responsible for recycling it so that it can promote the sustainable reuse of raw materials. To return your used product, you can use the regular return and collection systems or contact the store where the product was purchased. They can recycle this product for the environment.

---

## Declaration of Conformity

We, Nedis B.V. declare as manufacturer that the product ZBDG11WT from our brand Nedis®, produced in China, has been tested according to all relevant CE standards and

The complete Declaration of Conformity (and the safety datasheet if applicable) can be found and downloaded via:

<https://support.nedis.com/ZBDG11WT>

- 
- 
- 
- 
- 
- 
- 
- 
- 
- 
-