

First of all thank you for using our smart projector! Please read this manual carefully before using so it will help you to quickly be familiar with this product.

In case of any printing or translation error, we apologize for the inconvenience. As for the content change, we are sorry for no further notice.

CONTENTS

- Interface/Buton Diagram 1
- Remote Control 3
- Language Setting 3
- Power on/Power off 4
- Sharpness 4
- Home 5
- App Center 5
- Settings 6
- Wi-Fi Setting 6
- Hotspot Setting 7
- Bluetooth Setting 8
- Screen Share 9
- File Browser 10
- APP Install/Uninstall 11
- Factory data reset 12
- Notes 12

1. Interface/Button Diagram

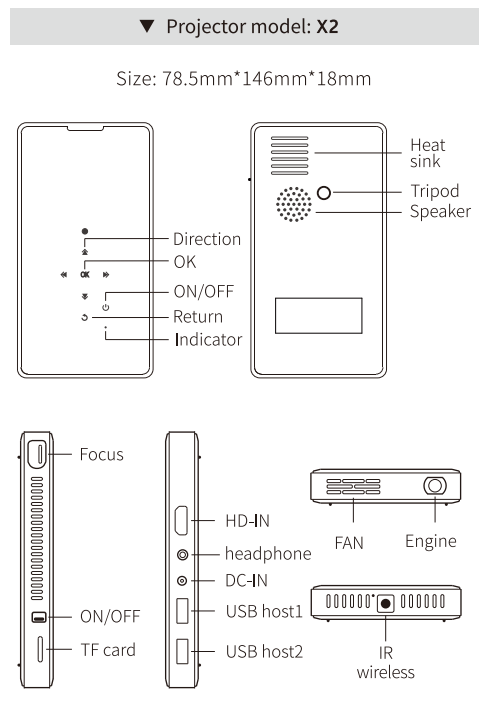

1

2. Remote Control

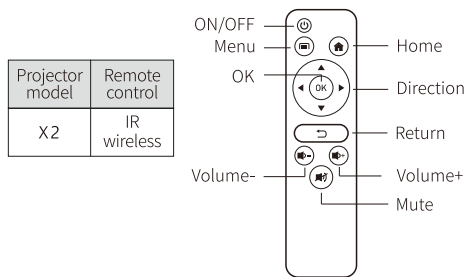

3. Language Setting

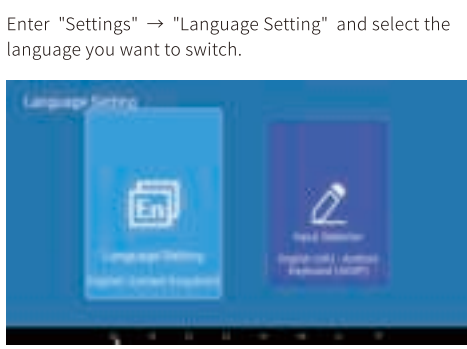

2

4. Power on/Power off

▼ Projector model: X2

- Power on: Switch down the [ON/OFF] on the left side of the projector and wait for the screen to display.
- Power off: Switch down the [ON/OFF] on the right side of the projector, the interface of shutdown will pop up, click "OK" to shut down, after the projector stops running, please switch the [ON/OFF] up to the top, otherwise the battery will still be in a power-consuming state.

5. Sharpness

Turn the focus gear on the left side of the projector to adjust the picture sharpness.

3

6. Home



7. App Center



4

8. Settings



9. Wi-Fi Setting

Enter "Settings"→"Networking Setting"→"Wi-Fi Setting", click the switch to "ON" state, select the network which you want to connect, enter the password and click "Link".



5

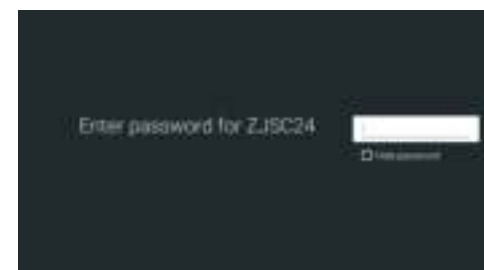

10. Hotspot Setting

Enter "Settings" → "Networking Setting" → "Hotspot Setting", click the switch to "ON" state, you can set the parameters , click "OK", and then the projector's hotspot can be searched by other devices to share the network.



6



11. Bluetooth Setting

Enter "Settings" → "Bluetooth Setting", click the switch to the "ON" state, search for the device which you want to connect, pairing.



7

12. Screen Share

Method one: need to download the APP (recommended for iPhone/iPad/Windows/Android)

- The phone and the projector are connected to the same network, or in the absence of a network, the phone is connected to the hotspot of the projector. (Details of the hotspot setting method, see 10.)
- Enter the APP "EShareServer" on the projector and follow the steps of the screen.

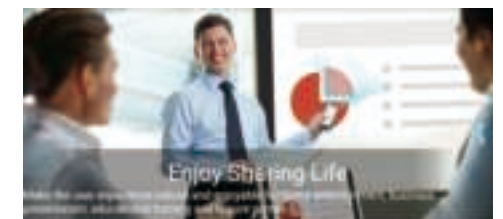

Method two: no need to download the APP

- Miracast(for Android system):
 - The phone and the projector are connected to the same network.
 - Enter the APP "Miracast" on the projector.
 - Enter "Settings" → "More" → "Wireless Display" on the phone, and click the name of the device to match.

8

② airplay(for iOS system):

- The phone and the projector are connected to the same network, or in the absence of a network, the phone is connected to the hotspot of the projector. (Details of the hotspot setting method, see 10.)
- Enter the APP "airplay" on the projector .
- Open the "Screen Mirroring" on the iPhone/iPad, and click the name of the device to match.

13. File Browser

- Read: Insert the U disk/TF card, enter the "File Browser".
- Edit: Select the menu icon , tick the file you want to operate , deselect the menu icon , select the options you want to operate in the edit icon directory .
- If "Cut" or "Copy" is selected, you need to first select the directory, and then click the edit icon to select "Paste".



9

14. APP Install/Uninstall

① APP Install: If the APK Downloaded, enter the "App Center" → "AppInstaller", find the location of the APK, click and install it; If the APK is not downloaded , you can download and install it in the "Google Play".



② APP Uninstall: Enter "Settings" → "Other Setting" → "Apps", click the App that needs to be uninstalled.

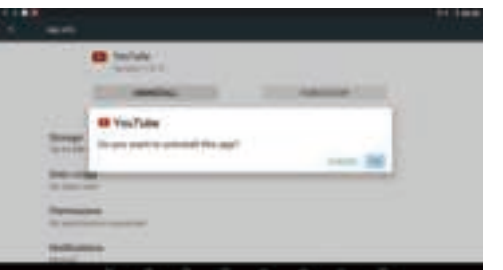

10

15. Factory data reset

Enter "Settings" → "Other Setting" → "Backup & reset" → "Factory data reset" → "RESET MBX" .



16. Notes

- Make sure to use a standard power adapter. Other adapters may cause serious damage to the projector.
- Please keep the lens clean, dirt or scratches will affect the projection effect.
- Before you clean the projector, disconnect the power supply, clean it with a clean cotton wool or soft cloth, and then wipe off the residual moisture with a dry cloth.
- Do not place or drop hard objects on the projector.
- Do not place the projector on your legs or any part of your body to prevent injury from the heat.
- Avoid using the projector during weather of high humidity or thunderstorms.

11

12

4