

NUTRI NINJA®

Slim

QB3001UK series
OWNER'S GUIDE



IMPORTANT SAFETY INSTRUCTIONS

For Household Use Only

WHEN USING ELECTRICAL APPLIANCES, BASIC SAFETY PRECAUTIONS SHOULD ALWAYS BE FOLLOWED, INCLUDING THE FOLLOWING:

READ ALL INSTRUCTIONS BEFORE USING YOUR NUTRI NINJA® SLIM.

WARNING:

The blades are not affixed to the unit. They are removable and very sharp. Handle with care!

CAUTION:

In order to avoid a hazard due to inadvertent resetting of the thermal cut-out, this appliance must not be supplied through an external switching device, such as a timer, or connected to a circuit that is regularly switched on and off by the utility.

IMPORTANT:

This appliance is not intended for use by persons with reduced physical, sensory or mental capabilities, or lack of experience and knowledge, unless they have been given supervision or instruction concerning use of the appliance by a person responsible for their safety.

Children shall not use or play with this appliance. Close supervision is necessary to keep appliance and cord out of reach of children during use.

WARNING:

TO REDUCE THE RISK OF FIRE, ELECTRIC SHOCK OR INJURY:

- 1 To protect against electrical shock, **DO NOT** submerge the appliance or allow the power cord to come into contact with water or any other liquid.
- 2 **DO NOT** allow children to operate the appliance or use as a toy. Close supervision is necessary when any appliance is used near children.
- 3 Never leave an appliance unattended when in use.
- 4 Turn the appliance off and remove the power cord from the electrical outlet when not in use, before assembling or disassembling parts, accessing parts that move while in use and before cleaning. To unplug, grasp the plug and pull from the electrical outlet. Never pull from the power cord.
- 5 **DO NOT** abuse the power cord. Never carry the appliance by the power cord or yank it to disconnect from electrical outlet; instead, grasp the plug and pull to disconnect.
- 6 **DO NOT** use with damaged cord or plug.
- 7 **DO NOT USE** if the appliance is not working, has been dropped, dropped into water, damaged or left outdoors.
- 8 **NO SERVICEABLE PARTS.** Incorrect re-assembly or repair can cause a risk of electrical shock or injury to persons when the appliance is used. Contact Customer Service.
- 9 If the supply cord is damaged, it must be replaced by the manufacturer, its service agent or similarly qualified persons in order to avoid a hazard.
- 10 **DO NOT** let the power cord hang over the edge of table or counter or touch hot surfaces such as the stove.

- 11 Always use the appliance on a dry, level surface.
 - 12 Keep hands, hair, clothing, as well as utensils out of container while processing or blending to reduce the risk of severe injury to persons or damage to the appliance. A scraper may be used but only when the appliance is not running.
 - 13 **CAUTION: The blades are not affixed to the unit. They are removable and extremely sharp. When handling the blades, do not hold the blades but rather always hold by the base of the blade assembly. Blades are sharp. Handle carefully!**
 - 14 Avoid contact with moving parts.
 - 15 **DO NOT** remove the Power Pod before the blades have stopped turning.
 - 16 **DO NOT** attempt to sharpen blades.
 - 17 **DO NOT** use the appliance if the blades are bent or damaged.
 - 18 **DO NOT** block the vents on the Power Pod when using the appliance.
 - 19 **DO NOT** operate this appliance on or near any hot surfaces (such as gas or electric burner or in a heated oven).
 - 20 The use of attachments or accessories including canning jars, not recommended by the manufacturer may result in fire, electric shock or personal injury.
 - 21 To avoid injury, never attempt to place the single serve blade assembly onto the Power Pod without first assembling the blade assembly to the Nutri Ninja cup.
 - 22 When using the blades, make sure they are properly installed before operating the appliance.
 - 23 **CAUTION: DO NOT PROCESS HOT FOODS OR HOT LIQUIDS.** Allow hot ingredients to cool before processing.
 - 24 Extreme caution must be used when moving an appliance containing hot food, water or other liquids.
 - 25 **DO NOT** expose containers to extreme temperature changes.
 - 26 **DO NOT** overfill. **DO NOT** exceed max fill line.
 - 27 **DO NOT** operate the appliance empty.
 - 28 To reduce the risk of burns, always allow the appliance to cool before taking off parts and before cleaning.
 - 29 Max ON time is 30 seconds under 700W load. If the appliance overheats, a thermal switch will become activated and shut off the motor. To reset, unplug the appliance and let it cool down for approximately 15 minutes before using again.
 - 30 **THIS PRODUCT IS INTENDED FOR HOUSEHOLD USE ONLY.** Do not use this appliance for anything other than its intended use. Do not use outdoors.
- ⚠ WARNING:** Extension cords are not recommended for use with this product.

SAVE THESE INSTRUCTIONS

This appliance complies with the WEEE-Directive 2012/19/EU on the disposal of electrical and electronic equipment (WEEE).



This marking indicates that this product should not be disposed with other household wastes throughout the EU. To prevent possible harm to the environment or human health from uncontrolled waste disposal, recycle it responsibly to promote the sustainable reuse of material sources. To return your used device, please use the return and collection systems or contact the retailer where this product was purchased. They can take this product for environmental safe recycling.

This appliance complies with the European directives for electromagnetic compatibility (EMC) 2014/30/EU and its revisions, as well as Low Voltage Directive (LVD) 2014/35/EU and its revisions.

Guarantee: This product is unconditionally guaranteed for one year against all defects of workmanship and materials. This guarantee does not affect your statutory rights. If this product proves unsatisfactory please contact our customer service department on freephone 0800 862 0453 or by e-mail ukservice@euro-pro.com.

THIS BOOK COVERS MODEL NUMBERS:

QB3001UK 30

QB3001UKMK 30

QB3001UKMR 30

TECHNICAL SPECIFICATIONS

Voltage: 220-240V~, 50/60hz

Power: 700 Watts

Single Serve Capacity: 470 ml



Contents

**Thank you for
purchasing the
Nutri Ninja® Slim.**

Getting to know your Nutri Ninja Slim	6
Using the Nutri Ninja Slim	7
Using the Nutri Ninja Slim Cup	8
Cleaning and Maintenance	9
Troubleshooting Guide.....	10

The Nutri Ninja® Slim is an indispensable kitchen tool that is perfect for blending, chopping, mixing or pureeing when preparing your favourite recipes. For best results, be sure to carefully read all the instructions contained in the manual before using this appliance.



FEATURES:

- Interchangeable “Slim” Power Pod that flips for different meal-making functions.
- Single Serve Blending in 470 ml Nutri Ninja Cups.
- BPA Free Nutri Ninja Cups and Sip & Seal® Lids.
- Hidden Drain Holes - prevent water retention from dishwasher.

Getting To Know Your Nutri Ninja® Slim

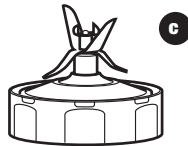

- a Power Pod
- b 470 ml Nutri Ninja Cup (x2)
- c Nutri Ninja Blade Assembly
- d Sip & Seal® Lid (x2)

NOTE: Blades are **not** interchangeable.

PLEASE KEEP THESE IMPORTANT SAFEGUARDS IN MIND WHEN USING THE APPLIANCE:

- ⚠ WARNING:** Never leave the appliance unattended while in use.
- ⚠ CAUTION:** DO NOT PROCESS HOT FOODS OR HOT LIQUIDS.
- ⚠ IMPORTANT:** DO NOT attempt to operate the appliance without the lid on.
- ⚠ IMPORTANT:** Never run the appliance empty.

BEFORE FIRST USE

- 1 Remove all packaging material and labels from the appliance.
- 2 Wash the Sip & Seal® lids, Nutri Ninja® cups and Nutri Ninja Blade Assembly in warm, soapy water with a soft cloth.
- ⚠ CAUTION:** Handle the Nutri Ninja Blade Assembly with care when washing as the blades are very sharp.
- 3 Rinse and dry thoroughly.
- 4 The Power Pod is **NOT** dishwasher safe. Do not submerge in water.
- 5 The Sip & Seal lids, Nutri Ninja cups and Nutri Ninja Blade Assembly are all dishwasher safe. It is recommended that the Sip & Seal lids and Nutri Ninja Blade Assembly be placed on the top rack. Ensure that the blades are removed from the containers before placing in the dishwasher.
- 6 Wipe the Power Pod clean with a damp cloth and wipe dry.

Using the Nutri Ninja® Slim Cup

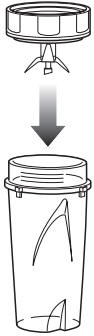

Fig. 1

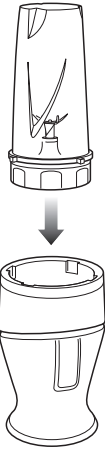

Fig. 2

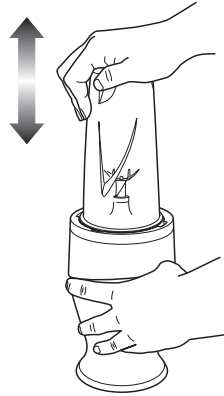

Fig. 3

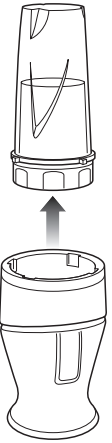

Fig. 4

▲ IMPORTANT: Make sure that the Power Pod is plugged in for use.

- 1 Place the Power Pod upside down on a clean, dry, level surface such as a counter or table top.
- 2 Add ingredients to the single serve cup.
NOTE: Do not overfill! To avoid spilling, do not add ingredients past the "Max" fill line.
- 3 Place the single serve blade onto the cup and screw it tightly until a good seal is achieved. **(Fig. 1)**
- 4 Turn the Nutri Ninja cup upside down and place it onto the Power Pod. Press down on the single serve cup to pulse or blend. **(Fig. 2, Fig. 3)**

- 5 Once desired consistency is reached, remove pressure from single serve cup. Pull straight up to remove. **(Fig. 4)**
- 6 Turn the cup upright and remove the single serve blade by twisting the Nutri Ninja Blade Assembly anticlockwise.
- 7 Place the Sip & Seal® drinking lid onto the single serve drink cup, twist to seal and enjoy!
- 8 Make sure that the Power Pod is unplugged when not in use.

NOTE: To order additional Nutri Ninja Cups, please visit our website: www.ninjakitchen.eu or feel free to contact customer service: **0800 862 0453**

Cleaning and Maintenance

HOW TO CLEAN

- ⚠ CAUTION: Make sure that the Power Pod is unplugged from the power source before inserting or removing any attachment and before cleaning.**
 - ⚠ CAUTION: DO NOT immerse the Power Pod in water or any other liquid.**
 - ⚠ CAUTION: Use caution when handling the Nutri Ninja® Blade Assembly as the blades are very sharp.**
- 1 Separate all parts from each other.
 - 2 Clean the Power Pod with a damp cloth and wipe dry.
 - 3 Place Nutri Ninja cups, Sip & Seal® lids, and the Nutri Ninja Blade Assembly on the top rack of the dishwasher.

OR

- 4 Carefully hand wash the lids, cups, and Nutri Ninja Blade Assembly in warm, soapy water with a soft cloth.
- If the appliance needs servicing, please call customer service at 0800 862 0453.

HOW TO STORE

- 1 Secure the power cord by wrapping the cord around the Power Pod. Store the rest of the components in a safe place where they will not be damaged and will not cause a hazard.

RESETTING THE MOTOR THERMOSTAT

The **Nutri Ninja Slim** features a unique safety system which prevents damage to the unit's motor and drive system should it be inadvertently overloaded. If the appliance is being overloaded, the motor will stop. To reset the appliance, follow the resetting procedure below:

- 1 Unplug the appliance from the electrical outlet.
- 2 Remove the cup from the Power Pod, empty the container and ensure that no food is jamming the Nutri Ninja Blade Assembly.
- 3 Allow the appliance to cool for approximately 15 minutes.
- 4 Refill the cup, place the cup in the Power Pod, and re-plug the appliance into the electrical outlet.
- 5 Proceed to use the appliance while making sure not to exceed the recommended maximum capacities.

Troubleshooting Guide

PROBLEMS	POSSIBLE REASONS & SOLUTIONS
Motor doesn't start or blades don't rotate.	<ul style="list-style-type: none">• Make sure the Nutri Ninja® cup is securely placed onto Power Pod.• Check that the plug is securely inserted into the electrical outlet.• Check fuse or breaker in your home. Replace fuse/reset breaker.• Check that the inside of the Power Pod is clean and there is no food blocking the connection between Power Pod and Nutri Ninja cup.• There is too much food in the container. Unplug the Power Pod. Remove some food and try again.• The unit has overheated. Unplug and wait approximately 15 minutes before using again.
Food is unevenly chopped.	<ul style="list-style-type: none">• Either too much food is being chopped at one time, or the pieces are not small enough. Try cutting the food into smaller pieces of even size and processing smaller amounts per batch.• Adjust pulse duration or pulse time.
Food is chopped too finely or is too watery.	<ul style="list-style-type: none">• The food has been overprocessed. Use brief pulses or process for a shorter time. Let blades stop completely between pulses.
Food collects on the sides of the Nutri Ninja cup.	<ul style="list-style-type: none">• Too much food is being processed at one time. Turn the Power Pod off. When the blades stop rotating, remove the cup from the Power Pod. Remove some of the food being processed.
Snow from ice cannot be achieved.	<ul style="list-style-type: none">• Do not use ice that has been sitting out or has started to melt.• Be sure to use short pulses in the beginning to break up large pieces.

To purchase replacement parts, please visit our website: www.ninjakitchen.eu
or contact customer service: 0800 862 0453



Euro-Pro Europe Limited
15 Mariner Court
Calder Park
Wakefield
WF4 3FL

Freephone 0800 862 0453

www.ninjakitchen.eu

Copyright © 2016 Euro-Pro Europe Limited

Ninja, **Nutri-Ninja**, and **Sip & Seal** are registered trademarks of Euro-Pro Europe Limited.

Printed in China

Illustrations may differ from actual product. We are constantly striving to improve our products, therefore the specifications contained herein are subject to change without notice.

QB3001UK_Series_30_IB_160126_1

