

Instruction Manual

MODEL : MS220



Multi-function Foldable Handheld Steamer

Please read the user's instruction carefully before use.

ENJOY INC.

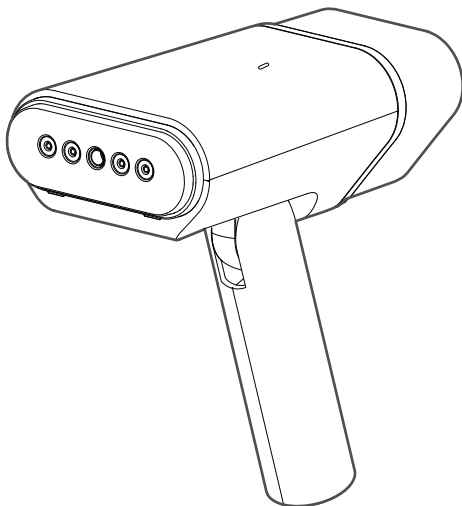

Thank you for purchasing the Foldable handheld Steamer. Please read this instruction carefully before your first use of this product.

IMPORTANT SAFE GUARDS

1. Please check your electricity supply is 220-240V before using the foldable handheld steamer.
2. Use this unit only as described in this manual. Other uses not recommended may cause burns or electric shock.
3. This unit is not a toy. Close supervision is required when using the unit near children, pets and plants.
4. Steam produced by the unit is hot. Care must be taken to avoid burns or other injuries. Never point steam nozzle at people or pets.
5. To protect against electrical shock, do not immerse unit, plug or cord in water, or spray with liquids.
6. Do not leave the unit unattended while it is in operation.
7. Always allow the unit to cool completely before refilling water, cleaning or storing.
8. Always disconnect the unit from electrical outlet when filling or disposing water as well as the reservoir is empty or the unit not being used.
9. No detergent or chemicals can be added into the reservoir or it will cause damage. Only water is allowed to use.
10. To disconnect, grasp the plug and pull it from the wall outlet. Never drag the cord.
11. Steam nozzle and accessory become hot during use. To avoid injuries, do not touch nozzle while using this unit. Do not attempt to remove accessory while unit is emitting steam.
12. After refilling, close the sealing cap and fill with pure water.
13. When the water in reservoir is finished, the pump is still working and this is normal, please switch off the unit and disconnect from power outlet. .
14. To reduce the risk of contact with hot water emitting from steam vents, hold the unit away from human being or pets.
15. This appliance is not intended for use by persons (including children) with reduced physical, sensory or mental capabilities, or lack of experience and knowledge, unless they have been given supervision or instruction concerning use of the appliances by a person responsible for their safety
16. While the machine is working, do not let children play with it, in order to avoid any sudden scald.

NOTE :

To avoid danger of electric shock, unplug the unit from outlet when not in use and before cleaning. If the supply cord is damaged, it must be replaced by the manufacturer or its service agent or a similarly qualified person in order to avoid a hazard.

PARTS DIAGRAM

Front view

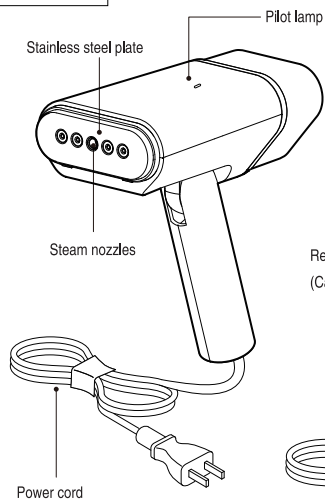

Rear view

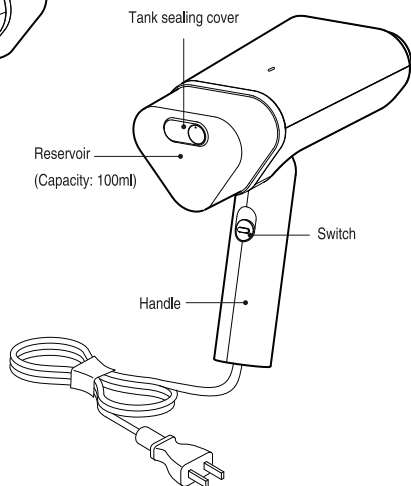

Accessories

Cloth cover holder



Cotton cover



Measuring cup



OPERATING INSTRUCTION

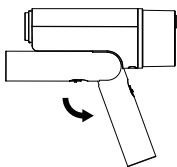

Pic .1 Fold down the handle

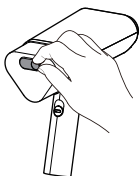

Pic .2 Unveil tank cover

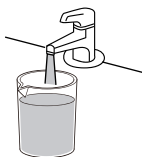

Pic .3 Filling water

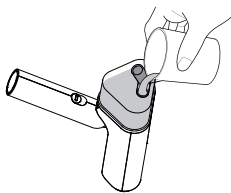

Pic .4 Filling water to the tank

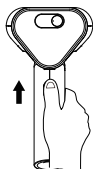

Pic .5 Switch on

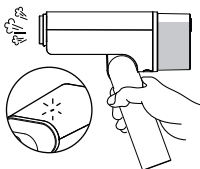

Pic .6 Ready for use

How to use

- 1.Before using, please check the voltage at home is matched with the unit at 220-240V.
- 2.Fold down the handle till hearing the "clip" sound
- 3.Unveil the tank sealing cover, filling pure water to reservoir with measuring cup.
- 4.Pull the switch to start the unit, the Indicated light will be flicker while heating up for around 25 second, and keep on while ready for continues steaming.
- 5.After finished using it, turn off the switch and unplug the power cord.

CAUTION :

- 1.Check the voltage at home is matched with the unit at 220-240V.
- 2.When water is finished in Reservoir, the Pump is still operating, and this is normal. Then the unit must be switched off or it may cause damage or accident.

BRUSH ATTACHMENT

Step 1: Cover the cotton cloth cover into the holder

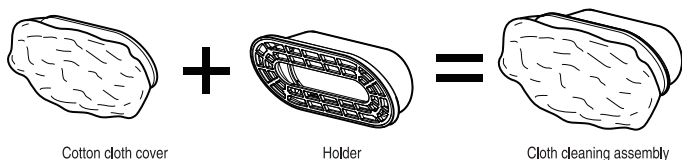

Step 2: Line up the holder into upper & lower slots of the steam nozzle plate as shown in figure.

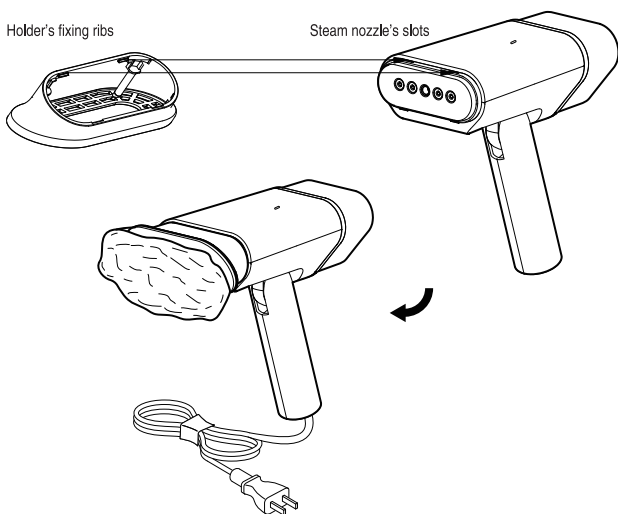

CAUTION :

1. Make sure the unit is turned off and no steam emitted from the Steam Nozzle.
2. Please cover the cotton cloth cover to the holder first and then assembly the holder to the steam nozzle appropriately and firmly.
3. Do not install the Brush Attachment on the Nozzle Plate while steam emitting.

TEAMING TIPS

Vertical Steaming

1. Hang the clothes on a hanger properly
2. Direct the Steam Nozzle towards the garment from the top to bottom part.
3. IMPORTANT: Pull the tail of the clothes slightly tight with your free hand to make the steaming effectively.

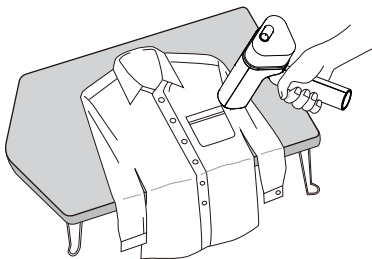
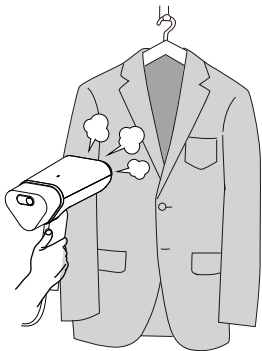

Steaming Ironing

1. Place the clothes or pants on a flat and heat resistant surface
2. Direct the Steam Nozzle plate closely on the garment and move back & forth motion.

LIGHT CLEANING

Cleaning Sofa

1. Assembly the cloth cleaning cover and holder appropriately,
2. Direct the cloth cover towards the sofa move top to bottom motion.

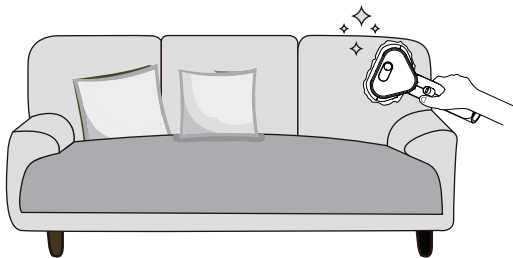

TORAGE

1. Unplug the power cord.
2. Allow the unit to cool completely
3. Empty the reservoir
4. Store the unit in a cool & dry location and away from children's access.

ROUBLE SHOOTING

Problem	Possible Reasons	Solution
Unit fails to heat up.	-Unit is not plugged in -Power Switch is not activated	-Plug into outlet with proper voltage. -Switch on to heat up. If still not work, bring it to Service Center
Power light is on , but fails to steam	-The Reservoir is empty -The unit is broken	-Refill water (refer to Operating Instruction) -Bring to Service Center for repair
When the machine is operating some slight sound & vibration observed	-This steamer operates with Pump-system design, sound is vibration is thus observed -The steamer is operating without water, large sound is observed	-This is normal as resulted from the working pump -Please switch off the machine -Refill water and switch on the unit again

SPECIFICATIONS

Voltage : 220-240V~ 50/60Hz
Wattage : 900W
Capacity : 100ml

ENJOY INC.