

Verbind je favorieten apparaten

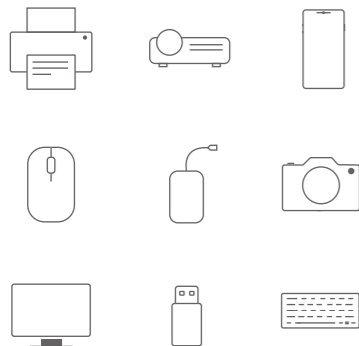

Aan de slag

1. Sluit de hub aan op de zijkant van je MacBook.
2. Wanneer het lampje brand zijn alle poorten beschikbaar.
3. Je kunt nu elke gewenste kabel of apparaat succesvol aansluiten.

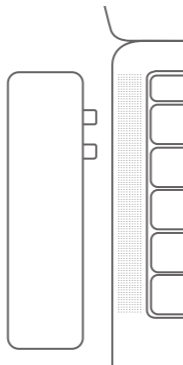

Externe monitor instellen

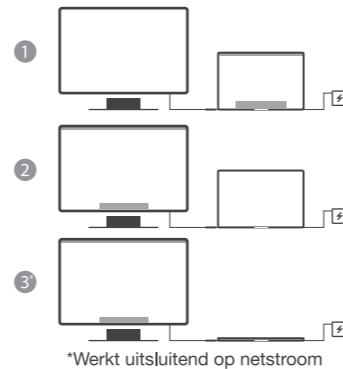

1. Ga naar en klik op **'Systeemvoorkeuren'**
2. voor **'Rangschikking'**
3. Rangschik de beeldschermen door deze naar de gewenste positie te slepen
4. Sleep de menubalk naar het gewenste beeldscherm
5. Voor synchrone weergave, klik op **'Schakel synchrone weergave in'**

Specificaties

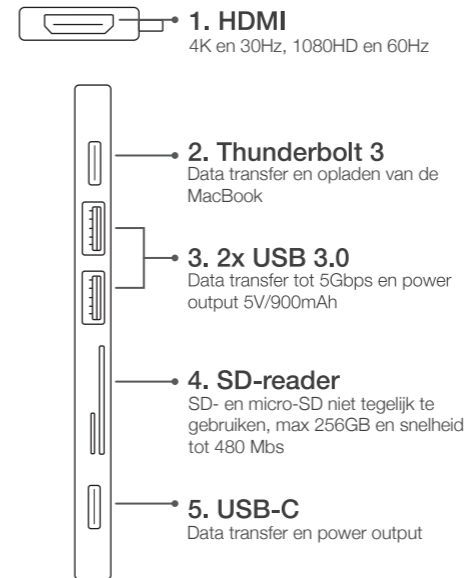

iMounts | Macbook hub

Connect your favorite devices

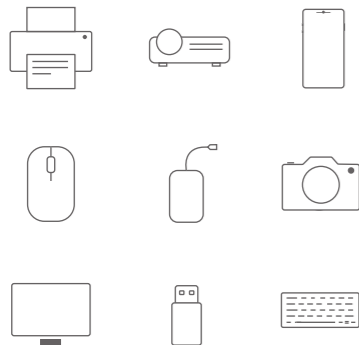

How it works

1. Connect the hub to the side of your MacBook
2. When the light turns blue, the hub is ready to use
3. Connect your cables or your favorite devices

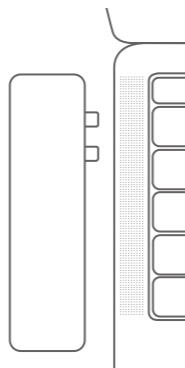

Connect external monitor

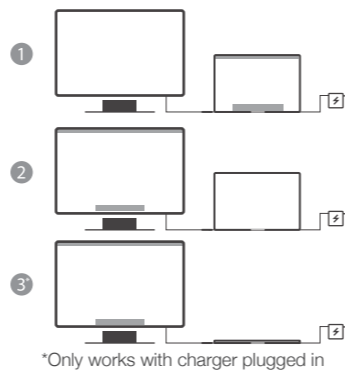

1. Go to **Apple** and click on **'System preferences'**
2. **Q** for **'Arrangement'**
3. To rearrange the displays, drag them to the desired position
4. To relocate the menu bar, drag it to the desired display
5. For mirrorview click on **'Mirror displays'**

Specifications

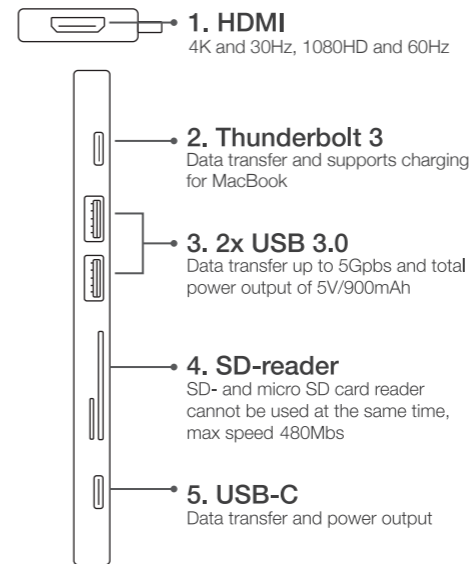

Warranty

All our products purchased from iMounts or authorized sellers have a 1-year warranty. Please feel free to contact us if you run into any problems.

Contact

Need help? Go to www.imounts.nl/support or send an email to support@imounts.nl

Visit www.imounts.nl for more information and products

iMounts is a registered trademark. All rights reserved.

