

Z1

4-AXIS FOLDABLE DRONE

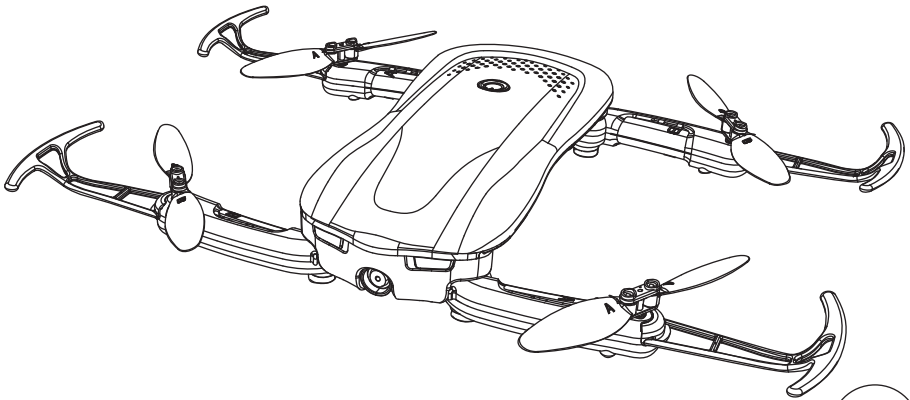

BC

1

USER MANUAL

MAIN FEATURES

- Special 4-axis structure - fast and agile. Suitable for flying in spacious indoor and outdoor areas.
- Built-in 6-axis gyroscope ensures accurate position hold.
- Modular design for easy upgrades and maintenance.
- New optical flow sensor for accurate position hold.
- Headless mode for easy recall of the drone.
- Improved height hold stability.
- Improved auto take-off/landing function.
- Enjoy aerial photography with high definition wireless real time video transmission.

Notice: The company will not be held responsibly for any printing inconsistencies and may or not inform end users regarding any new potential updates. For further information, please visit the [syma](http://www.syma.com) website.

Safety Guide

1. Please, keep the small drone accessories out of reach of children.
2. This drone is very powerful. When flying for the first time, avoid sudden movements of the throttle. When ascending push the throttle stick slowly up to avoid unintended damages or injuries.
3. After flying, turn off the transmitter before turning off the drone.
4. Do not keep the batteries in high temperatures areas or near heat sources.
5. It is strongly recommended to operate the drone at 2-3 meters away from a pilot and other people or animals. Crashes may cause unintended injuries. When landing the drone, avoid crashing it into other people.
6. Adult or experienced RC pilot's supervision is recommended for children.
7. Non-rechargeable batteries should not be recharged; Batteries should be inserted with a correct polarity; Different types of batteries, new or used batteries should not be mixing.
8. Turn off the drone/transmitter and remove the batteries when not in use.
9. The supply terminals should not be short-circuited.
10. When not in use for more than 10 days, take measures to pro-long the drone's battery life by reducing the drone battery level to 40%-50% of its capacity(fully charge the battery then fly the drone for half of its flying time).
11. Keep away from the rotating blades (rotating blades may cause bodily injuries, or damage to property).
12. To avoid interfering with air traffic control signals avoid flying a drone within 5000 meters of an airport. Avoid operating RC equipment during the periods set by the local authority.
13. Only use the included charger.
14. Liquids can be used to clean the product. Turn off the equipment and unplug the charger from the power source before cleaning the drone. Perform routine inspection of the charger (check: port, shell and other parts) on a regular basis. If any abnormalities are found, immediately stop using the equipment until it is fixed.
15. Attention: Drone assembly under adult supervision.
16. Do not look directly into the LED lights of the drone as it can damage your eyes.
17. Open the battery cover of the toy with screwdriver.
18. The packing has to be kept since it contains important information.

Repair and Maintenance

1. Use clean and soft cloth to clean the product.
2. Keep away the product from heat sources.
3. Avoid water exposure to this product. Moisture may cause damages of the aircraft electronic parts.
4. Charger used with the drone should be examined regularly, such as the cord, plug, enclosures and other parts. In case of any damages is found, please stop using it unless it is repaired or replaced.

Box Contents

Items included:

- Drone
- User Manual
- Blades X4
- USB Charger

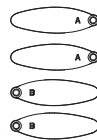
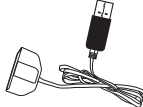
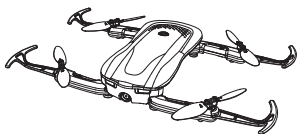

Smart Phone Application

1. Android/IOS Phone Software Download Instructions

Android: Please download and install the software SYMA FLY from www.symatoys.net or scan the QR code.

IOS: Please download and install the software SYMA FLY from the App Store, or scan the QR code.

Tips: QR codes can be found on the packaging box or at the last page of the user manual. Newest SYMA FLY app version can be found at www.symatoys.net or APP STORE.

2. Turn the drone on.

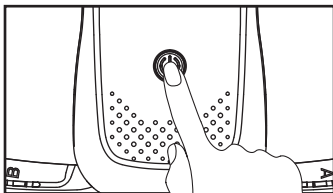

3. For more connection instructions, please refer to the App.

Folding/Unfolding the Drone's Arms

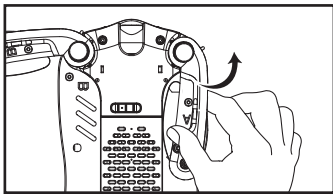

1. Unfold the arms of the drone as shown by the arrows in the picture. Make sure the arms are fully unfolded.

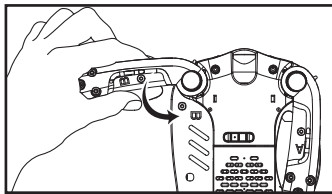

2. Fold the arms of the drone as shown by the arrows in the picture. Make sure the arms are fully folded.

Installing the Guards

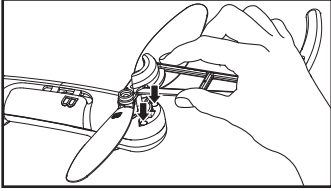

Locate the guards as shown by arrows in the picture by placing them into the slots near the motors.

Changing and Charging the Drone's Batteries



1. Gently press the on/off button to turn off the drone.

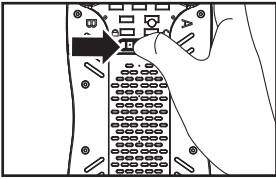

2. To remove the battery, slide the lock at the bottom of the drone as shown by arrows in the picture. Make sure it is fully unlocked and after remove the battery.

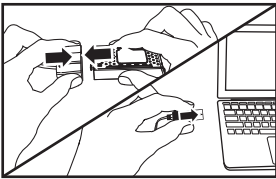

3. Connect the USB charging cable to the battery. Insert the charging cable into computer USB (when charging the light will be on; unplug the charger when the light goes off; charging time about 130 minutes).

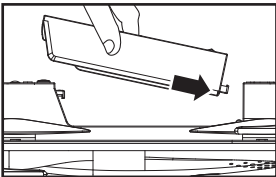

4. Once charging is completed, install the battery into the drone as shown by arrows on the picture.

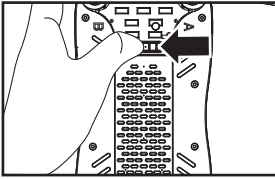

5. Slide the lock at the bottom of the drone as shown by arrows in the picture. Make sure it is fully locked.

Charging time is about 130 minutes. Drone hover time is about 7 minutes.

Important: battery charging information

- Do not keep the battery in high temperature areas, such as fire or heat sources. Otherwise, it may damage the battery or even trigger an explosion.
- Do not put the battery into water. Store the battery in a cool and dry environment.
- Avoid dismantling the batteries.
- During the charging of battery, avoid leaving the charging place.
- Rechargeable batteries should be removed from the toy before being charged.
- Rechargeable batteries should only be charged under the supervision of adults.
- Exhausted batteries should be removed from the aircraft.
- Caution: Risk of explosion if battery is replaced with incorrect ones. Please dispose the batteries according to the instructions.



1. During the battery installation, it must be ensured that the polarities of the batteries are matched with that of the battery box. No battery shall be installed with the opposite polarity.
2. Please do not use new and old batteries together.
3. Please do not use different types of batteries together.
4. Do not use rechargeable batteries.

Re-installing the Blades

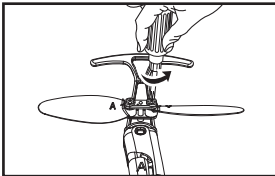

1. Remove the screws before re-installing the blades.

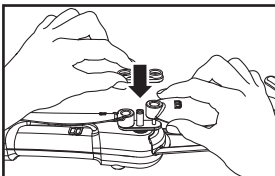

2. A labeled blades fit on the A labeled motors, B labeled blades fit on the B labeled motors. Use the screws to tighten the blades. Refer to the image.

Warning: Changes or modifications to this unit not expressly approved by the party responsible for compliance could void the user's authority to operate the equipment.

NOTE: This equipment has been tested and found to comply with the limits for a Class B digital device, pursuant to Part 15 of the FCC Rules. These limits are designed to provide reasonable protection against harmful interference in a residential installation. This equipment generates, uses and can radiate radio frequency energy and, if not installed and used in accordance with the instructions, may cause harmful interference to radio communications.

However, there is no guarantee that interference will not occur in a particular installation. If this equipment does cause harmful interference to radio or television reception, which can be determined by turning the equipment off and on, the user is encouraged to try to correct the interference by one or more of the following measures:

- Reorient or relocate the receiving antenna.
- Increase the separation between the equipment and receiver.
- Connect the equipment into an outlet on a circuit different from that to which the receiver is connected.
- Consult the dealer or an experienced radio/TV technician for help.

“This device complies with FCC radiation exposure limits set forth for general population (uncontrolled exposure). This device must not be collocated or operating in conjunction with any other antenna or transmitter.”

Declaration of Conformity Inserts:

“Hereby, GuangDong Syma model drone Industrial co.,ltd, declares that this drone is in compliance with the essential requirements and other relevant provisions of Directive 2014/53/EU.”

A copy of the full DoC is attached.

Accessories/Parts (Optional)

Please, look through the parts below. For your convenience, we have specified every part and accessory. The parts and accessories can be purchased through local distributors. Please specify desired colours at the time of purchase.



Body

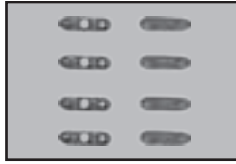

Blade Clip

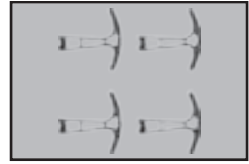

Protective Gear

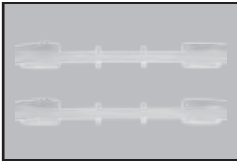

Light Protective Cover



Spinning Shell

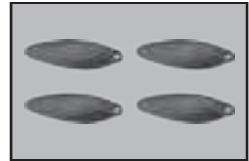

Blade A

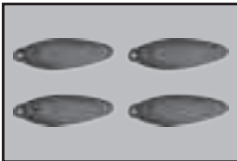

Blade B

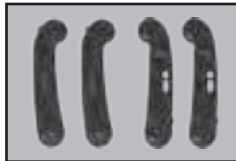

Arm A



Arm B

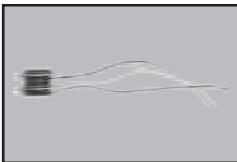

Motor A



Motor B



Storehouse Components



USB Charger



Receiver



Camera Components



Battery Elements

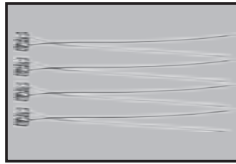

Light Board

Product Main Parts and Components

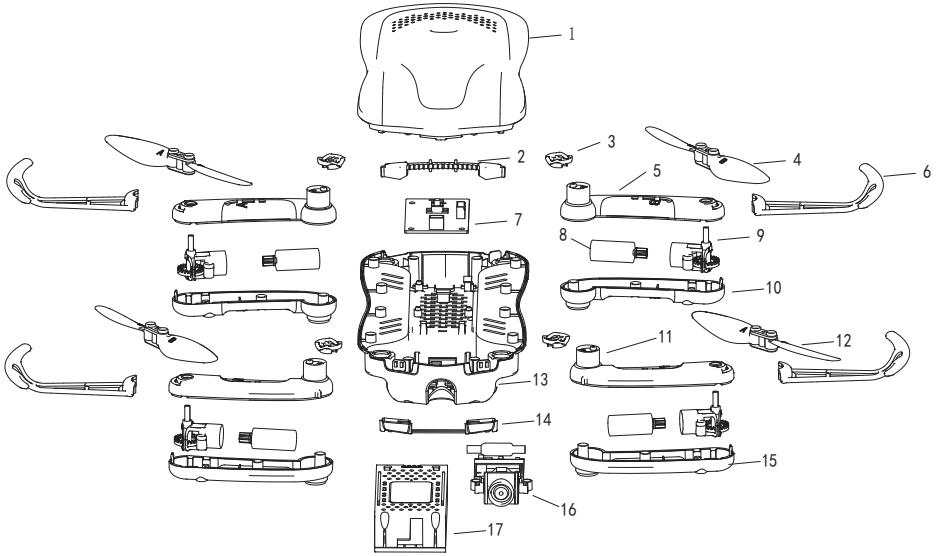

Serial number	Component/Part Name	Quantity	Serial number	Component/Part Name	Quantity
01	Top Main Body	1	10	Arm B Bottom Cover	2
02	Rear light Protective Cover	2	11	Arm A Top Cover	2
03	Spinning Shell	1	12	Blade A	2
04	Blade B	2	13	Bottom Main Body	1
05	Arm B Top Cover	2	14	Front Light Protective Cover	2
06	Protective Guard	4	15	Arm A Bottom Cover	2
07	Receiver	1	16	Camera Components	1
08	Battery Elements	4	17	Battery Elements	1
09	Storehouse Components	1			

Main Specifications

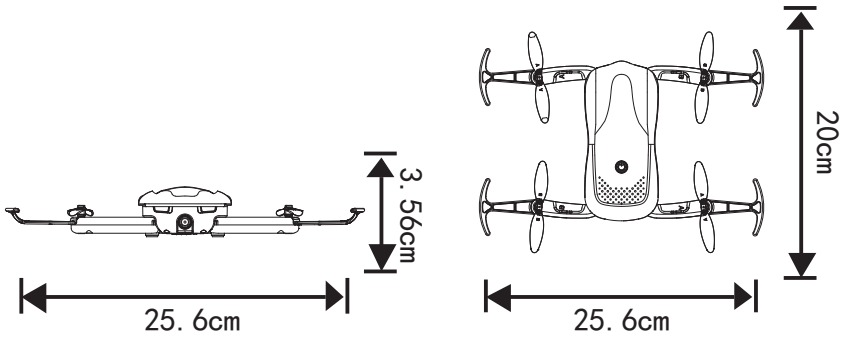

Drone length: 20cm

Drone width: 25.6cm

Drone height: 3.56cm

Motor size: \varnothing 8x16

Battery : 3.7V 500mAh lithium battery

Troubleshooting

Problem	Reason	Solution
The drone does not respond.	The drone has activated low voltage battery protection.	Recharge the drone's battery.
The transmitter sticks are not sensitive.	Out of flying control range.	Fly the drone within the range of the transmitter's transmission signal.
The drone is unstable when hovering or quickly drifts in one direction.	Balance calibration is needed.	Perform balance calibration, refer to the APP (balance calibration tool).
When in headless mode the forward direction deviates.	Numerous crashes.	Re-set forward direction, refer to the APP (headless mode tool).

Problem	Reason	Solution
<p>The drone does not hold the set altitude.</p>	<ol style="list-style-type: none"> 1. Balance calibration is needed. 2. Flying the drone in severe weather. 3. Heavy crash impacts gyroscope calculations. 	<ol style="list-style-type: none"> 1. Perform balance calibration, refer to the APP (balance calibration tool). 2. Avoid flying the drone in severe weather conditions (strong wind, rain, snow, fog, thunder etc). 3. Perform balance calibration, refer to the APP (balance calibration tool).



Android APP



iOS APP

Manufacturer:

Guangdong Syma Model Aircraft Industrial Co., Ltd.

Address: No 2 West Xingye Road, intersection of North Xingye Road,
Laimei Industrial Park, Chenghai District, Shantou City, Guangdong
Province, China. Postal Code: 515800

Sales department: +86 0754 86980668 After-sales service: +86 0754 86395095

Fax: +86 0754 86395098

Website: www.symatoys.net

Email: syma@symatoys.com

The company has the right of final interpretation of this user manual.