

SONOFF

DIY ZBDongle

User manual V1.1



Zigbee 3.0 USB Dongle Plus

CN > EN > DE > ES > FR > IT > RU > PT

产品简介

Product Introduction

Produkt Einführung

Introducción del producto

Présentation du produit

Introduzione al prodotto

Описание продукции

Introdução do produto

SONOFF Zigbee 3.0 USB Dongle Plus 基于 TI CC2652P + CP2102N, 预刷了 Z-Stack 3.x.0 协调器固件, 可以直接连接到您的计算机或树莓派, 通过 ZHA 或 Zigbee2MQTT 的方式连接到 Home Assistant 或其他开源平台中, 作为 ZigBee 网关。还可插入路由器固件作为路由设备扩展网络范围。

Le SONOFF ZigBee 3.0 USB Dongle Plus est conçu pour se brancher directement sur votre ordinateur ou Raspberry Pi et peut être utilisé comme coordinateur ou routeur pour votre réseau ZigBee via ZHA dans Home Assistant. Il est basé sur le TI CC2652P+CP2102N et pré-flashé avec le firmware officiel du coordinateur Z-Stack 3.x.0.

安装天线

Antenna Installation

Antenneninstallation

Instalación de la antena

Installation de l'antenne

Instalazione dell'antenna

Установка антенны

Instalação da antena

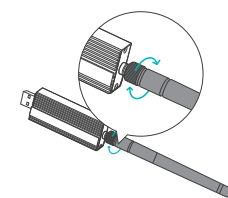

LIKE IT!

Glad to know you are satisfied with SONOFF products. It would mean a lot to us if you can take a minute to share your buying experience.



Share it on Amazon



Share it on your social media



Share it with your friends and family

Get the latest news by following us:

New arrival Promotion How-to videos

HAVE A PROBLEM?

We are so sorry for the inconvenience caused by the product. Please contact us for help via the email address below.



support@itead.cc

We will get back to you as soon as possible.



支持广泛的设备类型

Supported Device Types

Unterstützte Gerätetypen

Tipos de dispositivos compatibles

Types de dispositifs pris en charge

Tipi di dispositivi supportati

Поддерживаемые типы устройств

Tipos de dispositivos suportados

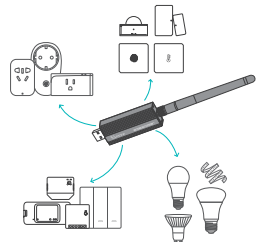

更多教程

More Detailed Tutorials

Ausführlichere Anleitungen

Tutoriales más detallados

Tutoriels plus détaillés

Tutorial più dettagliati

Более подробные инструкции

Tutoriais mais detalhados



https://sonoff.tech/uncategorized/zigbee-3-0-usb-dongle-plus/

扫码或输入网址观看设备使用详细教程。 Scan the QR code or enter the URL to view the detailed tutorial. Scannen Sie den QR-Code oder geben Sie die URL um die ausführliche Anleitung zu sehen.

FCC Warning

Changes or modifications not expressly approved by the party responsible for compliance could avoid the user's authority to operate the equipment. This device complies with part 15 of the FCC Rules. Operation is subject to the following two conditions:

(1) This device may not cause harmful interference, and (2) this device must accept any interference received, including interference that may cause undesired operation.

FCC Radiation Exposure Statement: This equipment complies with FCC radiation exposure limits set forth for an uncontrolled environment.

Note: This equipment has been tested and found to comply with the limits for a Class B digital device, pursuant to part 15 of the FCC Rules. These limits are designed to provide reasonable protection against harmful interference in a residential installation.

- Reorient or relocate the receiving antenna.
— Increase the separation between the equipment and receiver.
— Connect the equipment into an outlet on a circuit different from that to which the receiver is connected.
— Consult the dealer or an experienced radio/TV technician for help.

Hereby, Shenzhen Sonoff Technologies Co., Ltd. declares that the radio equipment type ZBDongle-P is in compliance with Directive 2014/53/EU. The full text of the EU declaration of conformity is available at the following internet address:

https://sonoff.tech/usermanuals

SONOFF

Shenzhen Sonoff Technologies Co., Ltd. 1001, BLDG8, Lianhua Industrial Park, Shenzhen, GD, China ZIP code: 518000 Website: sonoff.tech

MADE IN CHINA



Table with 2 columns: Brand (品牌), Material (物料), Material (材料), Dimensions (尺寸), Date (日期). Values include Sonoff, ZBDongle-P manual V1.1, 105g copper board, 190x80mm, and 2021.10.08.