

Power Supply User's Manual V550W / V650W / V750W

1. Model Descriptions

RS-550-AFBA-G1: 550W Active PFC Power Supply

RS-650-AFBA-G1: 650W Active PFC Power Supply

RS-750-AFBA-G1: 750W Active PFC Power Supply

2. Specifications

- Type: Intel ATX 12V V2.31
- Input Voltage: 100~240Vac
- Input Frequency : 47Hz ~ 63Hz
- Fan: 120mm Cooler Master Silencio FP FAN
- Power Good Signal: 100 ~ 500ms
- Hold Up Time: > 16ms
- Efficiency: 90% Typically
- MTBF: >100,000Hours
- Protection: OCP / OPP / OVP / OTP / SCP / UVP
- Dimension: 150 × 140 × 86mm (5.9 × 5.5 × 3.4 in)
- Operation Temperature: 0~40°C(Nominal Input Voltage)

- Regulatory: CE / TUV / FCC / UL / EAC / CCC / BSMI / RCM / KC

AC Input	100-240V~ 8-4A 60-50Hz				
DC Output	+3.3V	+5V	+12V	-12V	+5V _{sb}
	20A	20A	45A	0.3A	2.5A
Total Power	100W	540W	3.6W	12.5W	
	550W				

AC Input	100-240V~ 9-4.5A 60-50Hz				
DC Output	+3.3V	+5V	+12V	-12V	+5V _{sb}
	25A	22A	54A	0.3A	2.5A
Total Power	120W	648W	3.6W	12.5W	
	650W				

AC Input	100-240V~ 10-5A 60-50Hz				
DC Output	+3.3V	+5V	+12V	-12V	+5V _{sb}
	25A	22A	62A	0.3A	2.5A
Total Power	120W	744W	3.6W	12.5W	
	750W				

AC Input	100-240V~ 10-5A 60-50Hz				
DC Output	+3.3V	+5V	+12V	-12V	+5V _{sb}
	25A	22A	62A	0.3A	2.5A
Total Power	120W	744W	3.6W	12.5W	
	750W				

AC Input	100-240V~ 10-5A 60-50Hz				
DC Output	+3.3V	+5V	+12V	-12V	+5V _{sb}
	25A	22A	62A	0.3A	2.5A
Total Power	120W	744W	3.6W	12.5W	
	750W				

3. Installation

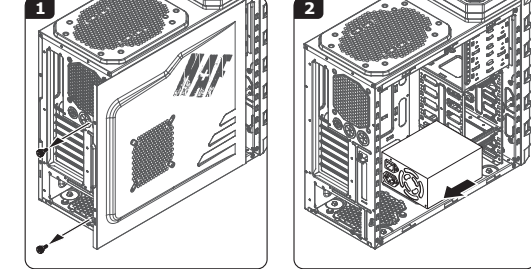

English

Warranty

Cooler Master guarantees this device to be free of defects in material and workmanship, and provide a 5-year hardware limited warranty for the power supply on the date of purchase. Please register on our official website for your international limited warranty (<http://www.coolermaster.com/member>).

This product is designed for computer usage only. Using this device in any other application will void the warranty. If you are not familiar with computer hardware installation, please ask for professional assistance.

The warranty applies to the Power Supply Unit, and does not include accessories.

The warranty applies to damages caused through normal use and is void if it is determined that the device was damaged because of abuse, alteration, misuse, negligence, incorrect voltage supply, air/water pollution, accidents and natural disasters.

During the warranty period, please return your product to the dealer or retailer from whom you purchased for a replacement/repair. Please contact our customer support team for any technical related questions.

<http://www.coolermaster.com/warrantyinfo>

Limited warranty period:

<http://www.coolermaster.com/warrantyperiod>

Technical support:

<http://www.coolermaster.com/techsupport>

Troubleshooting

If your system does not turn on after installing the power supply, follow the troubleshooting guide as listed below:

- Please make sure the main power is connected on correctly.
- Please make sure the P1 and P2 connectors are connected correctly to the motherboard.
- If the power supply does not work properly, please contact our service center immediately.

إذا لم يعمل نظام تشغيل الكمبيوتر الخاص بك بعد تركيب وحدة الإمداد بالطاقة، اتبع الإرشادات استكشاف الأخطاء وإصلاحها كما هو مذكور أدناه:

- يرجى التأكد من توصيل الطاقة الأساسي بشكل صحيح.
- يرجى التأكد من توصيل الموصلين P1 وP2 بالطورحة الأم بشكل صحيح.
- إذا كانت وحدة الإمداد بالطاقة لا تعمل بشكل مناسب، يرجى الاتصال على الفور بمركز الخدمة التابع لنا.

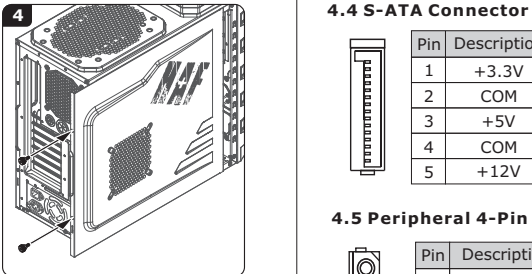
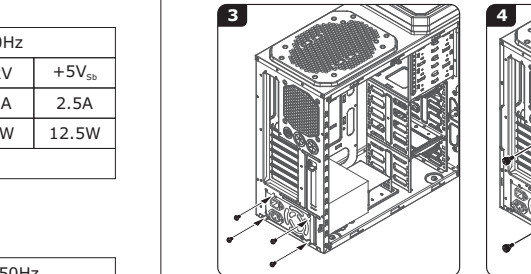

4. Connector Descriptions

4.1 Motherboard 24 Pin Connector (P1)

Pin1	Pin13	Pin	Description	Pin	Description
		1	+3.3V	13	+3.3V _s
		2	+3.3V	14	-12V
		3	COM	15	COM
		4	+5V	16	PS-ON
		5	COM	17	COM
		6	+5V	18	COM
		7	COM	19	COM
		8	P.G.	20	-----
		9	+5V _{sb}	21	+5V
		10	+12V	22	+5V
		11	+12V	23	+5V
		12	+3.3V	24	COM

4.2 CPU 4+4Pin

Pin1	Pin5	Pin	Description	Pin	Description
		1	GND	5	+12V
		2	GND	6	+12V
		3	GND	7	+12V
		4	GND	8	+12V

4.3 PCI-e 6+2Pin Connector

Pin1	Pin5	Pin	Description	Pin	Description
		1	+12V	5	COM
		2	+12V	6	COM
		3	+12V	7	COM
		4	COM	8	COM

4.4 S-ATA Connector

Pin	Description
1	+3.3V
2	COM
3	+5V
4	COM
5	+12V

4.5 Peripheral 4-Pin Connector

Pin	Description
1	+12V
2	COM
3	COM
4	+5V

4.6 Floppy Connector

Pin	Description
1	+12V
2	COM
3	COM
4	+5V

5. WEEE Notice



English

Disposal of Waste Equipment by Users in Private Households in the European Union.

This symbol on the product or on its packaging indicates that this product must not be disposed of with your other household waste. Instead, it is your responsibility to dispose of your waste equipment by handing it over to a designated collection point for the recycling of waste electrical and electronic equipment. The separate collection and recycling of your waste equipment at the time of disposal will help to conserve natural resources and ensure that it is recycled in a manner that protects human health and the environment. For more information about where you can drop off your waste equipment for recycling, please contact your local city office, your household waste disposal service or the shop where you purchased the product.

Français

Evacuation des équipements usagés par les utilisateurs dans les foyers privés au sein de l'Union européenne.

La présence de ce symbole sur le produit ou sur son emballage indique que vous ne pouvez pas vous débarrasser de ce produit de la même façon que vos déchets courants. Au contraire, vous êtes responsable de l'évacuation de vos équipements usagés et à cet effet, vous êtes tenu de les remettre à un point de collecte agréé pour le recyclage des équipements électriques et électroniques usagés. Le tri, l'évacuation et le recyclage séparés de vos équipements usagés permettent de préserver les ressources naturelles et de s'assurer que ces équipements sont recyclés dans le respect de la santé humaine et de l'environnement. Pour plus d'informations sur les lieux de collecte des équipements usagés, veuillez contacter votre mairie, votre service de traitement des déchets ménagers ou le magasin où vous avez acheté le produit.

Deutsch

Entsorgung von Elektrogeräten durch Benutzer in privaten Haushalten in der EU.

Dieses Symbol auf dem Produkt oder dessen Verpackung gibt an, dass das Produkt nicht zusammen mit dem Restmüll entsorgt werden darf. Es obliegt daher Ihrer Verantwortung, das Gerät an einer entsprechenden Stelle für die Entsorgung oder Wiederverwertung von Elektrogeräten aller Art abzugeben (z.B. ein Wertstoffhof). Die separate Sammlung und das Recyceln Ihrer alten Elektrogeräte zum Zeitpunkt ihrer Entsorgung trägt zum Schutz der Umwelt bei und gewährleistet, dass sie auf eine Art und Weise recycelt werden, die keine Gefährdung für die Gesundheit des Menschen und der Umwelt darstellt. Weitere Informationen darüber, wo Sie alte Elektrogeräte zum Recyceln abgeben können, erhalten Sie bei den örtlichen Behörden, Wertstoffhöfen oder dort, wo Sie das Gerät erworben haben.

Italiano

Smaltimento di apparecchiature da rottamare da parte di privati nell'Unione Europea.

Questo simbolo che appare sul prodotto o sulla confezione indica che il prodotto non deve essere smaltito assieme agli altri rifiuti domestici. Gli utenti devono provvedere allo smaltimento delle apparecchiature da rottamare portandole al luogo di raccolta indicato per il riciclaggio delle apparecchiature elettriche ed elettroniche. La raccolta e il riciclaggio separati delle apparecchiature da rottamare in fase di smaltimento favoriscono la conservazione delle risorse naturali e garantiscono che tali apparecchiature vengano rottamate nel rispetto dell'ambiente e della tutela della salute. Per ulteriori informazioni sui punti di raccolta delle apparecchiature da rottamare, contattare il proprio comune di residenza, il servizio di smaltimento dei rifiuti locale o il negozio presso il quale è stato acquistato il prodotto.

Português

Descarte de equipamentos por usuários em residências da União Europeia. Este símbolo no produto ou na embalagem indica que o produto não pode ser descartado junto com o lixo doméstico. No entanto, é sua responsabilidade levar os equipamentos a serem descartados a um ponto de coleta designado para a reciclagem de equipamentos eletro-eletrônicos. A coleta separada e a reciclagem dos equipamentos no momento do descarte ajudam na conservação dos recursos naturais e garantem que os equipamentos serão reciclados de forma a proteger a saúde das pessoas e o meio ambiente. Para obter mais informações sobre onde descartar equipamentos para reciclagem, entre em contato com o escritório local de sua cidade, o serviço de limpeza pública de seu bairro ou a loja em que adquiriu o produto.

Español

Eliminación de residuos de aparatos eléctricos y electrónicos por parte de usuarios domésticos en la Unión Europea. Este símbolo en el producto o en el embalaje indica que no se puede desechar el producto junto con los residuos domésticos. Por el contrario, si debe eliminar este tipo de residuo, es responsabilidad del usuario entregarlo en un punto de recolección designado de reciclado de aparatos electrónicos y eléctricos. El reciclaje y la recolección por separado de estos residuos en el momento de la eliminación ayudará a preservar recursos naturales y a garantizar que el reciclaje proteja la salud y el medio ambiente. Si desea información adicional sobre los lugares donde puede dejar estos residuos para su reciclado, póngase en contacto con las autoridades locales de su ciudad, con el servicio de gestión de residuos domésticos o con la tienda donde adquirió el producto.

Nederlands

Afvoer van afgedankte apparatuur door gebruikers in particuliere huishoudens in de Europese Unie.

Dit symbool op het product of de verpakking geeft aan dat dit product niet mag worden afgevoerd met het huishoudelijk afval. Het is uw verantwoordelijkheid uw afgedankte apparatuur af te leveren op een aangewezen inzamelpunt voor de verwerking van afgedankte elektrische en elektronische apparatuur. De gescheiden inzameling en verwerking van uw afgedankte apparatuur draagt bij tot het sparen van natuurlijke bronnen en tot het hergebruik van materiaal op een wijze die de volksgezondheid en het milieu beschermt. Voor meer informatie over waar u uw afgedankte apparatuur kunt inleveren voor recycling kunt u contact opnemen met het gemeentehuis in uw woonplaats, de reinigingsdienst of de winkel waar u het product hebt aangeschaft.

Deuts

Evacuation des équipements usagés par les utilisateurs dans les foyers privés au sein de l'Union européenne. La présence de ce symbole sur le produit ou sur son emballage indique que vous ne pouvez pas vous débarrasser de ce produit de la même façon que vos déchets courants. Au contraire, vous êtes responsable de l'évacuation de vos équipements usagés et à cet effet, vous êtes tenu de les remettre à un point de collecte agréé pour le recyclage des équipements électriques et électroniques usagés. Le tri, l'évacuation et le recyclage séparés de vos équipements usagés permettent de préserver les ressources naturelles et de s'assurer que ces équipements sont recyclés dans le respect de la santé humaine et de l'environnement. Pour plus d'informations sur les lieux de collecte des équipements usagés, veuillez contacter votre mairie, votre service de traitement des déchets ménagers ou le magasin où vous avez acheté le produit.

English

العربية

Български

Гаранция

Cooler Master гарантира, че това устройство няма дефекти на материалите и изработката и предоставя 5-годишна ограничена хардуерна гаранция за захранването, считано от датата на покупка. За да получите своята международна ограничена гаранция, регистрирайте се на нашия официален уеб сайт (<http://www.coolermaster.com/member>). Този продукт е предназначен само за компютърна употреба. Използването на това устройство за други цели ще анулира гаранция. Ако не сте запознати с инсталирането на компютърен хардуер, потърсете помощ от специалист.

Гаранцията важи за захранващото устройство и не включва аксесоарите.

Гаранцията важи за повреди в резултат от нормална употреба и се анулира, ако бъде установено, че устройството е било повредено при злоупотреба, модифициране, неправилна употреба, небрежност, неправилно захранващо напрежение, замърсяване на въздуха/водата, злополука или природно бедствие.

По време на гаранционния период, занесете продукта на търговеца, от който сте го закупили, за замяна/ремонт. Свържете се с обслужване на клиенти, ако имате технически въпроси.

<http://www.coolermaster.com/warrantyinfo>

Период на ограничената гаранция:

<http://www.coolermaster.com/warrantyperiod>

Техническа поддръжка:

<http://www.coolermaster.com/techsupport>

Отстраняване на проблеми

Отстраняване на проблеми

Ако системата Ви не се включва след инсталирането на захранването, следвайте посочените по-долу стъпки за отстраняване на проблема:

- Уверете се, че основното захранване е свързано правилно.
- Уверете се, че конекторите P1 и P2 са свързани правилно към дънната плата.
- Ако захранването не работи нормално, моля, обърнете се незабавно към нашия сервизен център.

繁體中文

保固資訊

Cooler Master保證本電源供應器裝置之材質及做工無瑕疵，並提供此電源供應器自購買日算起5年的硬體有限保固服務。煩請上 Cooler Master官方網站註冊您的產品 (<http://www.coolermaster.com/member>)。本產品專為電腦使用設計，一旦將本設備用於其他用途，則保固無效。若您不熟悉硬體安裝程序，煩請尋求專業的協助。本公司所提供之保固僅限於電源供應器本體，不包含配件。若電源供應器毀損之原因為人為濫用、改造、誤用、疏忽、電壓供應錯誤、空氣及水汙染意外和自然災害，則保固無效。保固期間，如需做產品更換/維修，請至您所購買產品的經銷商或零售商。如有任何技術相關的問題，請聯絡本公司客戶服務部門。<http://www.coolermaster.com/warrantyinfo>

Cooler Master 全序列產品保固期:

<http://www.coolermaster.com/warrantyperiod>

技術支援:

<http://www.coolermaster.com/techsupport>

疑難排除

如果您裝好本電源供應器後無法開機，請按照下列的疑難排除步驟：

- 確定電源供應器之主電源線有確實插入。
- 請確定 P1、P2接頭接到主機板的方式正確。
- 如果電源運作不正常，歡迎聯絡本公司之服務中心。

如有任何技術相關的問題，請聯絡本公司客戶服務部門。<http://www.coolermaster.com/warrantyinfo>

全序列產品保固期:

<http://www.coolermaster.com/warrantyperiod>

技術支援:

<http://www.coolermaster.com/techsupport>

有毒有害物質標示

部件名称	铅 (Pb)	汞 (Hg)	镉 (Cd)	六价铬 (Cr(VI))	多联联苯 (PBB)	多溴二苯醚 (PBDE)
PCB板	○	○	○	○	○	○
元器件	X	○	○	○	○	○
结构件	○	○	○	○	○	○
塑胶件	○	○	○	○	○	○
线材	○	○	○	○	○	○
其他辅料	○	○	○	○	○	○

○：表示该有毒有害物质在该部件所有材料中的含量均符合SJ/T 11363-2006 标准规定的限量以下；

X：表示该有毒有害物质至少在该部件某一均质材料中的含量超出SJ/T 11363-2006 标准规定的限量以下；

上述规范仅适用于中国法律

Português

Descarte de equipamentos por usuários em residências da União Europeia. Este símbolo no produto ou na embalagem indica que o produto não pode ser descartado junto com o lixo doméstico. No entanto, é sua responsabilidade levar os equipamentos a serem descartados a um ponto de coleta designado para a reciclagem de equipamentos eletro-eletrônicos. A coleta separada e a reciclagem dos equipamentos no momento do descarte ajudam na conservação dos recursos naturais e garantem que os equipamentos serão reciclados de forma a proteger a saúde das pessoas e o meio ambiente. Para obter mais informações sobre onde descartar equipamentos para reciclagem, entre em contato com o escritório local de sua cidade, o serviço de limpeza pública de seu bairro ou a loja em que adquiriu o produto.

Cooler Master Products: Limited Warranty
This document describes the warranty terms for all Cooler Master product sold in Australia

For Australia only:

Our goods come with guarantees that cannot be excluded under the Australian Consumer Law. You are entitled to a replacement or refund for a major failure and for compensation for any other reasonably foreseeable loss or damage. You are also entitled to have the goods repaired or replaced if the goods fail to be of acceptable quality and the failure does not amount to a major failure. (Cooler Master Technology Inc. 8F, No. 788-1, Zhongzheng Rd., Zhonghe Dist., New Taipei City 23586, Taiwan (R.O.C.).)
Telephone: +886-2-2225-3517 (standard international call charges apply.)

Who the Warranty Protects:

This Warranty is valid to the original purchaser only.

What the warranty protects:

This warranty is valid only for the Cooler Master Products distributed by authorized dealer(s) in Australia. Please contact Cooler Master for warranty information and services:
■ Cooler Master Technology Inc. 8F, No. 788-1, Zhongzheng Rd., Zhonghe Dist., New Taipei City 23586, Taiwan (R.O.C).

■ E-mail Support: eservice@coolermaster.com.tw

■ Online live chat support: www.coolermaster.com/livehelp

■ Customer service: +886-2-2225-3517 (standard international call charges apply.)

What the warranty does not cover

- Any product, on which the serial number has been defaced, modified or removed.
- Accident, misuse, neglect, fire, water, lightning, or other acts of nature, unauthorized product modification, or failure to follow instructions supplied with the product.
- Repair or attempted repair by anyone not authorized by Cooler Master.
- Damage to or loss of any programs, data or removable storage media.
- Software or data loss occurring during repair or replacement.
- Any damage of the product due to shipment.
- Removal or installation of the product.
- External causes, such as electric power fluctuations or failure.
- Use of supplies or parts not meeting Cooler Master's specifications.
- Normal wear and tear.
- Failure of owners to perform periodic product maintenance as stated in User Guide, Such as cleaning of user-cleanable projector filters.
- Any other cause which does not relate to a product defect.
- Damage caused by static (non-moving) images displayed for lengthy periods of time (also referred to as image burn-in).

