



Installation guide



Wi-Fi router X3 N300

- UK** Full manual available in English
- NL** Volledige handleiding beschikbaar in het engels
- IT** Il manuale utente completo è disponibile in lingua inglese
- DE** Vollständiges Handbuch in englischer Sprache verfügbar
- ES** Manual completo disponible en inglés
- PT** Manual completo disponível em inglês
- FR** Manuel complet disponible en anglais
- RU** Подробное руководство доступно на английском языке



www.sitecom.com/helpdesk

Package content

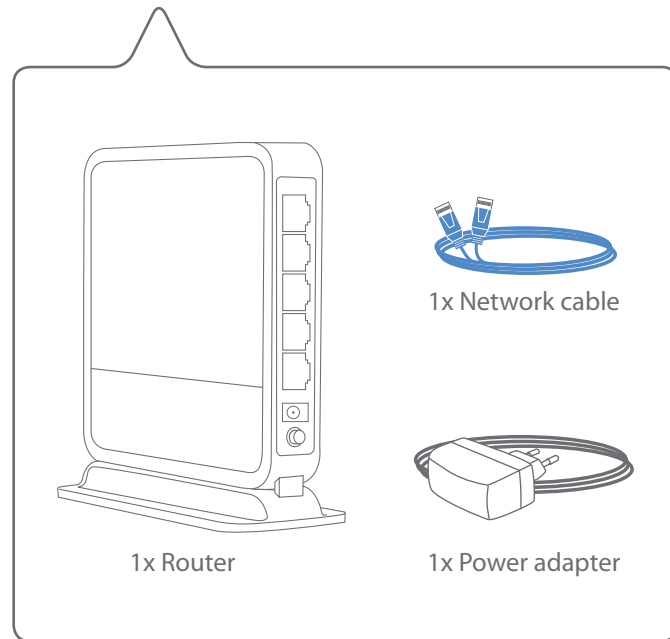

1

Connect the router to your modem

- NL Verbind de router met de modem
- IT Collegare il router al modem
- DE Verbinden Sie den Router mit Ihrem Modem
- ES Conecte el router a su módem
- PT Ligue o router ao seu modem
- FR Connectez le routeur à votre modem
- RU Подключите маршрутизатор к модему

A

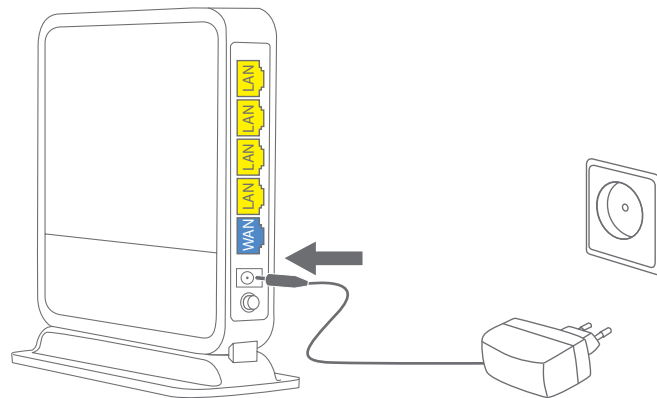
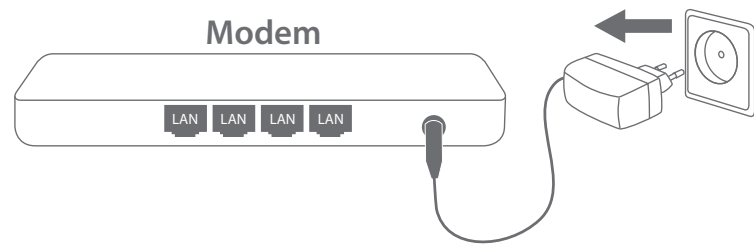

B

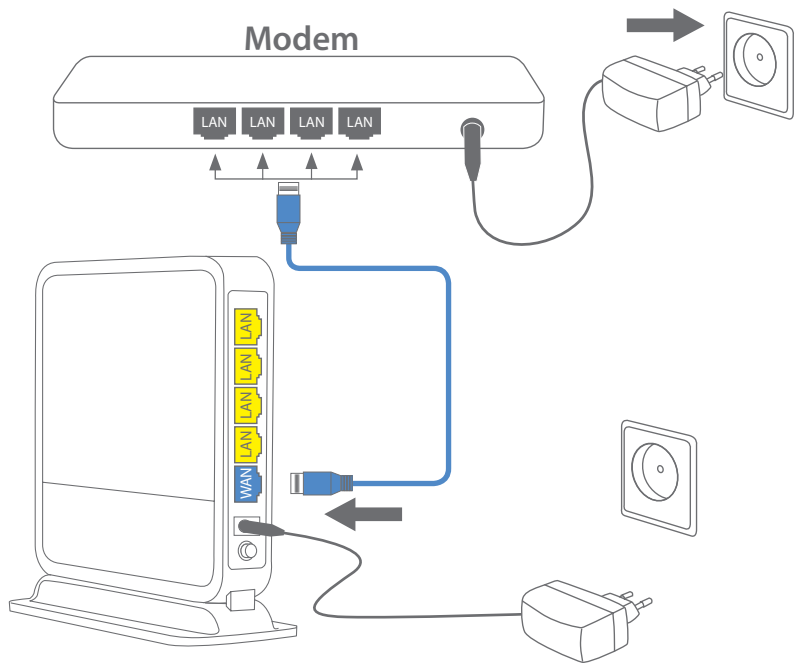

C

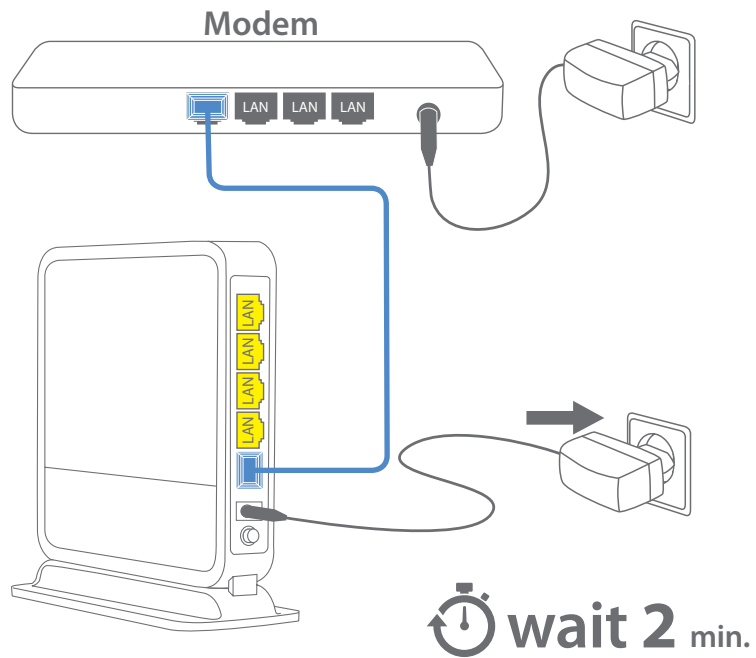

2

Connect to your PC / Mac

- NL Verbind je PC / Mac
- IT Connetti al PC / Mac
- DE Verbindung zum PC / Mac
- ES Conéctese a su PC / Mac
- PT Ligue ao seu PC / Mac
- FR Peut être connecté à votre ordinateur PC / Mac
- RU Подключитесь к PC / Mac

A

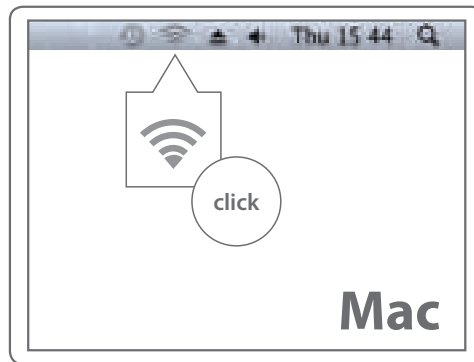
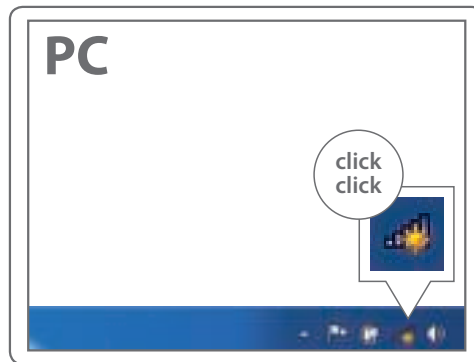

B

PC

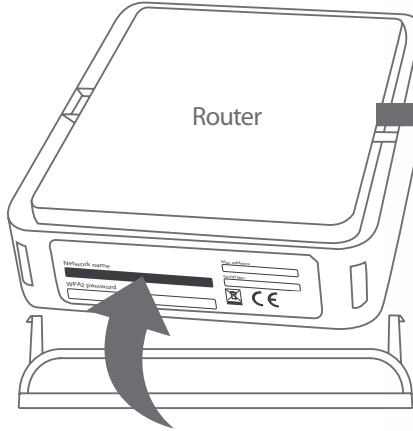

click
click



network name



Network name also in the Network Login Details

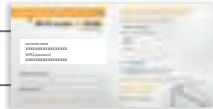

Mac

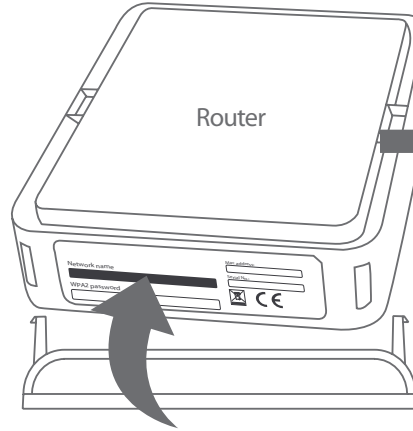

click



network name



Network name also in the Network Login Details

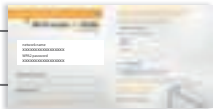

C

PC



click
OK

WPA2 password



WPA2 password also in the Network Login Details

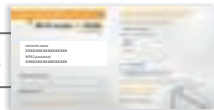

Mac

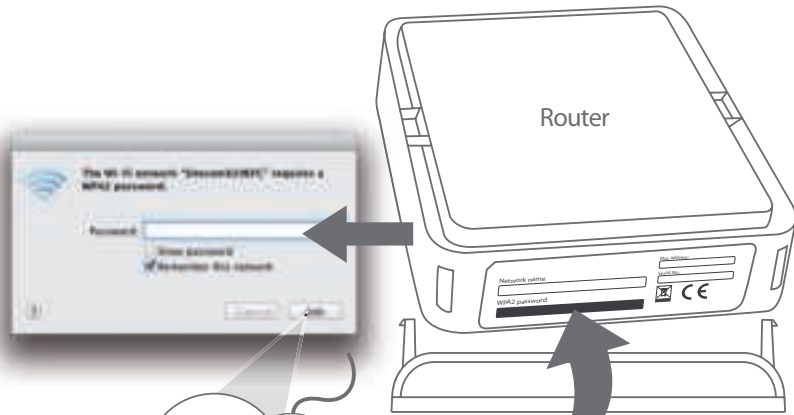

click
Join

WPA2 password



WPA2 password also in the Network Login Details

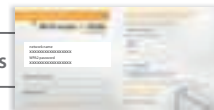

D

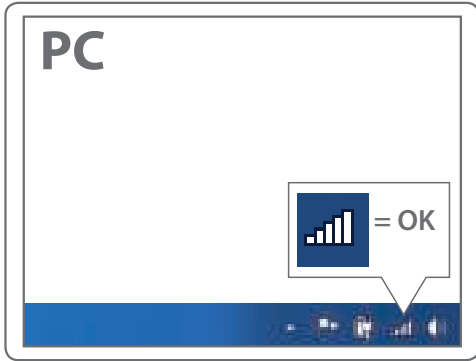

E



**Done.
Enjoy!**

Trouble? www.sitecom.com/helpdesk

Extra!



Easily find out how to
create a guest
Wi-Fi network for your
family & friends

Check FAQs online

for instructions in your local language

www.sitecom.com/helpdesk



Register this product online
within 3 weeks of purchase and
get a free **10 year** warranty

www.sitecom.com/warranty