

AREBOS

Inflatable mattress air bed

single/double



Please follow all security measures in this user manual to ensure safe use.



Thank you for your trust in AREBOS.

Table of Content

| | |
|--|-----------|
| 1 Introduction and safety instructions..... | 3 |
| 1.1 Introduction..... | 3 |
| 1.2 Explanation of symbols | 3 |
| 1.3 Important safety instructions | 5 |
| 2 Scope of delivery | 6 |
| 2.1. Product characteristics..... | 6 |
| 3 Commissioning | 7 |
| 4 Folding the air bed..... | 8 |
| 5 Maintenance | 9 |
| 6 Cleaning | 9 |
| 7 Troubleshooting | 9 |
| 7.1. Repair air leak..... | 9 |
| 8 Environmentally friendly disposal..... | 10 |
| 8.1 Disposal and packaging | 10 |
| 8.2 Disposal of waste equipment | 10 |
| EU declaration of conformity | 11 |

Thank you for purchasing our product. Please read the user manual carefully before using the product for the first time. If you leave the product to third parties, this instruction manual must be handed over with you. Keep the instruction manual for later reference. The drawings in this guide may not match the physical objects. Please refer to the physical objects.

1 Introduction and safety instructions

1.1 Introduction

- This guide is intended to familiarize you with the installation, use, and maintenance of the product. To install the device safely and correctly, please read the user manual **before** you begin.

1.2 Explanation of symbols



Warning! Read the safety instructions carefully. Failure to observe safety precautions may result in serious injury or damage. Keep the instruction manual in a safe place.



Note! Unplug the power cord.



Warning! Risk of electrical voltage!



Use with caution when using this article!

! WARNING! This signal symbol/word refers to a hazard with a medium degree of risk which, if not avoided, could result in death or serious injury.

! CAUTION! This signal symbol/word refers to a hazard with a low level of risk which, if not avoided, may result in minor or moderate injury.

Hint! This signal symbol/word warns of possible property damage.



Read the instructions for use



Do not use pins



Not to be used by very young children (0-3) years



Do not bleach



Do not tumble dry

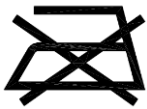

Do not iron



Do not dry clean



Do not wash



This product **must not** be disposed of with household waste!





By means of a CE marking, it can be recognized that a product complies with the legal requirements of European legal standards and may therefore be traded within the European Community.



This product has been tested and certified by TÜV Süd.
The symbol "GS" stands for tested safety. Products marked with this symbol comply with the requirements of the Product Safety Act (ProdSG).

1.3 Important safety instructions

- Your safety is of the utmost importance to us. Please make sure you have read this user manual **before** attempting to use the item. If you are not sure about the information contained in this guide, please contact the retailer where you purchased your device.
-  **WARNING!** This item is highly flammable. The mattress contains plastic. Do not place the item next to a fire pit or highly flammable objects.
-  **WARNING! Suffocation!** Packaging material is dangerous for children. Never let children play with packaging material.
- This is not a toy. Do not let toddlers play/jump on it.
- Unplug the power when you are not using the air bed.
- The pump is electric, do not use it near water. Do not let the pump get wet.
- Do not attempt to disassemble or repair the pump.

WARNING!

- This mattress may only be used as an air bed, not use in water!
- May not be used by children under 3 years of age without supervision.
- This air bed is not suitable for children or people with reduced mobility to roll down because of the danger.
- Do not use the mattress on sharp-edged surfaces. The surface must be smooth, even, clean and free of objects that can lead to damage.
- Do not climb and jump on the mattress, this is not a trampoline!
- Walking on the mattress leads to punctual damage.

2 Scope of delivery

Check the article for completeness before using it

Included in the delivery are:

- Air mattress with built-in electric pump
- Repair patches (no glue)
- Storage bag

The mattress has a built-in pump with a 2 compartment valve.
The 2 compartment valve is used for inflating or draining air

The valve is constructed as follows:

1. Valve opening
2. Center valve
3. Stopper

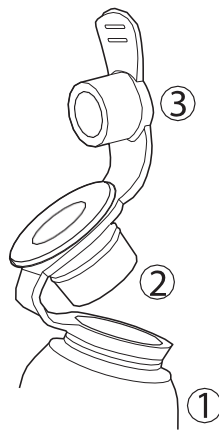

2.1. Product characteristics

Single mattress: 203 x 95 x 51 cm Weight: 6.3 kg

Double mattress: 203 x 152.5 x 51 cm Weight: 8.2 kg

Material thickness: 0.45 mm – 0.6 mm, PVC

3 Commissioning

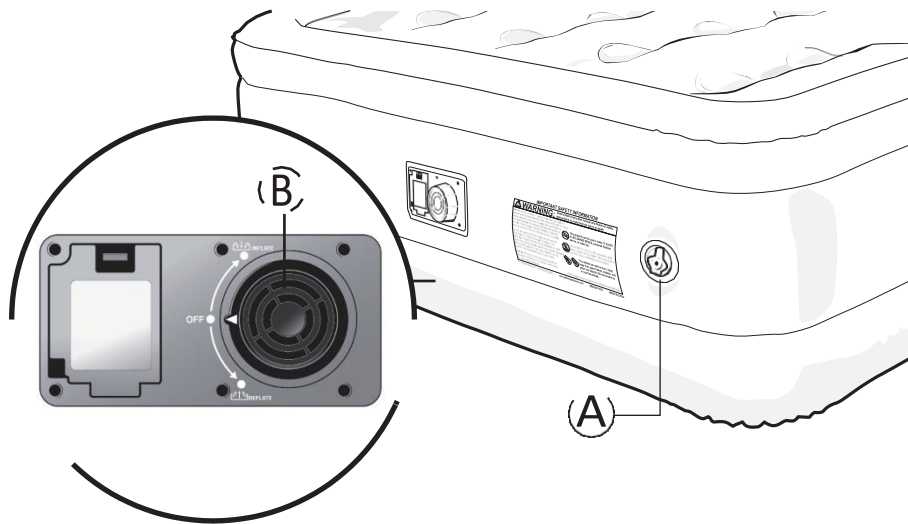

Inflate

1. Place the air mattress on a flat, clean surface (without sharp-edged objects that could cause damage)
2. Spread out the mattress so that the air can be pumped in more easily.
3. Make sure that the plug (3) closes the center valve (2) tightly.
4. Set the controller (B) of the integrated pump to „inflate" to inflate the mattress.
5. As soon as the desired amount of air is in the mattress, set the controller (B) to the "off" position.

Deflate

1. Set the slider (B) to "deflate" to drain the air from the mattress.
2. Let all the air out. To speed up the process, you can open the center valve (2).
3. Then set the controller (B) to the "off" position to switch off the pump.
4. Fold the air bed according to the instructions and store it in the storage bag until the next use.

4 Folding the air bed

- As soon as the air is completely out, place the mattress with the sleeping surface facing up on a smooth, flat surface and fold it together as follows:

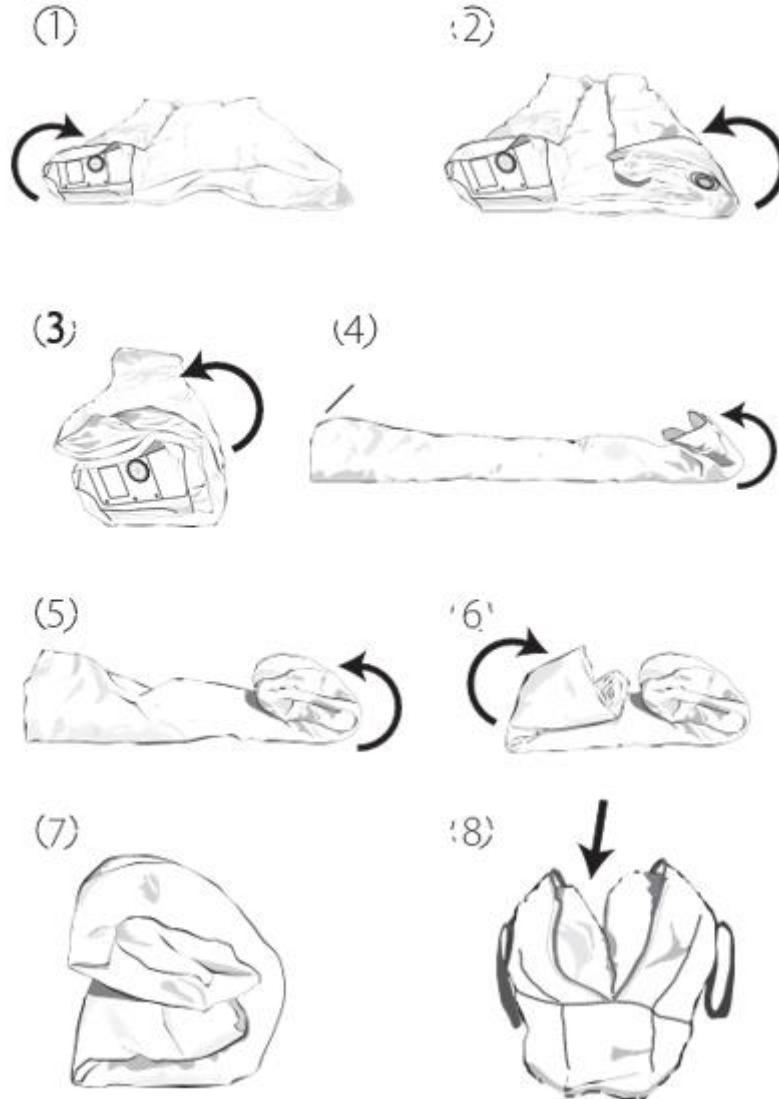

5 Maintenance

1. Check the mattress for damage before use
2. Keep the mattress away from sharp-edged objects. Large cracks, holes, cuts may not be mended with the repair patch and are not covered by guarantee/warranty.
3. In case of small damage/holes, a repair plaster set is included. You can use any brand of adhesive for swimming accessories. Attention, this is not included in the scope of delivery.
4. When not in use, store the mattress in the designated storage bag in a clean, dry place without extreme temperature fluctuations.

6 Cleaning

- Do not submerge the mattress under water!
- To remove dirt, use a clean, slightly damp cloth to wipe the surface. If necessary, you can put a little detergent on the cloth.
- Do not exert force, but clean the dirty area with circular movements. Then wipe the cleaned area dry.
- Do not dry the mattress with a hair dryer or similar. Only allow the air bed to air dry completely before storing it.

7 Troubleshooting

- In case of air loss, please check the following:
 - Is the controller (B) of the integrated pump in the "inflate" position?
 - Is the plug on the valve tightly closed?
 - **For small cracks / holes, a repair plaster is included. You can use any brand of adhesive for swimming accessories. Attention, this is not included in the scope of delivery.**

7.1. Repair air leak

1. Wipe with mild soapy water over the area where you suspect the leakage. In case of leakage, bubbles should rise. Please do not submerge the mattress under water!
2. Clean the area as described above and wipe it completely dry
3. Cut out a suitable piece from the repair patch. Make sure that the edges are rounded to avoid peeling off the patch.
4. Apply the glue (not included) to the repair patch and around the leakage.
5. Press the patch firmly onto the area where air is escaping.
6. Wait at least 1 hour before inflating the matzratze again.

8 Environmentally friendly disposal

 **WARNING! Suffocation!** Packaging material is dangerous for children. Never let children play with packaging material.

8.1 Disposal and packaging

- The packaging of your device consists of materials that are necessary to guarantee effective protection during transport. These materials are fully recyclable, reducing environmental impact. Dispose of the packaging in a bin for recyclable materials.

8.2 Disposal of waste equipment

- Waste equipment must be disposed of in accordance with local waste disposal guidelines and regulations. Contact your local administration at the address of the nearest recycling centre and drop off your device there.



The symbol of the crossed-out bin on WEEE indicates that it must not be disposed of with household waste at the end of its life. Collection points for waste electrical and electronic equipment are available in your area for free return. The addresses can be obtained from your city or local government. You can www.arebos.de find out about other return options we have created on our website.



The separate collection of WEEE is intended to enable the reuse, recycling or other forms of recovery of WEEE, as well as to avoid the negative effects of disposal on the environment and human health.

Our customer service number: Tel. +49 (0) 931 9080 3000

Fax: +49 (0) 931 4523 2799 / E-Mail: info@arebos.de

Office address: Canbolat Vertriebs GmbH • Gneisenaustraße 10-11 • 97074 Würzburg

Return address can be found in the imprint: <https://www.arebos.de/impressum/>

VAT identification number: DE 263752326

Place of registration in the commercial register is Würzburg, HRB 10082

WEEE-Reg. No. DE 61617071

EU declaration of conformity



We, the **Canbolat Vertriebsgesellschaft mbH**
Gneisenaustrasse 10-11
97074 Würzburg, Germany
Germany

represent under their sole responsibility that the following product:

Brand **AREBOS**
Product Inflatable mattress air bed
Article 4252023112024/4252023112031

was developed, constructed 2014/30/EU
and manufactured in accordance 2014/35/EU
with 2011/65/EU / 2015/863/EU
with the requirements of the
European Directives:

The object of the declaration described above corresponds to the respective European Union Harmonisation legislation.

The assessment is based on the EN IEC 55014-1:2021
Subsequently **applied harmonized** EN IEC 55014-2:2021
Standards: EN IEC 61000-3-2:2019+A1
EN 61000-3-3:2013+A1
EN 60335-1:2012+A1+A2+A11+A13+A14
EN 62233: 2008

Place and date of issue: Würzburg, 02.03.2023

Signature:

Dipl.-Inform. (Univ.) Korhan Canbolat, Managing Director

If the device is modified without our consent, this declaration of conformity loses its validity.