

60x125mm

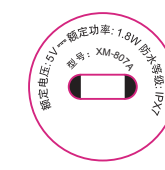

Operation Manual of electric toothbrush

Please read this product manual carefully before use

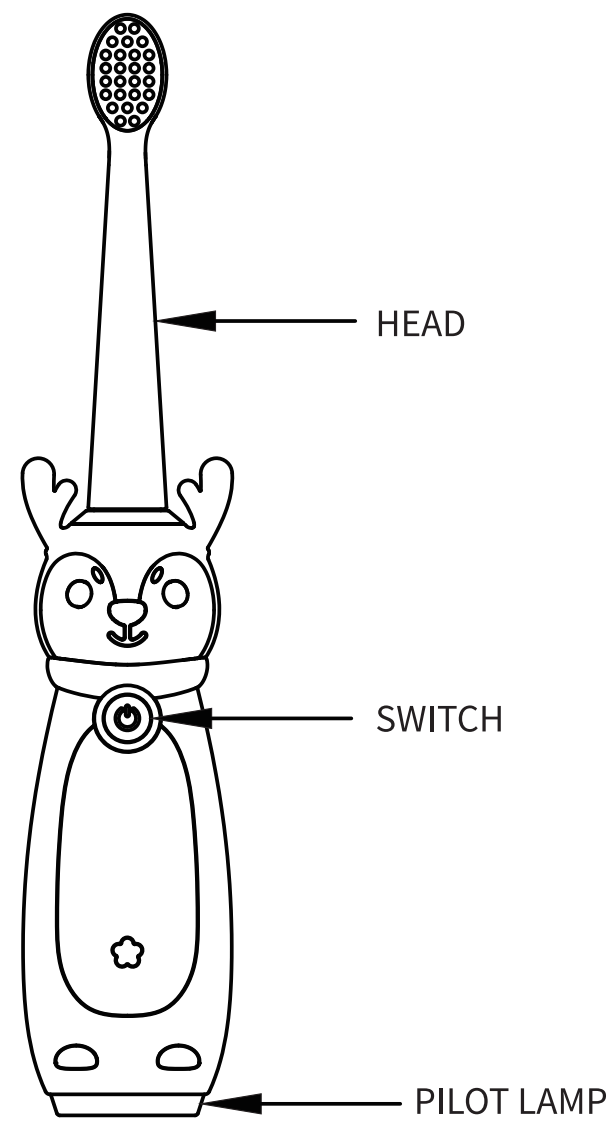

QUICK GET START

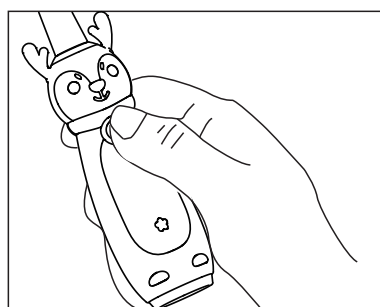

1. Wet the brush head and squeeze a small amount of toothpaste onto the brush head, Use a toothbrush. After placing the brush head in the mouth, press the on button to start

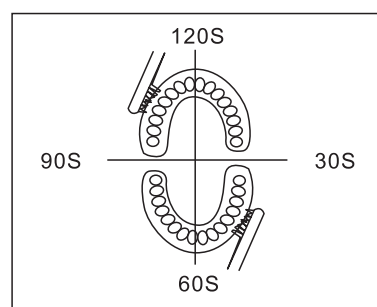

2. Slowly move the brush head on all sides of the teeth to complete A 2-minute brushing cycle.

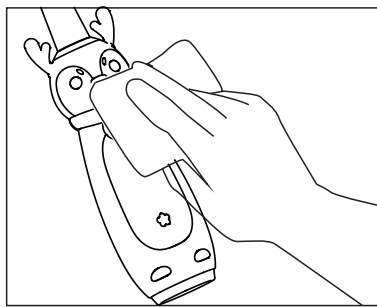

3. Press the key to close the electric toothbrush. Remove, clean the brush head and handle, and dry the handle with a soft cloth.

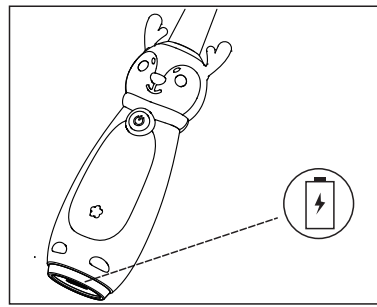

4. Please pay attention to the status of the battery indicator light, flashing. The battery is low and needs to be charged.

In a laboratory environment with a fully charged battery, the average usage time of the three gears is calculated based on two minutes of usage for every two uses, which can last for about 21 days.

Battery status and charging

①



1. When the product cannot start or has weak power, it will be in a state of low or no power

0%-5%
No flashing or reduced power

②

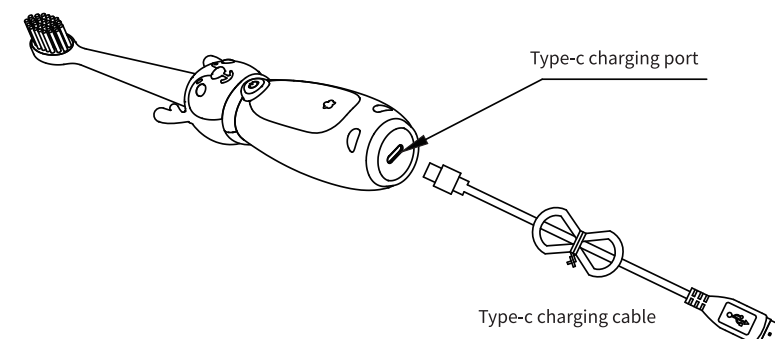

Type-c charging port

Type-c charging cable

③

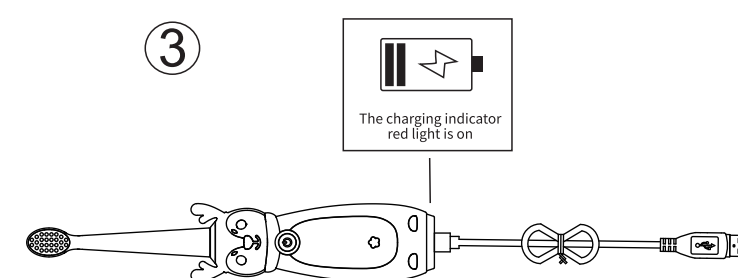

The charging indicator red light is on

Remove the Type-c charging cable and insert it into the charging port. The charging indicator light will turn red when fully charged, and then turn green.

Install the special brush head of electric toothbrush

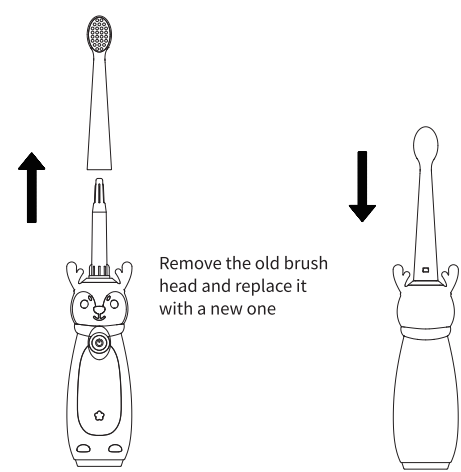

Remove the old brush head and replace it with a new one

There is a gap when installing a new brush head 0.5mm-1mm. It's a normal phenomenon

When using this product, please choose the exclusive brush head to use it continuously for three months. If you find hair loss or bundle bifurcation, please replace the exclusive brush head to avoid damaging gums and teeth.

BRUSHING TIME



The dentist suggests that brushing teeth should take up to 2 minutes each time. During use, you will feel a brief pause every 30 seconds. Here is a reminder that you should clean the four areas of your mouth evenly to achieve the best cleaning effect.

- Automatic memory function
- Press the switch to start. After starting, press the switch to change to different modes, and then switch on and off again for 1 second
- The red light is always on during charging
- The green light remains on when fully charged

Third gear mode: Sensitivity protection mode

Cleaning mode

Massage mode

Function Introduction

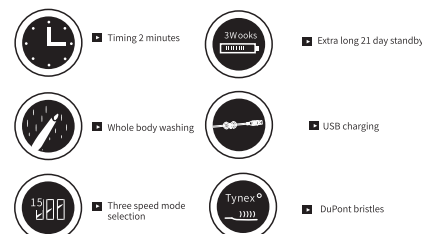

Receiving Reminder

When receiving the product for the first time, please fully charge it before use and then use it again. Do not keep the product in a low battery state for a long time to prevent the battery from running out of power and liquid leakage from damaging the product. Do not use excessive external force to break the toothbrush head

Toothbrush bristles may deform during production and transportation. It is normal to use warm water to soak the brush head and restore it

SAFETY PRECAUTIONS

To reduce the risk of malfunction, electric shock, injury, fire, death, and damage to equipment or property, please be sure to follow the following safety precautions

- This product has a built-in rechargeable battery. Do not put this product into fire or expose it to sunlight, as this may cause liquid leakage, overheating, or explosion in the battery.
- Do not use this product while charging.
- Do not modify or repair this product on your own.
- Do not use water or acidic liquid above 40 ° C to clean the power cord and plug of the host, and do not immerse the plug in water.
- Do not place this product in the contact range of children and infants.
- Do not use this product for purposes other than oral health.
- Please avoid falling or being impacted by this product.
- As PX7's waterproof performance does not include protection against hot water and steam, please do not use this product while taking a shower or shower.
- Individuals with severe periodontal disease, teeth undergoing treatment, or concerns about discomfort in the oral cavity should consult a dentist before use
- Do not use paint thinner, benzene, alcohol, or other chemicals to clean this product.
- During the first few days of using this product, there may be an itching sensation in the mouth due to the surface of the mouth and tongue. The normal feeling caused by the high-frequency vibration of the brush head, which is not accustomed to, usually disappears after several days of continuous use.
- If any damage is found to this product, please stop using it immediately.
- Do not disassemble or replace the battery inside the product by yourself.
- If any rechargeable batteries inside the product are found to be leaking, please stop using them immediately and contact our customer service personnel.

Product specifications

Product name: electric toothbrush
Product execution standard:

GB/4706.1-2005
GB/4706.59-2008

Model: XM-807A
Host power: 1.8W
Rated input of the host: 5V
Waterproof grade: IPX7
Battery capacity: 320mAh

WARRANTY DESCRIPTION

- Thank you for providing us with our products. Thank you very much! In order to effectively protect consumers and ensure their safe and satisfactory use of our high-quality products, our company will strictly comply with relevant national laws, specific provisions of the China Consumer Rights Protection Law, the China Product Quality Law, and the "Three Guarantees" line management regulations, and standardize our after-sales service system.
- First, please explain the warranty benefits you enjoy as follows:
When placing an order, please leave your true contact information. If our company is unable to fulfill the obligation of free warranty service due to inaccurate contact information, the buyer shall bear the responsibility on their own. Any malfunction caused by quality issues of the product during normal use will be provided with free repair service by our company during the warranty period. From the date of purchase of this product, the host enjoys one year of free warranty service. The charger is guaranteed for three months, and consumables such as brushes are not covered by the warranty

THE FOLLOWING SITUATIONS ARE NOT COVERED BY WARRANTY

- Product damage caused by improper use or lack of reasonable maintenance (such as using the wrong current and voltage, inserting the product into an unqualified socket, or causing human damage) Product failures and damages caused by fires, floods, lightning strikes, other natural disasters, public hazards, or abnormal power and voltage
- Termination of warranty during the warranty period:
1. The product has been repaired or disassembled by personnel not authorized by our company
2. The product uses parts that are not from our company
3. Damage caused by non domestic use of the product (such as industrial or commercial use). The free warranty service for parts or complete machines replaced during the warranty period shall terminate at the same time as the free warranty service period of this product. Unless there are relevant legal provisions, our company shall not be responsible for any other requirements
- Repair services within the scope of warranty shall be charged according to regulations. During the warranty period, for various defects caused by materials or production, the company will replace the parts or products. When applying for warranty, please be sure to send the defective products and proof of purchase date (backend order) to our company's manufacturer together
- The parts or complete machine replaced during the warranty period are from our company, so please consult our customer service center for any questions related to repair services

WARRANTY CARD

Product Name	
model	
Purchase date	
Customer Name	
Mobile phone	
Contact address	
Fault description	

Please fill in your information carefully and send this card along with the product that needs to be repaired back to our company's repair and modification center