

1. Kies een gewenste positie om de mount te plaatsen

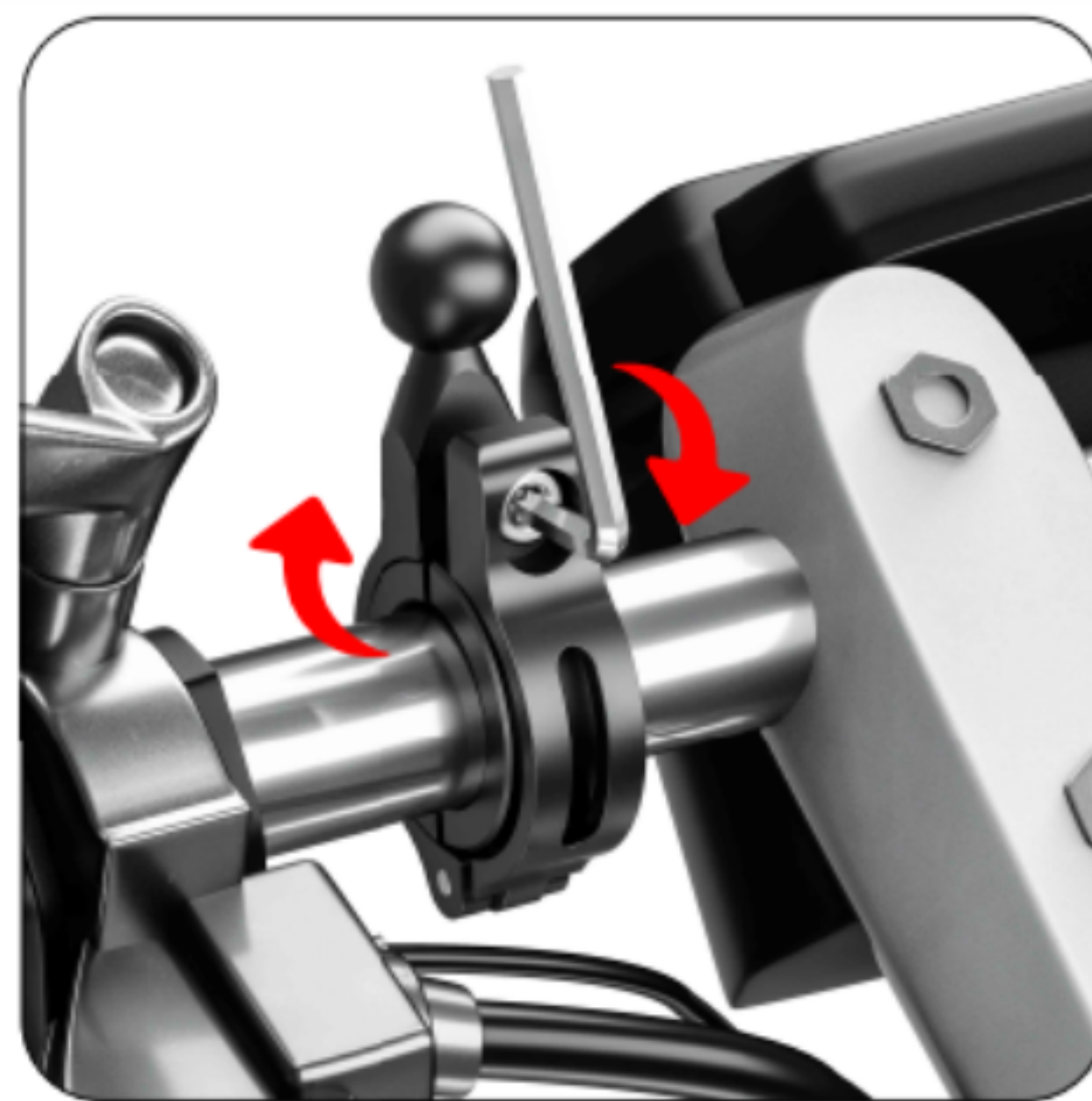

2. Maak de schroef strak vast

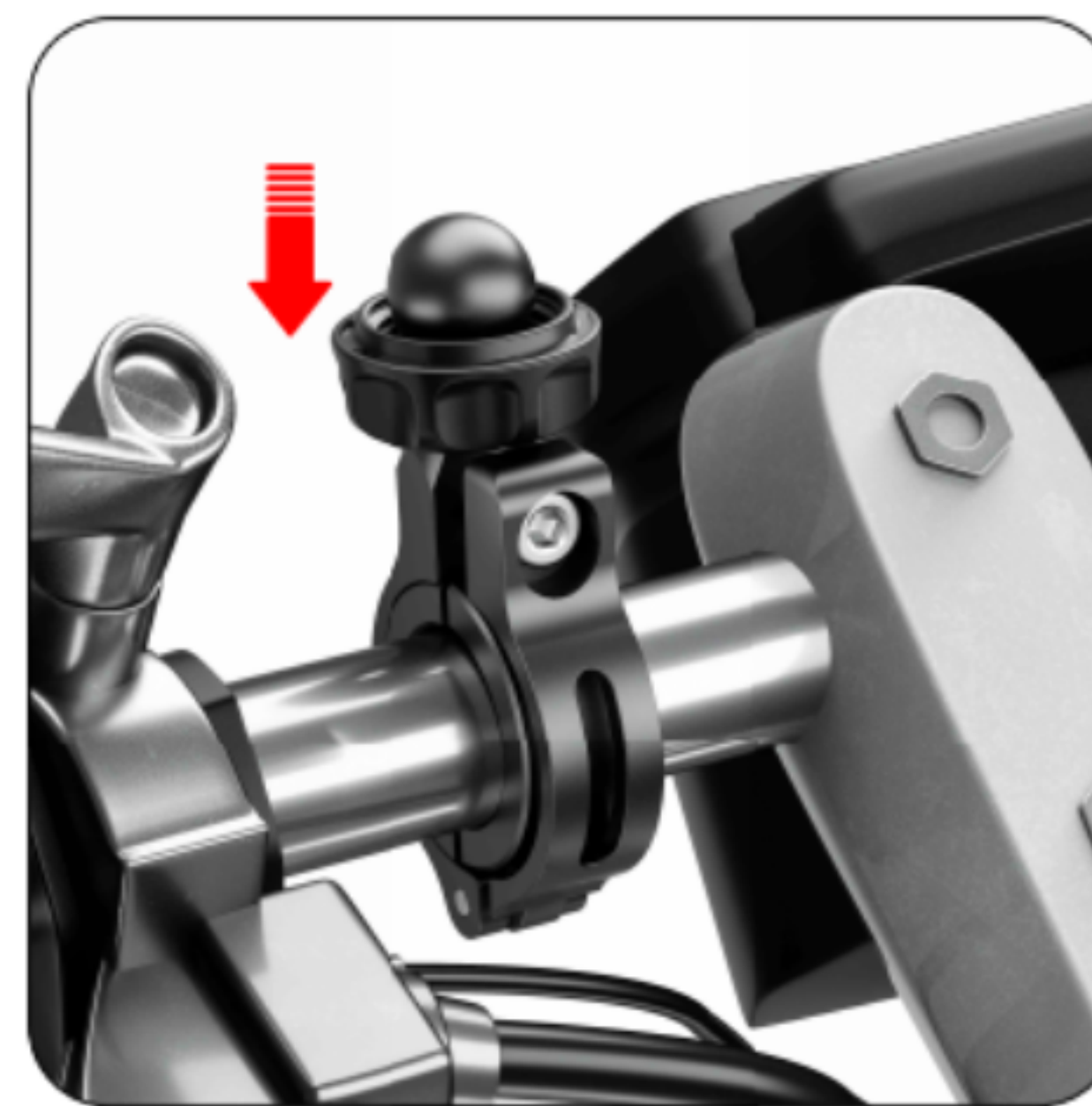

3. plaats de draaiknop om de balmount heen.

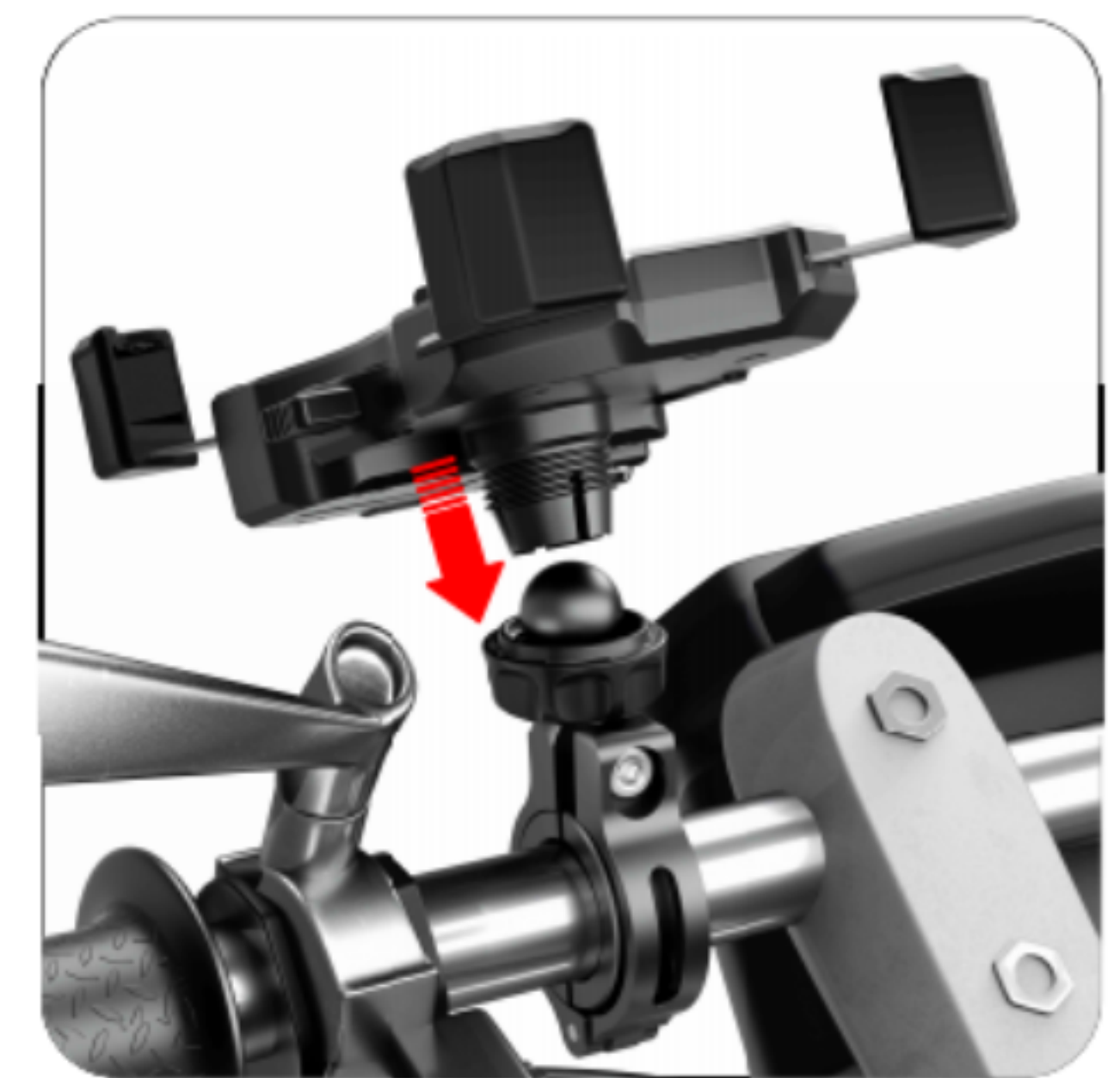

4. plaats de houder in op de balmount. (gebruik lichtjes je kracht om het te plaatsen)



5. zet het in een goede positie en gebruik de draaiknop om de houder goed vast te draaien.



6. De installatie is klaar.



Spiegelmontage:

Als je op de spiegel wilt monteren, dien je eerst de spiegel eruit te schroeven en dan de meegeleverde tussenstuk te plaatsen



Herhaal daarna de stappen 1 tot 6 op de spiegelhouder.

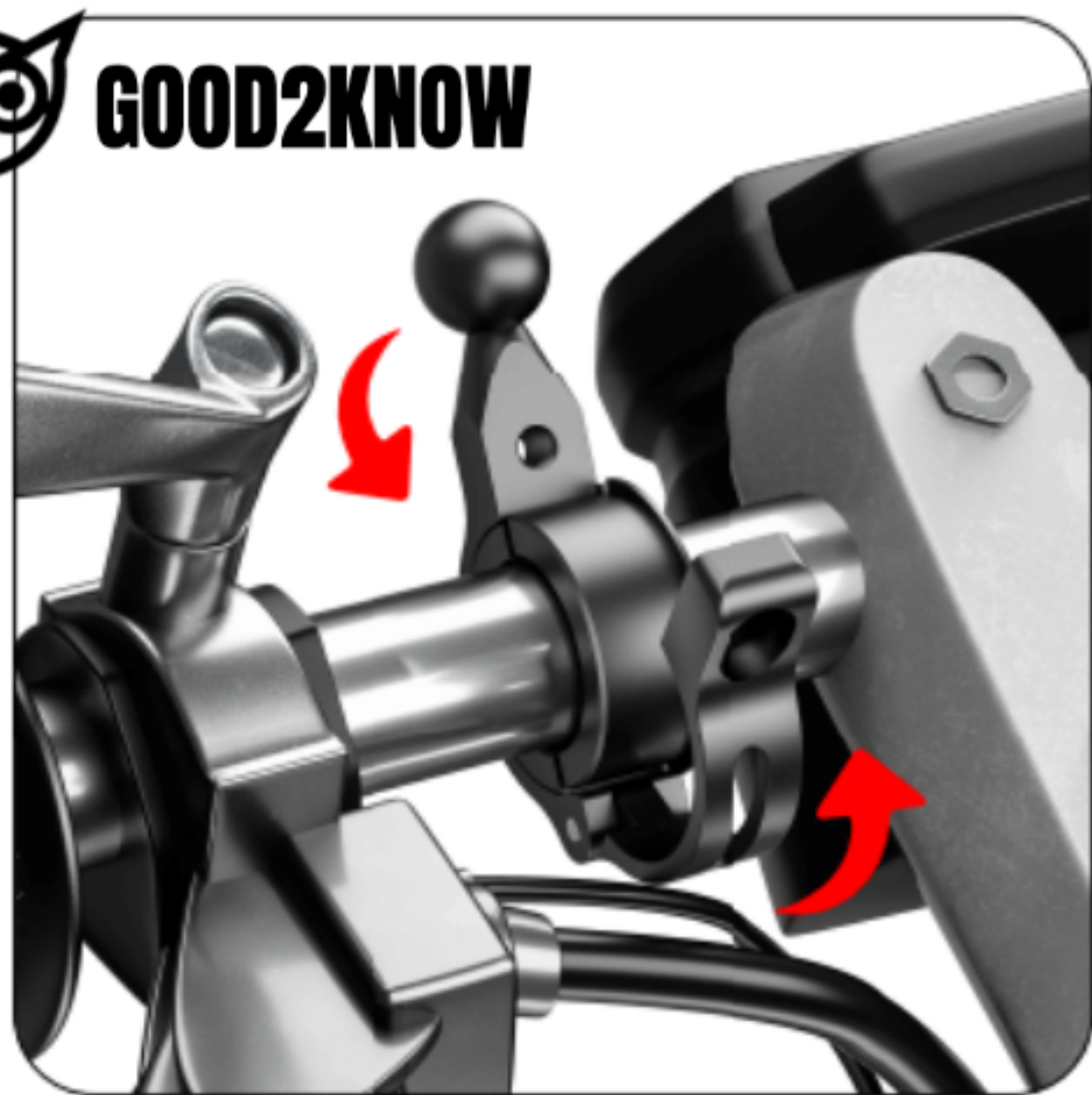

1. Choose a suitable position to place the mount.

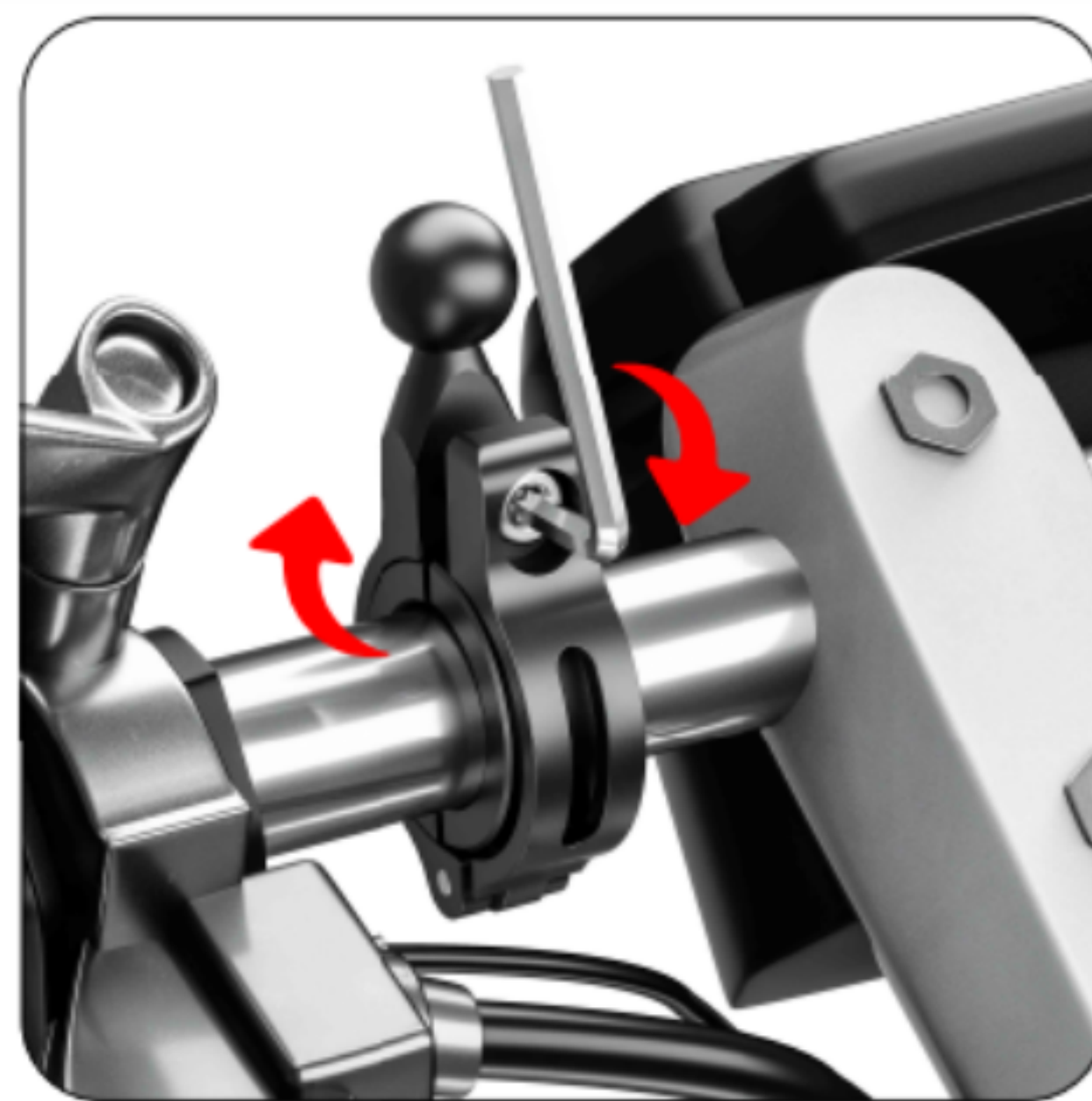

2. Tighten the screw

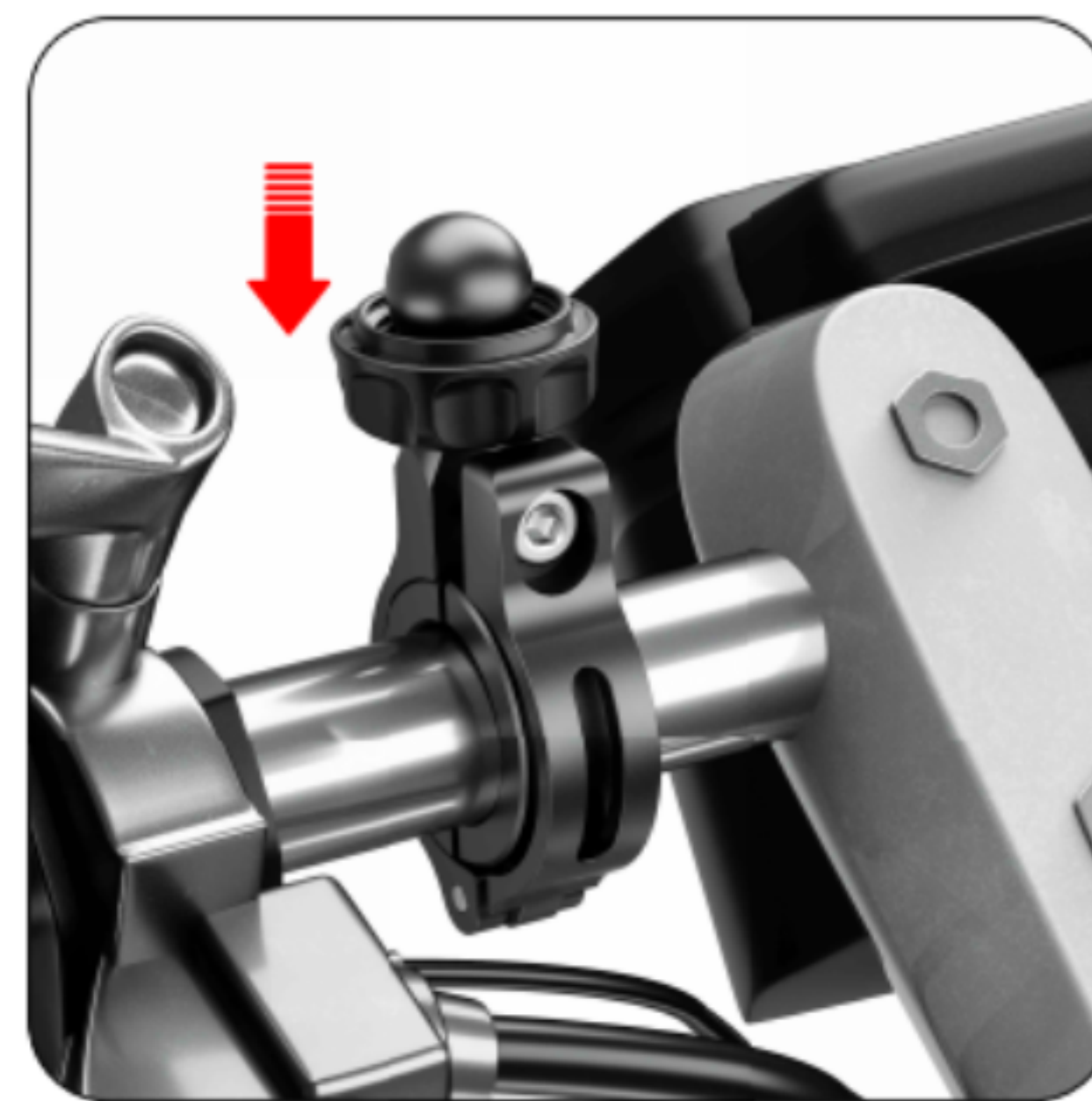

3. Put the fixing nut to tighten the mount later on.

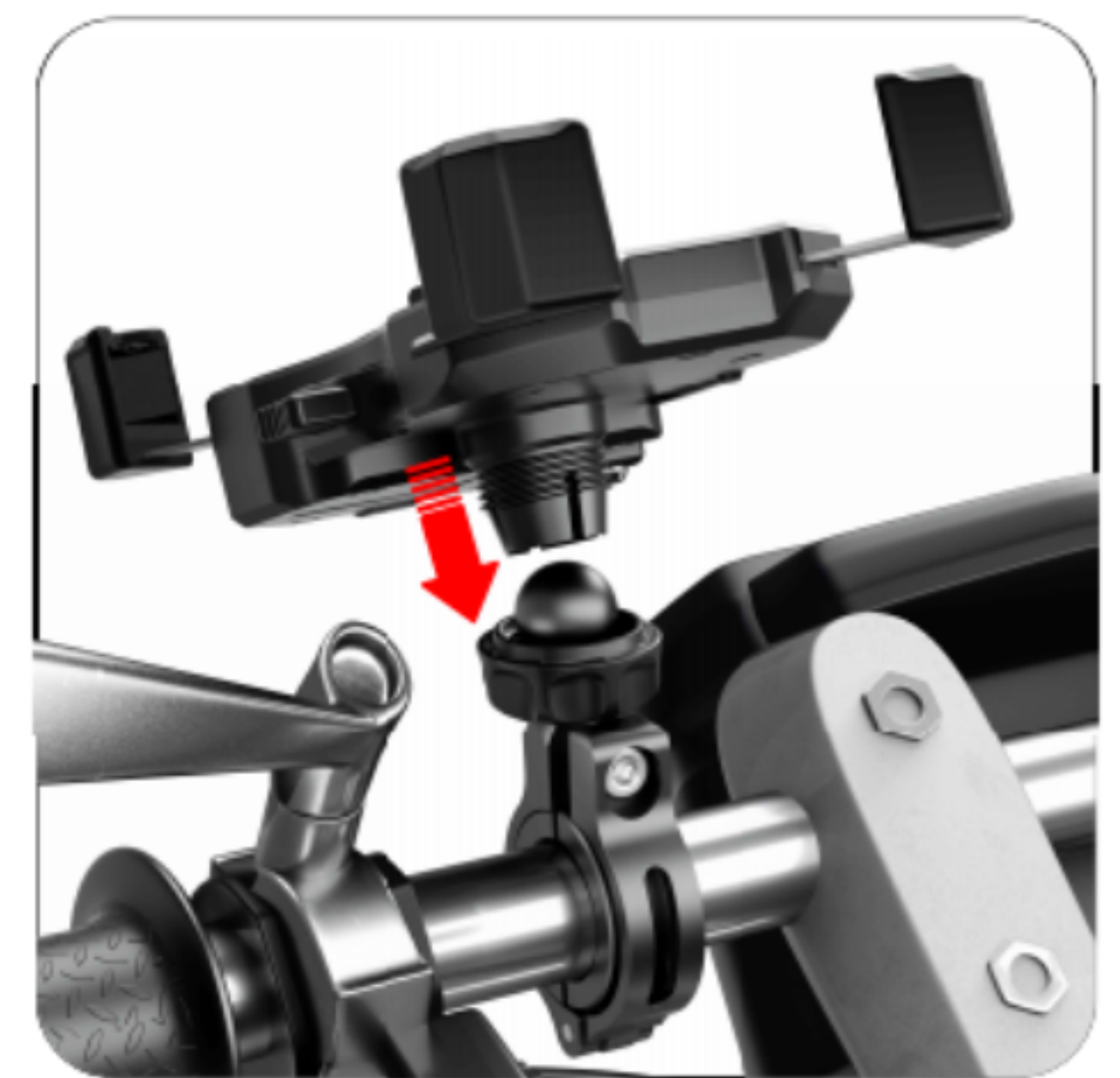

4. Clip the mount into the holder (slightly use force when clipped)

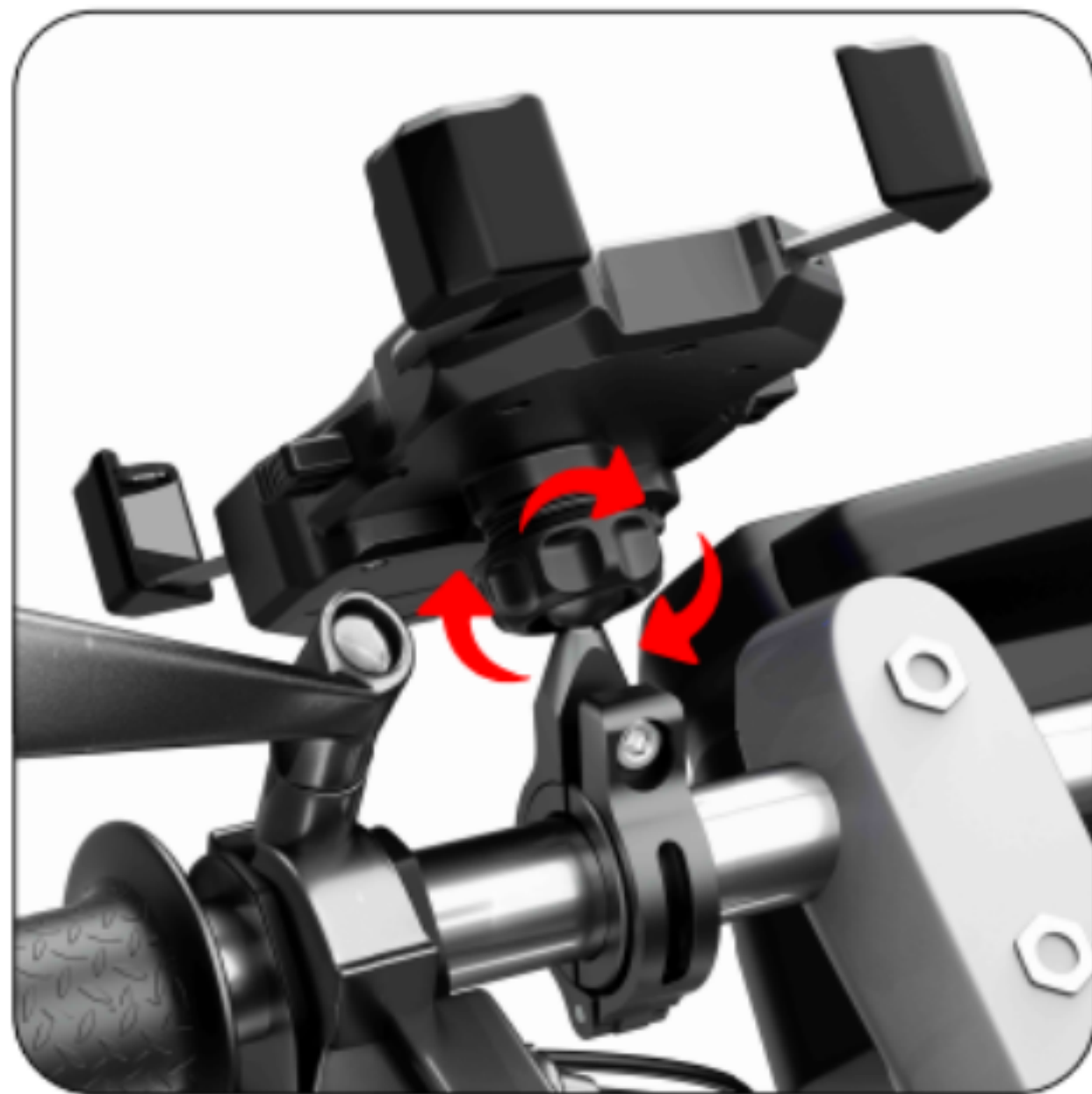

5. Adjust the holder to an appropriate angle and tighten the fixing nut by turning it.



6. The installation is finished.



mirror mount:

If you want to place the holder on your mirror mount, you need to remove your mirror first. Use the mirror mounting part to place the mount later on



Re-do the proces 1-6 on the mirror mount to have it in place.

