

封面



TuyaSmart

Thank you for using smart camera

1. Install APP

Download APP: scan the QR code below to download and install.
Register and login: open the "TuyaSmart" APP to register and login according to the prompts.



01

2. Add The Device-Scan QR code mode

- Make sure Wi-Fi is available and connected to the Internet.
- Connect the camera to the power, then system startup completed.
- Open "TuyaSmart" APP, press the '+' in the upper right corner of the main screen (Figure 01); choose "Camera & Lock", click "Smart Camera" (Figure 02) to add camera; and then click "Next step" (Figure 03);

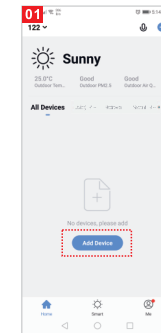

02

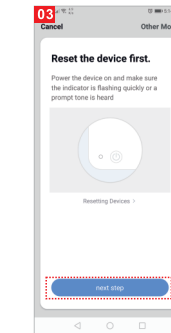
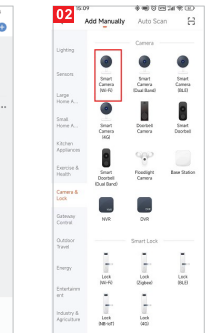

- If the mobile phone is not connected to wi-fi, please click "Connect to Wi-fi" (Figure 04);
- It will jump to the WLAN interface and connects Wi-Fi (Figure 05). Please note that only 2.4 GH Wi-Fi network is supported;
- If the phone is connected to Wi-Fi (Figure 06);

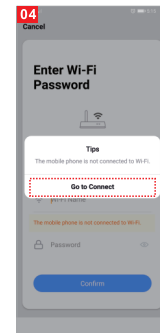

05

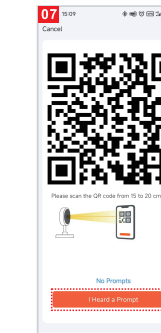
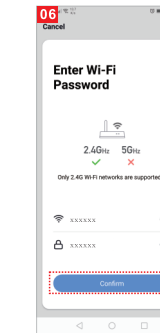
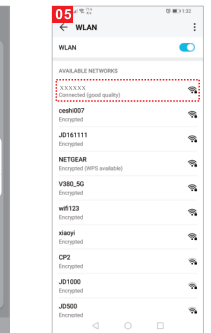

08

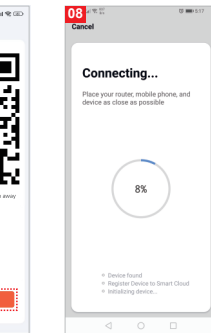

09

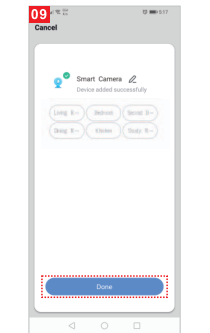

10

- click "Confirm". It will jump to the interface to prompt to scan the QR code with camera and click "Continue";
- A QR code will prompt on your screen and you need to scan it with the Smart Camera. (the camera is about 20-30 cm away from the mobile phone lens). Then click "hear the prompt sound" (Figure.07).
- "connecting" (Figure.08);

When the progress reaches 100%, connection completed (Figure 09), and click "Finish";

- Then jump to preview interface
- After closing the device preview interface, the interface returns to the APP home page. At this time, the connected device will appear on the APP home page. Then you can click directly to the device interface to see the monitoring situation without re-adding afterwards.

3. APP Video Browsing Details

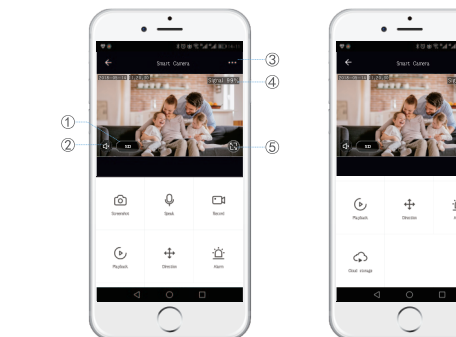

- ① Preview mode
- ② Monitor Switch
- ③ About device
- ④ SQ
- ⑤ Full screen

06

4. Matters Need Attention

Try to keep away from the metal space;
Avoid the furniture, microwave oven blocked;
Avoid the space where the audio, video and data lines are wound, and keep the space away from them as large as possible;
Ensure that as close as possible to the coverage of wireless Wi-Fi signals. Switching network environment;
In the new network environment, please press the reset hole about 5 seconds, then connect to the network.

07

The name and content of the harmful substances in the product

Part Name	Harmful Substance					
	Pb	Hg	Cd	Cr(VI)	PBB	PBDE
shell	○	○	○	○	○	○
Board	X	○	○	○	○	○
charger	○	○	○	○	○	○
annex	○	○	○	○	○	○

This form is based on the provisions of SJ/T 11364.

08

This product conforms to RoHS environmental protection requirements. At present, there is no mature technology in the world to replace or reduce the lead content in the electronic ceramics, porcelain, optical glass, steel and copper alloy.