

MAKE THE WORLD CLEAN

AS2103
Cordless brushless stick vacuum

Instruction Manual

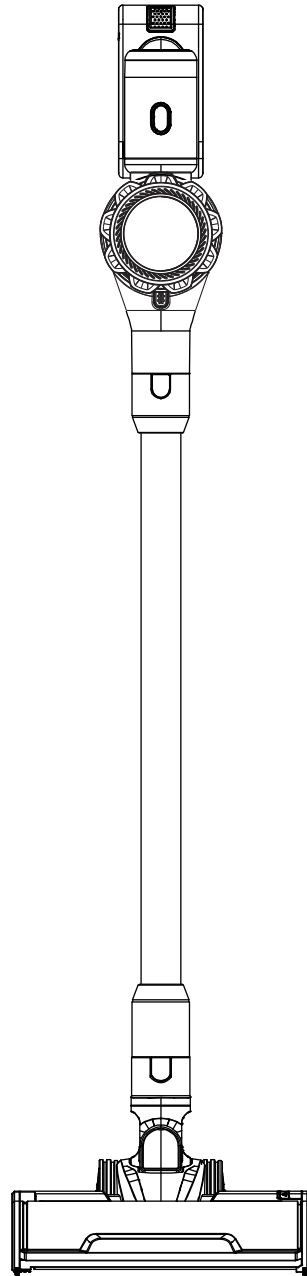

Please read the instructions carefully before using the appliance

Preface

Thank you for choosing appliance, hope you will enjoy it.

This user manual involves how to use the appliance safely and correctly, please read it carefully before using to get an ideal operating result

To use the product better, we will constantly update this operation manual. The terminal explanation right of the manual belongs to our company.

If there is any question and suggestion during using please be feel free to contact with our after-sell service

Table Of Contents

Table Of Contents

Important safety Instructions	1
Overview of the appliance.....	2
Operation Instructions Assemble the unit	3
Assemble the battery	3
Battery status indicator.....	4
Charging your vacuum cleaner.....	5
The wall charger base assemble	5
Empty the dust container & dust filter	6
Clean the dust container & dust filter.....	6
Clean the floor brush	7
Product parameters.....	7
Correct Disposal of this product	8

Important safety Instructions

Important safety Instructions

- 1.Please do not use this machine outdoor or in wet place.
- 2.Do not use it to pick up water and other liquids.
- 3.Please charge it with the original adaptor.
- 4.If it is broken,please have it repaired by professionals.
- 5.Please do not aim the vacuum directly at people's skin or others.
- 6.Make sure the machine is turned off when you are replacing accessories.
- 7.Do not use this vacuum to collect sharp objects.Such as screws,nails,etc
- 8.Do not use this vacuum to suck up burning things.
- 9.Do not use this vacuum to suck up lime and cement ,etc
- 10.This product is not suitable for things that are easy to burn and corrosive.
- 11.Please keep this vacuum cleaner in a cool place.
- 12.If the battery is damaged,please stop using this machine immediately.and if the liquids in the battery have contacted the skin or others,Please go to hospital immediately.
- 13.This product is forbidden to be used by children under 8 years old or inexperienced people.

Warnings:

1. All accessories must be original.
- 2.The adaptor can not be used for other machines.
- 3.Do not use the vacuum cleaner during charging.
- 4.The suction inlet and outlet can not be blocked ,otherwise the machine will be protected from overheating.
- 5.Do not put the battery in a fire or at a high temperature.
- 6.Do not use a non-original adaptor for charging.

Overview of the appliance

Overview of the appliance

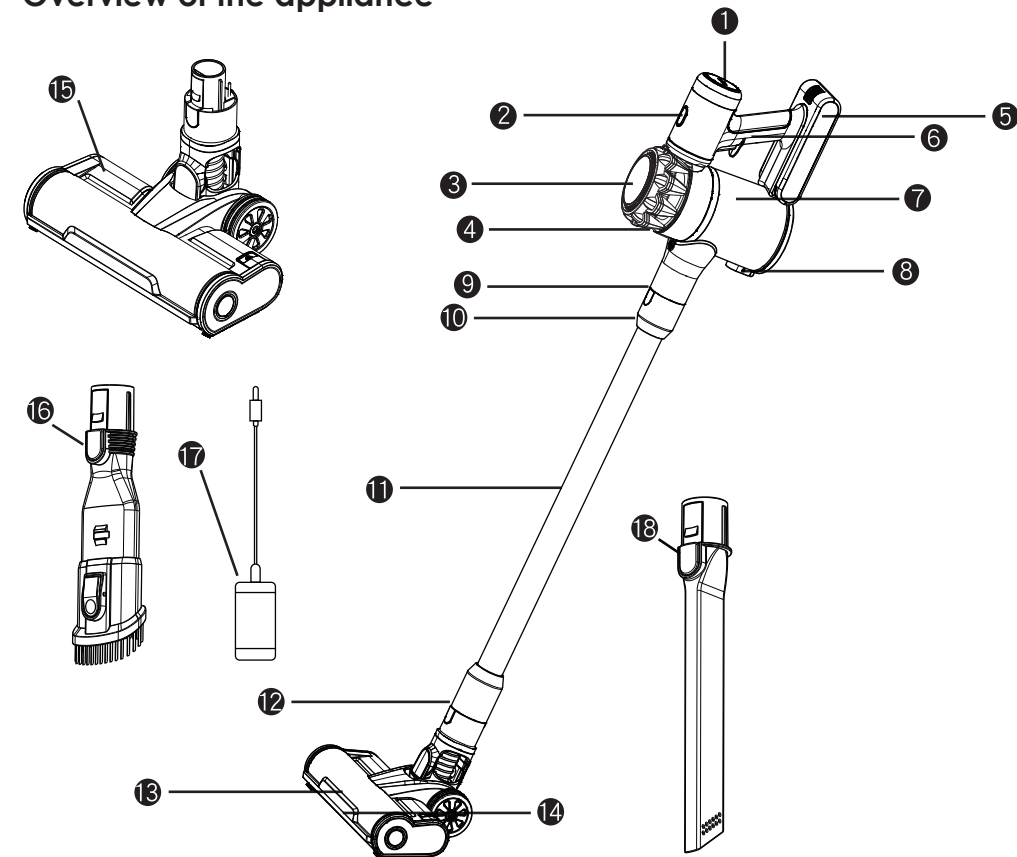

1. Gear power display	10. All accessories and main engine
2. Gear speed control button	asse mbly buttons
3.cover	11. Conducting tube
4. main cover	12. All accessories and conductive tube
5.Battery pack	asse mbly button
6.Switch start button of the whole machine	13. Roller brush
7. dust cup	14. LED headlight
8. The button of the dust cup	15. Electric floor brush
9. Main suction port	16. Two in one suction nozzle
	17. Charger
	18.Long flat suction

Assemble the battery

Operation Instructions Assemble the unit

Note: Ensure that the handheld vacuum cleaner is not connected to the charger before assembling the Metal tube.

1. take out of handheld vacuum cleaner, metal tube and floor brush.

2. Connect the floor brush with the extended tube.

Please insert the extended tube into the floor brush, You will hear the "click" when the extended tube is assembled rightly.

3. Connect the floor brush with the extended tube.

Please insert the extended tube into the floor brush, You will hear the "click" when the extended tube is assembled rightly.

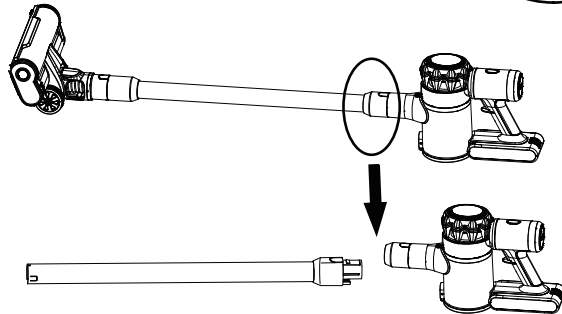
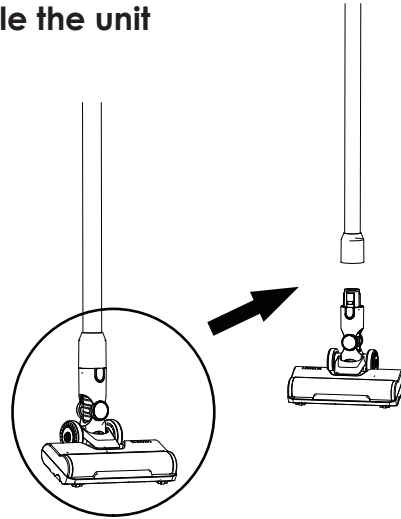

Assemble the battery

How to install and remove the battery as shown in the picture.

It is necessary to align the buckle on the battery pack with the vacuum cleaner

After the groove on the corresponding position, push the electric motor inward

The battery pack is installed when you hear a click

When taking out the battery pack, press and hold the button parallel to the outside

Pull to remove the battery pack easily

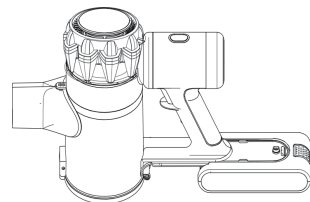

3

Battery status indicator

Use the handheld vacuum cleaner

Note: Please take out of the charger before using the vacuum cleaner. If the vacuum cleaner is charging or low battery status, the vacuum cleaner will not work.

1. The handheld vacuum cleaner can be used directly. The combined crevice nozzle can be used with the handheld vacuum cleaner directly. If you have the connection converter, it can be connected with your other suitable brush.

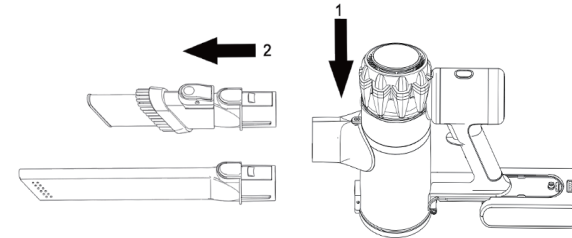

2. Press the speed control button to change the speed of the vacuum. The vacuum degree will be automatically adjusted according to the size of particles in AUTO mode. The vacuum cleaner has two speed adjustment modes-----Low speed mode and High speed mode.

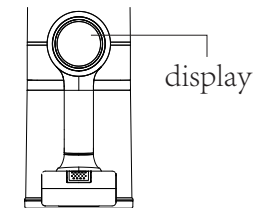
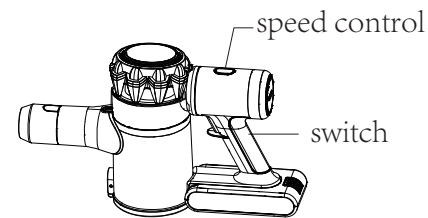

4

Charging your vacuum cleaner

Charging your vacuum cleaner

1. Place the machine near to the power supply ,make sure that the vacuum does not shake.
2. Connect the machine to the adaptor and plug it into the power supply.
3. When the lamp lights up, the vacuum cleaner starts charging.

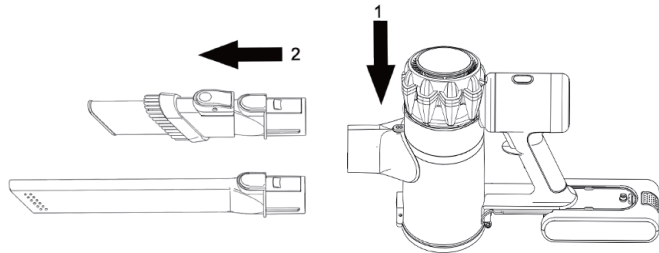

The wall charger base assemble

As show in the picture

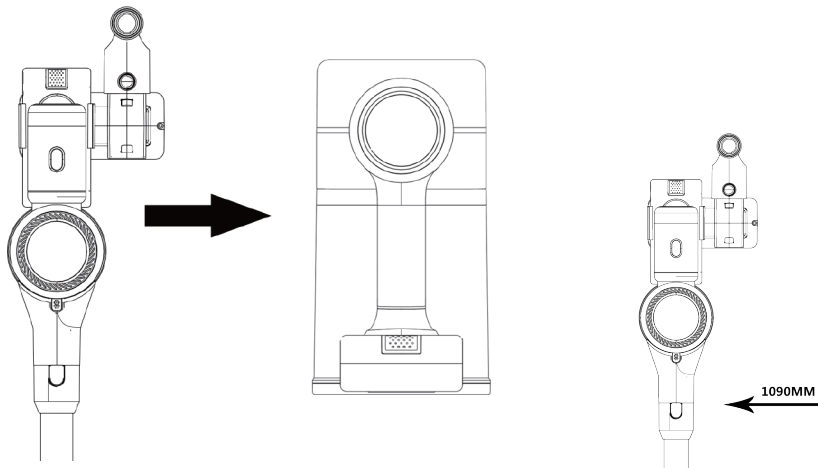

Empty the dust container & dust filter

Empty the dust container & dust filter

Note: Press the button of the dust cup to empty the container.

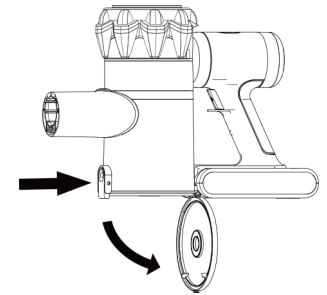

Clean the dust container & dust filter

Note: In order to ensure the good cleaning efficiency of the vacuum cleaner ,Please clean the dust cup and filter after five times of usage.

1. Remove the dust cup from the vacuum cleaner.

2. Press the button of the dust cup .Take down the dust cup as shown in the picture.

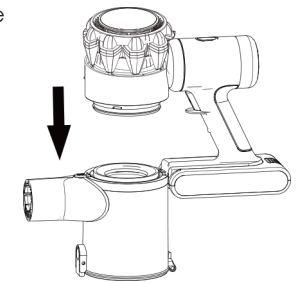

3. Take out the HEPA from the HEPA cover and wash the HEPA filter and HEPA cover with cold water. Install them on the vacuum cleaner when they are completely dry. Do not dry with a hair dryer.

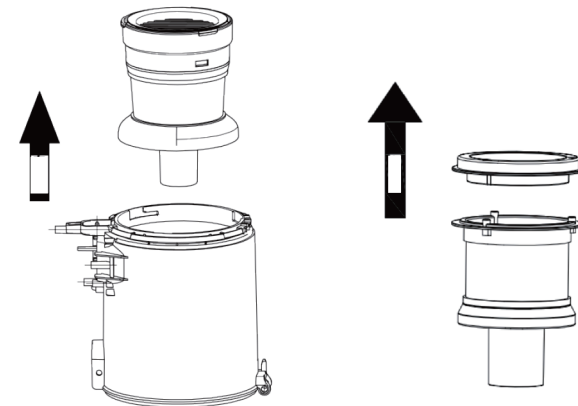

Clean the floor brush

Clean the floor brush

NOTE: Please make sure the vacuum cleaner is turned off when you are cleaning the floor brush.
Please remove the floor brush as shown in the picture.

1. Press the button of the floor brush as shown in the picture.

2. Rotate the floor brush cover and pull the roller out.

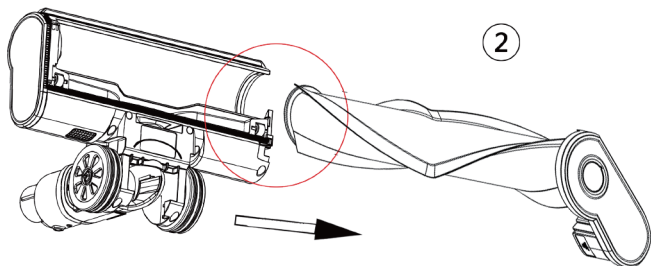
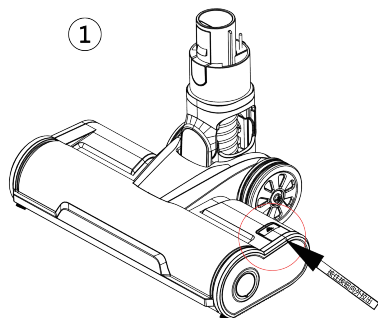

CAUTION

The suction inlet can not be blocked, otherwise, the vacuum cleaner will be protected from overheating.

Please Note

The dust filter is washable. the HEPA needs to be replaced every 3 to 6 months to keep the good cleaning efficiency of the machine.

Warning

Please ensure the vacuum is turned off when you are cleaning the floor brush.

Product parameters

Product parameters

Product model: NH0020	Voltage: DC 22.2V
Rating Power: 160W	Noise: 70-80dB
Battery Capacity(mAh): 6×2200mAh	Charging Time(h): 4-5h
Run Time(min): 20(powerful) 35(eco)	Battery Type: Lithium
Net Weight(kg): 2.6Kg	Gross Weight(kg): 3.2Kg
Battery type: lithium battery	Product Size: 340*115*215 (mm)
Dust cup capacity: 0.6L	Air Flow : ≥1.1 M3/MIN
Vacuum : ≥12Kpa (MAX)	



Correct Disposal of this product

This marking indicates that this product should not be disposed with other household wastes throughout the EU. To prevent possible harm to the environment or human health from uncontrolled waste disposal, recycle it responsibly to promote the sustainable reuse of material resources. To return your used device, please use the return and collection systems or contact the retailer where the product was purchased. They can take this product for environmental safety.